

HAMMOND AVE.

SEE SHEET 11

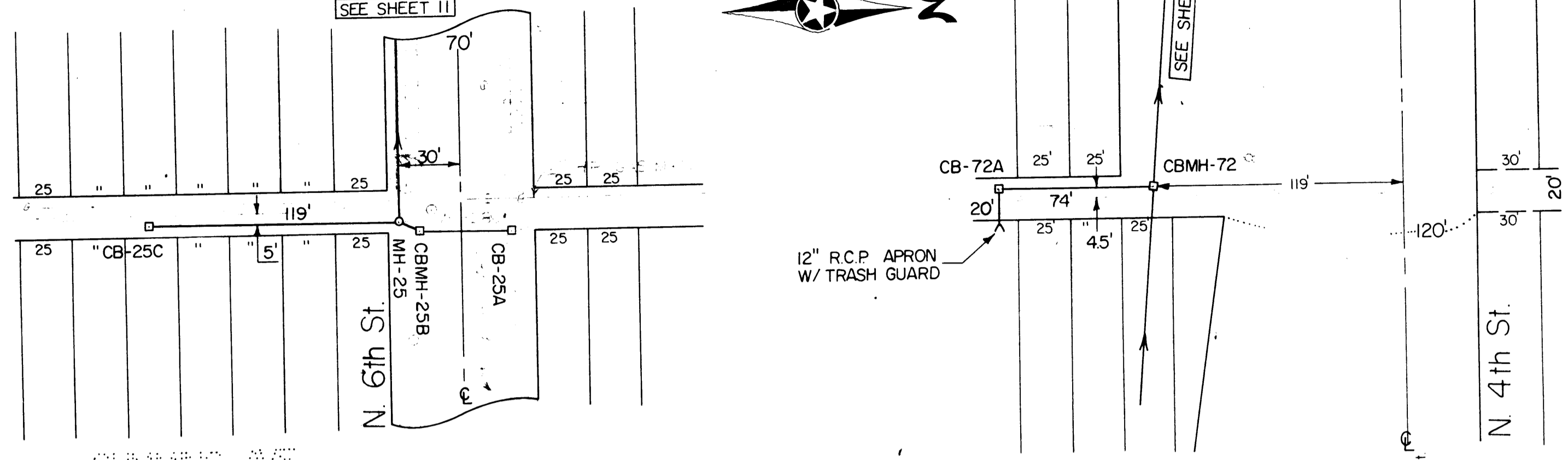

SEE SHEET 15



CUMMINS AVE.

NOTE: 12" R.C.P. IS CL. IV

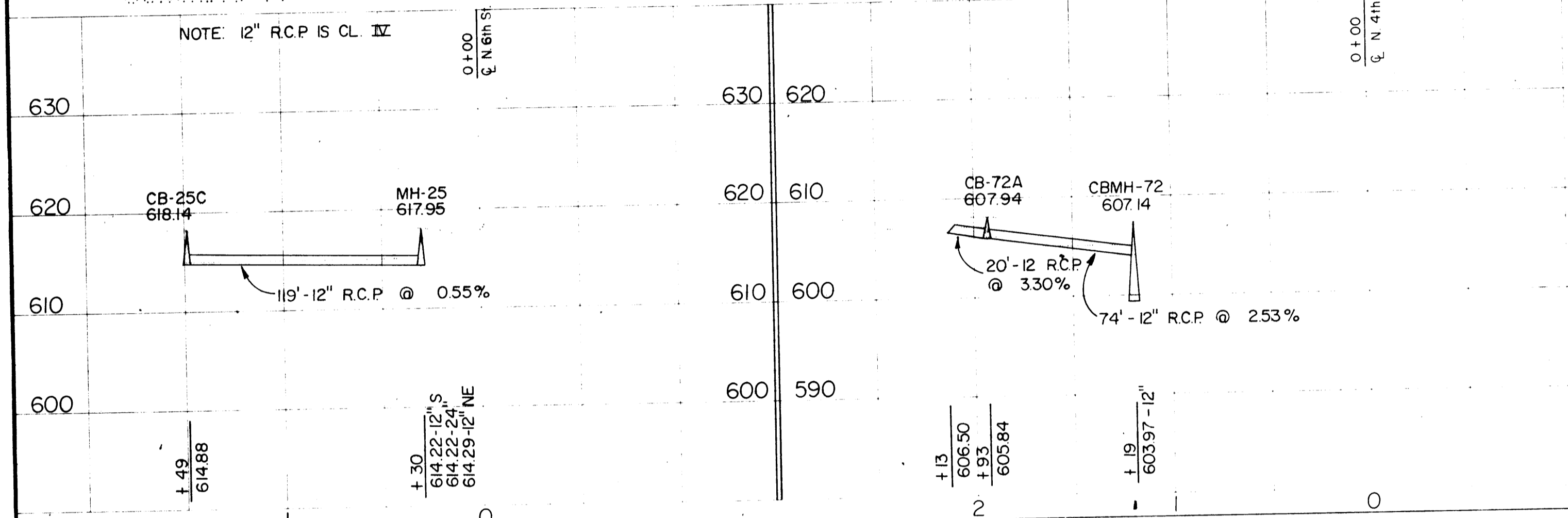

DESIGNED BY: HBR
 CHECKED BY: MSL
 DATE: FEB 23, 1979

SUPPLY
 HBR
 MSL
 DESIGN
 APPROVAL

REVISIONS
 RECORD PLANS
 12/29/78 HBR

BONESTROO, ROSENE, ANDERLIK & ASSOC., INC.
 ST. PAUL, MINNESOTA

SUPERIOR, WISCONSIN
 DATE: JULY 22, 1974
 DISTRICT I - WATER FRONT

ALLEY N 6th St.
 ALLEY N 5th St.

SHEET
 21
 21