

Sheet No.	Title
1	Typical Sections and Details
	Estimate of Quantities
	Miscellaneous Quantities
	Right of Way Plat
	Plan and Profile
	Standard Detail Drawings
	Sign Plates
	Structure Plans
	Computer Earthwork Data
	Cross Sections

TOTAL SHEETS =

STATE OF WISCONSIN
DEPARTMENT OF TRANSPORTATION
PLAN OF PROPOSED IMPROVEMENT
CITY OF SUPERIOR, HAMMOND AVENUE
BELKNAP STREET - 12TH STREET NORTH
DOUGLAS COUNTY

STATE PROJECT	PROJECT	CONTRACT
8998-13-71		

STATE PROJECT NUMBER
8998-13-71



END PROJECT 8998-13-71
STA. 10+573.000

BEGIN PROJECT 8998-13-71
STA. 10+048.000
X = 144466.033
Y = 174710.167



DESIGN DESIGNATION

A.D.T. 1997	=	10,200
A.D.T. 2017	=	14,400
D.H.V.	=	
D.	=	60/40
T.	=	9.2%
DESIGN SPEED	=	40 km/h
ESALS	=	4,803,400

CONVENTIONAL SYMBOLS

COUNTY LINE		COMBUSTIBLE FLUIDS (UNDER PRESSURE)	
CORPORATE LIMITS		UNDERGROUND UTILITIES	
PROPERTY LINE		GAS	
LOT LINE		ELECTRIC	
LIMITED EASEMENT		TELEPHONE OR TELEGRAPH	
EXISTING RIGHT OF WAY		SERVICE PEDESTAL	
PROPOSED OR NEW R/W LINE		CABLE MARKER	
SURVEY LINE		POWER POLE	
SLOPE INTERCEPT		TELEPHONE POLE	
ORIGINAL GROUND		RAILROAD	
MARSH OR ROCK PROFILE		MARSH AREA	
EXISTING CULVERT		WOODED OR SHRUB AREA	
PROPOSED CULVERT (Box or Pipe)			
CULVERT (Profile View)			

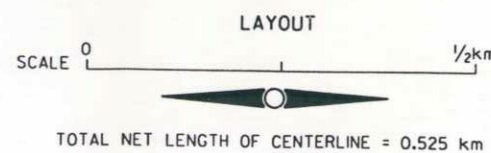

COORDINATE NOTE
ALL COORDINATES ON THIS PLAN ARE REFERENCED TO THE WISCONSIN GRID COORDINATE SYSTEM, NORTHERN ZONE. ALL ELEVATIONS SHOWN ON THIS PLAN ARE REFERENCED TO THE U.S.G. AND G.S. DATUM.

APPROVED FOR
CITY of SUPERIOR
DATE 11/19/97
DIRECTOR OF PUBLIC WORKS

ORIGINAL PLANS PREPARED BY



DATE 12/17/97

STATE OF WISCONSIN
DEPARTMENT OF TRANSPORTATION

PREPARED BY
Surveyor S.E.H. INC.
Designer S.E.H. INC.
District Examiner CHRISTINE KOSKI
District Supervisor RICK WASHKLUHN
Proj. Dev. Engineer
C.O. Examiner

APPROVED FOR DISTRICT OFFICE
DATE: _____ (Signature)

AUTHORIZED FOR CENTRAL OFFICE DESIGN
DATE: _____ (Signature)

PLOT SCALE: 0.50

PLOT NAME: SSHAMMO2.INI

REV. DATE: 11/04/97

ORIGINATOR: SEH

FILE NAME: SSHAMMO2.DGN

LEVELS ON - 1, 2, 3, 4, 5, 6, 7, 8, 9, 10, 11, 12, 13, 14, 15, 16, 17, 18, 19, 20, 21, 22, 23, 24, 25, 26, 27, 28, 29, 30, 31, 32, 33, 34, 35, 36, 37, 38, 39, 40, 41, 42, 43, 44, 45, 46, 47, 48, 49, 50, 51, 52, 53, 54, 55, 56, 57, 58, 59, 60, 61, 62, 63

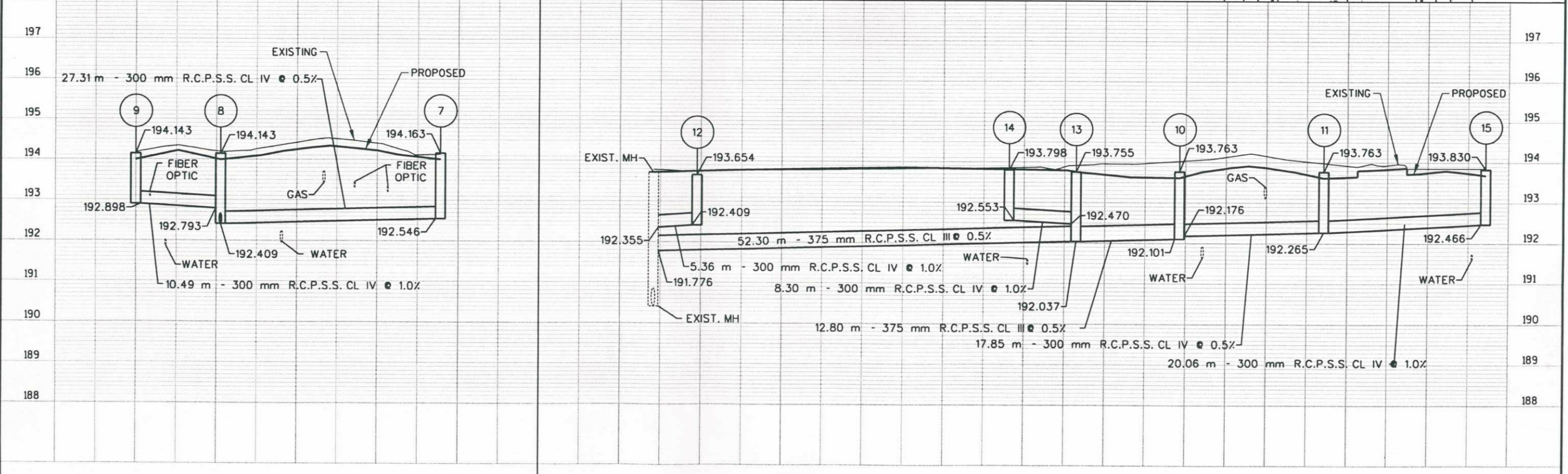
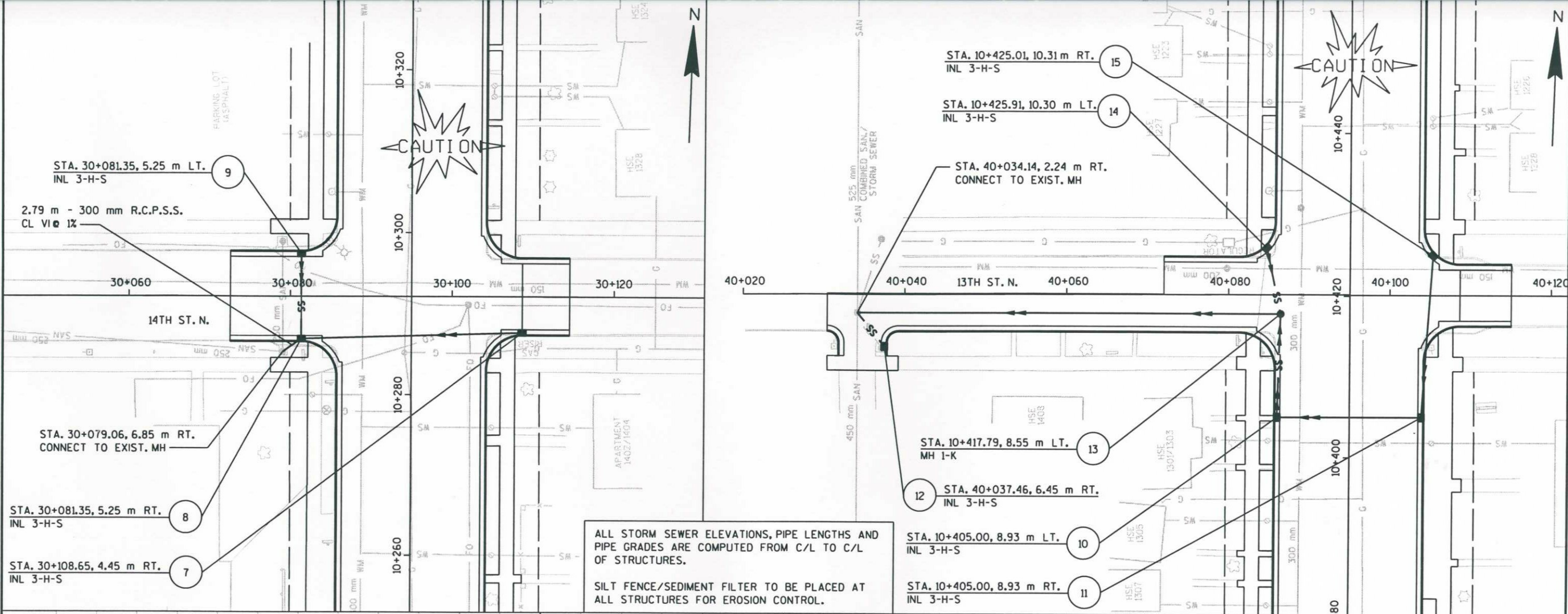

PLOT SCALE: 0.5

PLOT NAME: SSSHAMMOI.INI

REV. DATE: 11/04/97

ORIGINATOR: SEH

FILE NAME: SSSHAMMOI.DGN
EVELS ON - 1, 2, 3, 4, 5, 6, 7, 8, 9, 10, 11, 12, 13, 14, 15, 16, 17, 18, 19, 20, 21, 22, 23, 24, 25, 26, 27, 28, 29, 30, 31, 32, 33, 34, 35, 36, 37, 38, 39, 40, 41, 42, 43, 44, 45, 46, 47, 48, 49, 50, 51, 52, 53, 54, 55, 56, 57, 58, 59, 60, 61, 62, 63

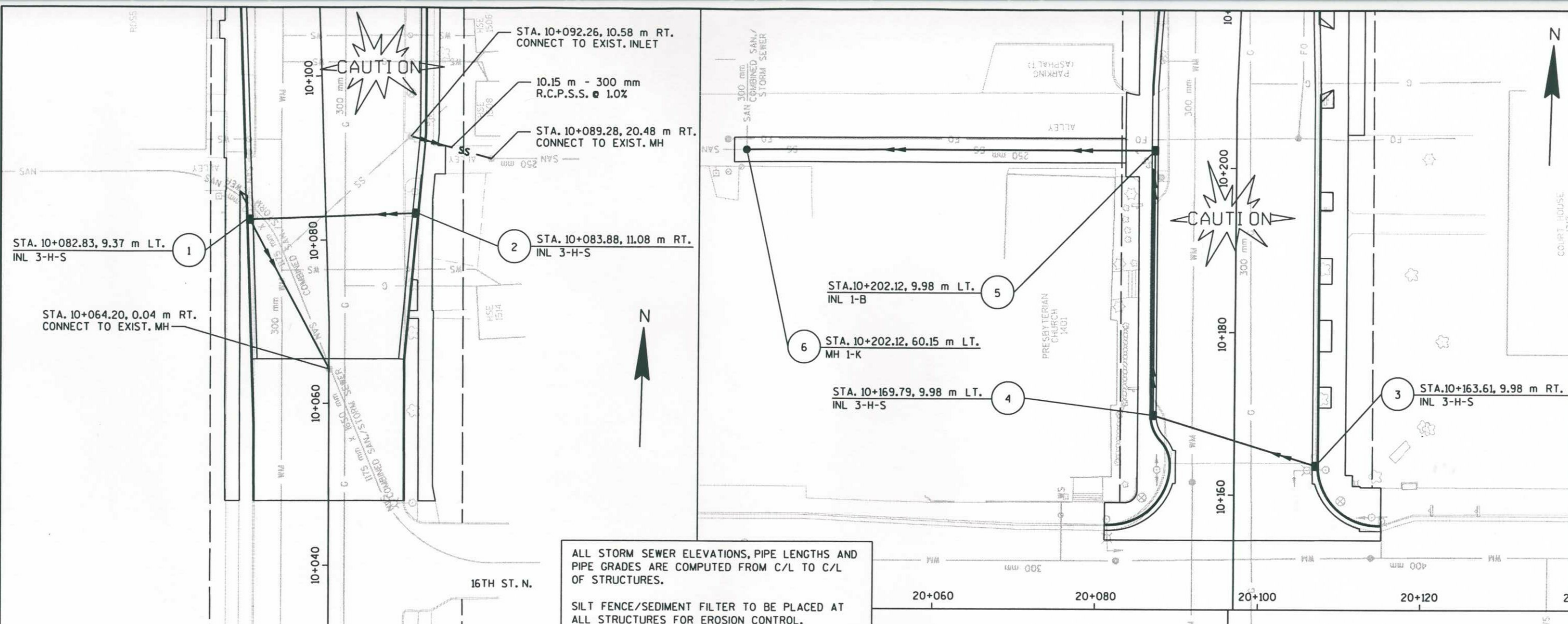

ALL STORM SEWER ELEVATIONS, PIPE LENGTHS AND PIPE GRADES ARE COMPUTED FROM C/L TO C/L OF STRUCTURES.

SILT FENCE/SEDIMENT FILTER TO BE PLACED AT ALL STRUCTURES FOR EROSION CONTROL.

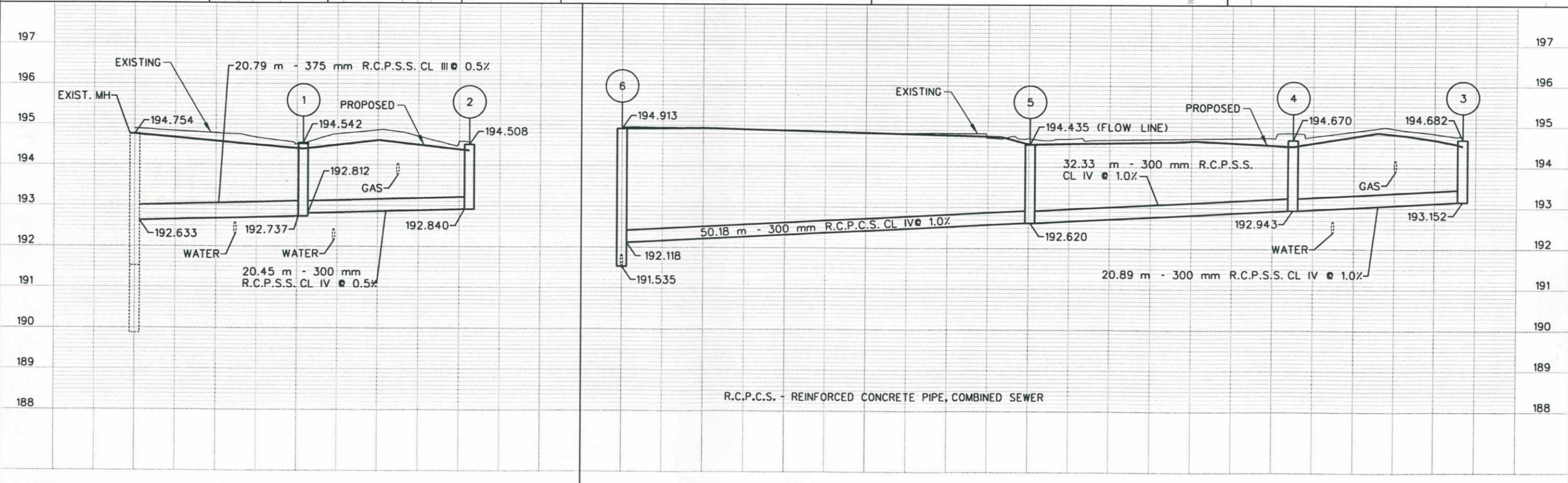

R.C.P.C.S. - REINFORCED CONCRETE PIPE, COMBINED SEWER

PLOT SCALE: 5:00

PLOT NAME: SSHAMMO3.INI

REV. DATE: 11/11/97

ORIGINATOR: SEH

FILE NAME: SSHAMMO3.DGN
ELEVATIONS ON - 1, 2, 3, 4, 5, 6, 7, 8, 9, 10, 11, 12, 13, 14, 15, 16, 17, 18, 19, 20, 21, 22, 23, 24, 25, 26, 27, 28, 29, 30, 31, 32, 33, 34, 35, 36, 37, 38, 39, 40, 41, 42, 43, 44, 45, 46, 47, 48, 49, 50, 51, 52, 53, 54, 55, 56, 57, 58, 59, 60, 61, 62, 63

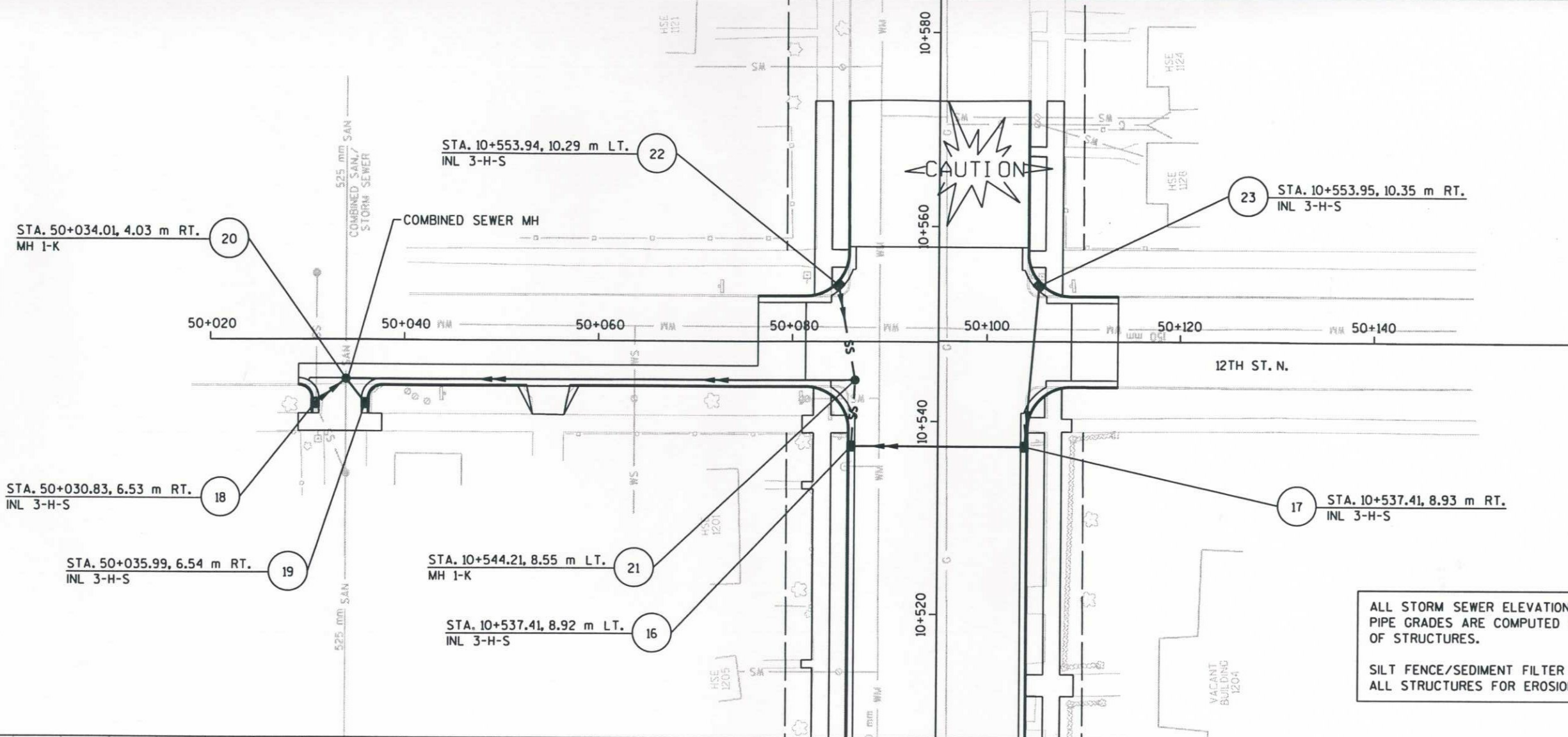

ALL STORM SEWER ELEVATIONS, PIPE LENGTHS AND PIPE GRADES ARE COMPUTED FROM C/L TO C/L OF STRUCTURES.

SILT FENCE/SEDIMENT FILTER TO BE PLACED AT ALL STRUCTURES FOR EROSION CONTROL.

