

CITY OF SUPERIOR

SANITARY SEWER EXTENSION

22 ND AVE. E. - BTN. E.10TH & E.11TH ST.

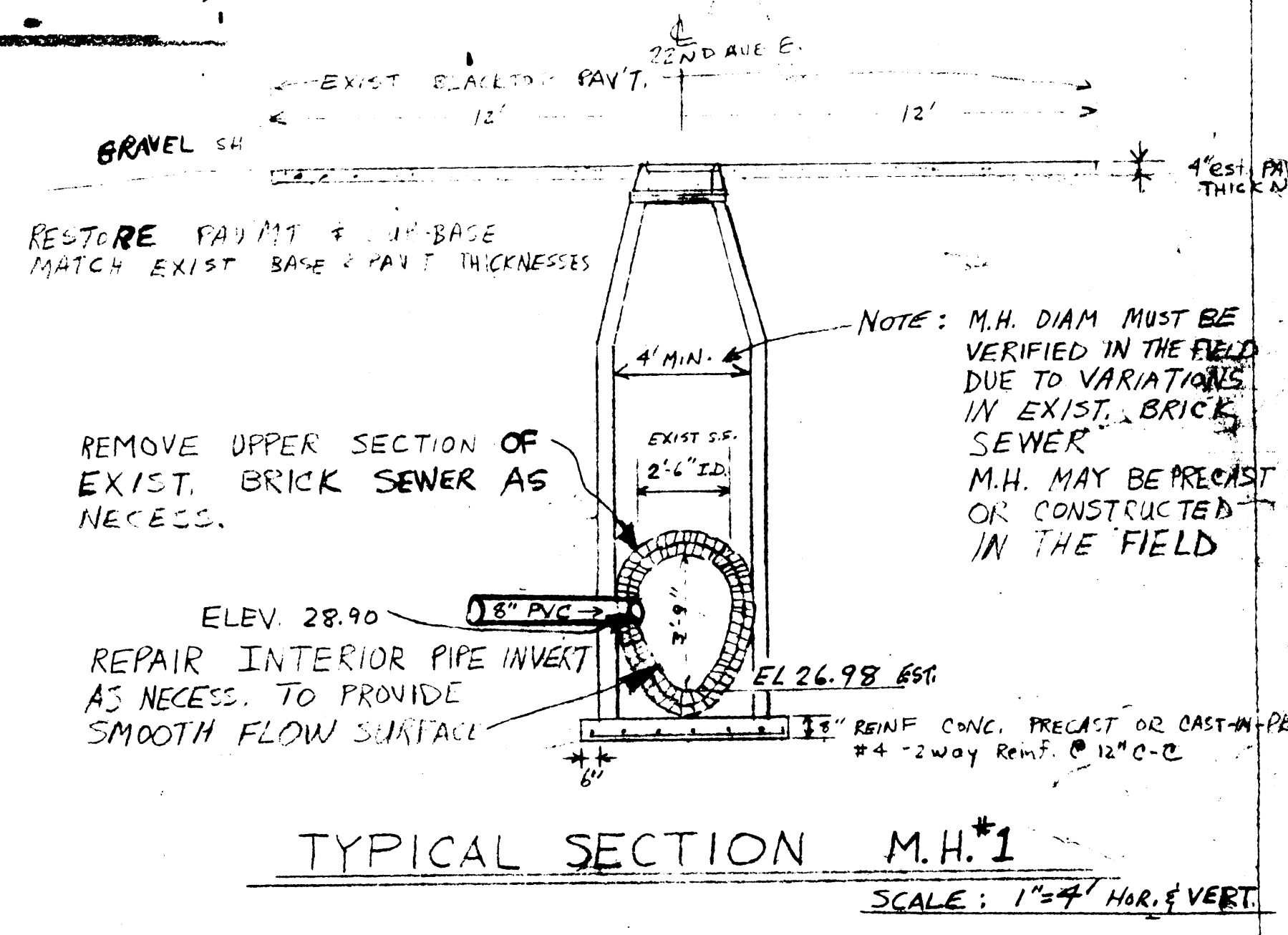
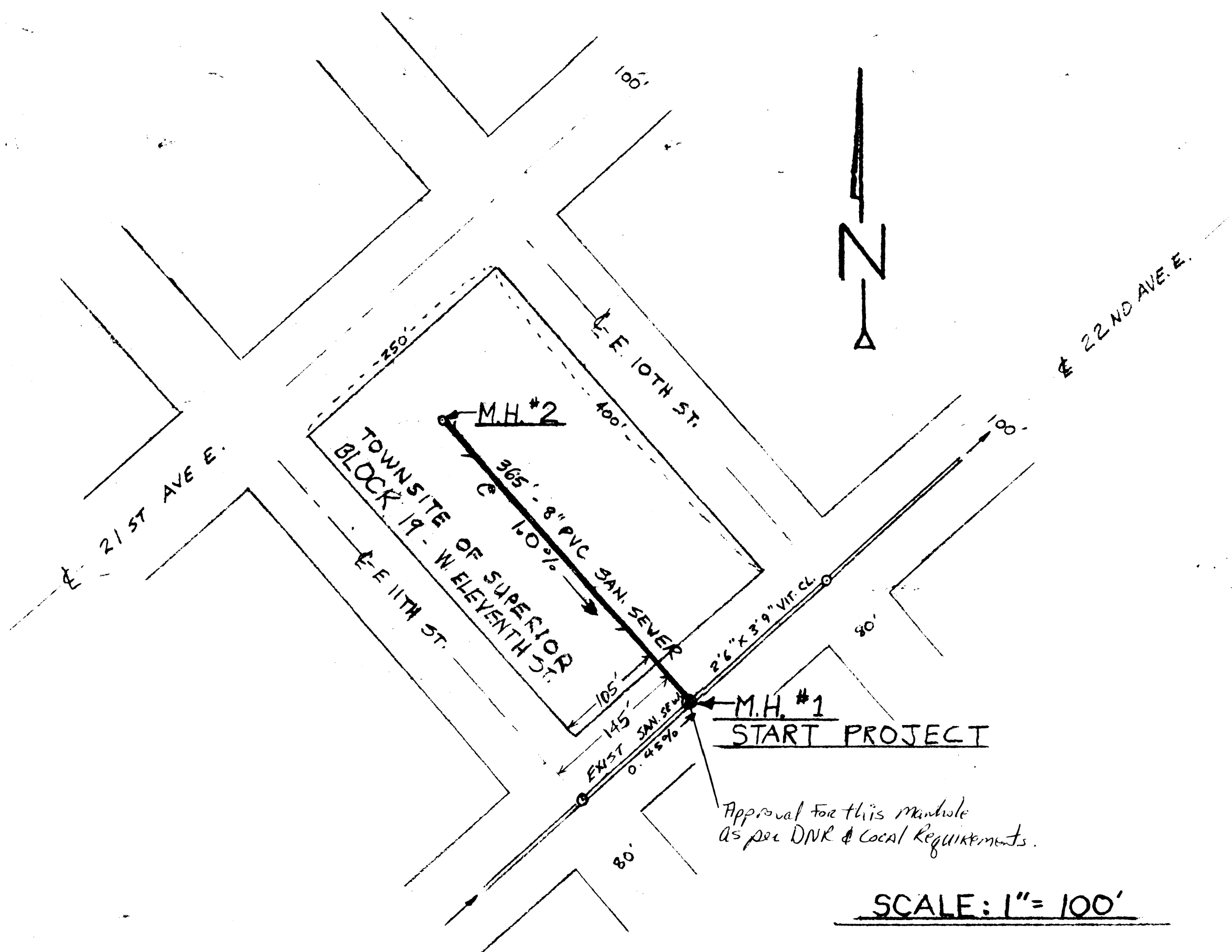

CONSTRUCTION NOTES:

Utilities shown on these plans are approximate locations only. Contractor is responsible for all utility locations.

CONTACT Superior Water Light and Power Company for all water, gas, and electric utility locations.

CONTACT Wisconsin Bell Telephone for all underground telephone cables.

CONTACT Group W Cable T.V. for all cable T.V. lines.

Contractor is responsible for coordination with all utility companies for all relocations, etc. for all underground or overhead utilities.

Contractor is responsible for the cost of utility relocations unless specifically excluded elsewhere in the specifications.

Contractor is responsible for all pavement crossings. Pavement shall be neatly sawcut. Subgrade and pavement shall be restored to the original condition.

Contractor shall coordinate with the City of Superior Public Works Department for location of City owned storm and sanitary sewers or other facilities. Contractor shall coordinate with the City Plumbing Inspector for construction of sanitary sewers.

PLUMBING

Conditionally APPROVED

DEPARTMENT OF INDUSTRY, LABOR AND HUMAN RELATIONS

DEVELOPER: EUGENE S. PARISE

CITY OF SUPERIOR

SANITARY SEWER EXTENSION

ENGINEER: GEORGE C. LAVALLEY, JR. P.E.

WISC. REG. NO. E-19991

22 ND AVE. E. SUPERIOR, WIS. 546 01 01

George C. Lavalley, Jr.
 July 23, 1991

G9120125

SHEET 1 of 2

Fed. Proj. No.

END PROJECT
M.H. #2
F.L. ELEV. 632.55
RIM ELEV. 642.40

BEGIN PROJECT
M.H. #1 F.L. EL. 628.90
RIM ELEV. 641.79
SEE 1st SECTION ON SHEET 1

12+88 wye E.S.T.
365' - 8" PVC SAN. SEWER @ 1.0% →

All wye connections for future use shall be properly capped.

PLANNING
Conditionally APPROVED
DEPARTMENT OF INDUSTRY, LABOR AND HUMAN RELATIONS
DIVISION OF SAFETY AND BUILDINGS
John E. Davis
SCALE: 1" = 20' HORIZONTAL
1" = 4' VERTICAL

E. 11TH ST.

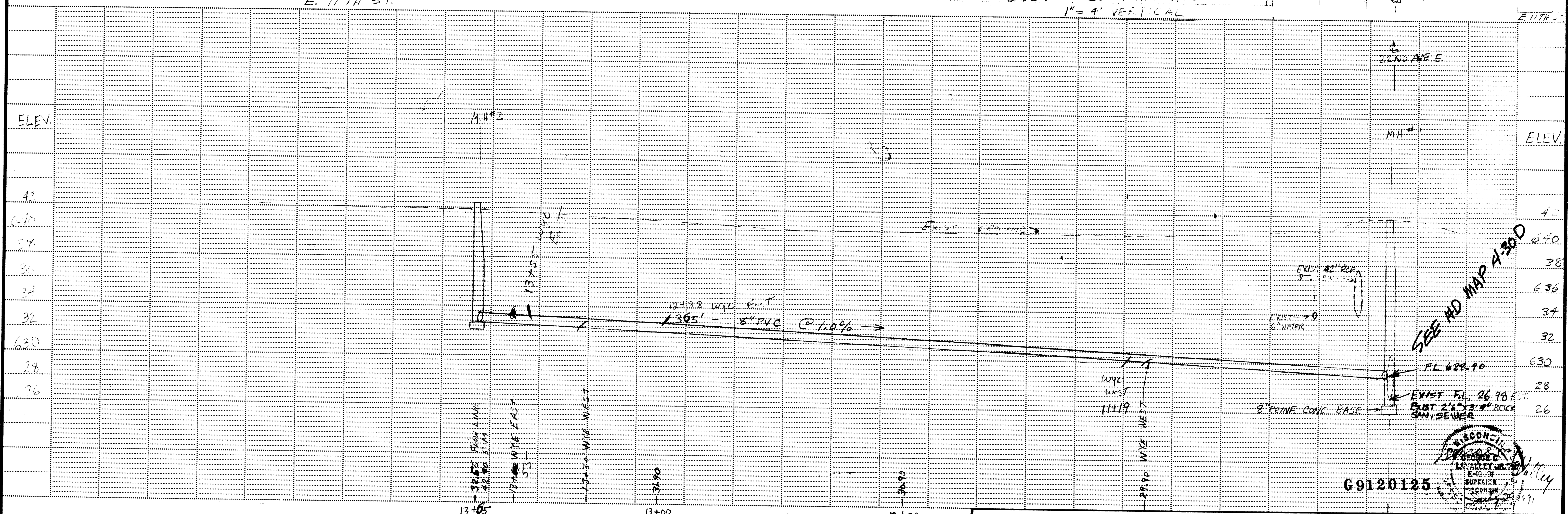

SINGLE PLAN DOTTED
N. A. ROGERS CO. - MILWAUKEE, WI. PAUL

State Proj. No.

Sheet No. 2 of 2 Sheets

69120125

