

SUPERIOR INDUSTRIAL PARK
 E.D.A. PROJECT NO. 06-01-01127

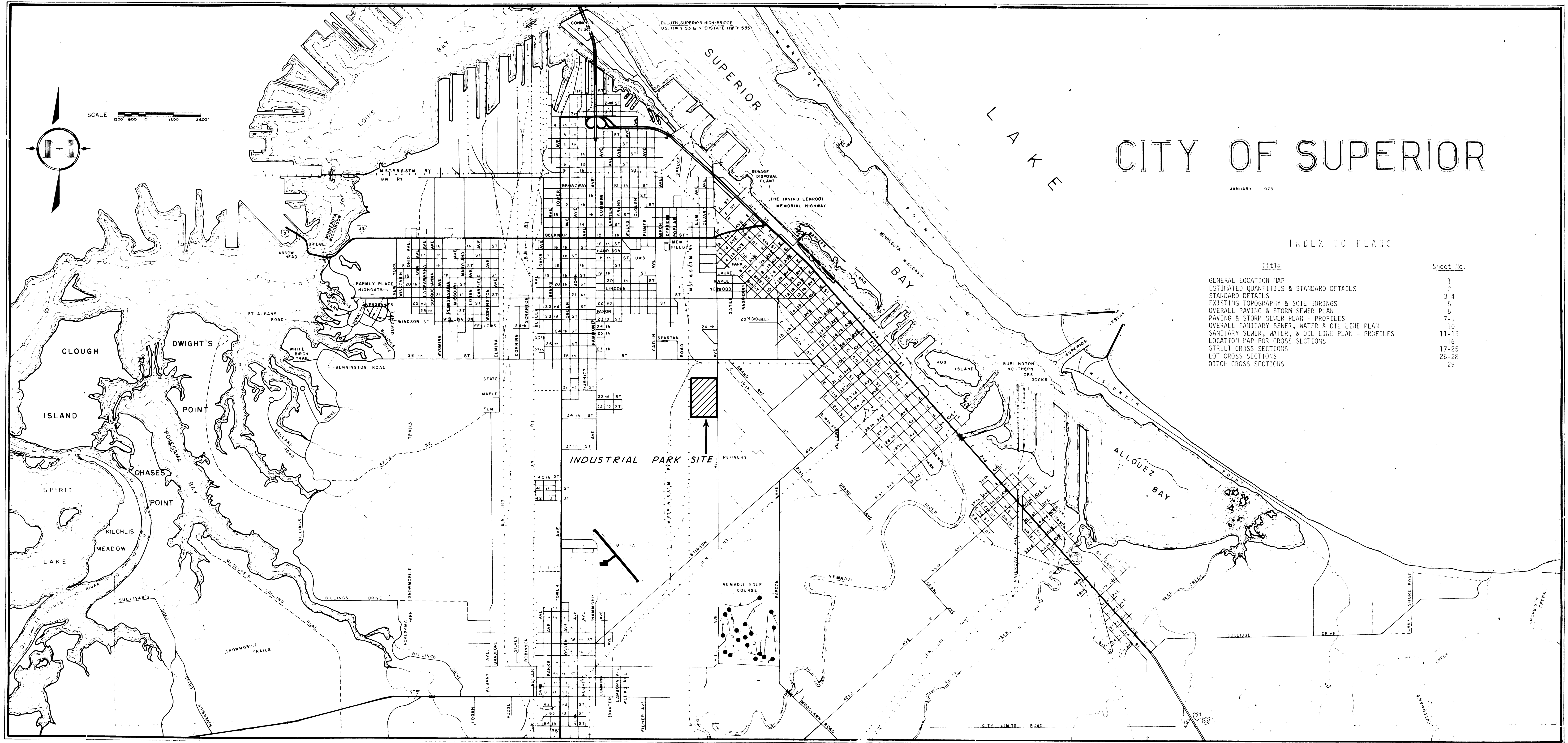

CITY OF SUPERIOR

JANUARY 1973

INDEX TO PLANS

| Title | Sheet No. |
|---|-----------|
| GENERAL LOCATION MAP | 1 |
| ESTIMATED QUANTITIES & STANDARD DETAILS | 2 |
| STANDARD DETAILS | 3-4 |
| EXISTING TOPOGRAPHY & SOIL BORINGS | 5 |
| OVERALL PAVING & STORM SEWER PLAN | 6 |
| PAVING & STORM SEWER PLAN - PROFILES | 7-9 |
| OVERALL SANITARY SEWER, WATER & OIL LINE PLAN | 10 |
| SANITARY SEWER, WATER, & OIL LINE PLAN - PROFILES | 11-15 |
| LOCATION MAP FOR CROSS SECTIONS | 16 |
| STREET CROSS SECTIONS | 17-25 |
| LOT CROSS SECTIONS | 26-28 |
| DITCH CROSS SECTIONS | 29 |

40 50 100 200 400 800 1600 3200

GENERAL LOCATION MAP

SUPERIOR INDUSTRIAL PARK

ROBERT R. WALLACE & ASSOC., INC.
 HIBBING, MINNESOTA

PRJ. NO. EDA 06-01-01127