

HILL AVE.
LOOKING SOUTH

HILL AVE.
LOOKING SOUTH

30 25 20 15 10 5E 0 5W 10 15 20 25 30 30 25 20 15 10 5E 0 5W 10 15 20 25 30 35

FINAL SURVEY
BY _____ DATE _____
SURVEYED _____
PLOTTED _____
NOTE BOOK _____
AREAS CHECKED _____

ORIGINAL SURVEY
BY _____ DATE _____
SURVEYED _____
PLOTTED _____
NOTE BOOK _____
AREAS CHECKED _____

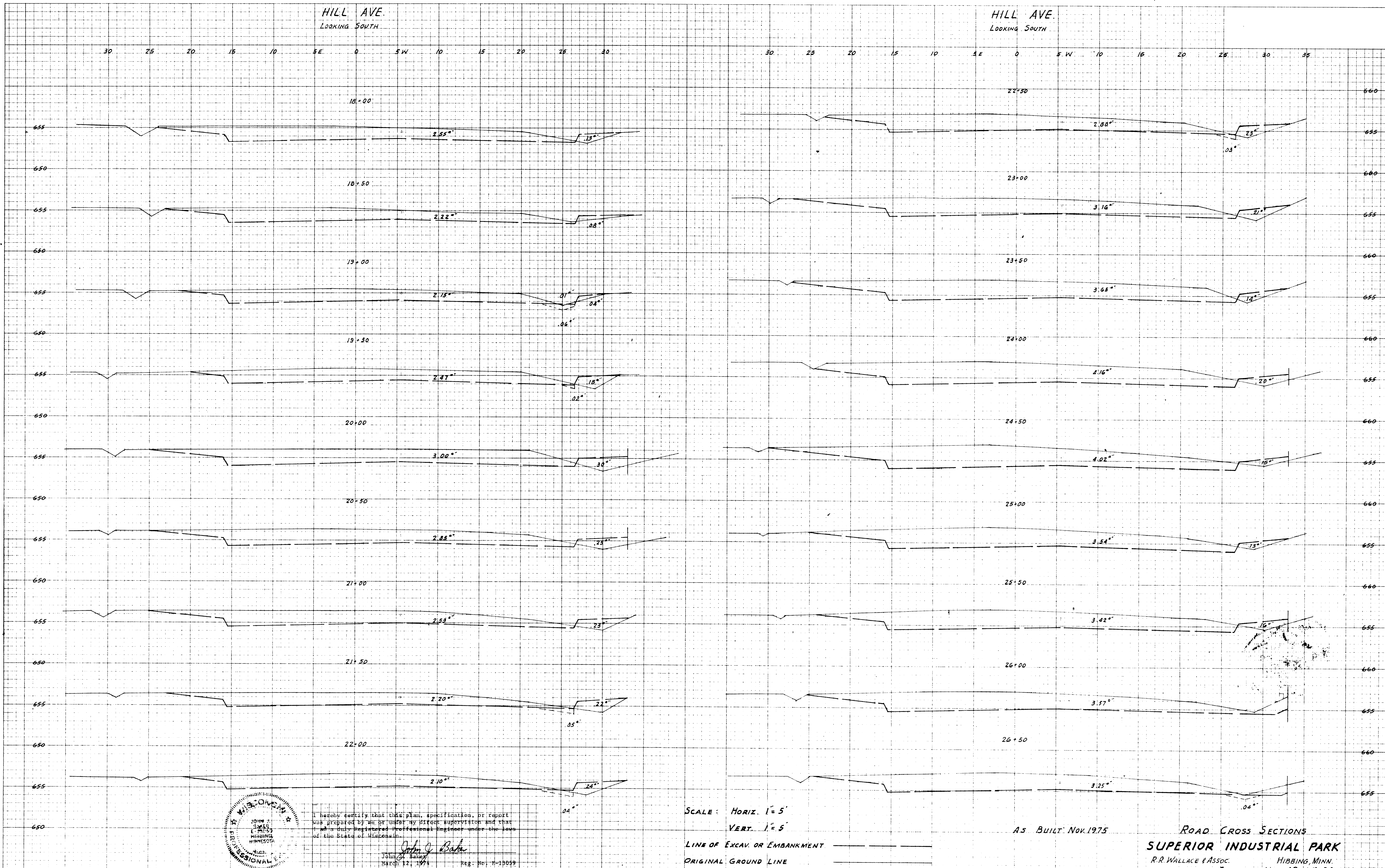

I hereby certify that this plan, specification, or report was prepared by me or under my direct supervision and that I am a duly registered Professional Engineer under the laws of the State of Minnesota.
John J. Baker
John J. Baker
March 12, 1974 Reg. No. H-10039

SCALE: HORIZ. 1" = 5'
VERT. 1" = 5'
LINE OF EXCAV. OR EMBANKMENT _____
ORIGINAL GROUND LINE _____

A5 BUILT Nov. 1975
ROAD CROSS SECTIONS
SUPERIOR INDUSTRIAL PARK
R.R. WALLACE & ASSOC. HIBBING, MINN.
SHEET No. 19 OF 29