

DATE	
BY	
CHECKED	
PLANNED	
DESIGNED	
DRAWN	
NO.	

DATE	
BY	
CHECKED	
PLANNED	
DESIGNED	
DRAWN	
NO.	

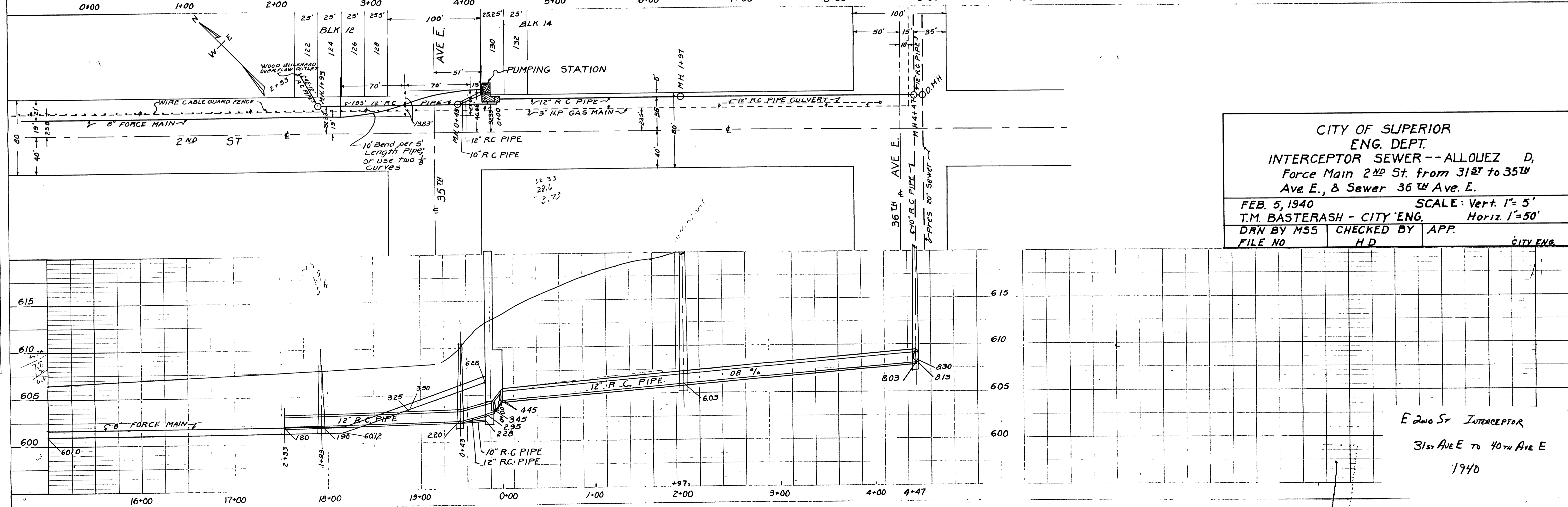
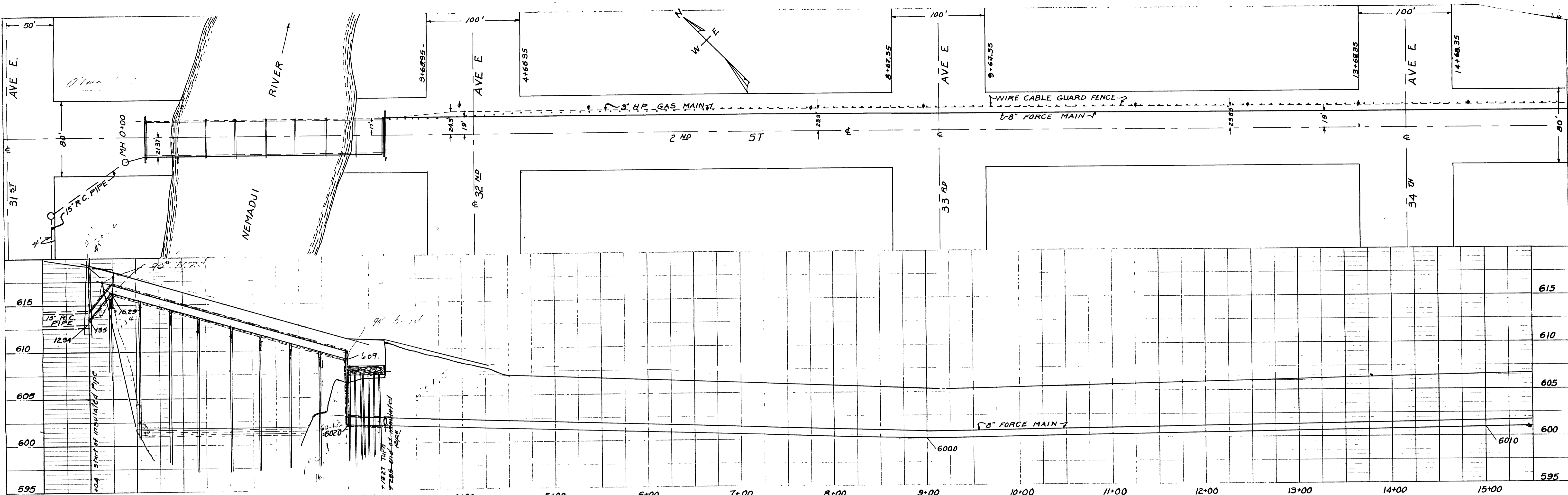

**CITY OF SUPERIOR
ENG. DEPT.
INTERCEPTOR SEWER -- ALLOUÉZ D,
Force Main 2ND St. from 31ST to 35TH
Ave. E., & Sewer 36TH Ave. E.**

FEB. 5, 1940		SCALE: Vert. 1"= 5'
T.M. BASTERASH - CITY ENG.		Horiz. 1"=50'
DRN BY MSS	CHECKED BY APP.	
FILE NO	H.D.	CITY ENG.

E 2ND St INTERCEPTOR
31ST Ave E TO 40TH Ave E
1940

PLATE 2-PLAN-PROFILE 6 P R STANDARD
LUGER DITZEN CO. CHGO. ILL.

SECTION D, D-10