

LAUREL AVE.

AVE.

20	21	22	23	24
10+79	10+44	10+19	9+94	9+77
10+68	10+42	10+17	9+92	9+75
10+68	10+42	10+17	9+92	9+75

AVE.

1	2	3	4	5	6	7	8	9
8+84	8+60	8+35	8+10	7+65	7+60	7+35	7+10	6+95
8+84	8+60	8+35	8+10	7+65	7+60	7+35	7+10	6+95
8+84	8+60	8+35	8+10	7+65	7+60	7+35	7+10	6+95

1	2	3	4	5	6	7	8	9	10	11	12	13	14	15	16	17
8+87	8+63	8+38	8+13	7+68	7+63	7+38	7+13	6+92	6+72	6+57	6+32	6+07	5+82	5+57	5+32	5+07
8+87	8+63	8+38	8+13	7+68	7+63	7+38	7+13	6+92	6+72	6+57	6+32	6+07	5+82	5+57	5+32	5+07
8+87	8+63	8+38	8+13	7+68	7+63	7+38	7+13	6+92	6+72	6+57	6+32	6+07	5+82	5+57	5+32	5+07

CONTRACT No 1512.
 CONTRACT LET..... APR. 26th 1916
 CONTRACT COMPLETED..... MAY 15th 1916
 J. Sutherland & Forsee..... CONTRACTORS
 J. Graham..... INSPECTOR
 E. B. Banks..... CITY ENGINEER.

CONTRACT No 1068
 Contract let..... April 20, 1908.
 Contract completed..... Sept. 10, 1908.
 Anderson & Johnson Co..... Contractors.
 Andrew Solin..... Inspector.
 E. B. Banks..... City Engineer.

CITY OF SUPERIOR
SEWER PLAN

Horizontal Scale : 1 in = 60 ft.
 Vertical Scale : 1 in = 4 ft.

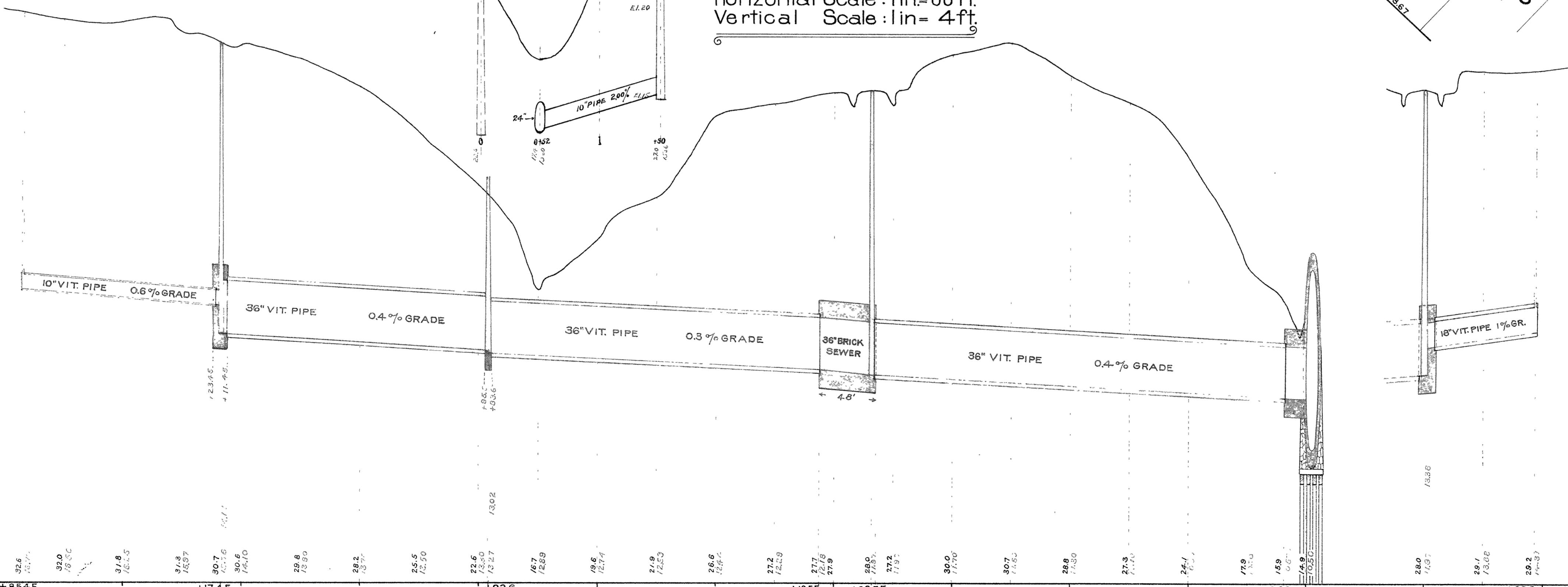

Sewer in the Alley between Laurel & Maple Ave, in L St. and in the Alley between W. 8th. & W. 9th. St. from a point 125 feet west of Gates Ave. and from a point 57 feet S. E. of L St. to K St. Sewer: