

Note:
Dec. 31ST 1937 - Excavated for
Elevation of Water Main on 21ST
Street: Top 29.98 at point 22'
East of $\frac{1}{2}$ of Hill Ave.

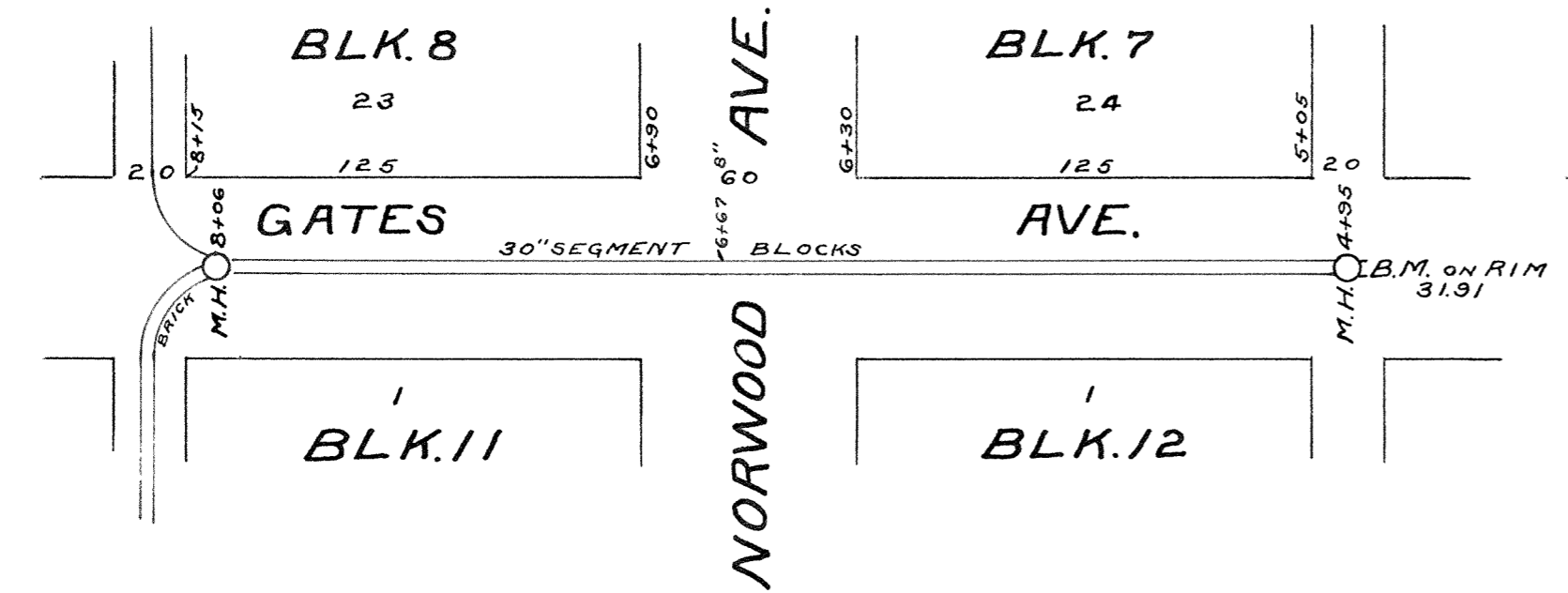

MAP AND PROFILE
SHOWING EXTENSION OF THE GATES AVE.
MAIN SEWER TOGETHER WITH LATERAL
SEWERS IN THE ALLEY BETWEEN NORWOOD
AVE & RITCHIE AVE. FROM RASPBERRY AVE.
TO HILL AVE.

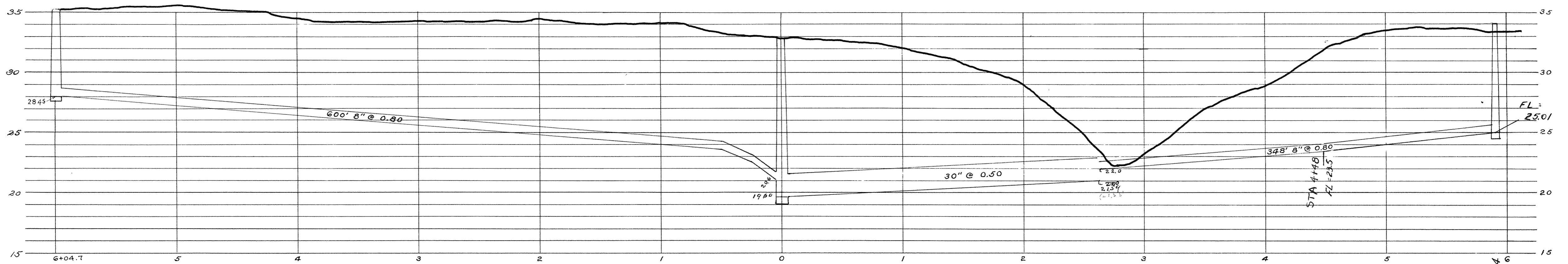
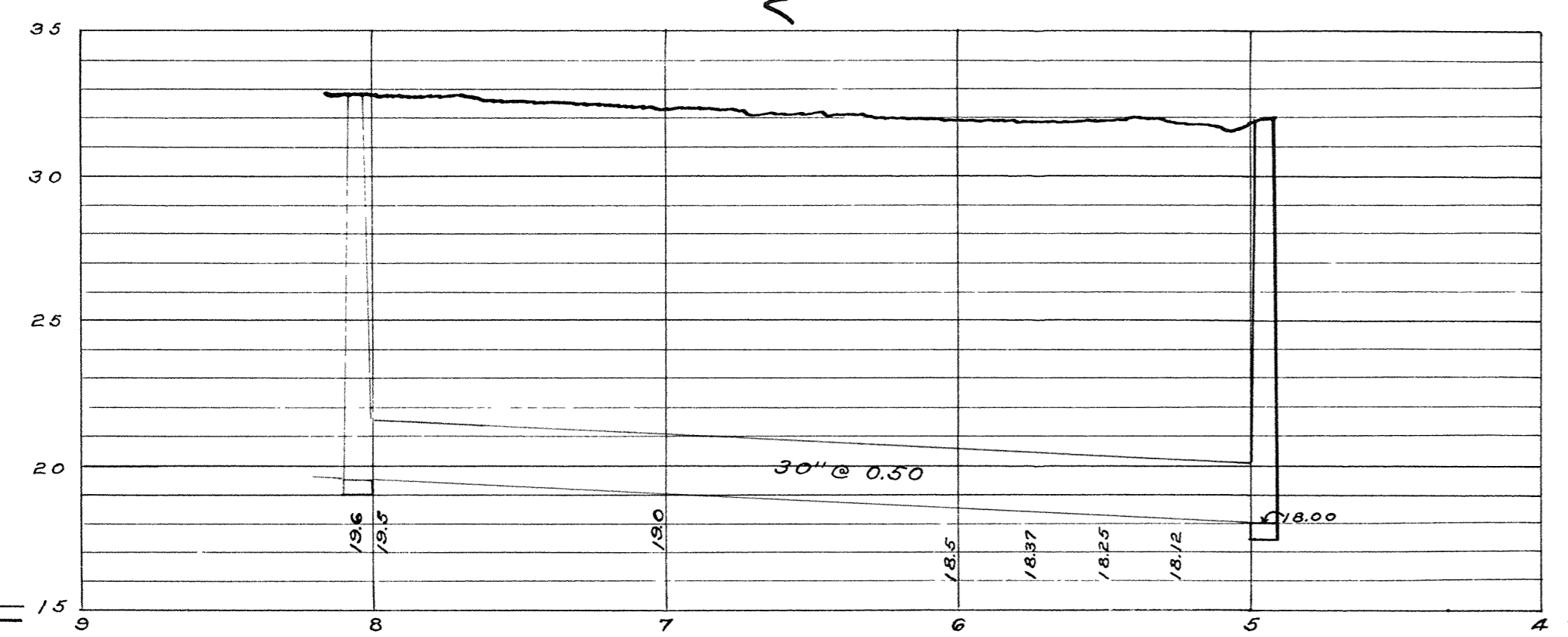

HORIZONTAL SCALE: 1 IN = 50 FT. THE PORTION OF THIS
VERTICAL SCALE: 1 IN = 5 FT. SEWER FROM STA 4+48
CONTRACT No. 1644 TO STA 5+91.4 WAS
CONTRACT LET NOV. 29TH 1921 BUILT IN NOV. 1950 BY
CONTRACT COMPLETED DEC. 15TH 1921 THE BUILDERS
CONTRACTOR CITY OF SUPERIOR SUPPLY CO.
INSPECTORS ANDERSON & STEFFENSON
E.B. BANKS CITY ENGINEER

3A-30