

DATE  
BY  
W.H.W.  
CHECKED  
NO.

PROFILE  
SURVEYED  
M.S. BARNES  
P.L.O.T.T.E.D.  
W.H. WILLIAMS  
NOTE COPY  
NO.

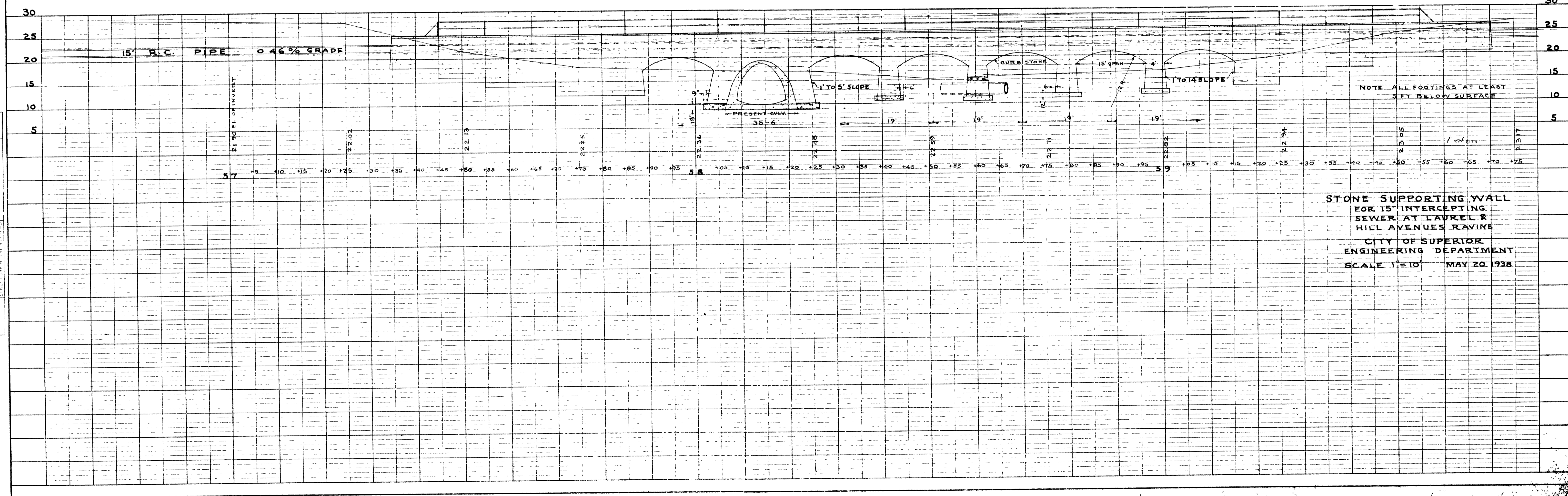
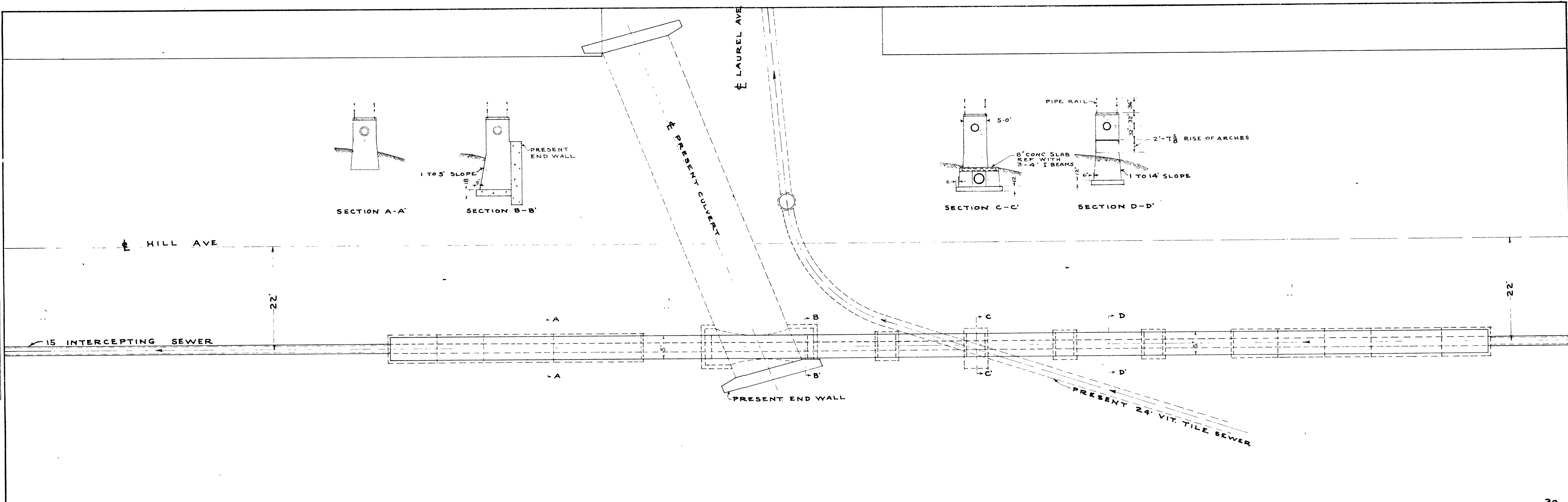

STONE SUPPORTING WALL  
FOR 15" INTERCEPTING  
SEWER AT LAUREL &  
HILL AVENUES RAVINE  
CITY OF SUPERIOR  
ENGINEERING DEPARTMENT  
SCALE 1"=10' MAY 20, 1938