

Index of Sheets

Sheet No.	1	Title
Sheet No.	2-2.19	Typical Sections and Details
Sheet No.	3-3.5	Estimate of Quantities
Sheet No.	3A-3H	Miscellaneous Quantities
Sheet No.	4-4.5	Right of Way Plat
Sheet No.	5-5.25	Plan and Profile
Sheet No.	6-6.33	Standard Detail Drawings
Sheet No.	-	Standard Sign Plates
Sheet No.	8-8.19	Structure Plans
Sheet No.	-	Computer Earthwork Data
Sheet No.	9-9.67	Cross Sections

TOTAL SHEETS = 189

STATE OF WISCONSIN DEPARTMENT OF TRANSPORTATION

PLAN OF PROPOSED IMPROVEMENT

EAST 2nd STREET
CITY OF SUPERIOR
U.S.H. 2 & 53

EAST 2nd STREET OVERHEAD
CITY OF SUPERIOR
U.S.H. 2 & 53

I.H. 535 - U.S.H. 2
("E" STREET - SECOND AVE. E.)
CITY OF SUPERIOR
U.S.H. 53

STATE PROJECT	FEDERAL PROJECT	
	PROJECT	CONTRACT
1190-07-71	MAF 018(45)	1
1190-07-72	MAF 018(45)	
1190-10-71	BRF 018(40)	
1190-12-72	MAF 018(45)	

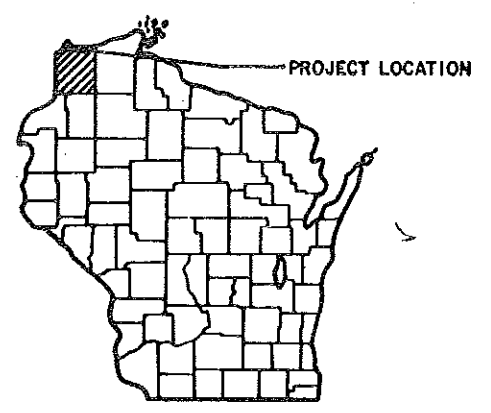

STATE PROJECT NUMBERS		
1190-07-71 & 72	1190-10-71	1190-12-72

STA. 113A+09.76
END PROJECT 1190-12-72 AND
BEGIN PROJECT 1190-07-71.72
STA. 85+98
N 574,000 ±100'
E 1,480,900 ±100'

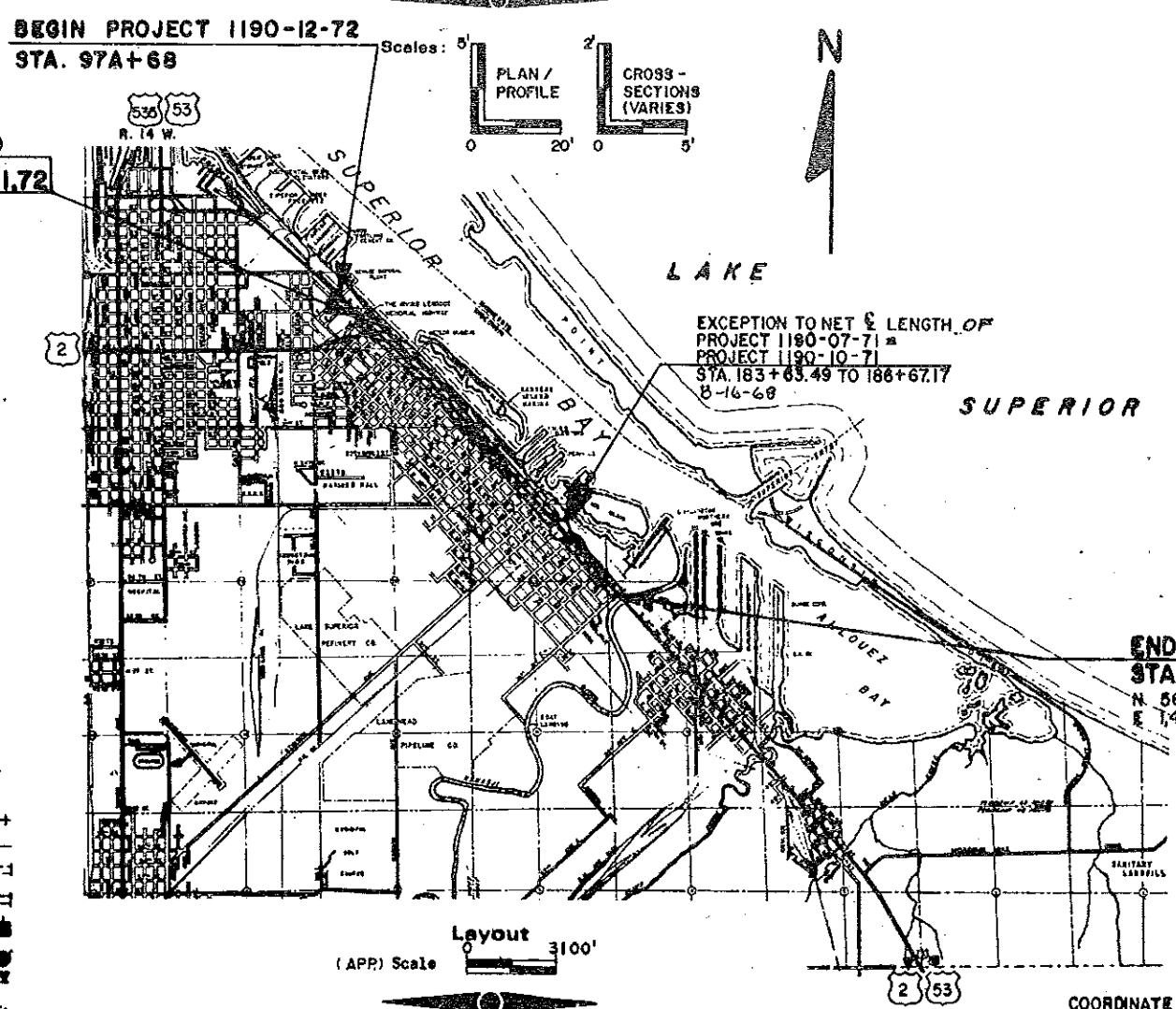

Design Designation

A.D.T. (1989)	=	19,490
A.D.T. (2009)	=	28,760
D.H.V. (2009)	=	2,781
D.	=	60/40
T.	=	7%
V.	=	40 M.P.H.
DESIGN CLASS	=	8-3

Conventional Signs

County Line	-----	Caution Symbol (Combustible fluids under pressure)	
Township or Range Line	-----	Railroads	
Section Line	-----	Fence	
Corporate or City Limits	-----	Culverts in Place	
Property line	-----	Culverts Required	
Lot Line	-----	Power Pole	
Existing Right of Way Line	-----	Telephone or Telegraph Pole	
New Right of Way Line	-----	Right of Way Markers	
Base or Survey Line	-----	Marsh	
Slope Intercept	-----	Wooded Area	
Existing Roadway or Private Entrance	-----	Grade Elevation	

Layout (APP) Scale 1" = 3100'

Total Net Length of Centerline - 2.765 Mi.	
1190-07-71	= 2.418 Mi.
1190-07-72	= 0.00 Mi.
1190-12-72	= 0.291 Mi.
TOTAL	2.707 Mi.
1190-10-71	= 0.057 Mi.

COORDINATE NOTE:
ALL COORDINATES ARE REFERENCED TO THE WISCONSIN COORDINATE SYSTEM CENTRAL ZONE AND SCALED FROM U.S.G.S. TOPOGRAPHIC MAP SUPERIOR, WI., 1983, 7.5 MINUTE WISCONSIN QUADRANGLE FOR IDENTIFICATION ONLY.

APPROVED FOR CITY OF SUPERIOR
10-7-88 DATE
Sam M. Peterson
DIRECTOR OF PUBLIC WORKS



10/21/88 DATE
STATE OF WISCONSIN DEPARTMENT OF TRANSPORTATION
Surveyor _____ District Checker _____
Designer _____ C. O. Checker *PLA*
District Supervisor _____ C. O. Coordinator _____

Approved: _____
Date 10-7-88 *Greg Pietie*
District Transportation Director
Approved: _____
Date 11-1-88 *W.P.*
State Traffic Engineer
Approved: _____
Date 11/8/88 *R.W. Ross*
State Design Engineer

U.S. DEPARTMENT OF TRANSPORTATION
FEDERAL HIGHWAY ADMINISTRATION
REGION 5 WISCONSIN DIVISION
Approved: _____
Date _____
Division Administrator

10-12-72

STORM SEWER SCHEDULE

NO.	STATION	LOCATION	TYPE & COVER	TOP OF MANHOLE	GRATE ELEV.	DISCH. ELEV.	D" BOX DEPTH	P.U.D. ELEV.	REINFORCED CONCRETE PIPE SIZE					APPROX. END-WALL CLASS	DRAINS TO		REMARKS	
									12"	15"	18"	24"	30"		60"	NO.		GRADE EXIST.
101	89+28	CENTERLINE	EXIST.	625.67	---	620.60	---	---	---	---	---	---	---	---	100	EXIST.	621.20	ADJUST
101A	89+28	36.42' LT.	3-H	---	624.14	621.35	2.46	621.85	---	---	---	---	---	---	101	0.44	621.20	CONN. TO EXIST. MH 101
101B	89+28	27.50' RT.	3-H	---	624.46	621.42	2.66	622.17	---	---	---	---	---	---	101	0.88	621.20	CONN. TO EXIST. MH 101
EW	89+28	50.50' RT.	---	---	---	622.82	---	---	---	---	---	---	---	---	101B	5.92	621.52	CLASS III PIPE
102	92+52	31.00' LT.	EXIST.	624.49	---	620.89	---	---	---	---	---	---	---	---	EXIST	12"	EAST	ADJUST
102A	91+82.30	39.50' LT.	3-H	---	624.05	621.17	2.50	621.76	---	---	---	---	---	---	102	0.39	620.89	ADJUST
103	93+68	37.00' LT.	EXIST.	---	623.70	621.53	2.20	621.78	---	---	---	---	---	---	---	---	---	ADJUST
103A	93+42	27.50' RT.	3-H	---	---	---	---	---	---	---	---	---	---	---	---	---	---	CONNECT TO EXIST. 12"
104	96+12	37.00' LT.	EXIST.	---	---	---	---	---	---	---	---	---	---	---	---	---	---	ADJUST
104A	96+09	39.50' LT.	3-H	---	621.62	617.55	3.69	619.33	---	---	---	---	---	---	104	12.00	617.07	CSPSS
104B	96+12	27.50' RT.	3-H	---	621.97	617.93	3.66	619.68	---	---	---	---	---	---	104	2.40	616.44	ADJUST
105	99+67.50	33.00' LT.	1-J	619.60	---	611.65	6.99	---	---	---	---	---	---	---	105	11.25	610.11	ADJUST
105A	99+67.50	39.50' LT.	3-H	---	619.35	615.31	3.66	617.06	---	---	---	---	---	---	105	4.48	614.86	ADJUST
105B	99+67.50	27.50' RT.	3-H	---	619.75	615.71	3.66	617.46	---	---	---	---	---	---	105	0.36	611.65	ADJUST
106	102+98	33.00' LT.	1-J	618.92	---	612.84	5.12	---	---	---	---	---	---	---	106	16.00	614.04	ADJUST
106A	102+98	39.50' LT.	3-H	---	618.72	614.68	3.66	616.43	---	---	---	---	---	---	106	1.79	614.04	ADJUST
106B	102+98	27.50' RT.	3-H	---	619.12	615.08	3.66	616.83	---	---	---	---	---	---	106	1.07	613.24	ADJUST
107	104+23	33.00' LT.	1-J	620.04	---	618.83	615.79	3.66	617.54	---	---	---	---	---	107	11.25	615.34	ADJUST
107A	104+23	39.50' LT.	3-H	---	620.23	616.19	3.66	617.94	---	---	---	---	---	---	107	0.62	614.54	ADJUST
107B	104+23	27.50' RT.	3-H	---	620.37	616.62	6.08	---	---	---	---	---	---	---	107	1.47	615.34	ADJUST
108	107+62	33.00' LT.	1-J	623.70	---	623.53	619.07	4.08	620.85	---	---	---	---	---	108	18.00	618.35	ADJUST
108A	107+62	39.50' LT.	3-H	---	624.18	620.64	3.16	---	---	---	---	---	---	---	108	1.49	618.15	ADJUST
109	107+62	28.00' RT.	1-J	624.00	---	619.00	3.94	---	---	---	---	---	---	---	108	0.67	620.42	ADJUST
109A	107+27	54.50' RT.	3-H	---	624.28	620.22	3.66	---	---	---	---	---	---	---	109	4.43	619.20	ADJUST
109B	107+62	54.50' RT.	3-H	---	623.97	619.93	3.66	621.68	---	---	---	---	---	---	109	3.04	619.20	ADJUST
109C	107+89	27.50' RT.	3-H	---	623.97	619.93	3.66	621.68	---	---	---	---	---	---	109	0.62	617.02	ADJUST
110	111+28	33.00' LT.	1-J	624.93	---	619.25	4.64	---	---	---	---	---	---	---	110	1.40	619.45	ADJUST
111	111+28	28.00' RT.	1-J	625.25	---	620.25	3.94	---	---	---	---	---	---	---	111	1.27	621.65	ADJUST
111A	110+93	54.50' RT.	3-H	---	625.61	622.07	3.16	---	---	---	---	---	---	---	111	4.35	620.45	ADJUST
111B	111+28	54.50' RT.	3-H	---	625.66	621.45	3.83	---	---	---	---	---	---	---	111	2.88	620.45	ADJUST
111C	111+55	27.50' RT.	3-H	---	625.18	621.14	3.66	622.89	---	---	---	---	---	---	111	1.06	619.25	ADJUST
EW	111+28	74.00' RT.	---	---	---	625.20	---	---	---	---	---	---	---	---	---	---	---	ADJUST
112	111+94	33.00' LT.	1-J	625.16	---	619.91	4.21	---	---	---	---	---	---	---	112	1.63	620.31	ADJUST
112A	111+94	51.50' LT.	3-H	---	624.61	620.57	3.66	622.32	---	---	---	---	---	---	112	3.68	616.84	ADJUST
113	114+59.50	93.00' RT.	1-B	---	626.59	623.61	2.50	---	---	---	---	---	---	---	112	0.53	615.39	ADJUST
EW	114+59.50	98.00' LT.	---	---	---	---	---	---	---	---	---	---	---	---	---	---	---	ADJUST
114	118+26	26.00' LT.	1-J	624.00	---	618.33	4.61	---	---	---	---	---	---	---	112	0.53	615.39	ADJUST
114A	118+91.43	28.41' LT.	3-H	---	623.58	619.54	3.66	621.29	---	---	---	---	---	---	112	0.53	615.39	ADJUST
EW	118+26	114.00' LT.	---	---	---	611.38	---	---	---	---	---	---	---	---	---	---	---	ADJUST
115	118+26	28.13' RT.	1-J	624.12	---	619.12	3.94	621.71	---	---	---	---	---	---	114	1.56	618.54	ADJUST
115A	117+99	27.50' RT.	3-H	---	624.11	620.07	3.66	621.82	---	---	---	---	---	---	114	1.58	618.33	ADJUST
115B	118+88.90	29.11' RT.	3-H	---	623.80	619.76	3.66	621.51	---	---	---	---	---	---	115	3.13	619.32	ADJUST
115C	118+61	56.04' RT.	3-H	---	624.22	620.68	3.16	---	---	---	---	---	---	---	115	0.74	619.32	ADJUST
115D	118+26	54.50' RT.	3-H	---	624.27	620.14	3.75	---	---	---	---	---	---	---	115	1.03	620.34	ADJUST
116	122+35	27.50' RT.	3-H	---	622.13	617.28	4.50	619.84	---	---	---	---	---	---	115	3.57	619.32	ADJUST
116A	122+31	82.00' RT.	1-B	---	624.07	620.59	3.00	---	---	---	---	---	---	---	116	6.25	617.28	ADJUST
116B	122+03	84.00' RT.	1-B	---	624.07	620.59	3.00	---	---	---	---	---	---	---	116	1.04	620.80	ADJUST
116C	122+35	27.50' LT.	3-H	---	622.13	616.75	5.00	---	---	---	---	---	---	---	116	0.62	617.02	ADJUST
EW	122+32.6	112.00' LT.	---	---	---	608.86	---	---	---	---	---	---	---	---	---	---	---	ADJUST
117	126+11	27.50' RT.	3-H	---	620.51	618.66	4.50	618.29	---	---	---	---	---	---	116	0.62	617.02	ADJUST
117A	125+80	115.00' RT.	1-B	---	623.00	619.90	2.50	---	---	---	---	---	---	---	116	0.62	617.02	ADJUST
117B	126+08	113.00' RT.	1-B	---	622.90	619.42	4.00	---	---	---	---	---	---	---	117	1.04	619.62	ADJUST
117C	126+35	27.50' RT.	3-H	---	620.49	616.48	3.66	618.20	---	---	---	---	---	---	117	4.25	615.66	ADJUST
117D	126+11	27.50' LT.	3-H	---	620.51	615.38	4.80	618.22	---	---	---	---	---	---	117	2.95	615.86	ADJUST
117E	126+35	27.50' LT.	3-H	---	620.49	616.48	3.66	618.20	---	---	---	---	---	---	117	2.95	615.86	ADJUST
EW	126+11	92.50' LT.	---	---	---	614.85	---	---	---	---	---	---	---	---	---	---	---	ADJUST
118	130+09	36.00' LT.	5-J	625.31	---	610.06	14.50	---	---	---	---	---	---	---	118	3.68	619.56	ADJUST
118A	130+52	27.50' LT.	3-H	---	625.11	621.07	3.66	622.82	---	---	---	---	---	---	118	1.04	610.06	ADJUST
119	130+09	58.00' RT.	5-J	625.58	---	611.00	13.83	---	---	---	---	---	---	---	119	0.50	619.83	ADJUST
119A	129+63	27.50' RT.	3-H	---	624.13	620.09	3.66	---	---	---	---	---	---	---	119	2.48	619.83	ADJUST
119B	130+52	27.50' RT.	3-H	---	625.11	621.07	3.66	622.82	---	---	---	---	---	---	1200	1.00	622.73	ADJUST
120	134+63	27.50' RT.	3-H	---	626.22	622.91	2.98	623.93	---	---	---	---	---	---	1200	0.57	622.53	ADJUST
120A	134+63	27.50' LT.	3-H	---	626.22	622.91	2.98	623.93	---	---	---	---	---	---	1200	0.57	622.53	ADJUST
120B	134+84	27.50' LT.	3-H	---	626.11	622.23	3.50	623.82	---	---	---	---	---	---	1200	0.57	622.53	ADJUST
120C	134+84	106.00' RT.	1-B	---	628.00	624.83	2.50	---	---	---	---	---	---	---	1200	0.57	622.53	ADJUST
120D	134+84	27.50' RT.	3-H	---	626.11	622.53	3.20	623.82	---	---	---	---	---	---	1200	0.57	622.53	ADJUST
EW	134+84	54.50' LT.	---	---	---	622.07	---	---	---	---	---	---	---	---	---	---	---	ADJUST
121	140+57	47.00' RT.	1-J	630.90	---	623.50	---	---	---	---	---	---	---	---	1200	0.57	622.53	ADJUST
121A	140+43	147.00' RT.	1-B	---	631.85	628.25	2.50	---	---	---	---	---	---	---	1200	0.57	622.53	ADJUST
121B	140+57	27.50' RT.	3-H	---	630.10	624.72	5.00	627.81	---	---	---	---	---	---	121	1.58	626.70	CONN. TO EXIST. MH 121
121C	140+57	27.50' LT.	3-H	---	630.10	625.22	4.90	627.81	---	---	---	---	---	---	121	7.00	623.60	CONN. TO EXIST. MH 121
122	145+55	39.00' RT.	1-J	635.38	---	630.33	---	---	---	---	---	---	---	---	121B	0.94	623.60	ADJUST
122A	145+14	164.00' RT.	1-B	---	638.00	635.00	2.50	---	---	---	---	---	---	---	121B	0.94	623.60	ADJUST
122B	145+42	164.00' RT.	3-H	---	638.00	634.52	3.00	---	---	---	---	---	---	---	121B	0.94	623.60	ADJUST
122C	145+55	27.50' RT.	3-H	---	634.64	631.44	2.83	632.35	---	---	---	---	---	---	121B	0.94	623.60	ADJUST
122D	145+55	27.50' LT.	3-H	---	634.39	631.69	2.53	632.10	---	---	---	---	---	---	121B	0.94	623.60	ADJUST
123	155+12	32.50' RT.	3-H	---	632.54	630.42	1.58	---	---	---	---	---	---	---	121B	0.94	623.60	ADJUST
123A	155+25	50.00' RT.	1-B	---	633.11	630.78	2.00	---	---	---	---	---	---	---	121B	0.94	623.60	ADJUST
124	160+80	28.00' LT.	1-J	632.10	---	628.86	4.18	---	---	---	---	---	---	---	121B	0.94	623.60	ADJUST
124A	160+40																	

STORM SEWER SCHEDULE

NO.	STATION	LOCATION	TYPE & COVER	TOP OF MANHOLE	GRADE ELEV.	DISCH. ELEV.	"D" BOX DEPTH	P.U.D. ELEV.	REINFORCED CONCRETE PIPE SIZE					APRON END WALL CLASS	DRAINS TO			REMARKS
									12"	15"	18"	24"	30"		60"	NO.	GRADE	
135	195+19	24.00' LT.	1-J	632.65	--	625.86	--	--	--	--	--	--	IV	EXIST 12"	125	1.73	626.00	RECONSTRUCT
135A	195+14.50	59.50' RT.	3-H	--	632.01	627.39	4.24	--	80	--	--	--	IV	EXIST 12"	125	1.73	626.00	RECONSTRUCT
135B	195+49.50	59.50' RT.	3-H	--	632.01	627.97	3.66	--	33	--	--	--	IV	EXIST 12"	125	1.73	627.59	RECONSTRUCT
136	200+23	24.00' LT.	1-J	631.43	--	625.64	--	--	--	--	--	--	IV	EXIST 12"	125	1.73	627.59	RECONSTRUCT
136A	199+87	32.50' LT.	3-H	--	631.30	627.26	3.66	629.01	34	--	--	--	IV	EXIST 12"	125	1.73	627.59	RECONSTRUCT
136B	200+14	59.50' RT.	3-H	--	631.40	626.82	4.04	--	81	--	--	--	III	EXIST 12"	125	1.73	627.59	RECONSTRUCT
136C	200+49	59.50' RT.	3-H	--	631.44	627.40	3.66	--	33	--	--	--	IV	EXIST 12"	125	1.73	627.59	RECONSTRUCT
137	205+25	25.00' LT.	1-J	629.39	--	622.33	--	--	--	--	--	--	IV	EXIST 12"	125	1.73	627.59	RECONSTRUCT
137A	204+87.50	32.50' LT.	3-H	--	629.31	625.27	3.66	626.02	35	--	--	--	IV	EXIST 12"	125	1.73	627.59	RECONSTRUCT
137B	204+87.50	32.50' RT.	3-H	--	629.59	625.55	3.66	626.30	66	--	--	--	IV	EXIST 12"	125	1.73	627.59	RECONSTRUCT
137C	205+76.50	32.50' RT.	3-H	--	629.11	625.07	3.66	626.82	75	--	--	--	IV	EXIST 12"	125	1.73	627.59	RECONSTRUCT
138	209+48	32.50' RT.	3-H	--	625.47	621.43	3.66	622.03	63	--	--	--	IV	EXIST 12"	125	1.73	627.59	RECONSTRUCT
138A	209+48	32.50' LT.	3-H	--	625.19	620.65	4.16	621.75	20	--	--	--	IV	EXIST 12"	125	1.73	627.59	RECONSTRUCT
EW	209+48	59.50' LT.	--	--	--	619.64	--	--	20	--	--	--	IV	EXIST 12"	125	1.73	627.59	RECONSTRUCT
139	215+10	32.50' RT.	1-J	626.04	--	619.36	5.64	623.63	125	--	--	--	IV	EXIST 12"	125	1.73	627.59	RECONSTRUCT
139A	214+80	32.50' RT.	3-H	--	626.55	622.51	3.66	623.26	27	--	--	--	IV	EXIST 12"	125	1.73	627.59	RECONSTRUCT
139B	215+05.86	40.00' LT.	3-H	--	625.86	621.82	3.66	622.57	70	--	--	--	IV	EXIST 12"	125	1.73	627.59	RECONSTRUCT
139C	216+57.80	33.00' LT.	1-B	--	621.84	617.05	5.66	617.55	68	--	--	--	IV	EXIST 12"	125	1.73	627.59	RECONSTRUCT
139D	216+39.57	33.00' RT.	1-B	--	622.63	616.11	6.14	618.34	20	--	--	--	IV	EXIST 12"	125	1.73	627.59	RECONSTRUCT
139E	215+48.30	75.00' RT.	3-H	--	624.58	620.54	3.66	--	33	--	--	--	IV	EXIST 12"	125	1.73	627.59	RECONSTRUCT
139F	215+13.30	75.00' RT.	3-H	--	624.58	619.99	4.21	--	39	--	--	--	IV	EXIST 12"	125	1.73	627.59	RECONSTRUCT
EW	215+09	88.00' RT.	--	--	--	623.00	--	--	8	--	--	--	IV	EXIST 12"	125	1.73	627.59	RECONSTRUCT
EW	216+39.50	60.00' RT.	--	--	--	614.70	--	--	--	--	--	--	IV	EXIST 12"	125	1.73	627.59	RECONSTRUCT
164	155+10.50	28.00' LT.	5-J	632.79	--	619.40	12.64	629.75	1	--	--	--	IV	EXIST 12"	125	1.73	627.59	RECONSTRUCT
164A	155+10.50	32.50' LT.	3-H	--	631.54	628.17	3.00	629.75	1	--	--	--	IV	EXIST 12"	125	1.73	627.59	RECONSTRUCT
165	152+70.50	28.00' LT.	1-J	634.25	--	627.94	5.00	629.75	242	--	--	--	IV	EXIST 12"	125	1.73	627.59	RECONSTRUCT
166	150+28.50	28.00' LT.	1-J	635.60	--	629.95	4.34	633.03	240	--	--	--	IV	EXIST 12"	125	1.73	627.59	RECONSTRUCT
166A	149+80	37.50' LT.	3-H	--	635.34	632.23	3.75	633.03	36	--	--	--	IV	EXIST 12"	125	1.73	627.59	RECONSTRUCT
167	150+28.50	32.00' RT.	1-J	635.60	--	630.60	3.67	633.03	56	--	--	--	IV	EXIST 12"	125	1.73	627.59	RECONSTRUCT
167A	149+79	37.50' RT.	3-H	--	635.31	632.28	2.66	633.78	46	--	--	--	IV	EXIST 12"	125	1.73	627.59	RECONSTRUCT
167B	150+06	64.50' RT.	3-H	--	635.56	632.71	2.66	633.78	44	--	--	--	IV	EXIST 12"	125	1.73	627.59	RECONSTRUCT
167C	150+51	59.50' RT.	3-H	--	635.75	631.38	4.00	633.78	33	--	--	--	III	EXIST 12"	125	1.73	627.59	RECONSTRUCT
SUBTOTAL LINEAL FEET OF PIPE FOR THIS SHEET									811	652	145	0	0	0				
TOTAL LINEAL FEET OF PIPE FOR SHEET 1 AND 2									2814	2797	730	456	648	90				

STATE PROJECT NUMBER	SHEET NO.
1190-07-71,72	513
E. SECOND ST - U.S.H. 2	

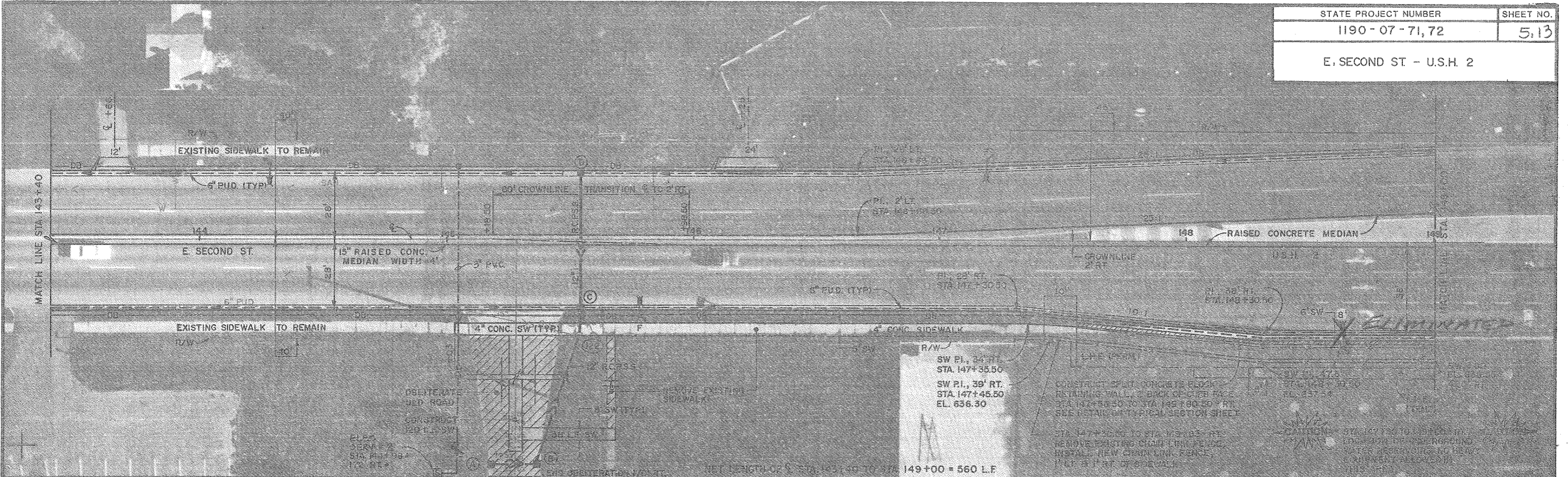

Station	Description	Left Side (ft)	Centerline (ft)	Right Side (ft)	Notes
634.02	FLAG EL. 26' LT.	34.31	34.51	34.71	80' CROWNLINE TRANSITION CENTERLINE TO 2' RT.
634.67	CENTERLINE	34.96	35.16	35.36	
633.92	FLAG EL. 26' RT.	34.18	34.38	34.58	
634.26	PAVEMENT 2' LT.	35.11	35.28	35.41	80' CROWNLINE TRANSITION CENTERLINE TO 2' RT.
634.76	CROWNLINE 2' RT.	35.70	35.98	36.11	
634.98	FLAG EL. 26' RT.	35.26	35.26	35.39	
635.02	FLAG EL. 26' LT.	35.61	35.76	35.86	STA. 146+50 TO STA. 149+00 LT. WARP PAV'T. CROSSFALL 2.5% TO 1.5%
635.12	PAVEMENT 2' LT.	35.88	36.12	36.27	
635.23	CROWNLINE 2' RT.	35.98	36.23	36.40	
635.27	PAVEMENT 2' LT.	35.88	36.27	36.43	STA. 147+00 TO STA. 149+00 RT. WARP PAV'T. CROSSFALL 3.0% TO 1.5%
635.36	CROWNLINE 2' RT.	35.98	36.36	36.46	
635.44	FLAG EL. 26' RT.	35.98	36.43	36.50	

E. SECOND ST - U.S.H. 2

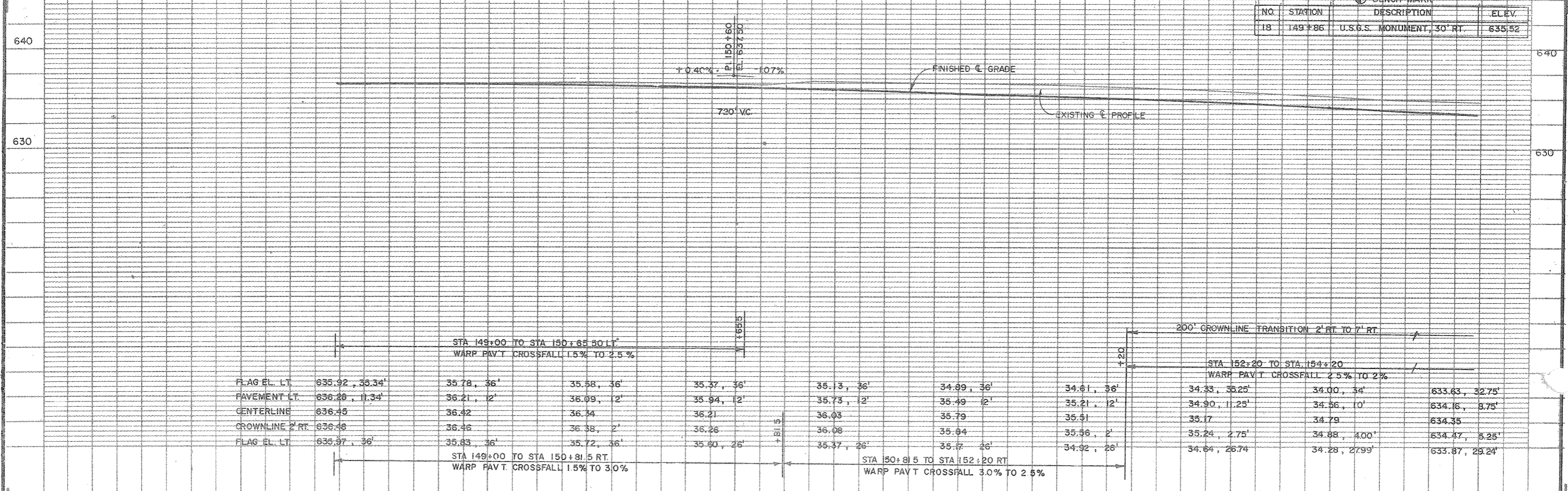
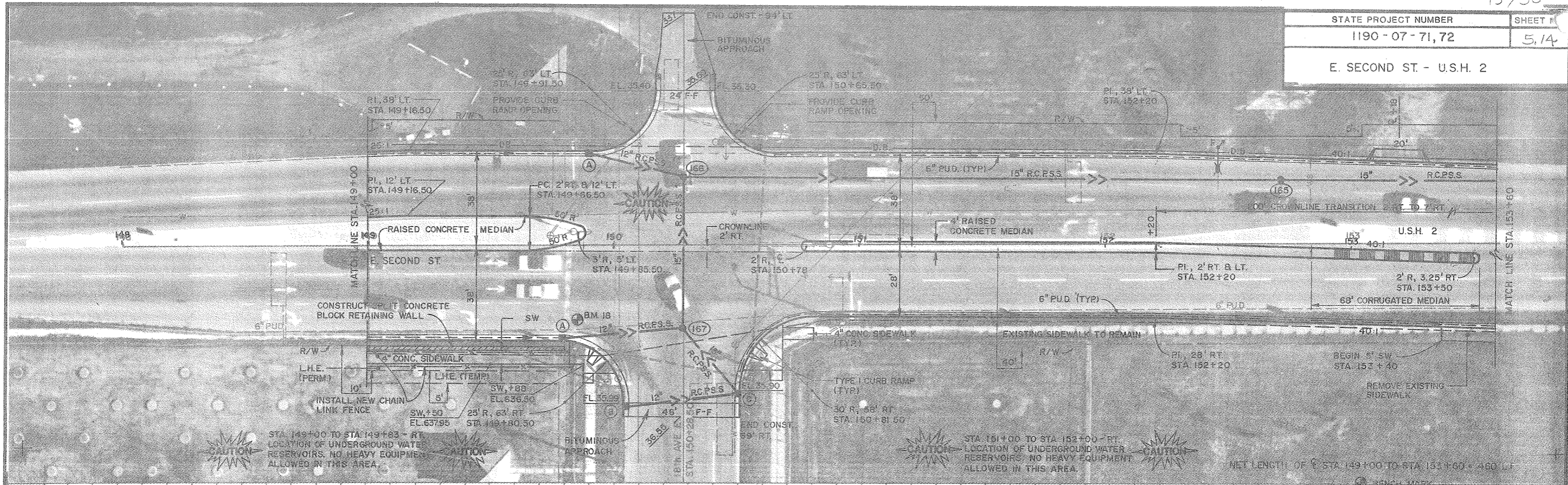

BENCH MARKS			
NO.	STATION	DESCRIPTION	ELEV.
1	100A+97	LIGHT POLE BASE 42' LT.	615.72
2	112A+04	BASE OF SIGN 54' LT.	623.32

STATE PROJECT NUMBER	SHEET NO.
1190-12-72	51
I535 - U.S.H. 2	

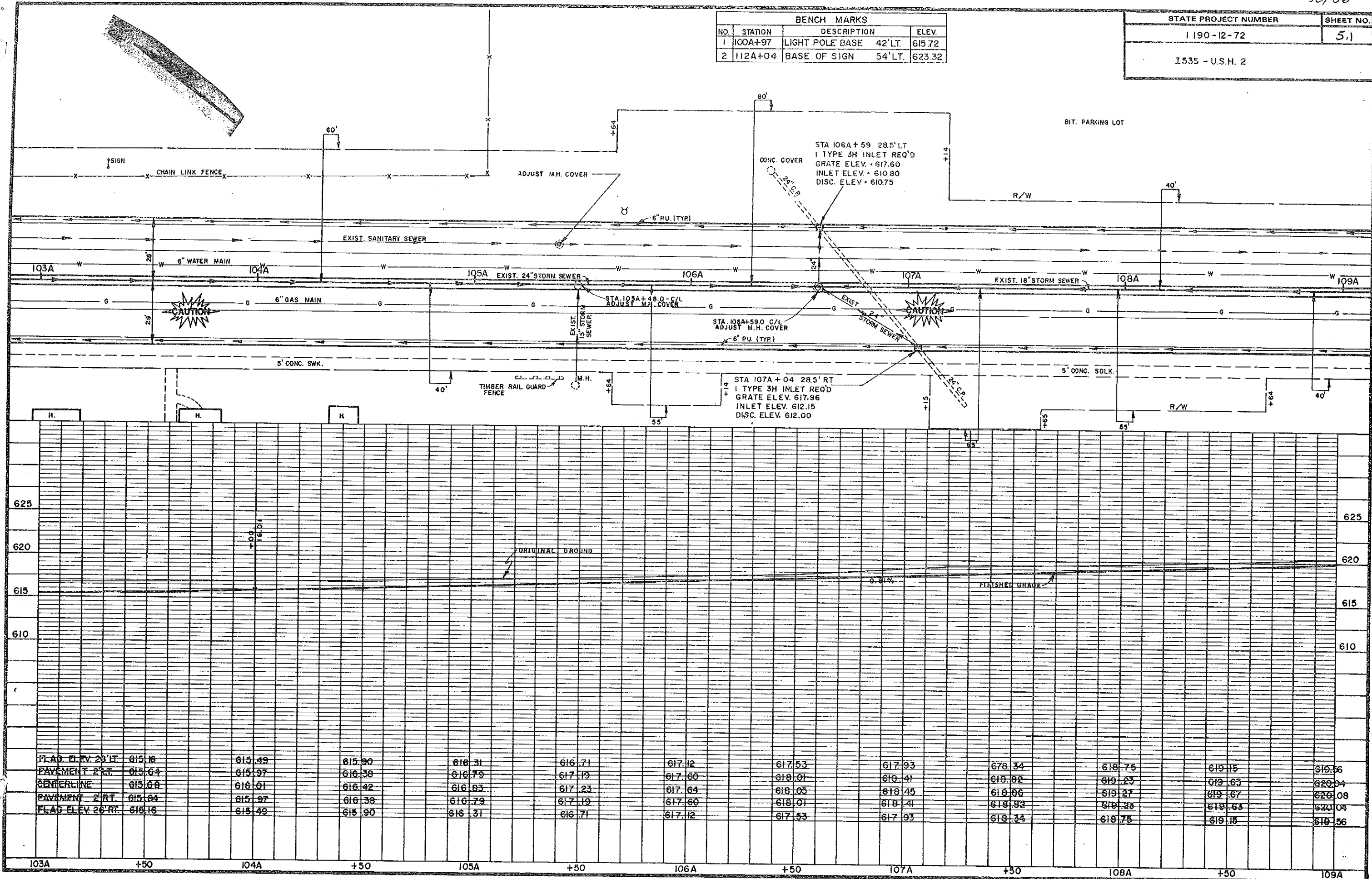

FLAG ELEV 23' RT.	615.18	615.49	615.90	616.31	616.71	617.12	617.53	617.93	618.34	618.75	619.15	619.56
PAYEMENT 2' RT.	615.64	615.97	616.38	616.79	617.19	617.60	618.01	618.41	618.82	619.23	619.63	620.04
CENTERLINE	615.68	616.01	616.42	616.83	617.23	617.64	618.05	618.45	618.86	619.27	619.67	620.08
PAYEMENT 2' RT.	615.64	615.97	616.38	616.79	617.19	617.60	618.01	618.41	618.82	619.23	619.63	620.04
FLAG ELEV 26' RT.	618.16	618.49	618.90	619.31	619.71	620.12	620.53	620.93	621.34	621.75	622.15	622.56

BENCH MARKS			
NO.	STATION	DESCRIPTION	ELEV.
2	112+04	BASE OF SIGN 5'4" LT.	623.32

STATE PROJECT NUMBER	SHEET NO.
1190-12-72	5.2
I 535 - U.S.H. 2	

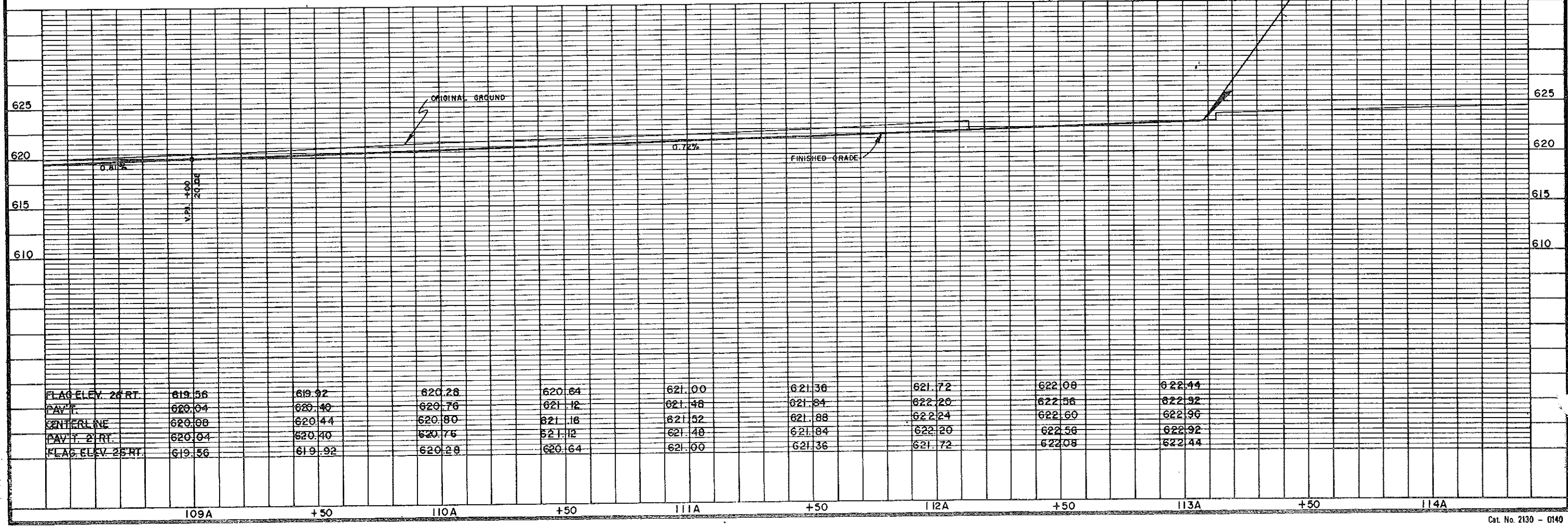
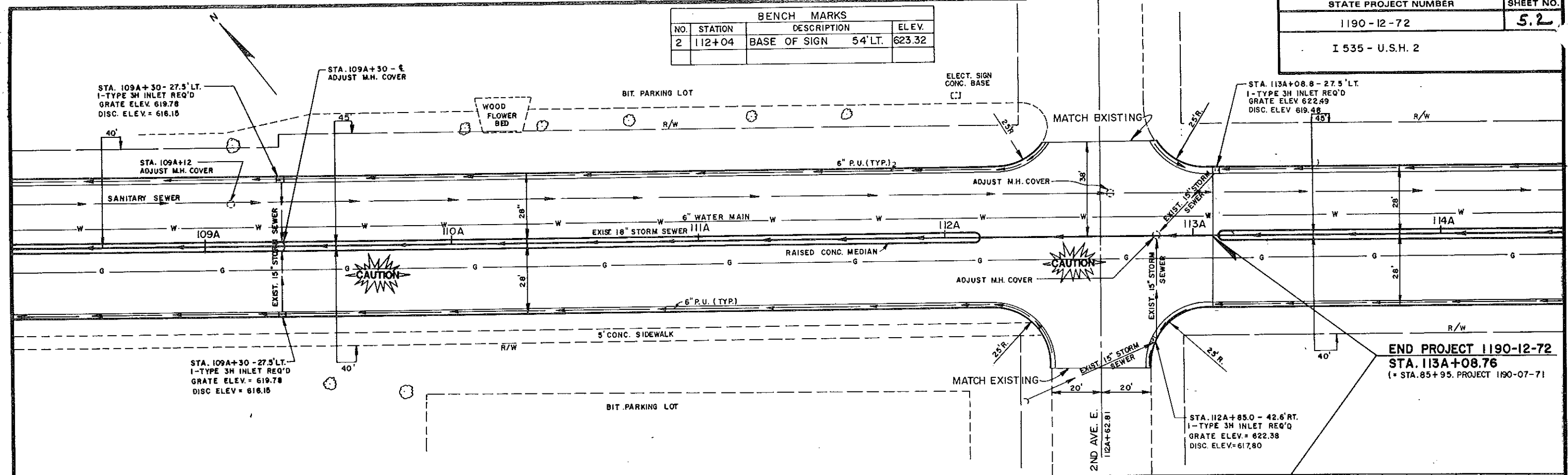

END PROJECT 1190-12-72
 STA. 113A+08.76
 (= STA. 85+95, PROJECT 1190-07-71)

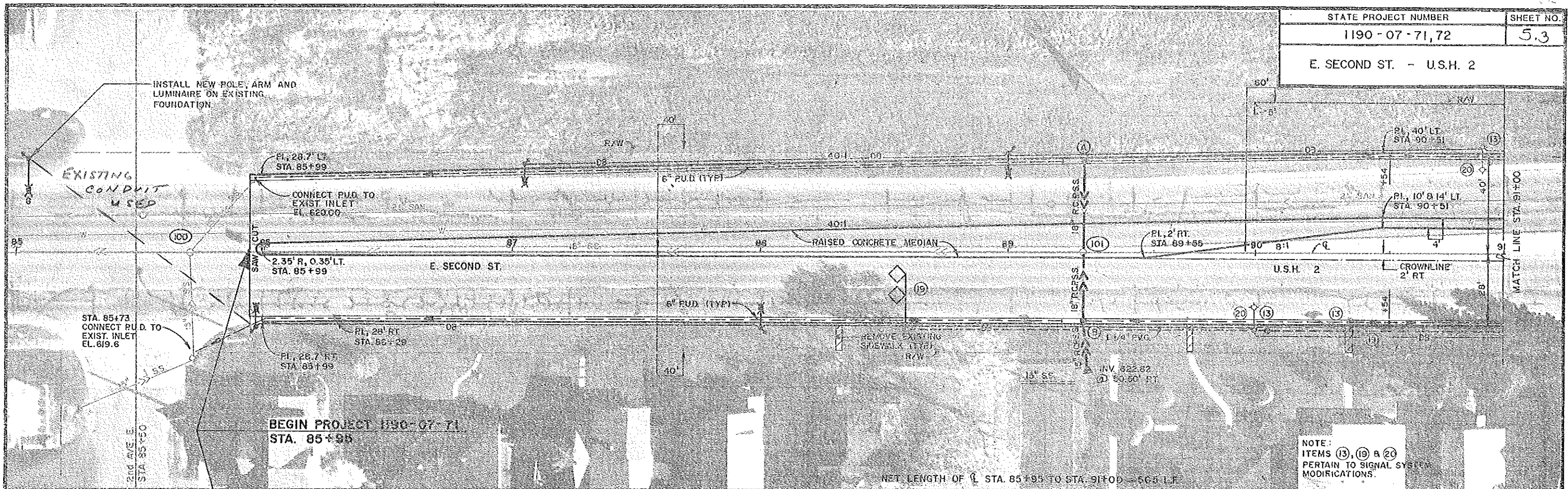

	85	86	87	88	89	90	91
FLAG EL. LT.	622.49, 26.73'	22.75, 27.98	23.01, 29.23'	23.34, 30.48'	23.67, 31.73'	24.20, 34.23'	24.43, 36.48'
PAVEMENT LT.	623.05, 2.73'	23.33, 3.98	23.61, 5.23'	23.94, 6.48'	24.27, 7.73'	24.80, 10.23'	25.03, 12.48'
CENTERLINE	623.06	23.40	23.74	24.10	24.46	25.06	25.37
CROWNLINE 2' RT	623.07	23.43	23.79	24.15	24.51	25.11	25.42
FLAG EL. 26' RT	622.51, 26.70'	22.85	23.19	23.56	23.91	24.24	24.51

STATE PROJECT NUMBER	SHEET NO.
1190-07-71, 72	54
E. SECOND ST. - U.S.H. 2	

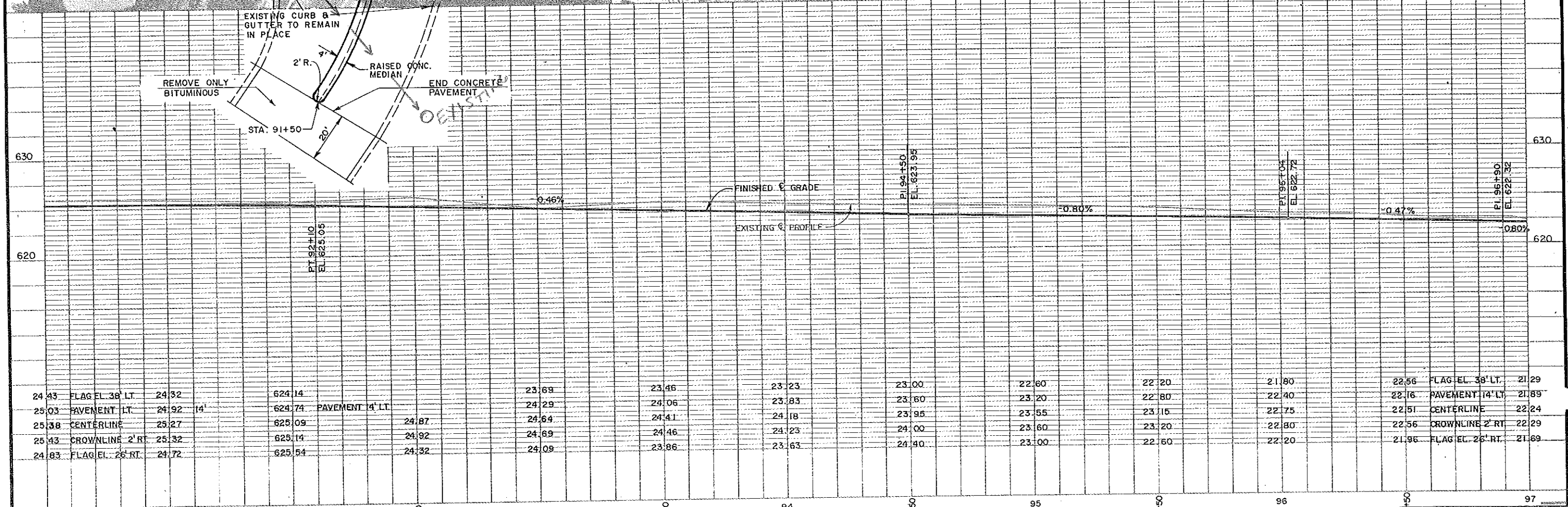
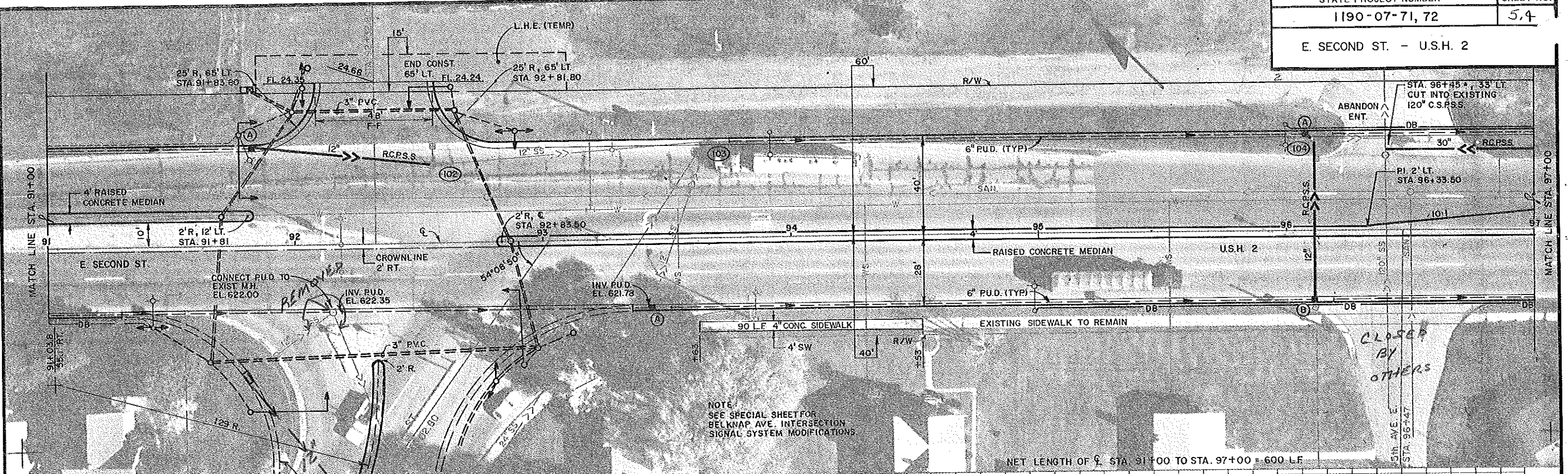

24.43	FLAG EL. 38' LT.	24.32	624.14	23.69	23.46	23.23	23.00	22.60	22.20	21.80	22.56	FLAG EL. 38' LT.	21.29
25.03	PAVEMENT 14' LT.	24.92	624.74	24.29	24.06	23.83	23.60	23.20	22.80	22.40	22.16	PAVEMENT 14' LT.	21.89
25.38	CENTERLINE	25.27	625.09	24.87	24.64	24.41	24.18	23.95	23.55	23.15	22.75	CENTERLINE	22.24
25.43	CROWNLIN 2' RT.	25.32	625.14	24.92	24.69	24.46	24.23	24.00	23.60	23.20	22.80	CROWNLIN 2' RT.	22.29
24.83	FLAG EL. 26' RT.	24.72	625.54	24.32	24.09	23.86	23.63	24.40	23.00	22.60	21.96	FLAG EL. 26' RT.	21.69

NOTE:
SEE SPECIAL SHEET FOR
BELKNAP AVE. INTERSECTION
SIGNAL SYSTEM MODIFICATIONS

NET LENGTH OF STA. 91+00 TO STA. 97+00 = 600 LF

CLOSED
BY
OTHERS

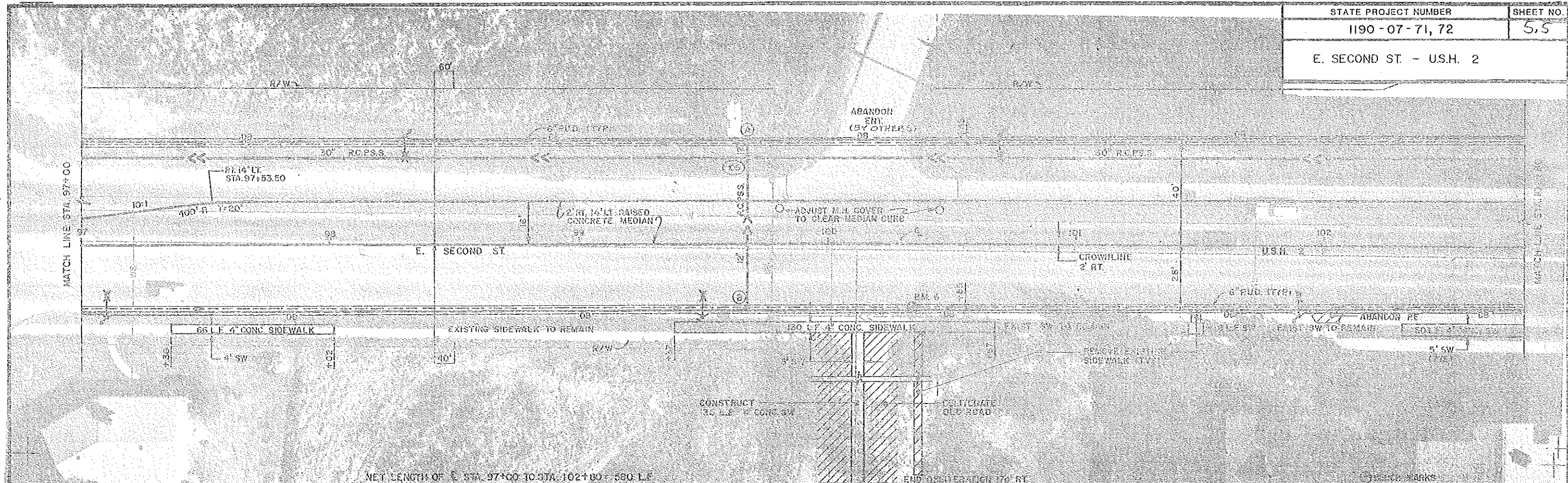

NET LENGTH OF E. STA. 97+00 TO STA. 102+00 = 500 L.F.

NO.	STATION	DESCRIPTION	LEV.
5	100+34	U.S.G.S. MONUMENT, 27' RT.	619.06

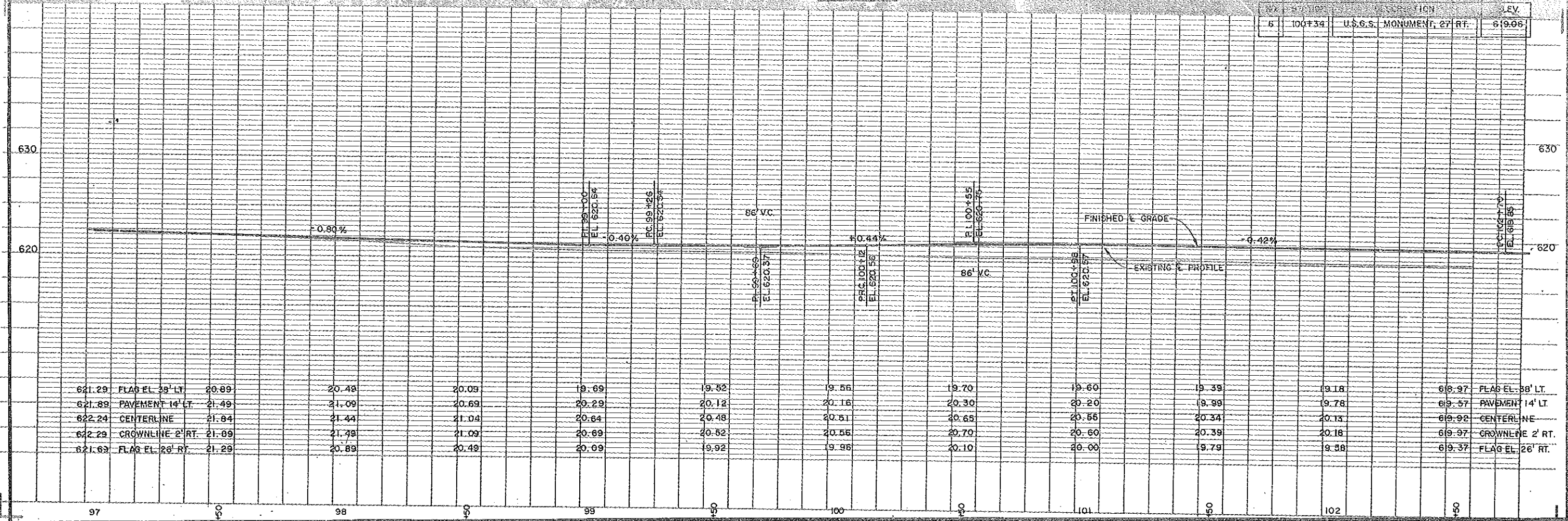

621.29	FLAG EL. 38' LT.	20.89	20.48	20.09	19.69	19.52	19.56	19.70	19.60	19.39	19.18	618.97	FLAG EL. 38' LT.
621.89	PAVEMENT 14' LT.	21.49	21.09	20.69	20.29	20.12	20.16	20.30	20.20	19.99	19.78	619.57	PAVEMENT 14' LT.
622.24	CENTERLINE	21.84	21.44	21.04	20.64	20.48	20.51	20.65	20.55	20.34	20.13	619.92	CENTERLINE
622.29	CROWNLINE 2' RT.	21.89	21.48	21.09	20.69	20.52	20.55	20.70	20.60	20.39	20.18	619.97	CROWNLINE 2' RT.
621.63	FLAG EL. 26' RT.	21.29	20.89	20.49	20.09	19.92	19.96	20.10	20.00	19.79	19.58	619.37	FLAG EL. 26' RT.

STATE PROJECT NUMBER	SHEET NO.
1190 - 07 - 71, 72	5, 6
E. SECOND ST. - U.S.H. 2	

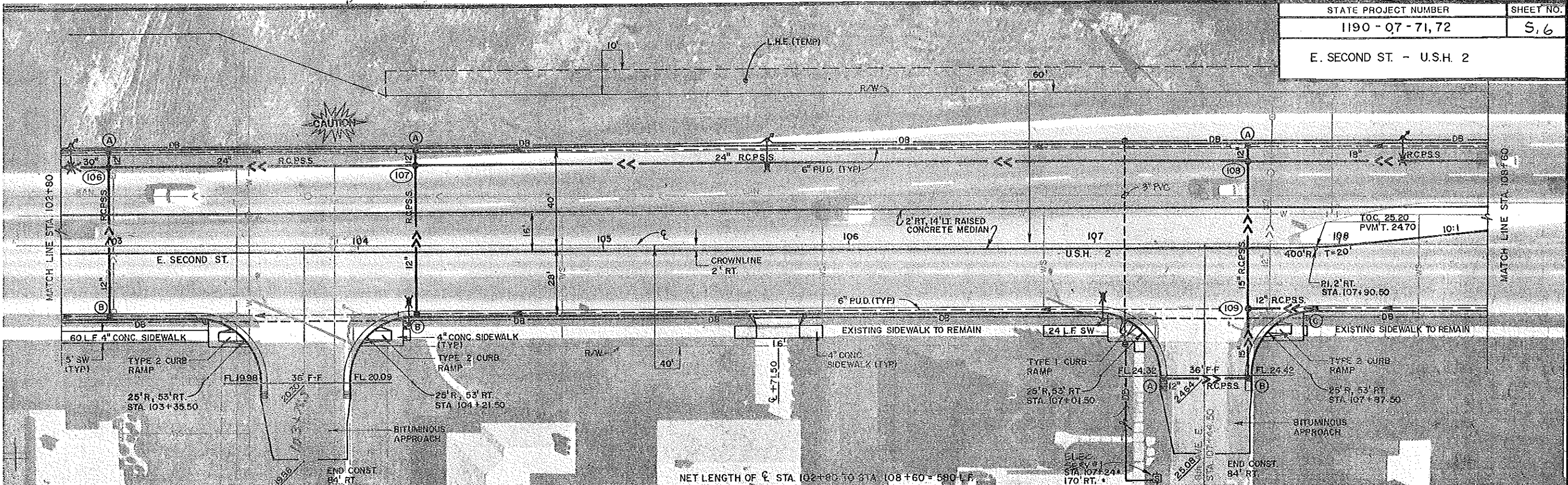

NET LENGTH OF ϵ STA. 102+80 TO STA. 108+60 = 580 L.F.

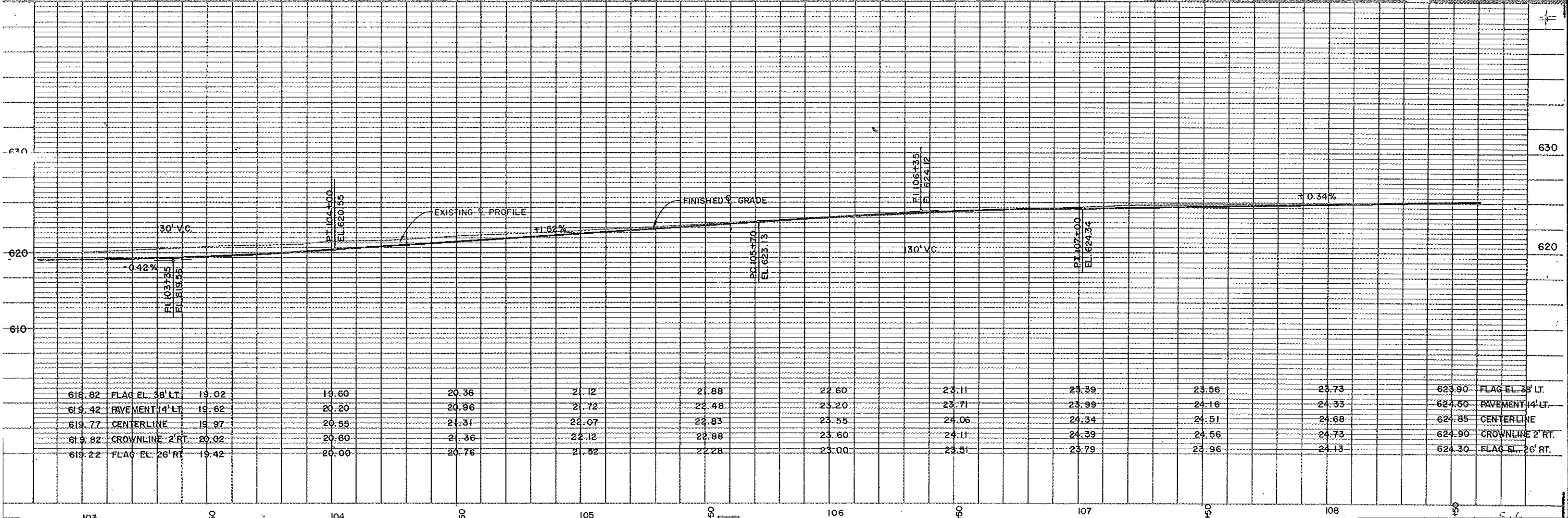

STATE PROJECT NUMBER	SHEET NO.
1190-07-71,72	5.7
E. SECOND ST. - U.S.H. 2	

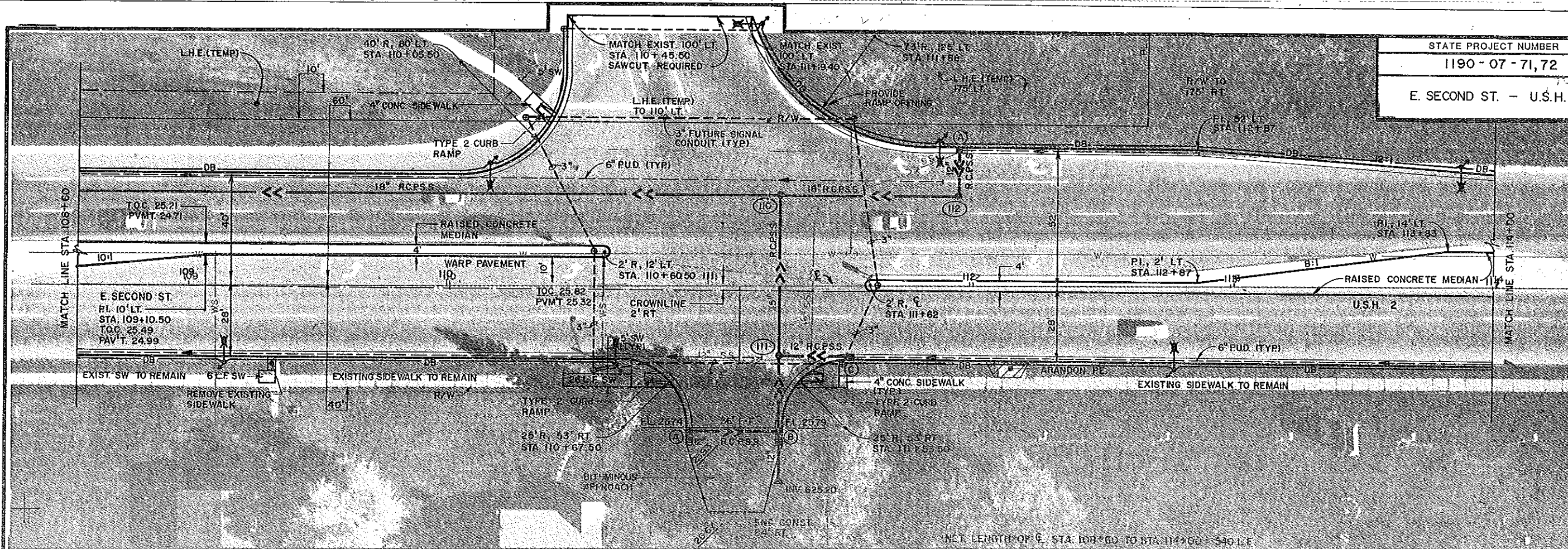

630	EXISTING G. PROFILE												630
	+0.34%												
	FINISHED G. GRADE												
	+0.40%												
620													620
	109	50	110	50	111	50	112	50	113	50	114		
FLAG EL 38' LT	24.07	24.24	24.41	24.58	24.75	24.92	24.80, 50'	25.00, 50'	25.23, 50.92'	25.53, 46.65'	25.84, 42.58'		
PAVEMENT 14' LT	24.87	24.84	25.01	25.18	25.35	25.62	25.70	25.90	26.10	26.30	26.50		
CENTERLINE	25.02	25.19	25.35	25.53	25.70	25.87	26.05	26.25	26.45	26.65	26.85		
CROWNLINE 2' RT	25.07	25.24	25.41	25.58	25.75	25.92	26.10	26.30	26.50	26.70	26.90		
FLAG EL 26' RT	24.27	24.64	24.81	24.98	25.15	25.32	25.50	25.70	25.90	26.10	26.30		

STATE PROJECT NUMBER	SHEET NO.
1190-07-71,72	5.8
E. SECOND ST. - U.S.H. 2	

LEFT MEDIAN CURB - CURVE DATA
 $\Delta = 4^{\circ}41'30''$
 $D = 1^{\circ}40'50''$
 $R = 3248.04'$
 $T = 133.08'$
 $L = 265.97'$
 $PI STA 117+55.24, 14' LT$

LEFT CURB - CURVE DATA
 $\Delta = 4^{\circ}41'30''$
 $D = 1^{\circ}40'50''$
 $R = 3248.04'$
 $T = 133.08'$
 $L = 265.97'$
 $PI STA 117+55.24, 14' LT$

RIGHT MEDIAN CURB - CURVE DATA
 $\Delta = 4^{\circ}41'30''$
 $D = 2^{\circ}19'43''$
 $R = 2460.61'$
 $T = 100.80'$
 $L = 201.49'$
 $PC STA 118+00.50, 2' RT$
 $PT STA 120+02.15, 0' RT$
 $STA 120+02.26, 4' RT, 2' RT$

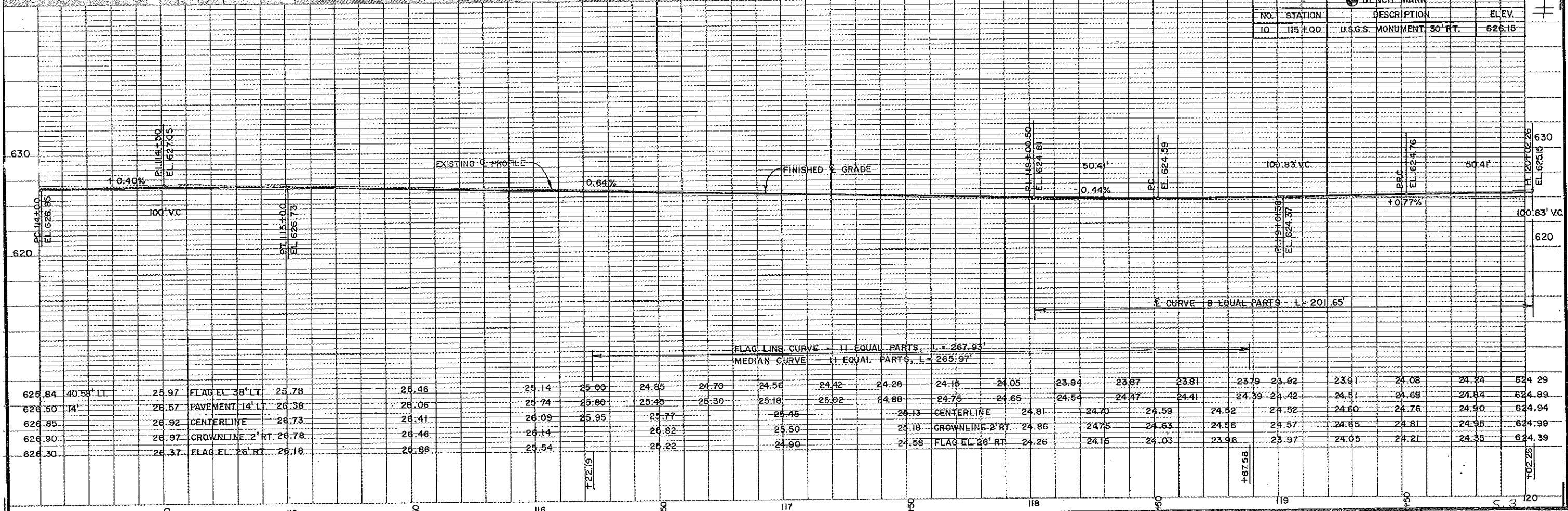
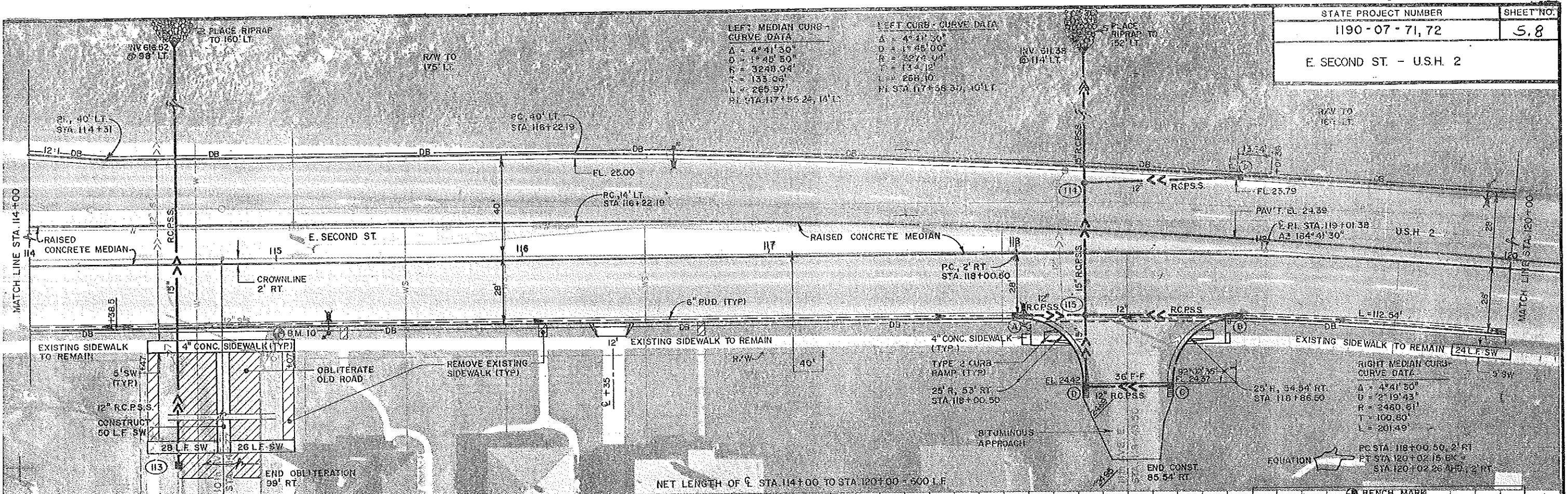

NO.	STATION	DESCRIPTION	ELEV.
10	115+00	U.S.G.S. MONUMENT, 30' RT.	626.15

STATION	625.84	626.50	626.85	626.90	626.30	625.84	626.50	626.85	626.90	626.30	625.84	626.50	626.85	626.90	626.30	625.84	626.50	626.85	626.90	626.30
114	40.53' LT	14'	26.92	26.97	26.37	25.97	26.57	26.92	26.97	26.37	25.97	26.57	26.92	26.97	26.37	25.97	26.57	26.92	26.97	26.37
115			26.92	26.97	26.37	25.97	26.57	26.92	26.97	26.37	25.97	26.57	26.92	26.97	26.37	25.97	26.57	26.92	26.97	26.37
116			26.92	26.97	26.37	25.97	26.57	26.92	26.97	26.37	25.97	26.57	26.92	26.97	26.37	25.97	26.57	26.92	26.97	26.37
117			26.92	26.97	26.37	25.97	26.57	26.92	26.97	26.37	25.97	26.57	26.92	26.97	26.37	25.97	26.57	26.92	26.97	26.37
118			26.92	26.97	26.37	25.97	26.57	26.92	26.97	26.37	25.97	26.57	26.92	26.97	26.37	25.97	26.57	26.92	26.97	26.37
119			26.92	26.97	26.37	25.97	26.57	26.92	26.97	26.37	25.97	26.57	26.92	26.97	26.37	25.97	26.57	26.92	26.97	26.37
120			26.92	26.97	26.37	25.97	26.57	26.92	26.97	26.37	25.97	26.57	26.92	26.97	26.37	25.97	26.57	26.92	26.97	26.37

STATE PROJECT NUMBER	SHEET NO.
1190-07-71,72	5.9
E SECOND ST. - U.S.H. 2	

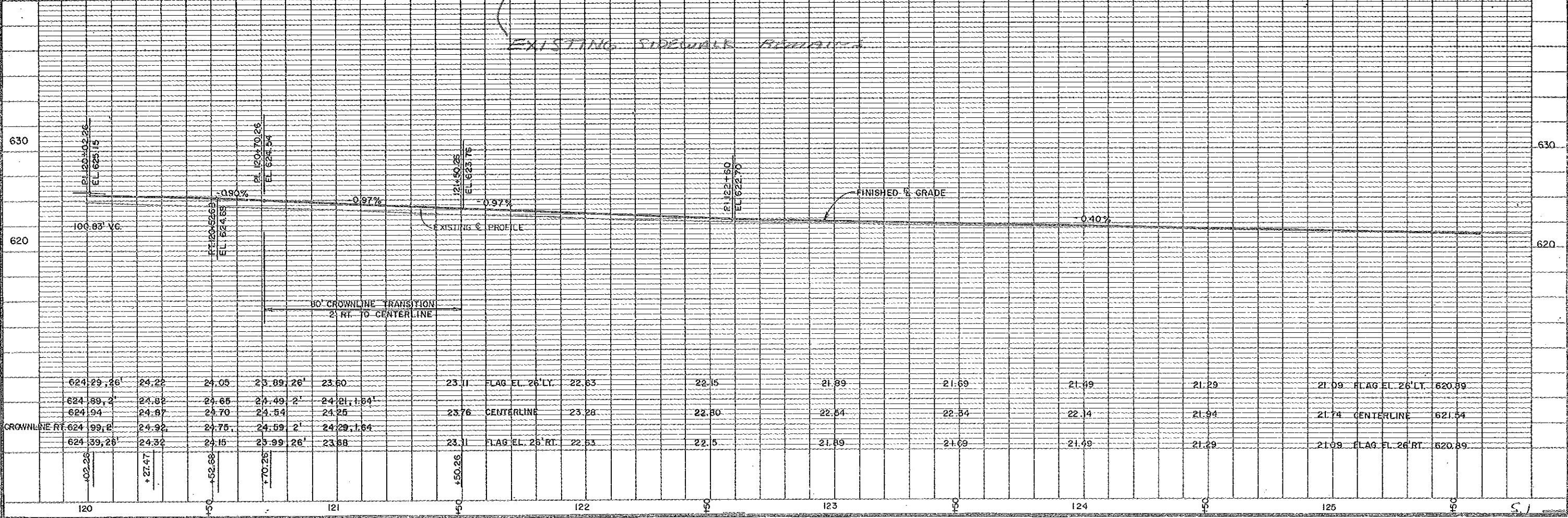
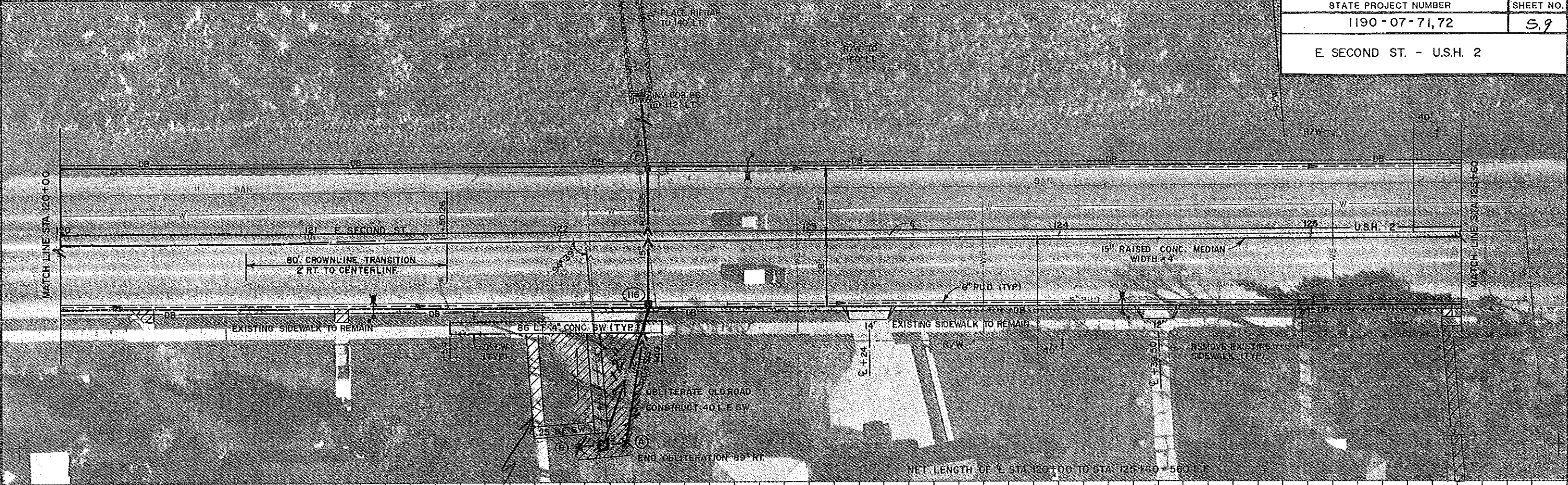

STATE PROJECT NUMBER	SHEET NO.
1190-07-71,72	5.10
E. SECOND ST. - U.S.H. 2	

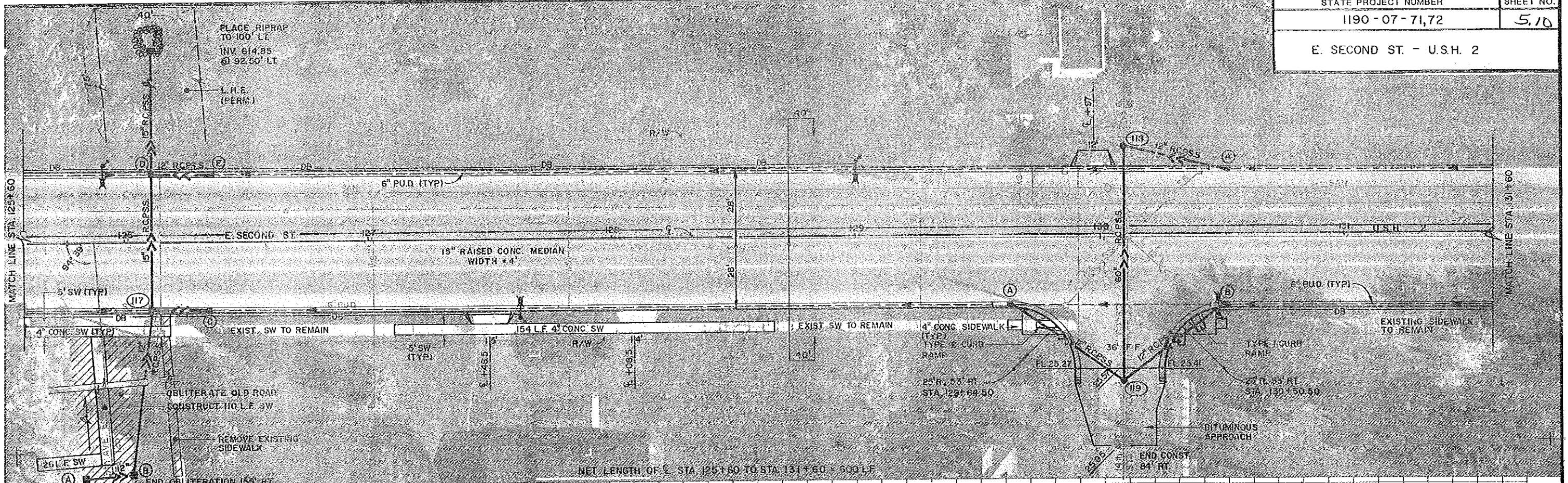

NET LENGTH OF C. STA. 125+60 TO STA. 131+60 = 600 LF

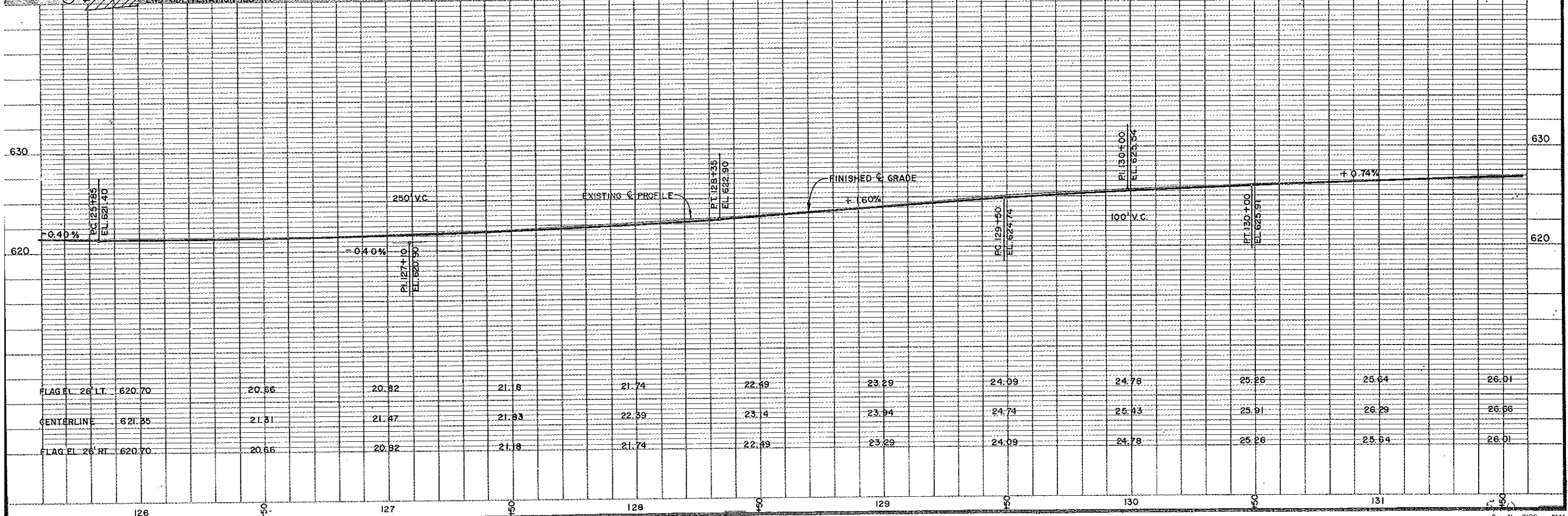

STATE PROJECT NUMBER	SHEET NO.
1190 - 07 - 71, 72	5.12
E. SECOND ST - U.S.H. 2	

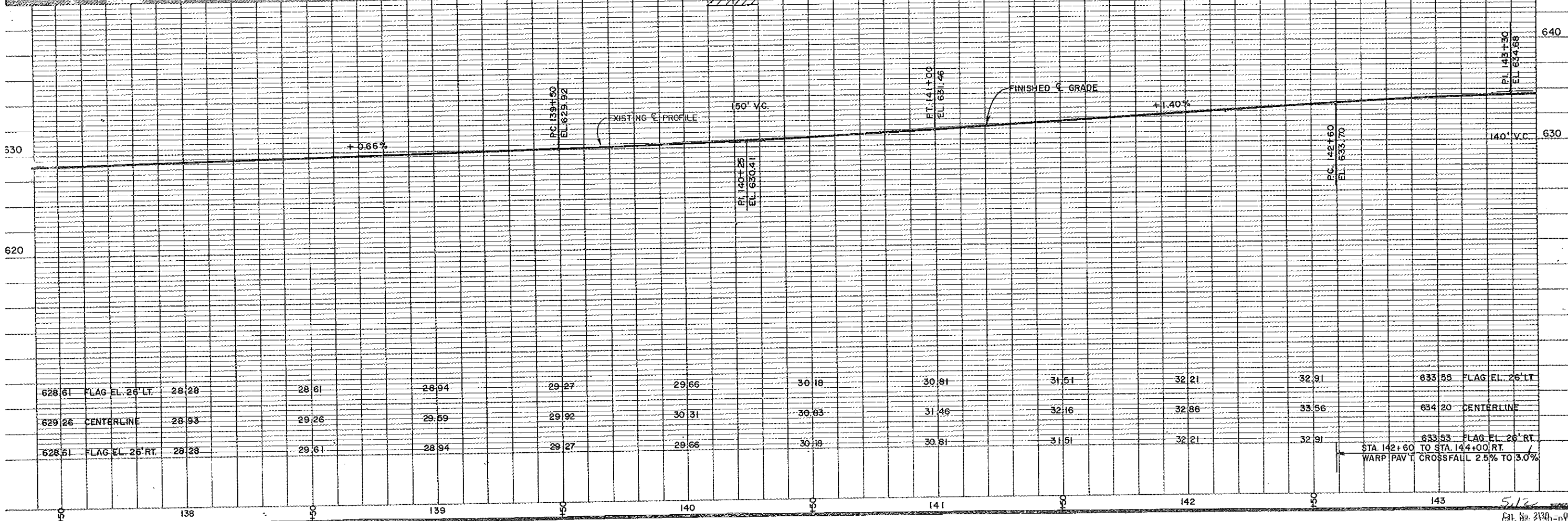
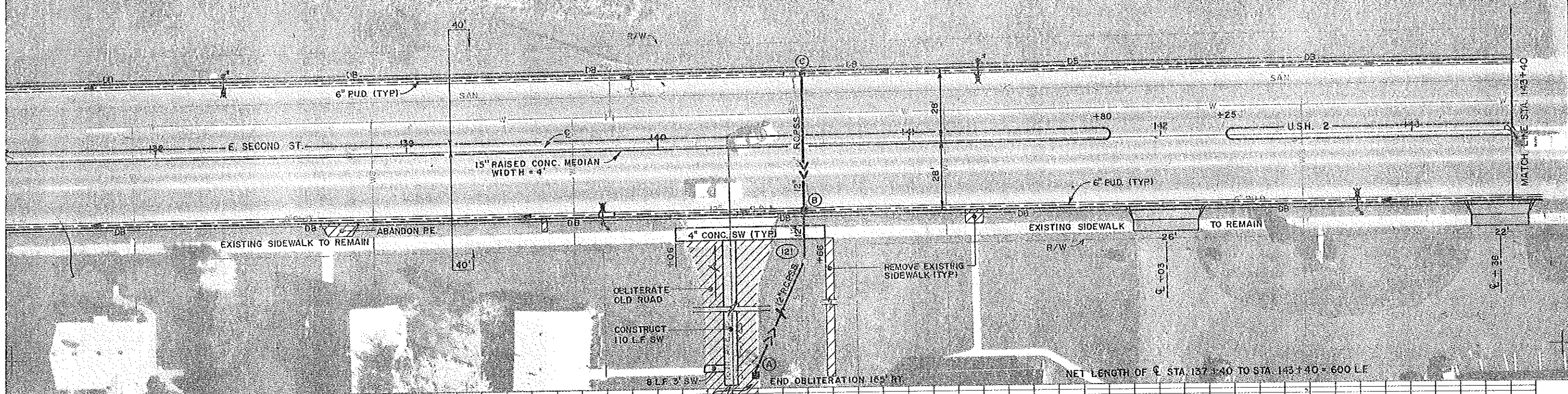

STATE PROJECT NUMBER	SHEET NO.
1190-07-71,72	5.13
E. SECOND ST - U.S.H. 2	

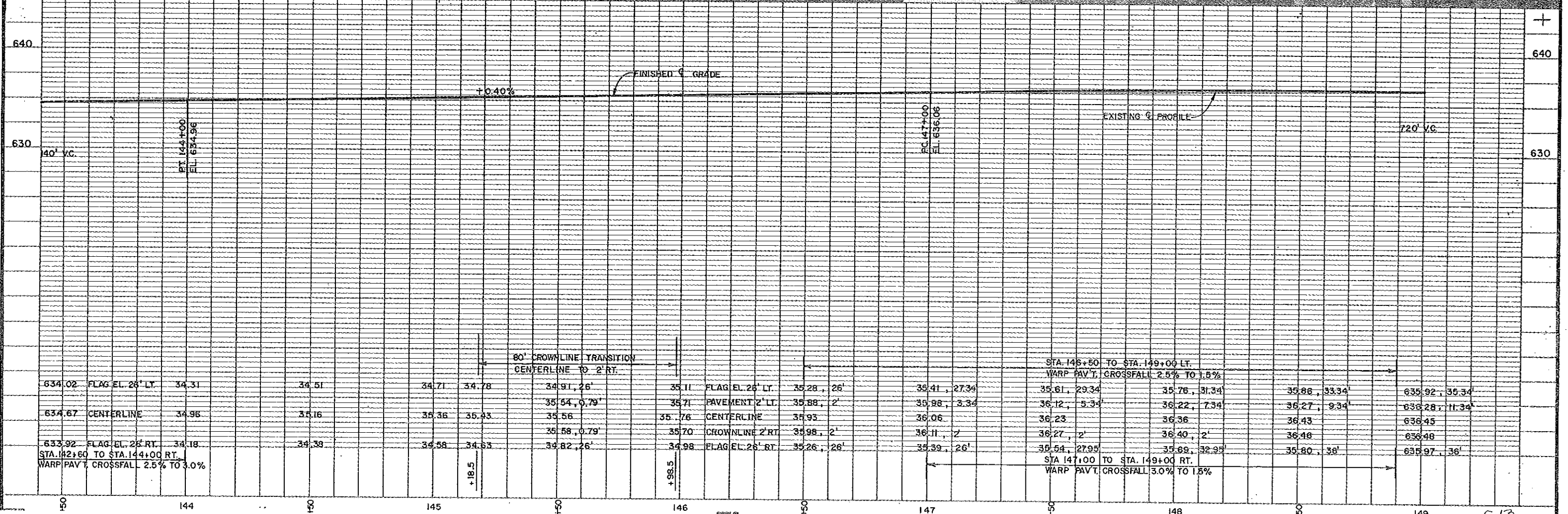
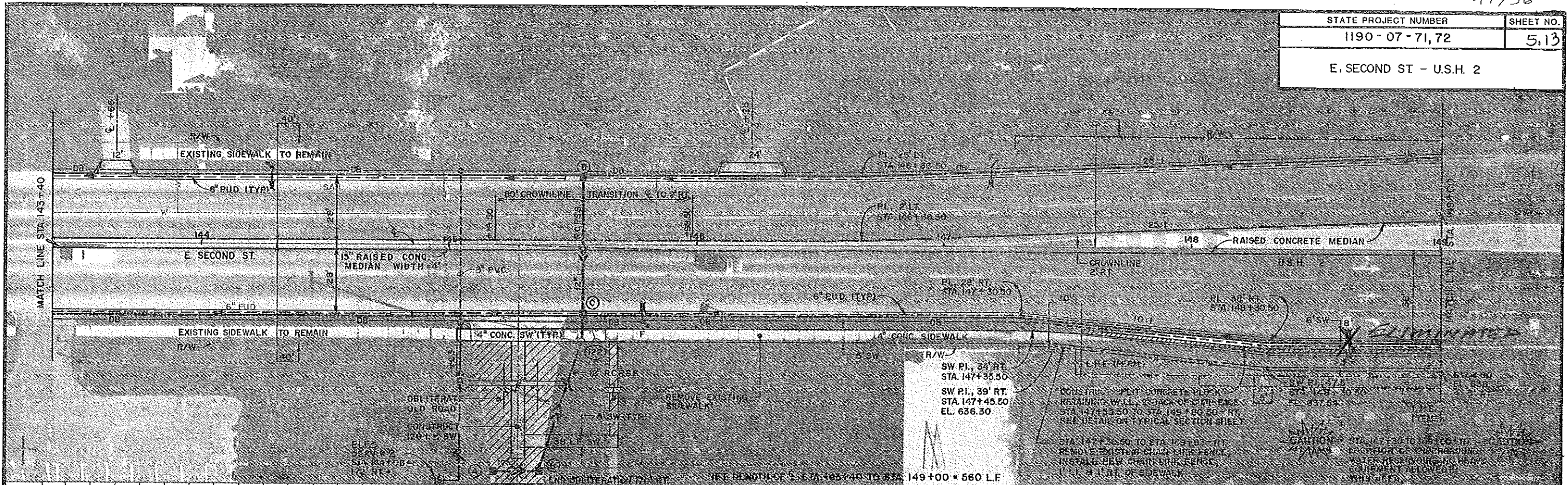

80' CROWNLINE TRANSITION CENTERLINE TO 2' RT.					STA 145+50 TO STA 149+00 LT.				
Station	Flag EL	Centerline	Crownline	RT	Station	Flag EL	Centerline	Crownline	LT
142+00	633.92	633.92	633.92	2'	145+50	635.61	635.61	635.61	2'
143+00	634.18	634.18	634.18	2'	146+00	635.76	635.76	635.76	2'
144+00	634.44	634.44	634.44	2'	147+00	635.91	635.91	635.91	2'
145+00	634.70	634.70	634.70	2'	148+00	636.06	636.06	636.06	2'
146+00	634.96	634.96	634.96	2'	149+00	636.21	636.21	636.21	2'
147+00	635.22	635.22	635.22	2'		636.36	636.36	636.36	2'
148+00	635.48	635.48	635.48	2'		636.51	636.51	636.51	2'
149+00	635.74	635.74	635.74	2'		636.66	636.66	636.66	2'

E. SECOND ST. - U.S.H. 2

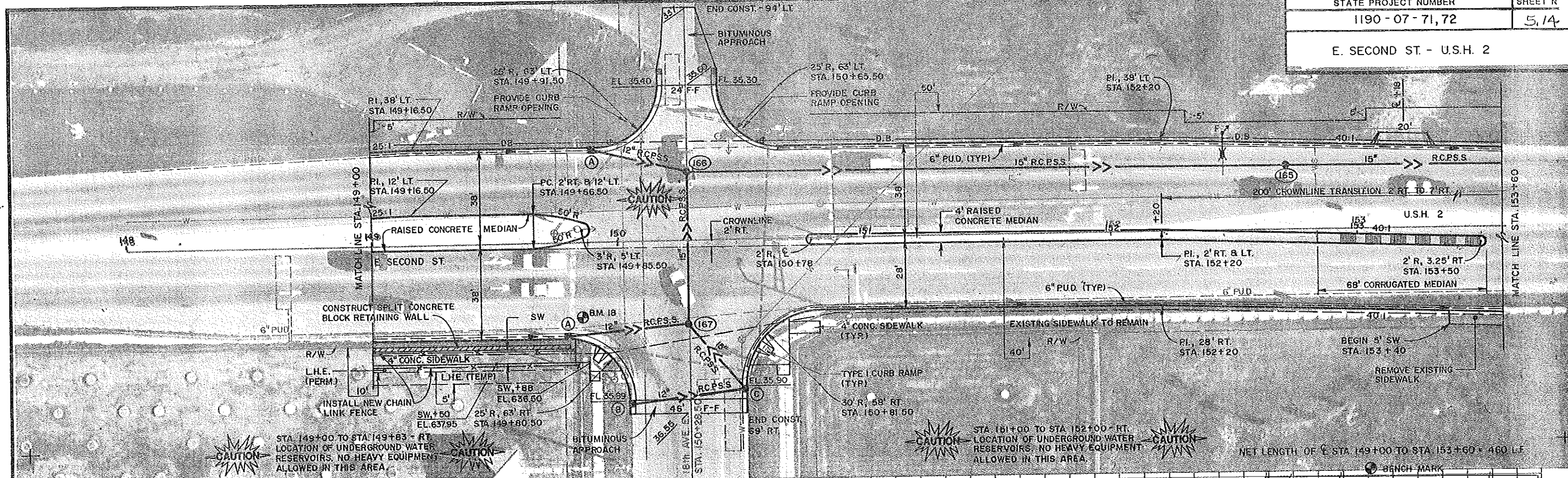

CAUTION - STA. 149+00 TO STA. 149+83 - RT. LOCATION OF UNDERGROUND WATER RESERVOIRS. NO HEAVY EQUIPMENT ALLOWED IN THIS AREA.

CAUTION - STA. 151+00 TO STA. 152+00 - RT. LOCATION OF UNDERGROUND WATER RESERVOIRS. NO HEAVY EQUIPMENT ALLOWED IN THIS AREA.

NET LENGTH OF E STA 149+00 TO STA 153+60 = 460 LF

NO.	STATION	DESCRIPTION	ELEV.
18	149+86	U.S.G.S. MONUMENT, 30' RT.	635.52

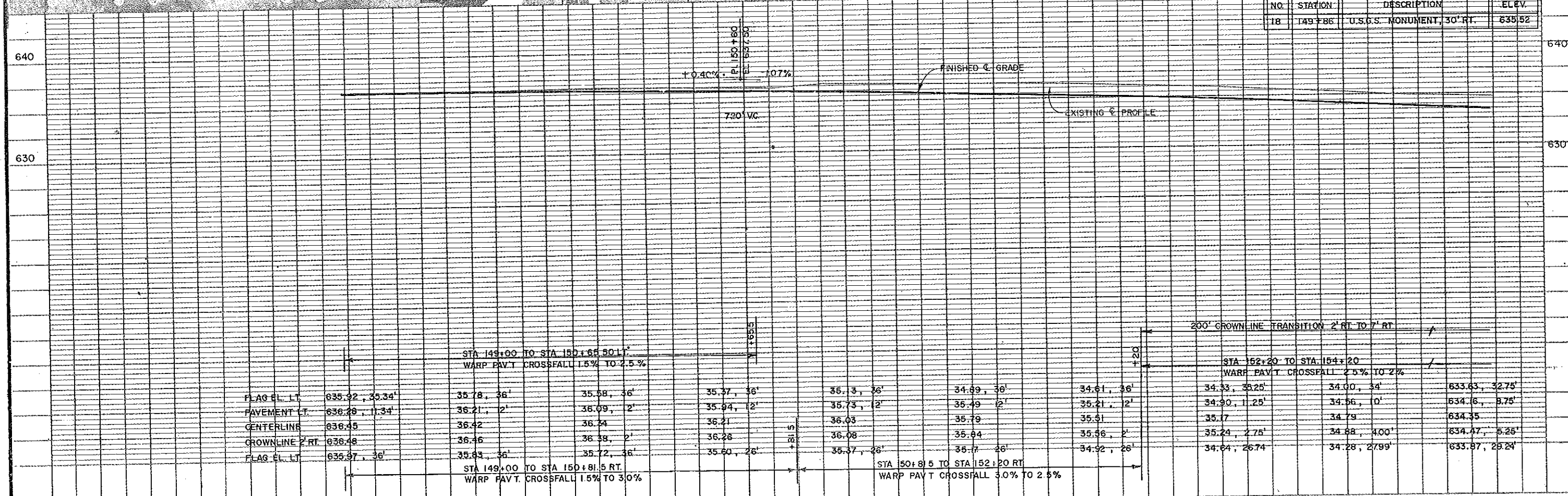

	STA 149+00 TO STA 150+65.50 LT	STA 149+00 TO STA 150+81.5 RT	STA 150+81.5 TO STA 152+20 RT
FLAG EL. LT.	635.92, 35.34'	35.78, 36'	35.3, 36'
PAVEMENT LT.	636.29, 11.34'	36.21, 2'	35.73, 2'
CENTERLINE	636.45	36.42	36.03
CROWLINE 2' RT.	636.48	36.46	36.08
FLAG EL. LT.	635.97, 36'	35.83, 36'	35.57, 26'
		35.58, 36'	34.89, 36'
		36.09, 2'	35.49, 2'
		36.24	36.79
		36.38, 2'	35.94
		35.72, 36'	35.56, 2'
		35.60, 26'	34.92, 26'
			34.61, 36'
			35.21, 12'
			35.17
			35.24, 2.75'
			34.84, 26.74
			34.00, 34'
			34.36, 10'
			34.79
			34.88, 4.00'
			34.28, 27.99'
			633.83, 32.75'
			634.6, 8.75'
			634.35
			634.47, 5.25'
			633.87, 29.24'

STATE PROJECT NUMBER	SHEET NO.
1190-07-71, 72	515
E. SECOND ST. - U.S.H. 2	

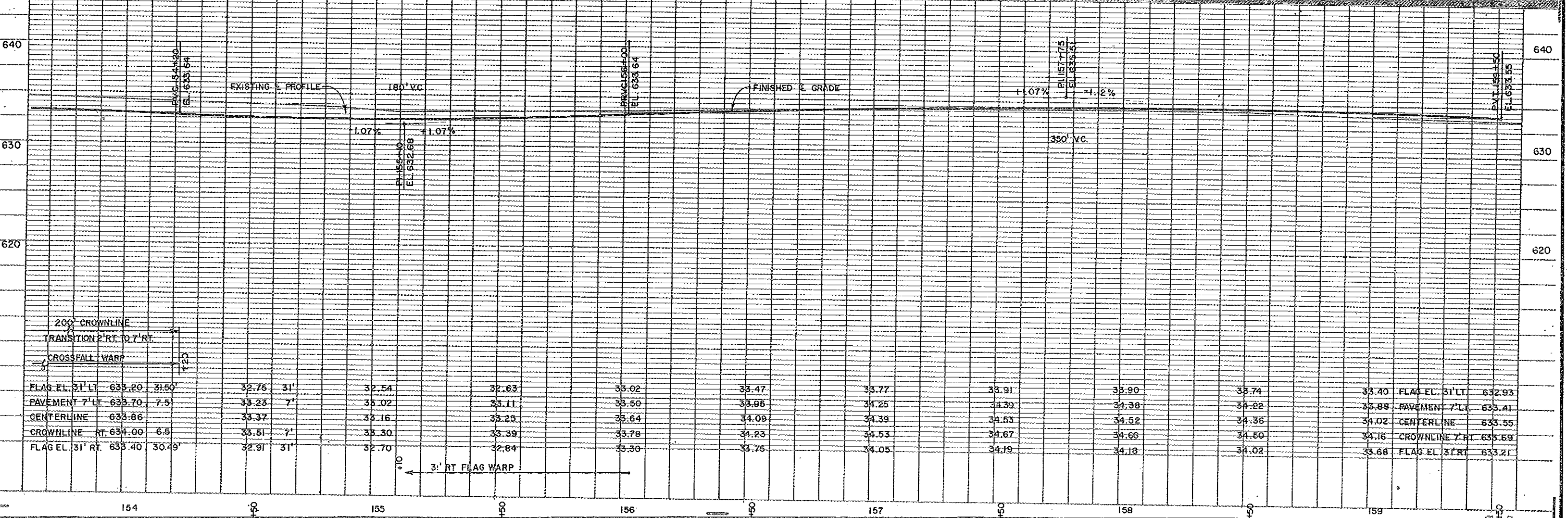
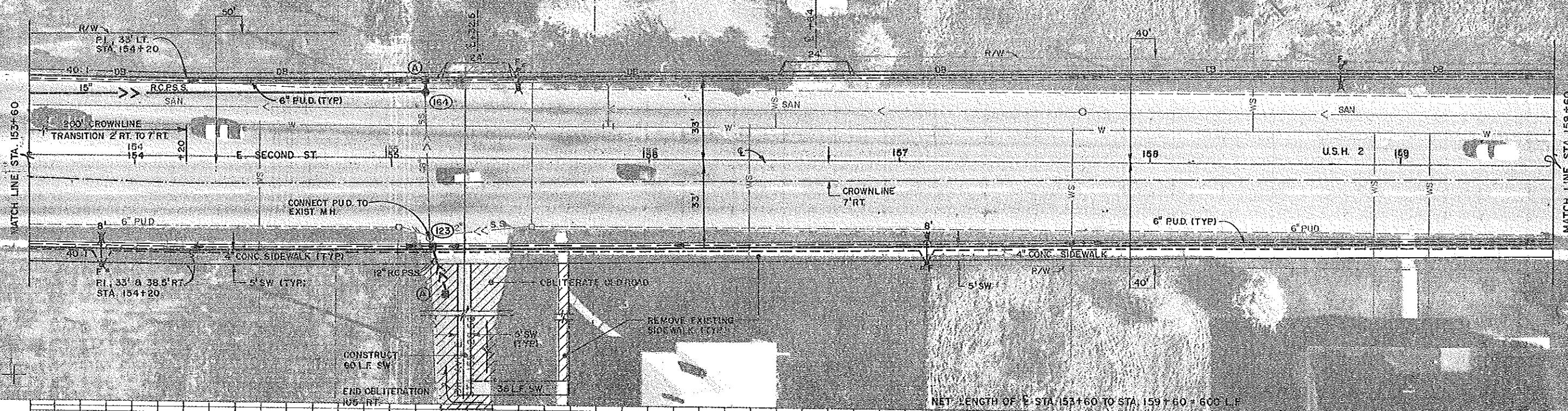

E. SECOND ST. - U.S.H. 2

