

BEGIN CONSTRUCTION
STA 278+80.00

BEGIN PROJECT
STA 125+50.00'NB'

END CONSTRUCTION
STA 280+65.00

END CONSTRUCTION
STA 290+70.00

LEGEND

- SLOPE INTERCEPT
- INLET PROTECTION TYPE A OR D
- TREE PROTECTION TYPE 1
- TEMPORARY DITCH CHECK

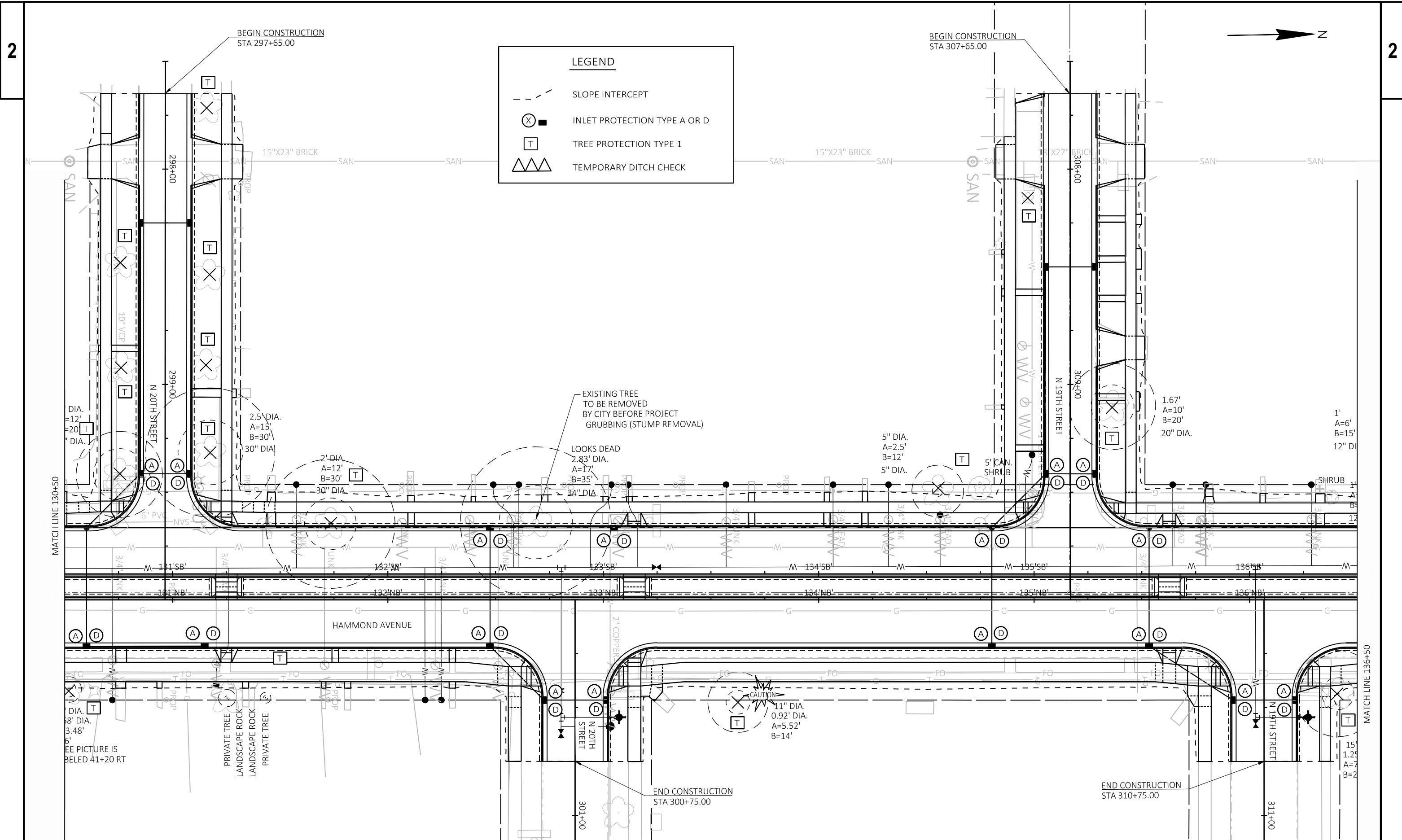

LEGEND

- - - SLOPE INTERCEPT
- ⊗ INLET PROTECTION TYPE A OR D
- ⊠ TREE PROTECTION TYPE 1
- ▲▲▲ TEMPORARY DITCH CHECK

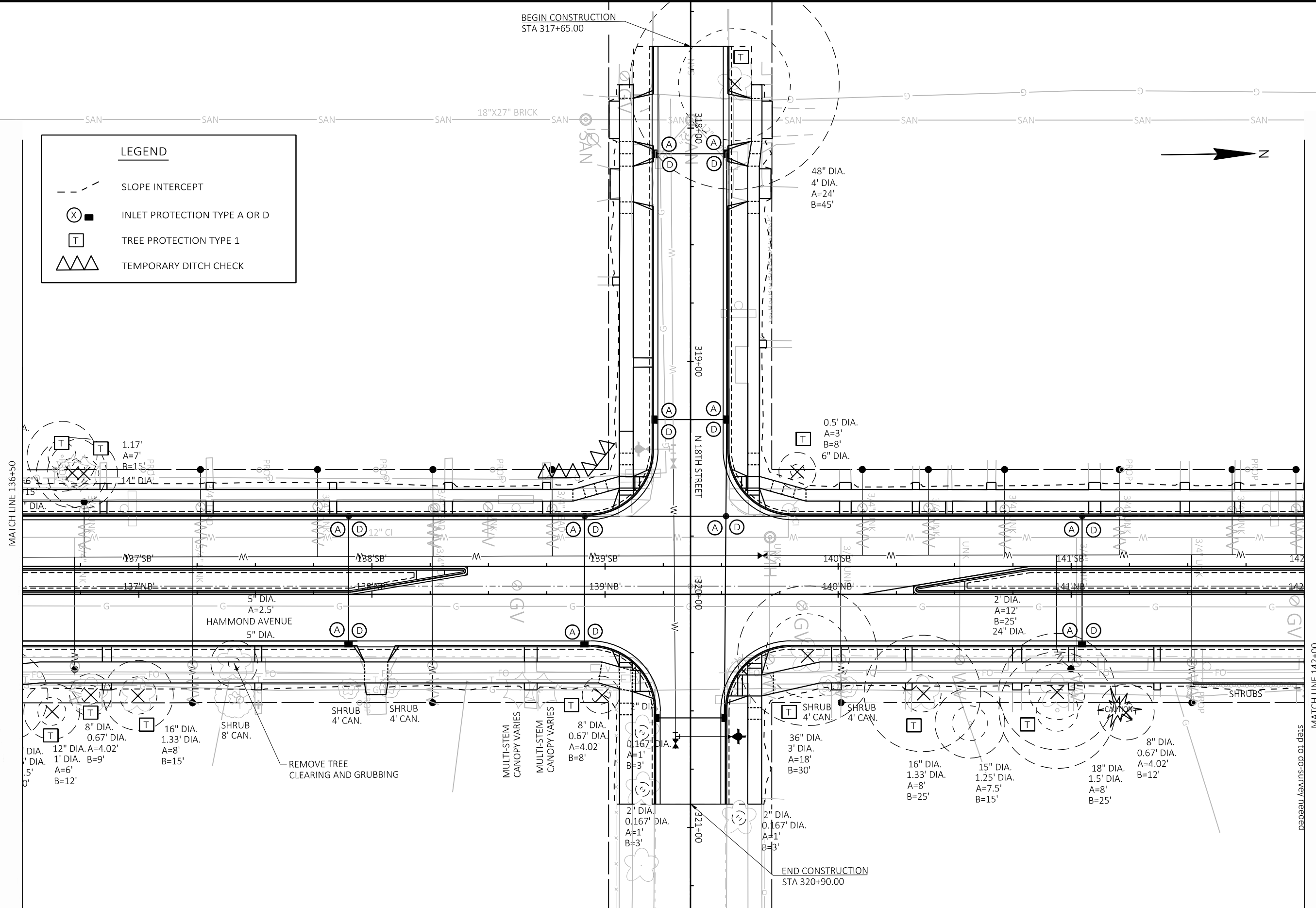

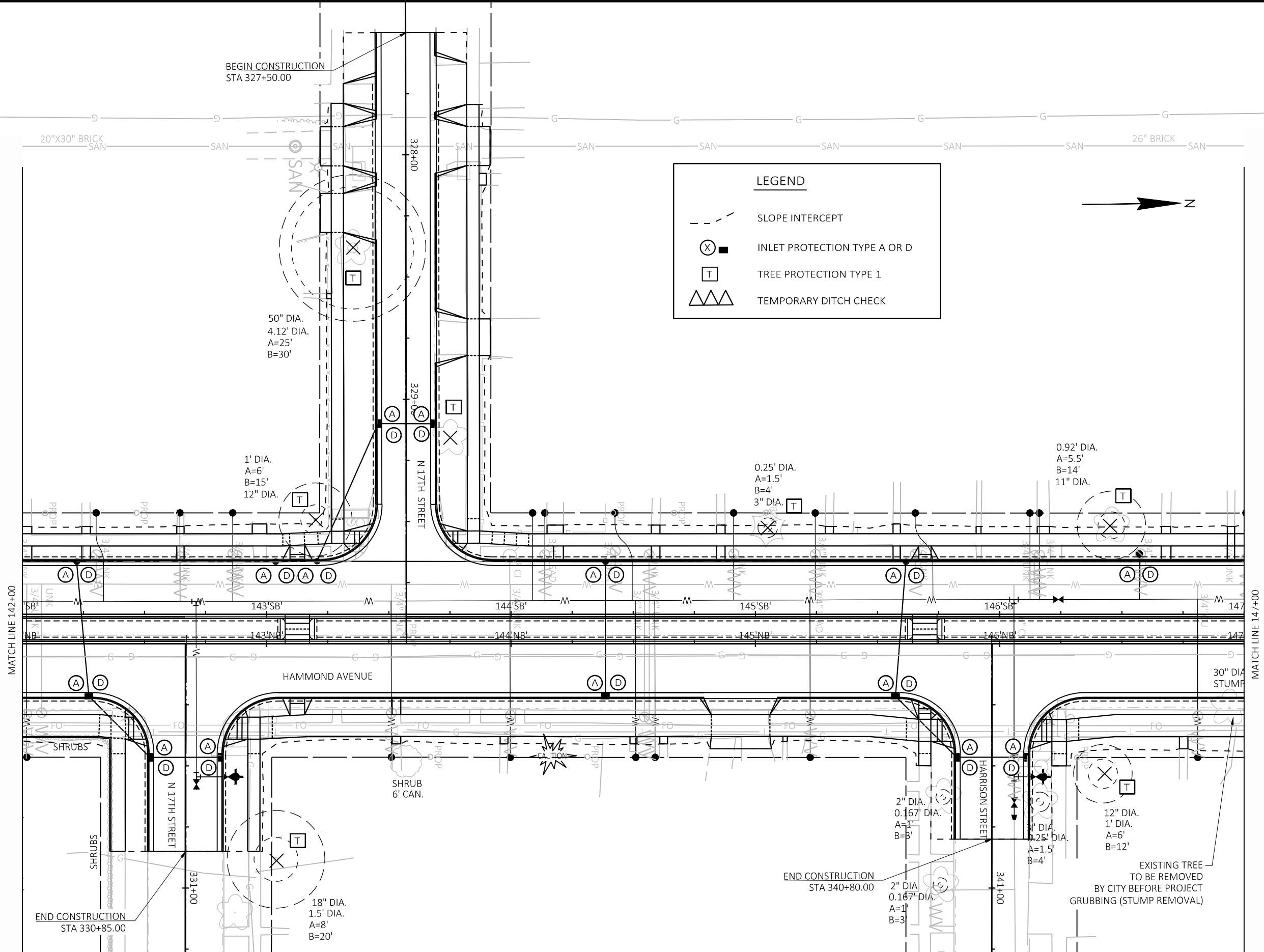

LEGEND

- SLOPE INTERCEPT
- INLET PROTECTION TYPE A OR D
- TREE PROTECTION TYPE 1
- TEMPORARY DITCH CHECK

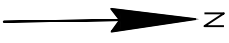

BEGIN CONSTRUCTION
STA 327+50.00

END CONSTRUCTION
STA 340+80.00

END CONSTRUCTION
STA 330+85.00

50" DIA.
4.12' DIA.
A=25'
B=30'

1' DIA.
A=6'
B=15'
12" DIA.

0.25' DIA.
A=1.5'
B=4'
3" DIA.





0.92' DIA.
A=5.5'
B=14'
11" DIA.

18" DIA.
1.5' DIA.
A=8'
B=20'

12" DIA.
1' DIA.
A=6'
B=12'

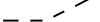
EXISTING TREE
TO BE REMOVED
BY CITY BEFORE PROJECT
GRUBBING (STUMP REMOVAL)

LEGEND

-  SLOPE INTERCEPT
-  INLET PROTECTION TYPE A OR D
-  TREE PROTECTION TYPE 1
-  TEMPORARY DITCH CHECK

