

KEY TO MAP

- 500-Year Flood Boundary
- 100-Year Flood Boundary
- Zone Designations* With Date of Identification e.g., 12/2/74
- 100-Year Flood Boundary
- 500-Year Flood Boundary
- Base Flood Elevation Line With Elevation In Feet** 513
- Base Flood Elevation in Feet Where Uniform Within Zone** (EL 987)
- Elevation Reference Mark RM7
- River Mile M1.5

**Referenced to the National Geodetic Vertical Datum of 1929

*EXPLANATION OF ZONE DESIGNATIONS

ZONE	EXPLANATION
A	Areas of 100-year flood; base flood elevations and flood hazard factors not determined.
A0	Areas of 100-year shallow flooding where depths are between one (1) and three (3) feet; average depths of inundation are shown, but no flood hazard factors are determined.
AH	Areas of 100-year shallow flooding where depths are between one (1) and three (3) feet; base flood elevations are shown, but no flood hazard factors are determined.
A1-A30	Areas of 100-year flood; base flood elevations and flood hazard factors determined.
A99	Areas of 100-year flood to be protected by flood protection system under construction; base flood elevations and flood hazard factors not determined.
B	Areas between limits of the 100-year flood and 500-year flood; or certain areas subject to 100-year flooding with average depths less than one (1) foot or where the contributing drainage area is less than one square mile; or areas protected by levees from the base flood. (Medium shading)
C	Areas of minimal flooding. (No shading)
D	Areas of undetermined, but possible, flood hazards.
V	Areas of 100-year coastal flood with velocity (wave action); base flood elevations and flood hazard factors not determined.
V1-V30	Areas of 100-year coastal flood with velocity (wave action); base flood elevations and flood hazard factors determined.

NOTES TO USER

Certain areas not in the special flood hazard areas (zones A and V) may be protected by flood control structures.
 This map is for flood insurance purposes only; it does not necessarily show all areas subject to flooding in the community or all planimetric features outside special flood hazard areas.
 For adjoining map panels, see separately printed Index To Map Panels.

INITIAL IDENTIFICATION:
DECEMBER 22, 1978

FLOOD HAZARD BOUNDARY MAP REVISIONS:

FLOOD INSURANCE RATE MAP EFFECTIVE:
FEBRUARY 4, 1981

FLOOD INSURANCE RATE MAP REVISIONS:

Refer to the FLOOD INSURANCE RATE MAP EFFECTIVE date shown on this map to determine when actuarial rates apply to structures in the zones where elevations or depths have been established.
 To determine if flood insurance is available in this community, contact your insurance agent, or call the National Flood Insurance Program, at (800) 638-6620, or (800) 424-8872.

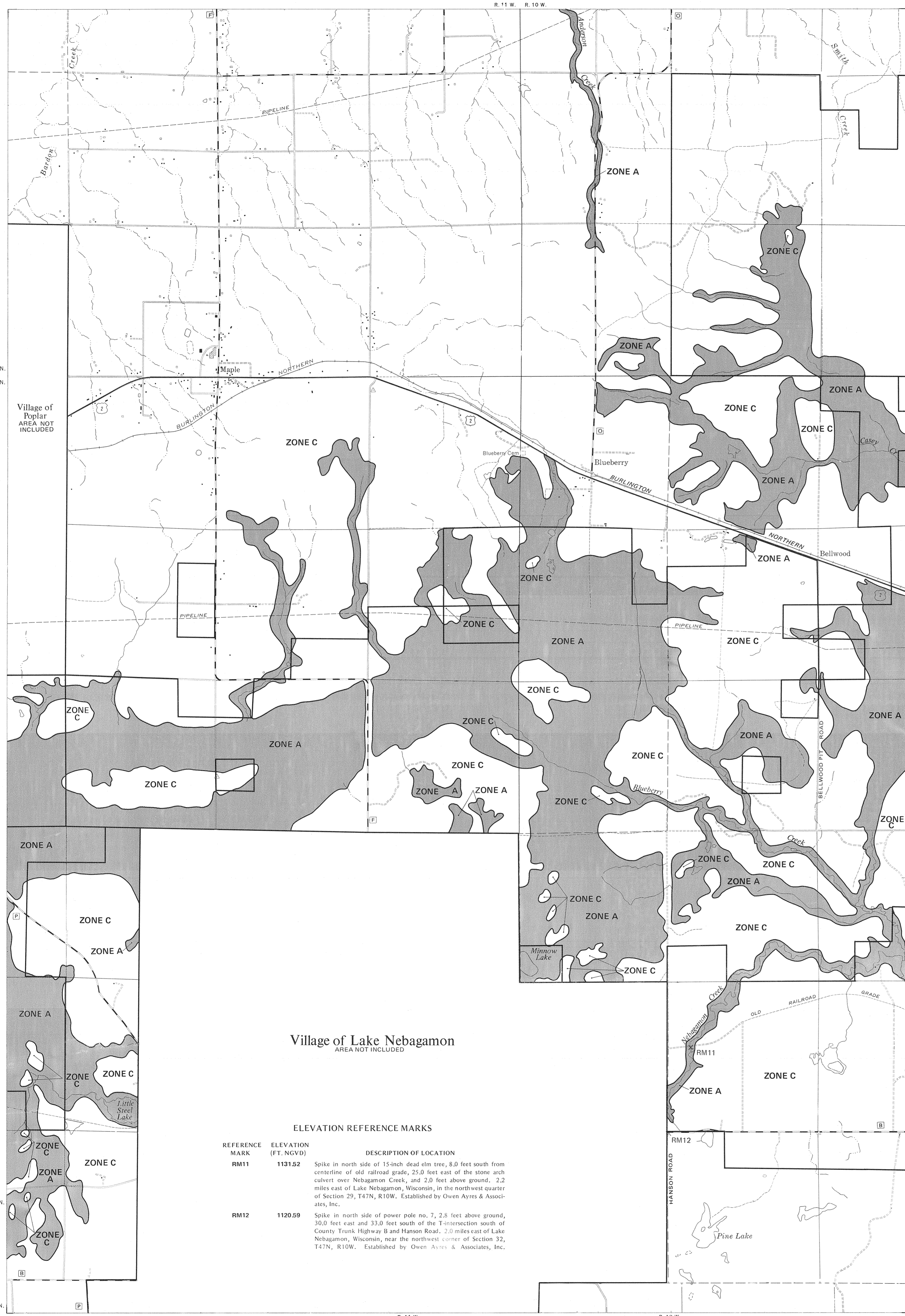
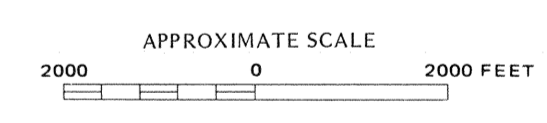

Village of Poplar
AREA NOT INCLUDED

Village of Lake Nebagamon
AREA NOT INCLUDED

ELEVATION REFERENCE MARKS

REFERENCE MARK	ELEVATION (FT. NGVD)	DESCRIPTION OF LOCATION
RM11	1131.52	Spike in north side of 15-inch dead elm tree, 8.0 feet south from centerline of old railroad grade, 25.0 feet east of the stone arch culvert over Nebagamon Creek, and 2.0 feet above ground, 2.2 miles east of Lake Nebagamon, Wisconsin, in the northwest quarter of Section 29, T47N, R10W. Established by Owen Ayres & Associates, Inc.
RM12	1120.59	Spike in north side of power pole no. 7, 2.8 feet above ground, 30.0 feet east and 33.0 feet south of the T-intersection south of County Trunk Highway B and Hanson Road, 2.0 miles east of Lake Nebagamon, Wisconsin, near the northwest corner of Section 32, T47N, R10W. Established by Owen Ayres & Associates, Inc.

NATIONAL FLOOD INSURANCE PROGRAM

FIRM
FLOOD INSURANCE RATE MAP

DOUGLAS COUNTY,
WISCONSIN
(UNINCORPORATED AREAS)

PANEL 325 OF 875
(SEE MAP INDEX FOR PANELS NOT PRINTED)

COMMUNITY-PANEL NUMBER
550538 0325 B

EFFECTIVE DATE:
FEBRUARY 4, 1981

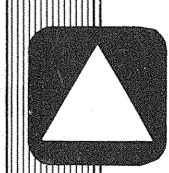

federal emergency management agency
federal insurance administration