

DEPARTMENT OF HEALTH, EDUCATION, AND WELFARE
DIVISION OF WATER CONTROL
These Plans and Specifications submitted in connection with an Application for a Permit under the provisions of the Federal Water Pollution Control Act (U.S.C. 405) and the regulations promulgated thereunder have been reviewed.

(Reviewing Engineer) _____ (Date) _____
APPROVED
(Regional Engineer) _____ (Date) _____
Region V, Chicago, Illinois

EXAMINED and reported upon by the Section on Environmental Sanitation
O. J. MUEGGE
State Sanitary Engineer
APPROVED by the State Board of Health, as required by Wisconsin Statutes, subject to conditions set forth in the letter of approval.
JUL 6 1956
CARL N. NEIPERT, M. D.
State Health Officer
Verification: *[Signature]*

FOR SECTIONS 1-1, 2-2, 3-3
SEE SH. 77

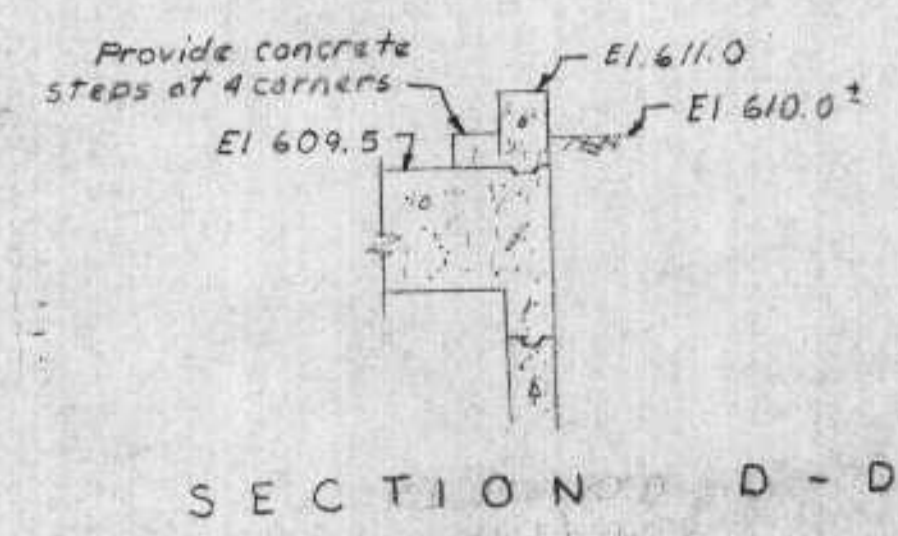
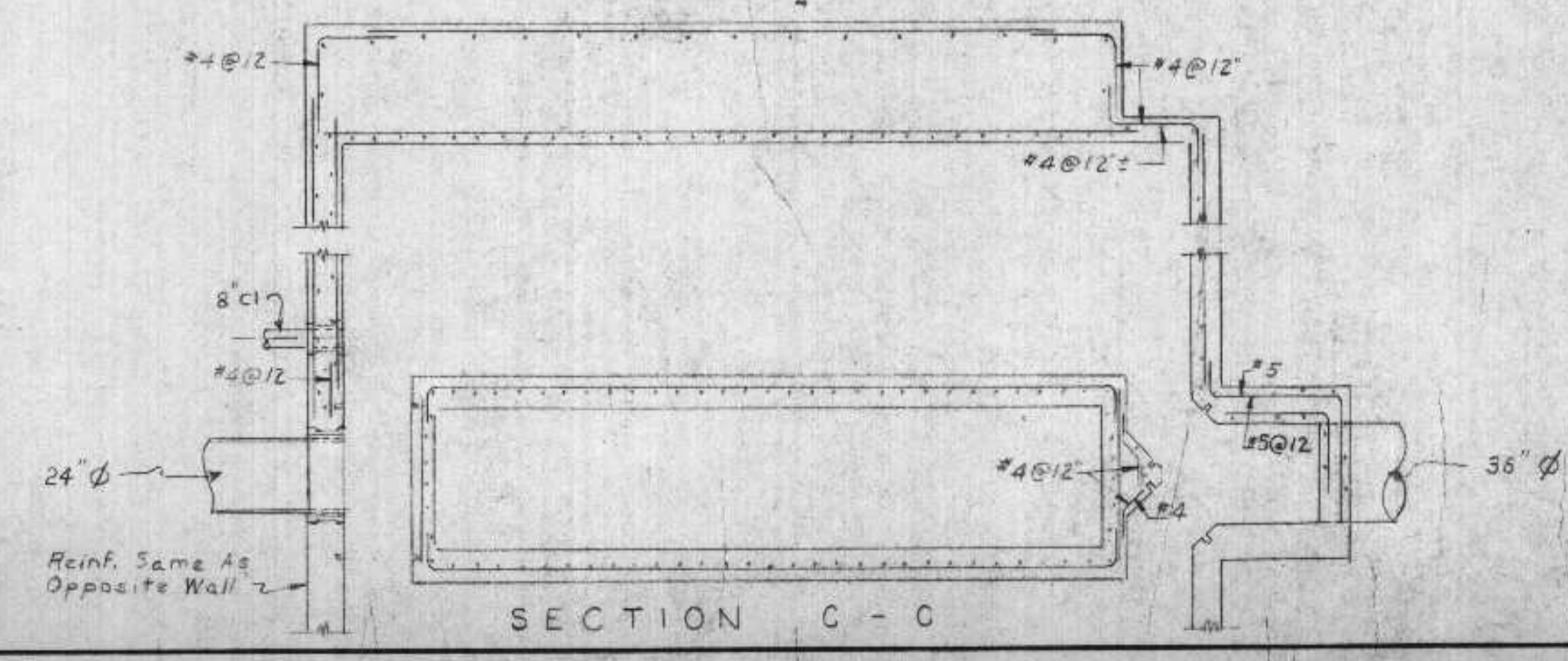

REVISIONS			BY	
DATE	DESCRIPTION			
6/18/56	Y-Trough drawn added		JD	

AERATED GRIT CHAMBER
SEWAGE TREAT PLANT
SUPERIOR WIS.
HITCHCOCK & ESTABROOK, INC.
CONSULTING ENGINEERS
300 LINCOLN BLDG.
MINNEAPOLIS 1, MINN.
DR. TR. ME. JL. CHKD. APP. JD. DATE: SCALE: 1/4" = 1'-0" JOB NO. 400 SHEET NO. 16 OF 71