

DATE	
BY	F.M.S.
SURVEYED	
GRADES CHECKED	
BY M. NOTED	
STRUCTURE NOTING DIV.	
NO.	
PLAN	
NOTE BOOK	
NO.	

DATE	
BY	F.M.S.
SURVEYED	
GRADES CHECKED	
BY M. NOTED	
STRUCTURE NOTING DIV.	
NO.	
PROFILE	
NOTE BOOK	
NO.	

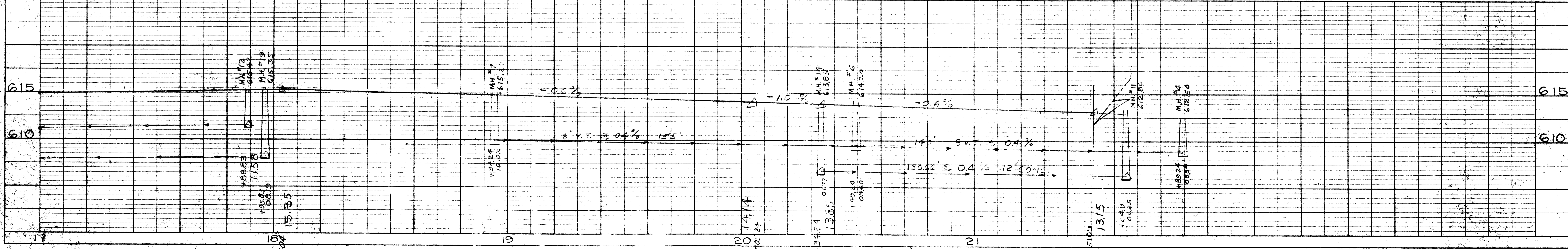
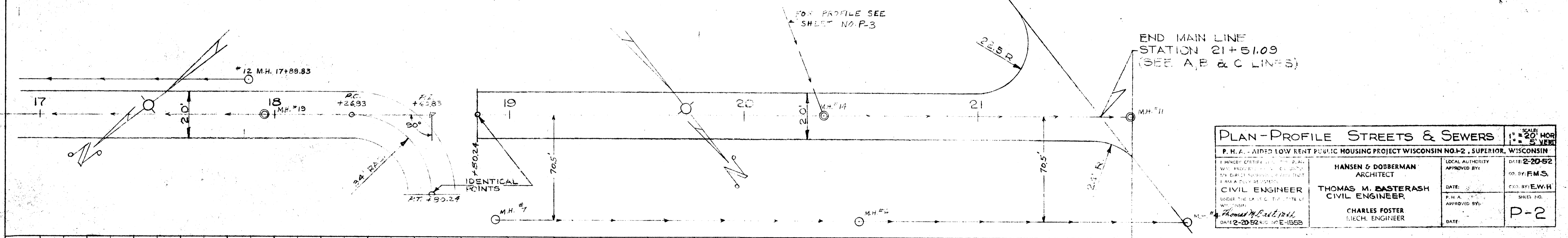
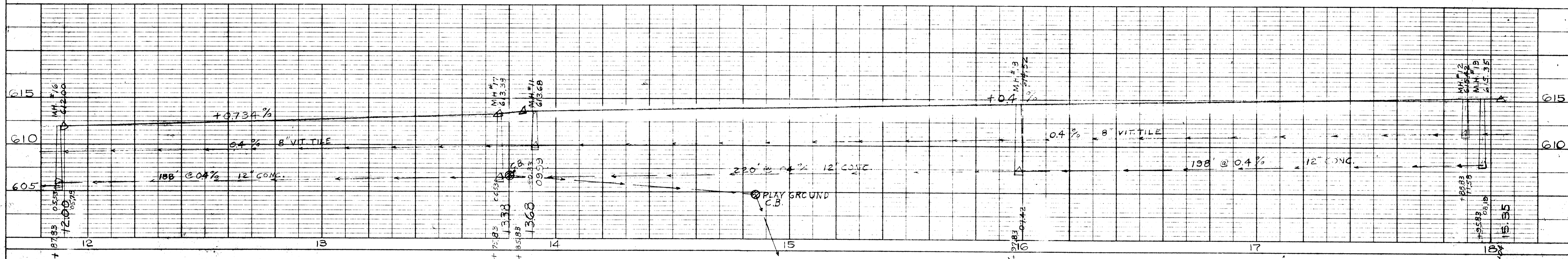
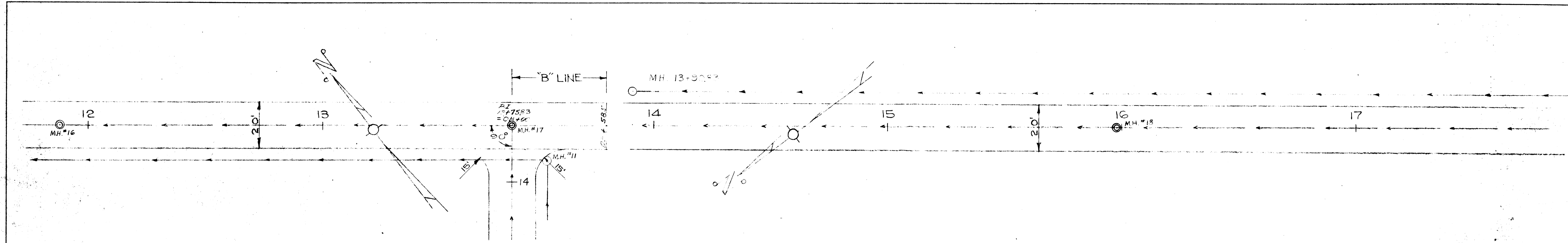

PLAN-PROFILE STREETS & SEWERS			SCALE
P. H. A. - AIDED LOW RENT PUBLIC HOUSING PROJECT WISCONSIN NO. 2, SUPERIOR, WISCONSIN			1" = 20' HOR
I HEREBY CERTIFY THAT THE PLAN, SPECIFICATIONS, AND SEWER LAYOUTS ARE THE WORK OF THE ARCHITECT OR ENGINEER IN CHARGE OF THE PROJECT AND THAT I AM A duly LICENSED PROFESSIONAL ENGINEER OR ARCHITECT IN THE STATE OF WISCONSIN.			5" VERT
CIVIL ENGINEER	HANSEN & DOBBERMAN ARCHITECT	LOCAL AUTHORITY APPROVED BY:	DATE: 2-20-52
THOMAS M. BASTERASH CIVIL ENGINEER	CHARLES FOSTER MECH. ENGINEER	DATE:	BY: F.M.S.
DATE: 2-20-52	DATE: 2-20-52	DATE:	BY: E.W.H.
		DATE:	SHEET NO. P-2