

LEVELS ON = 1,2,3,4,5,6,7,8,9,10,11,12,13,14,15,16,17,18,19,20,21,22,23,24,25,26,27,28,29,30,31,32,33,34,35,36,37,38,39,40,41,42,43,44,45,46,47,48,49,50,51,52,53,54,55,56,57,58,59,60,61,62,63

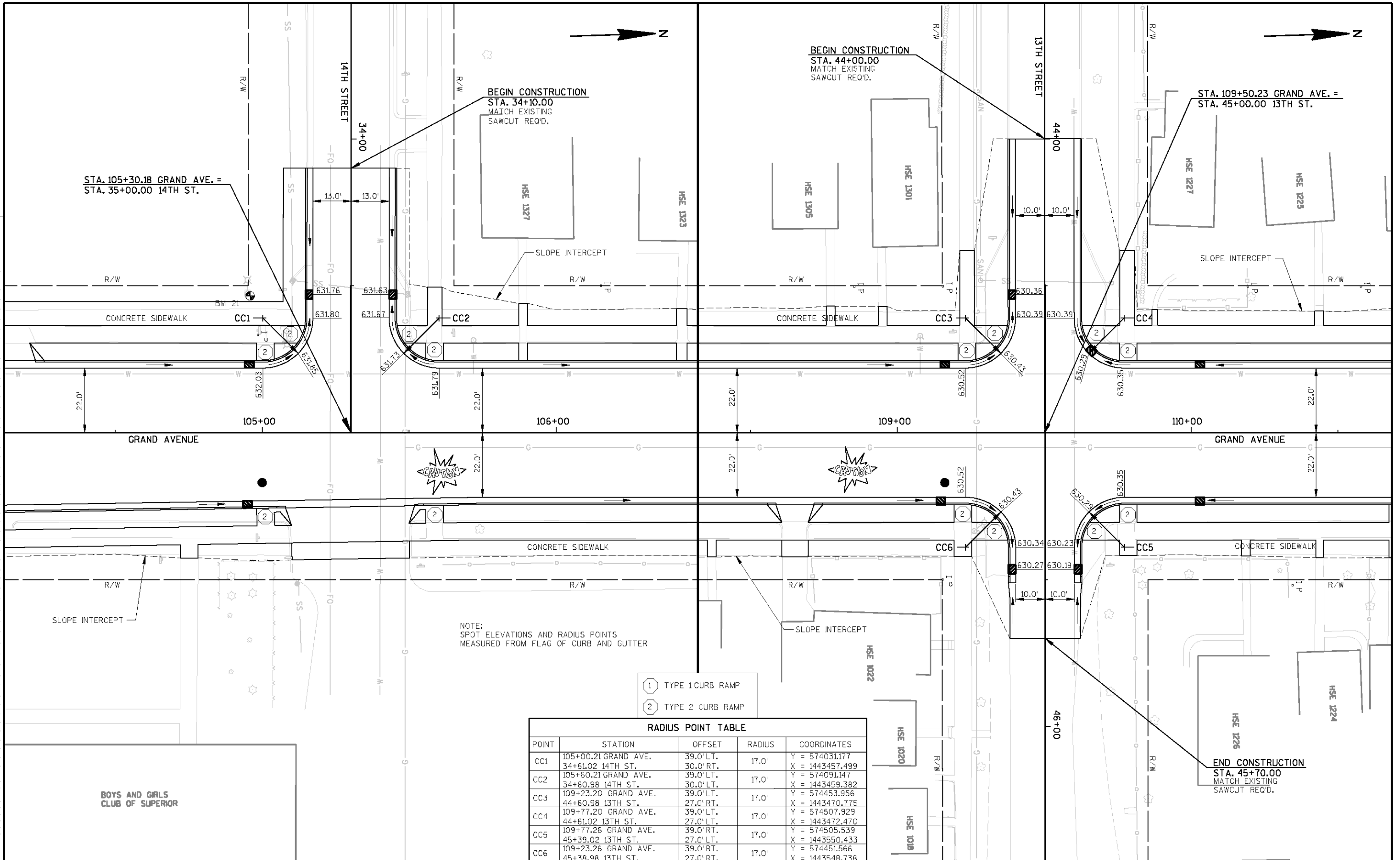

NOTE:
SPOT ELEVATIONS AND RADIUS POINTS
MEASURED FROM FLAG OF CURB AND GUTTER

- ① TYPE 1 CURB RAMP
- ② TYPE 2 CURB RAMP

RADIUS POINT TABLE				
POINT	STATION	OFFSET	RADIUS	COORDINATES
CC1	105+00.21 GRAND AVE.	39.0' LT.	17.0'	Y = 574031.177
	34+61.02 14TH ST.	30.0' RT.		X = 1443457.499
CC2	105+60.21 GRAND AVE.	39.0' LT.	17.0'	Y = 574091.147
	34+60.98 14TH ST.	30.0' LT.		X = 1443459.382
CC3	109+23.20 GRAND AVE.	39.0' LT.	17.0'	Y = 574453.956
	44+60.98 13TH ST.	27.0' RT.		X = 1443470.775
CC4	109+77.20 GRAND AVE.	39.0' LT.	17.0'	Y = 574507.929
	44+61.02 13TH ST.	27.0' LT.		X = 1443472.470
CC5	109+77.26 GRAND AVE.	39.0' RT.	17.0'	Y = 574505.539
	45+39.02 13TH ST.	27.0' LT.		X = 1443550.433
CC6	109+23.26 GRAND AVE.	39.0' RT.	17.0'	Y = 574451.566
	45+38.98 13TH ST.	27.0' RT.		X = 1443548.738

SEH PROJECT NUMBER: SUPER0005.00

HWY: GRAND AVENUE

COUNTY: DOUGLAS

INTERSECTION DETAILS

SCALE, FEET

SHEET NO:

E