

STATE PROJECT	FEDERAL PROJECT	
	PROJECT	CONTRACT
8998-16-71		

**STATE OF WISCONSIN
DEPARTMENT OF TRANSPORTATION**

PLAN OF PROPOSED IMPROVEMENT

**CITY OF SUPERIOR, HAMMOND AVENUE
NORTH 12TH STREET - NORTH 8TH STREET
DOUGLAS COUNTY**

INDEX OF SHEETS

Sheet No. 1	Title
Sheet No.	Typical Sections and Details
Sheet No.	Estimate of Quantities
Sheet No.	Miscellaneous Quantities
Sheet No.	Right of Way Plat
Sheet No.	Plan and Profile
Sheet No.	Standard Detail Drawings
Sheet No.	Sign Plates
Sheet No.	Structure Plans
Sheet No.	Computer Earthwork Data
Sheet No.	Cross Sections

TOTAL SHEETS =



STATE PROJECT NUMBER
8998-16-71



END PROJECT
STA. 114+98.00

BEGIN PROJECT
STA. 100+31.53
Y = 1442400.010
X = 574966.999

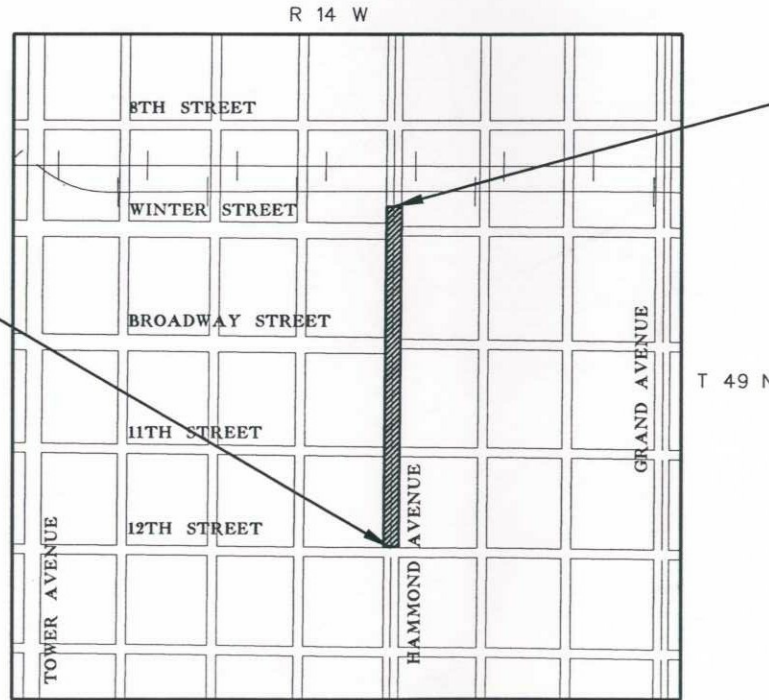

DESIGN DESIGNATION

A.D.T. 2000	=	10,560
A.D.T. 2020	=	14,900
D.H.V.	=	
D.	=	
T.	=	2.4%
DESIGN SPEED	=	35 mph
ESALS	=	335,800

CONVENTIONAL SIGNS

COUNTY LINE		COMBUSTIBLE FLUIDS	
CORPORATE LIMITS		UNDERGROUND UTILITIES	
PROPERTY LINE		GAS	
LOT LINE		ELECTRIC	
LIMITED EASEMENT		TELEPHONE OR TELEGRAPH	
EXISTING RIGHT OF WAY		SERVICE PEDESTAL	
PROPOSED OR NEW R/W LINE		CABLE MARKER	
SURVEY LINE		POWER POLE	
SLOPE INTERCEPT		TELEPHONE POLE	
ORIGINAL GROUND		RAILROAD	
MARSH OR ROCK PROFILE		MARSH AREA	
EXISTING CULVERT		WOODED OR SHRUB AREA	
PROPOSED CULVERT (Box or Pipe)			
CULVERT (Profile View)			

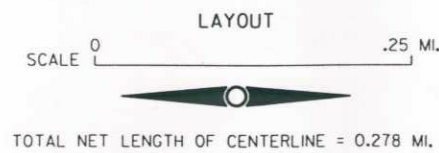

COORDINATES ON THIS PLAN ARE REFERENCED TO THE WISCONSIN COORDINATE SYSTEM NORTHERN ZONE.

APPROVED FOR

CITY _____ of SUPERIOR

DATE 9/14/99

DIRECTOR OF PUBLIC WORKS

ORIGINAL PLANS PREPARED BY:



STATE OF WISCONSIN
DEPARTMENT OF TRANSPORTATION

PREPARED BY

Surveyor	SEH INC.
Designer	SEH INC.
District Examiner	CHRISTINE KOSKI
District Supervisor	RICK WASHKLUHN
Proj. Dev. Engineer	
C.O. Examiner	

APPROVED FOR DISTRICT OFFICE

DATE: _____ (Signature)

AUTHORIZED FOR BUREAU OF HIGHWAY DEVELOPMENT

DATE: _____ (Signature)

LEVELS ON - 1, 2, 3, 4, 5, 6, 7, 8, 9, 10, 11, 12, 13, 14, 15, 16, 17, 18, 19, 20, 21, 22, 23, 24, 25, 26, 27, 28, 29, 30, 31, 32, 33, 34, 35, 36, 37, 38, 39, 40, 41, 42, 43, 44, 45, 46, 47, 48, 49, 50, 51, 52, 53, 54, 55, 56, 57, 58, 59, 60, 61, 62, 63

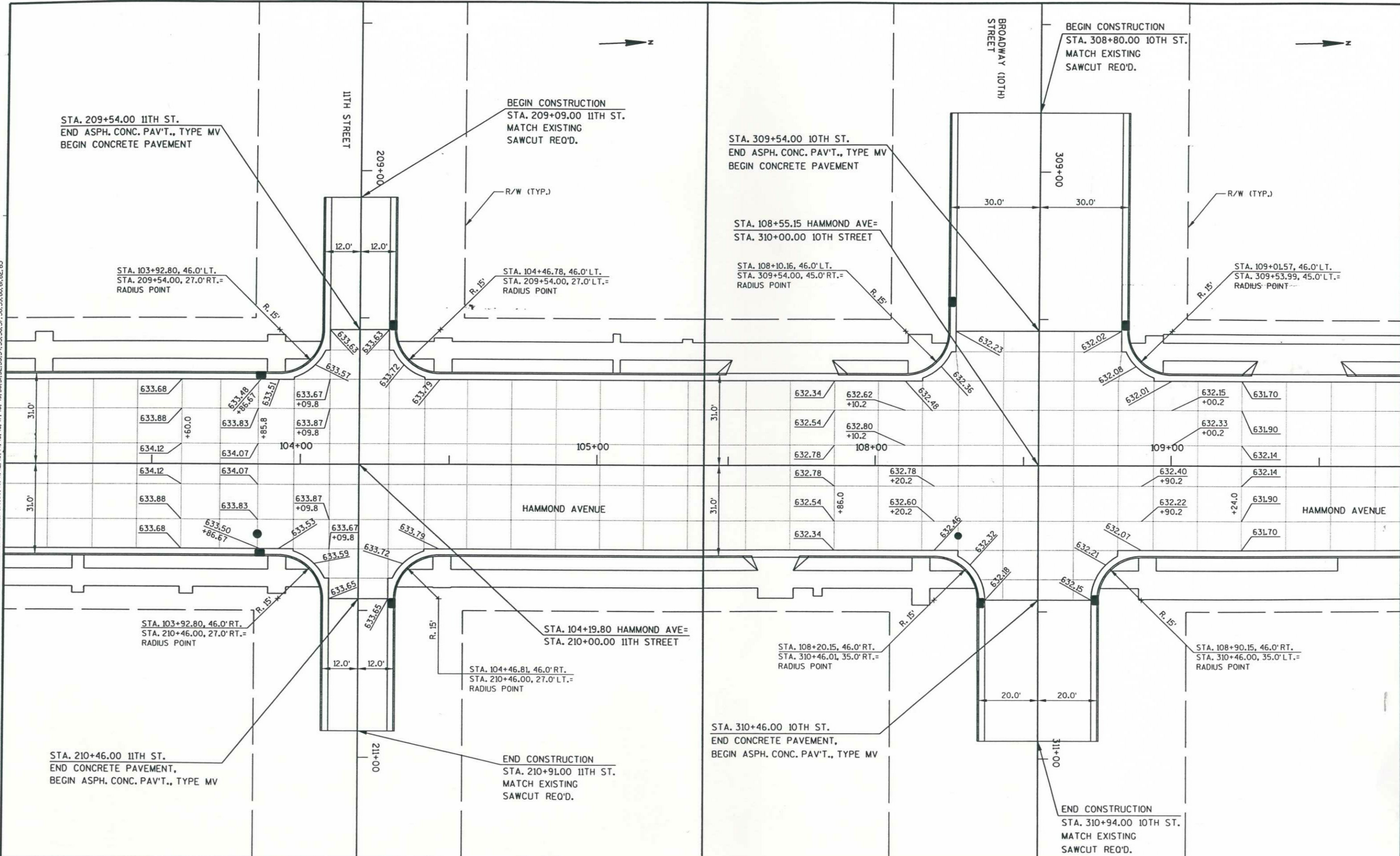

STATE PROJECT NUMBER: 8998-16-71 HWY: HAMMOND AVENUE COUNTY: DOUGLAS INTERSECTION DETAILS SCALE, FEET 0 30 SHEET NO: E

FILE NAME : e:\trans\super\9802.00\idham201.dgn PLOT DATE: 09 SEP 1999 PLOT TIME: 10:43:52 ORG DATE : PLOT NAME : Originator : Dist PLOT SCALE : N/A

LEVELS ON - 1, 2, 3, 4, 5, 6, 7, 8, 9, 10, 11, 12, 13, 14, 15, 16, 17, 18, 19, 20, 21, 22, 23, 24, 25, 26, 27, 28, 29, 30, 31, 32, 33, 34, 35, 36, 37, 38, 39, 40, 41, 42, 43, 44, 45, 46, 47, 48, 49, 50, 51, 52, 53, 54, 55, 56, 57, 58, 59, 60, 61, 62, 63

BEGIN STATE PROJECT
 NO. 8998-16-71
 STA 100+31.53
 N=574966.999
 E=1442400.010

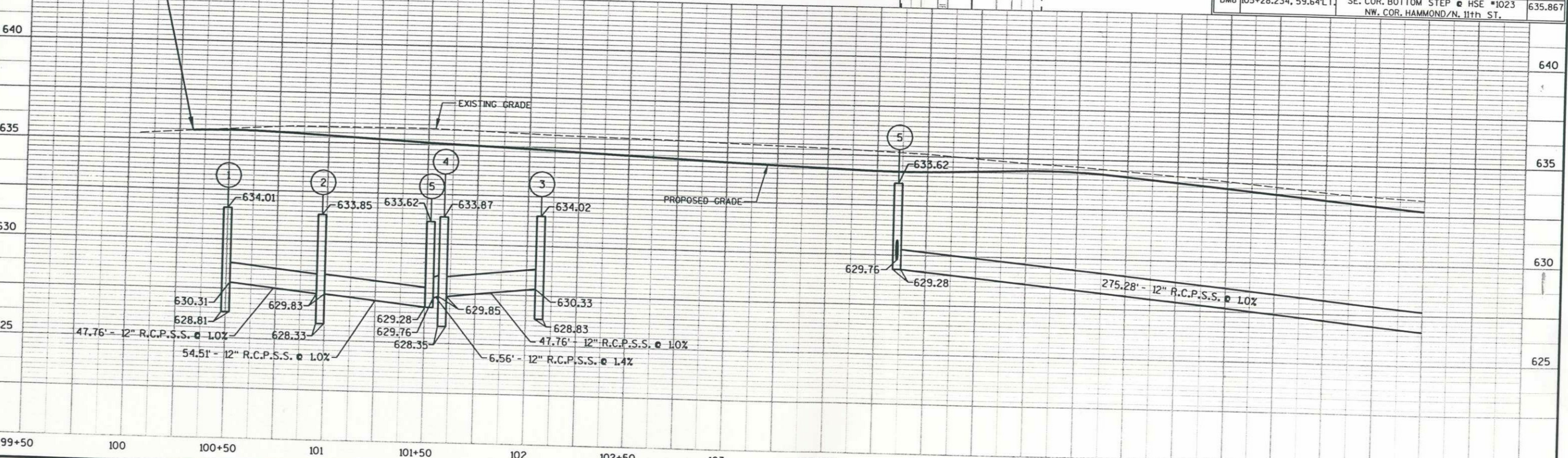
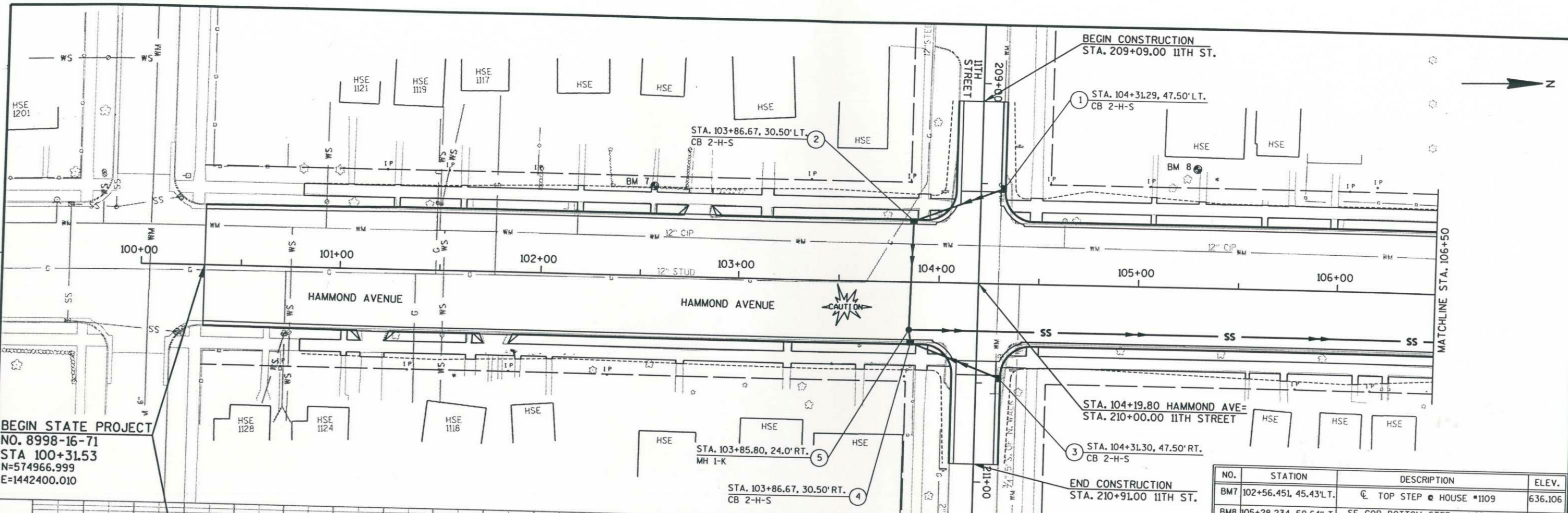

NO.	STATION	DESCRIPTION	ELEV.
BM7	102+56.45L, 45.43'L.	€ TOP STEP @ HOUSE #1109	636.106
BM8	105+28.234, 59.64'L.	SE. COR. BOTTOM STEP @ HSE #1023 NW. COR. HAMMOND/N. 11th ST.	635.867

LEVELS ON - 1, 2, 3, 4, 5, 6, 7, 8, 9, 10, 11, 12, 13, 14, 15, 16, 17, 18, 19, 20, 21, 22, 23, 24, 25, 26, 27, 28, 29, 30, 31, 32, 33, 34, 35, 36, 37, 38, 39, 40, 41, 42, 43, 44, 45, 46, 47, 48, 49, 50, 51, 52, 53, 54, 55, 56, 57, 58, 59, 60, 61, 62, 63

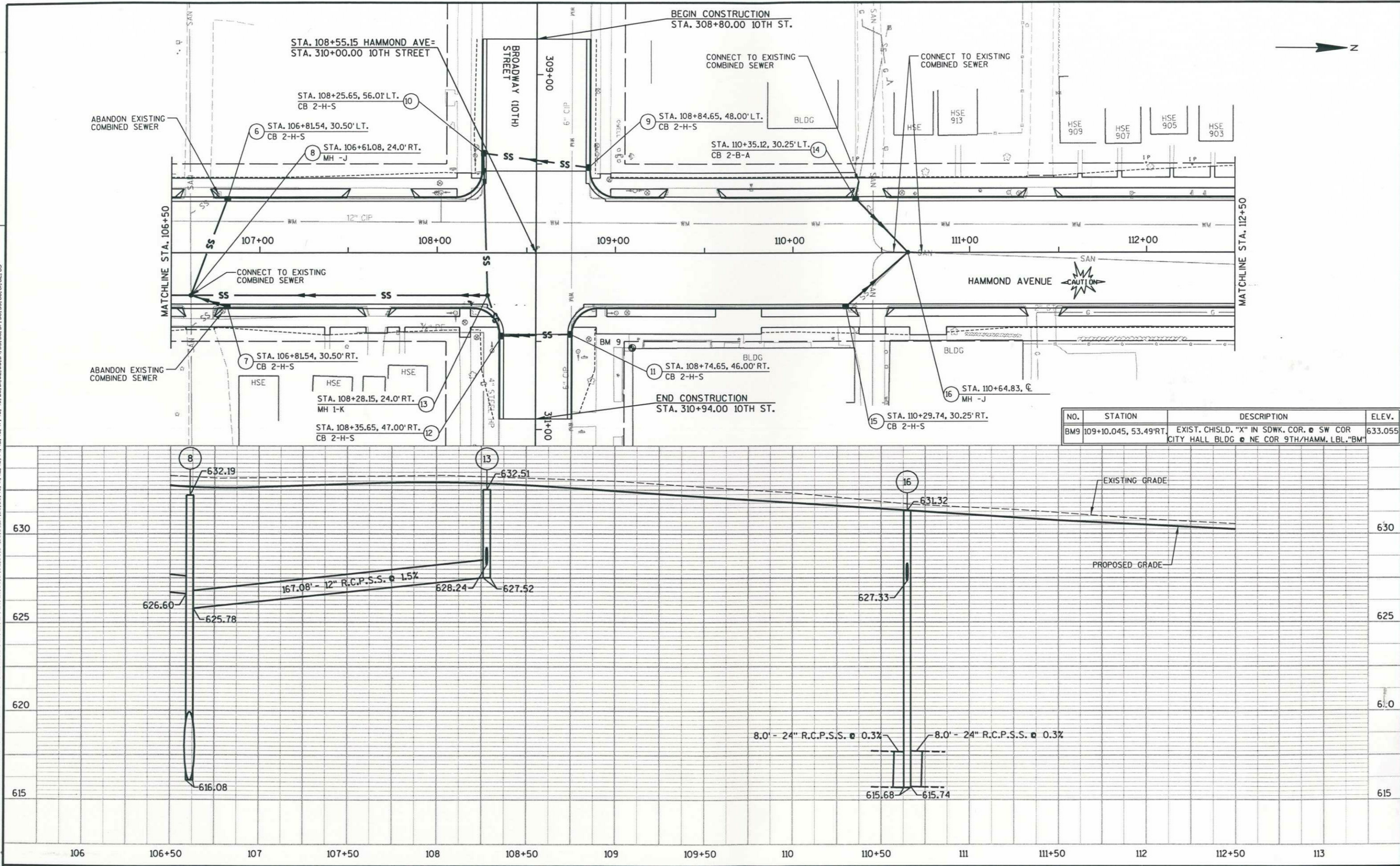

NO.	STATION	DESCRIPTION	ELEV.
BM9	109+10.045, 53.49' RT.	EXIST. CHISLD. "X" IN SDWK. COR. @ SW COR CITY HALL BLDG @ NE COR 9TH/HAMM. LBL. "BM"	633.055

STATE PROJECT NUMBER: 8998-16-71 HWY: HAMMOND AVENUE COUNTY: DOUGLAS STORM SEWER SHEET NO: E

LEVELS ON - 1, 2, 3, 4, 5, 6, 7, 8, 9, 10, 11, 12, 13, 14, 15, 16, 17, 18, 19, 20, 21, 22, 23, 24, 25, 26, 27, 28, 29, 30, 31, 32, 33, 34, 35, 36, 37, 38, 39, 40, 41, 42, 43, 44, 45, 46, 47, 48, 49, 50, 51, 52, 53, 54, 55, 56, 57, 58, 59, 60, 61, 62, 63

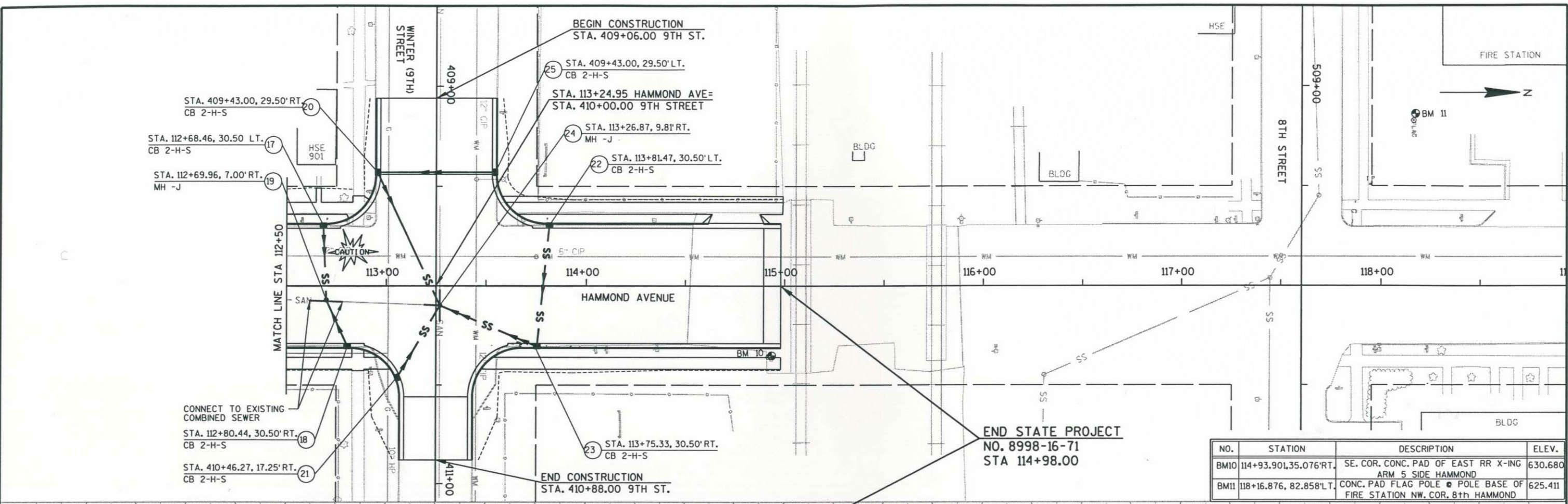

NO.	STATION	DESCRIPTION	ELEV.
BM10	114+93.90, 35.076 RT.	SE. COR. CONC. PAD OF EAST RR X-ING ARM 5 SIDE HAMMOND	630.680
BM11	118+16.876, 82.858 LT.	CONC. PAD FLAG POLE & POLE BASE OF FIRE STATION NW. COR. 8th HAMMOND	625.411



STATE PROJECT NUMBER: 8998-16-71 HWY: HAMMOND AVENUE COUNTY: DOUGLAS STORM SEWER SHEET NO: E

LEVELS ON - 1, 2, 3, 4, 5, 6, 7, 8, 9, 10, 11, 12, 13, 14, 15, 16, 17, 18, 19, 20, 21, 22, 23, 24, 25, 26, 27, 28, 29, 30, 31, 32, 33, 34, 35, 36, 37, 38, 39, 40, 41, 42, 43, 44, 45, 46, 47, 48, 49, 50, 51, 52, 53, 54, 55, 56, 57, 58, 59, 60, 61, 62, 63

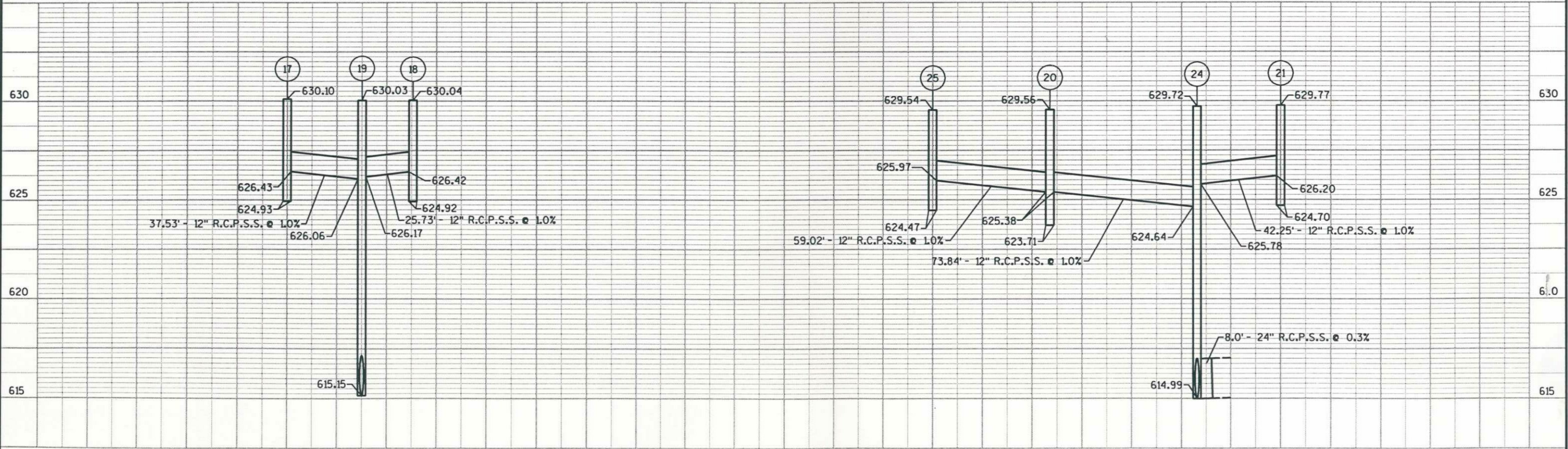
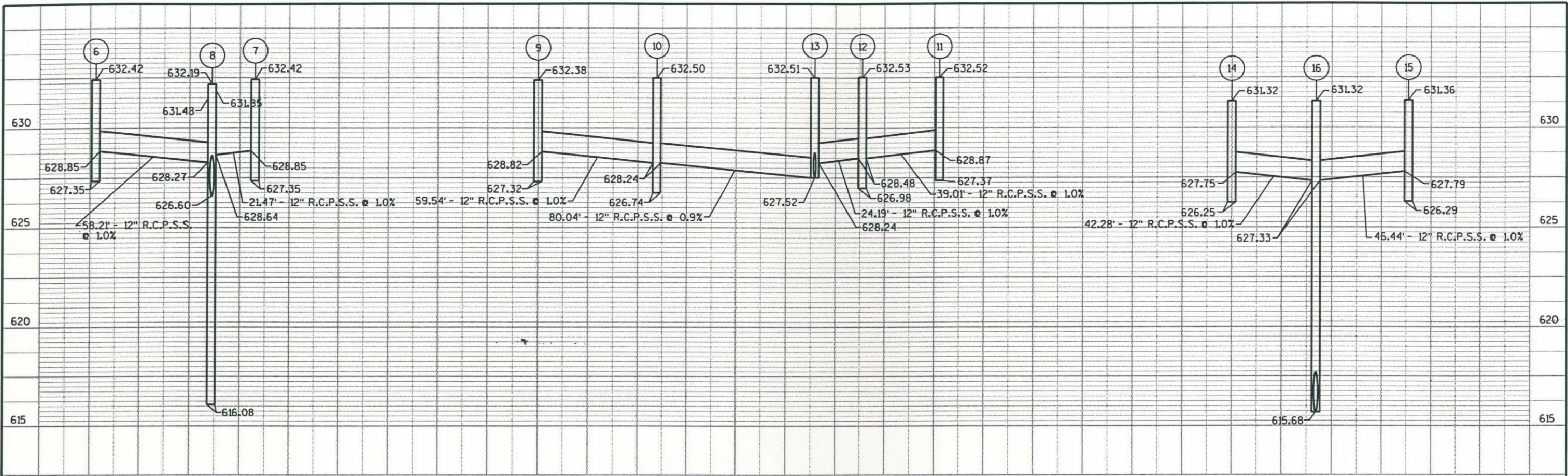

STATE PROJECT NUMBER: 8998-16-71	HWY: HAMMOND AVENUE	COUNTY: DOUGLAS	STORM SEWER	SHEET NO: E
----------------------------------	---------------------	-----------------	-------------	-------------

LEVELS ON - 1, 2, 3, 4, 5, 6, 7, 8, 9, 10, 11, 12, 13, 14, 15, 16, 17, 18, 19, 20, 21, 22, 23, 24, 25, 26, 27, 28, 29, 30, 31, 32, 33, 34, 35, 36, 37, 38, 39, 40, 41, 42, 43, 44, 45, 46, 47, 48, 49, 50, 51, 52, 53, 54, 55, 56, 57, 58, 59, 60, 61, 62, 63

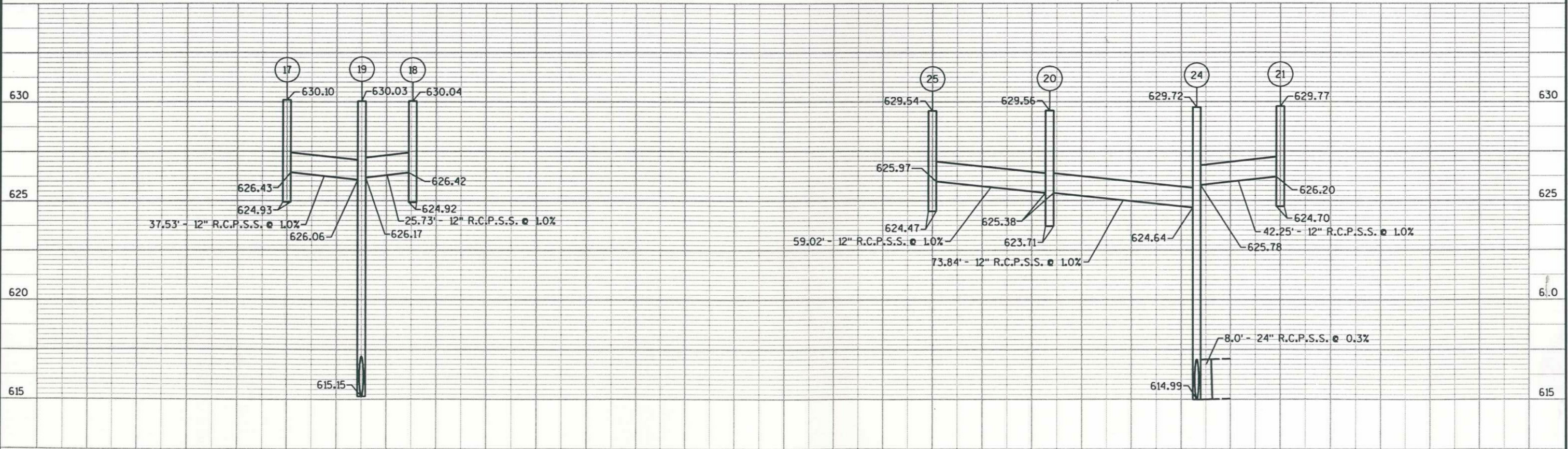
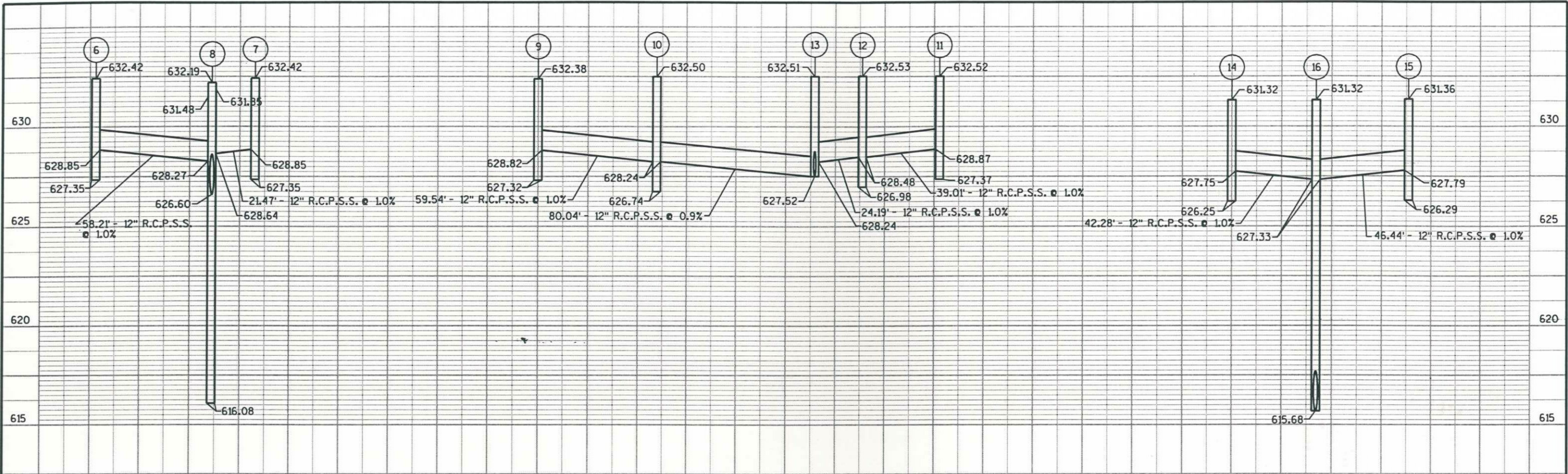

STATE PROJECT NUMBER: 8998-16-71	HWY: HAMMOND AVENUE	COUNTY: DOUGLAS	STORM SEWER	SHEET NO: E
----------------------------------	---------------------	-----------------	-------------	-------------