

CITY OF SUPERIOR
ENGINEERING DEPT
T.M. BASTERASH-CITY ENG.

PLAN SURVEYED
BY M. SKAMISER
DATE 5-28-38
NOTE BOOK NO. 177
BY T.M. BASTERASH

PROFILE SURVEYED
BY M. SKAMISER
DATE 5-28-38
NOTE BOOK NO. 177
BY T.M. BASTERASH

CITY OF SUPERIOR
ENGINEERING DEPARTMENT
T.M. BASTERASH-CITY ENG.

S.E. COR OF NE 1/4 SEC 35 (W. 1/4 COR SEC 36)
OPP STA 173+67.63

B.M. #165 ELEV. 70.87 NAIL IN P POLE 10' E & HILL AVE. STA 178+15
B.M. #166 ELEV. 67.97 NAIL IN P. POLE 12' E. & HILL AVE STA 179+90
B.M. #167 ELEV. 62.74 1 BOLT 22' E & HILL AVE STA. 190+40

S.E. COR SEC 35
OPP STA 200+07.92

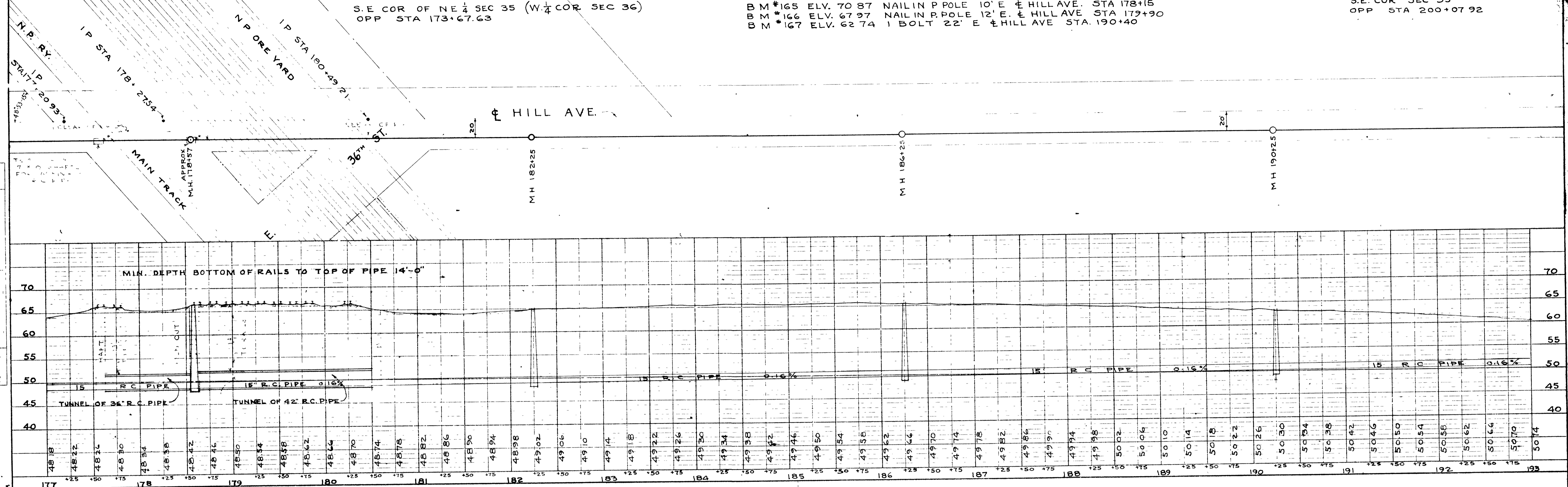

B.M. #167 ELEV. 62.74 1 BOLT 22' E & HILL AVE STA. 190+40
B.M. #168 ELEV. 64.43 1/2" x 6" PIPE SEC. COR. 35-36-2-1 STA 200+07.92
B.M. #169 ELEV. 59.42 1 BOLT 18' E & HILL AVE STA. 210+68

