

ALTERNATE No. 2  
 INSTALL 36" PIPE FROM M.H. "C" TO  
 M.H. "D" & FROM M.H. "D" TO DITCH.

Note: Storm Sewer On Hill Ave.  
 15' 10" From Back Of Curb.

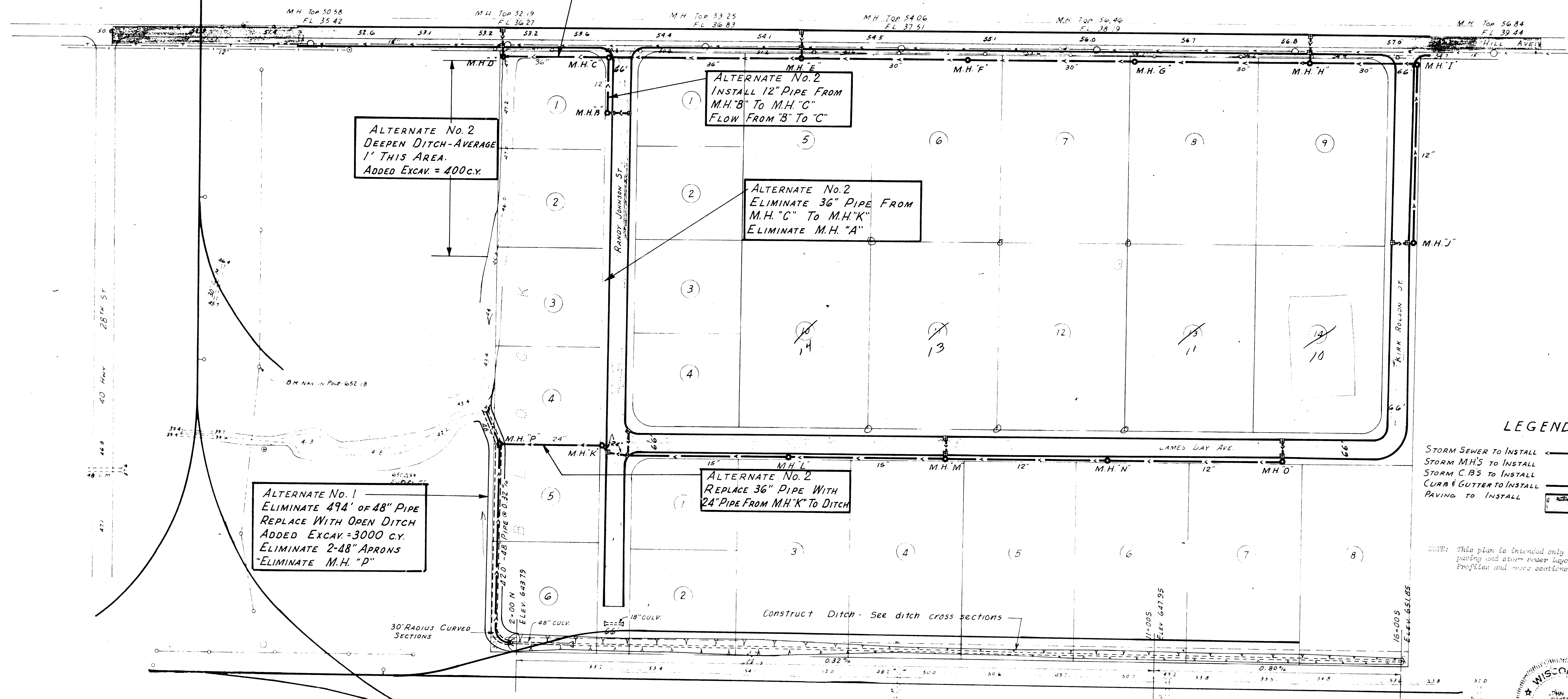

ALTERNATE No. 2  
 DEEPEN DITCH-AVERAGE  
 1' THIS AREA.  
 ADDED EXCAV. = 400 C.Y.

ALTERNATE No. 2  
 INSTALL 12" PIPE FROM  
 M.H. "B" TO M.H. "C"  
 FLOW FROM "B" TO "C"

ALTERNATE No. 2  
 ELIMINATE 36" PIPE FROM  
 M.H. "C" TO M.H. "K"  
 ELIMINATE M.H. "A"

ALTERNATE No. 1  
 ELIMINATE 494' OF 48" PIPE  
 REPLACE WITH OPEN DITCH  
 ADDED EXCAV. = 3000 C.Y.  
 ELIMINATE 2-48" APRONS  
 ELIMINATE M.H. "P"

ALTERNATE No. 2  
 REPLACE 36" PIPE WITH  
 24" PIPE FROM M.H. "K" TO DITCH

LEGEND

- STORM SEWER TO INSTALL
- STORM M.H.'S TO INSTALL
- STORM C.B.'S TO INSTALL
- CURB & GUTTER TO INSTALL
- PAVING TO INSTALL

NOTE: This plan is intended only to show the general paving and storm sewer layouts. See Plan - Profiles and more sections for details.



I hereby certify that this plan, specification, or report was prepared by me or under my direct supervision and that I am a duly Registered Professional Engineer under the laws of the State of Wisconsin.

John J. Baker  
 John J. Baker  
 March 12, 1974 Reg. No. E-13059



As BUILT Nov. 1975

STORM SEWER AND PAVING PLAN	
SUPERIOR INDUSTRIAL PARK	
DATE: 11/1/74	ROBERT R. WALLACE & ASSOC., INC. HIBBING, MINNESOTA
PROJECT: E.D.A. 06-01-01127	Sheet: 6 of 29