

PLAN	NO.	NOTE BOOK	ALIGNED CHECKED BY	DATE

PROFILE	NO.	NOTE BOOK	STRUCTURE NOTATIONS (BY)	DATE

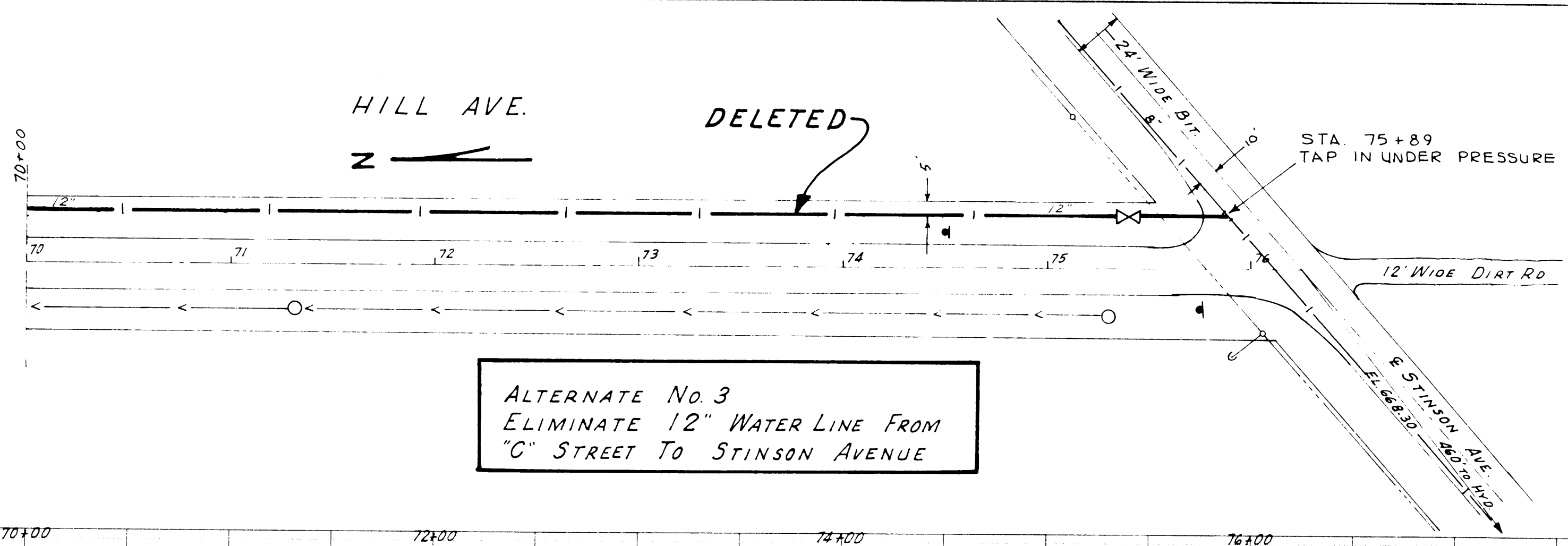

**ALTERNATE No. 3
ELIMINATE 12" WATER LINE FROM
"C" STREET TO STINSON AVENUE**

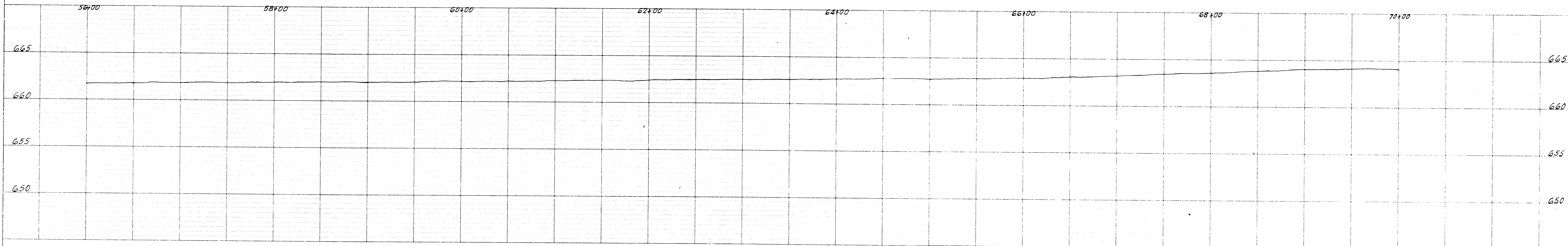
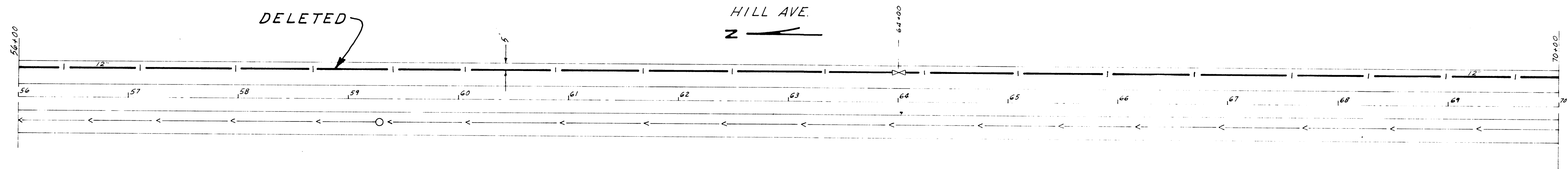
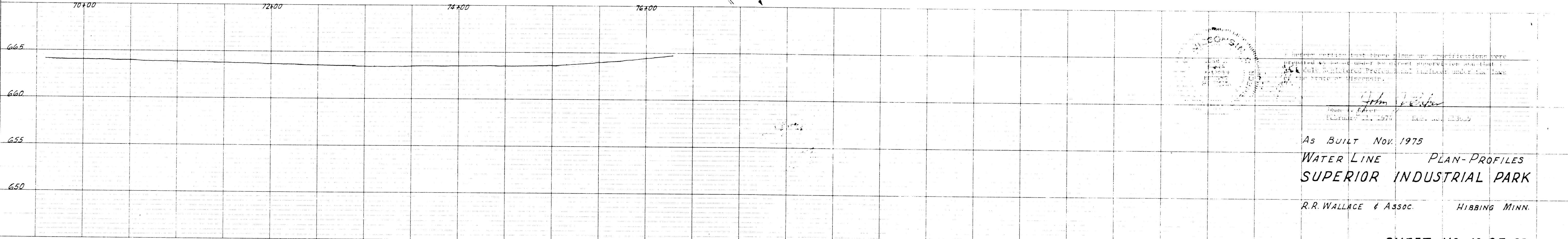

LEGEND

Water Line to Install: ————
 Gate Valve to Install: X
 Existing Water Line: - - - - -
 Existing Sewer: ————
 Existing Sewer Line: ————

Scale: Plan 1" = 50'
 Profile 1" = 5' Horizontal
 1" = 5' Vertical

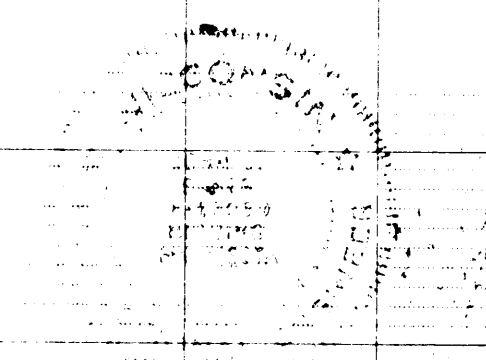

I hereby certify that these plans and specifications were prepared by me or under my direct supervision and that I am a duly Licensed Professional Engineer under the laws of the State of Wisconsin.

John J. Wallace
 John J. Wallace
 Licensed Professional Engineer
 Wisconsin No. 12345
 Exp. 12/31/77

As BUILT Nov. 1975
WATER LINE PLAN-PROFILES
SUPERIOR INDUSTRIAL PARK
 R.R. WALLACE & ASSOC. HIBBING MINN.

SHEET NO. 13 OF 29