

EROSION CONTROL AND CONSTRUCTION SEQUENCE NOTES

1. THE DEVELOPER IS RESPONSIBLE FOR COMPLIANCE AND ENFORCEMENT OF THE REGULATIONS AND ORDINANCES SET FORTH IN THE PLANS AND SPECIFICATIONS. THE DEVELOPER IS RESPONSIBLE AT THE START OF CONSTRUCTION AND UNTIL INDIVIDUAL LOT OWNERSHIP IS ESTABLISHED.
2. THE INTENT OF THE GRADING IS TO KEEP THE DISTURBANCE OF THE EXISTING GROUND SURFACE TO A MINIMUM. ANY GROUND SURFACE WHICH IS DISTURBED BY A CUT OR FILL SHALL BE PERMANENTLY SEEDED WITH WDOT CLASS 1 SEEDING AND MULCH.
3. SOIL EROSION AND SEDIMENTATION CONTROL MEASURES ARE SHOWN ON THE PLANS AND ARE LISTED BELOW:
  - A. MAINTENANCE AND MINIMAL DISTURBANCE OF EXISTING GROUND COVER
  - B. STRAW BALES AT ALL CATCH BASINS AND INLETS.
  - C. STRAW BALES ALONG DITCHES AND SWALES.
  - D. RIP-RAP AT ALL PROPOSED OUTLET CONTROL PIPES.
  - E. ANY DISTURBED GROUND SURFACE TO BE SEEDED AND MULCHED.
  - F. 150' GRAVEL CONSTRUCTION ROADS AT ALL ENTRANCES.
  - G. TEMPORARY SILTATION BASINS ESTABLISHED.

4. CONSTRUCTION SEQUENCE AND THE EROSION CONTROL TAKEN ARE LISTED BELOW:

LEGEND:

- I. ROAD CLEARING
  - A. STABILIZED CONSTRUCTION ENTRANCE.
  - B. PRESERVE AND PROTECT EXISTING LOW LEVEL VEGETATION.
  - C. STRAW BALES IN DITCH LINE.
  - D. TEMPORARY SEEDING AND MULCH IN DISTURBED AREAS.
- II. ROAD EXCAVATION AND SIDE YARD SWALES
  - A. MAINTAIN EROSION CONTROL PLAN.
  - B. STRAW BALES ALONG DITCH LINES.
  - C. PERMANENT SEEDING AND MULCH IN SIDE YARD SWALES, DISTURBED AREAS, AND ROAD SWALES.
  - D. AGGREGATE COVER OVER SUBGRADE.
  - E. MAINTAIN POSITIVE DRAINAGE AT ALL TIMES.
- III. DETENTION BASIN CONSTRUCTION
  - A. MAINTAIN EROSION CONTROL PLAN.
  - B. RIP-RAP AT OUTLET CONTROL PIPES.
  - C. PERMANENT SEEDING AND MULCH IN DETENTION BASIN AND BERMS WHERE DISTURBED.
  - D. CONSTRUCT AND MAINTAIN TEMPORARY SILTATION BASINS.
- IV. STORM SEWER
  - A. MAINTAIN EROSION CONTROL PLAN AND SILTATION BASINS
  - B. STRAW BALES AROUND INLET AND CATCH BASIN STRUCTURES.
  - C. PERMANENT SEEDING AND MULCH AROUND DISTURBED AREAS.
  - D. STORM SEWER AND LINED CHANNEL INSTALLATION
- V. ROAD CONSTRUCTION
  - A. MAINTAIN EROSION CONTROL PLAN AND SILTATION BASINS.
  - B. PAVING.
- VI. HOME SALES AND BASEMENT EXCAVATION
  - A. MAINTAIN EROSION CONTROL PLAN.
  - B. REMOVE TEMPORARY SILTATION BASINS WHEN 80% OF ALL HOUSES IN THEIR DRAINAGE BASIN AREA ARE BUILT.
  - C. PROVIDE AND MAINTAIN EROSION CONTROL MEASURES ON AN INDIVIDUAL LOT BASIS AS HOMES ARE CONSTRUCTED.
  - D. LANDSCAPING AND SODDING OR SEEDING AS LOT SALES PROGRESS.

SEE INDIVIDUAL PLAN SHEETS FOR CORRESPONDING ENGINEERING IMPROVEMENTS.

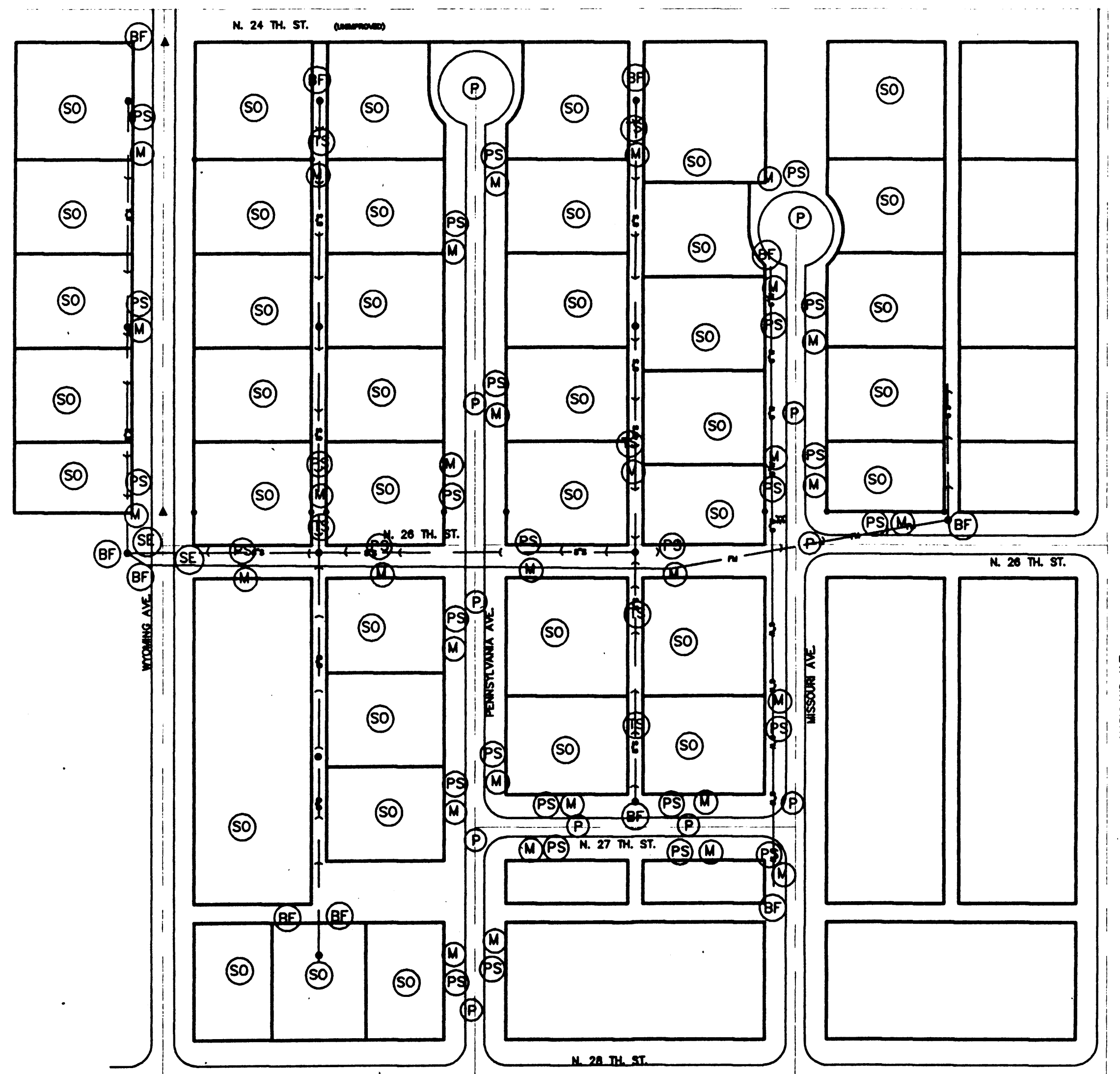

LOCATION PLAN

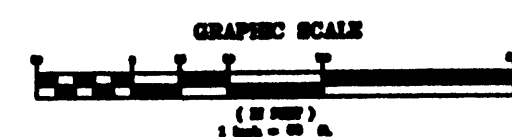

SOILS PROTECTION CHART

STABILIZATION TYPE	JAN.	FEB.	MAR.	APR.	MAY	JUNE	JULY	AUG.	SEPT.	OCT.	NOV.	DEC.
PERMANENT SEEDING						*	*	*	*			
TEMPORARY SEEDING												
SODDING **												
MULCHING												

\* IRRIGATION NEEDED JUNE, JULY, AUG. AND SEPT.  
 \*\* IRRIGATION NEEDED FOR 2-3 WEEKS AFTER INSTALLATION  
 NOTE: SEEDING AND MULCHING SHALL FOLLOW WDOT STANDARDS

NO.	DATE	DESCRIPTION	BY
1	1-20-93	ADD F.M.	CRI



**C.R.I. ENGINEERING**  
 Civil Engineering  
 Land Planning  
 Construction Management

12 BADGER DRIVE SUPERIOR, W. 54880  
 (715) 394 7338

**BILLINGS PARK SAN. EXT.  
 EROSION CONTROL PLAN**

MAY 12, 1992 SHEET # 7