

PIPE & FITTINGS SHALL MEET THE REQUIREMENTS FOR PVC SEWER PIPE A.S.T.M. D-3034.

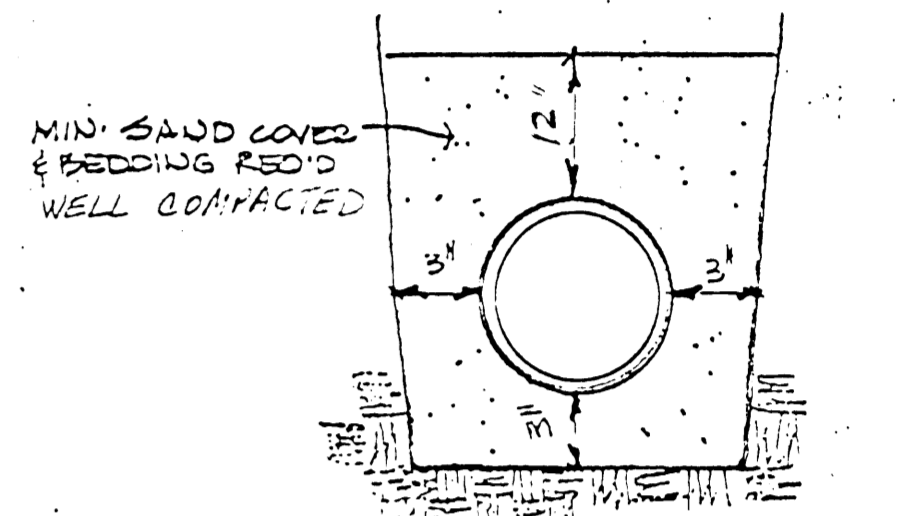

CITY OF SUPERIOR SANITARY SEWER EXTENSION N. 46 TH ST.

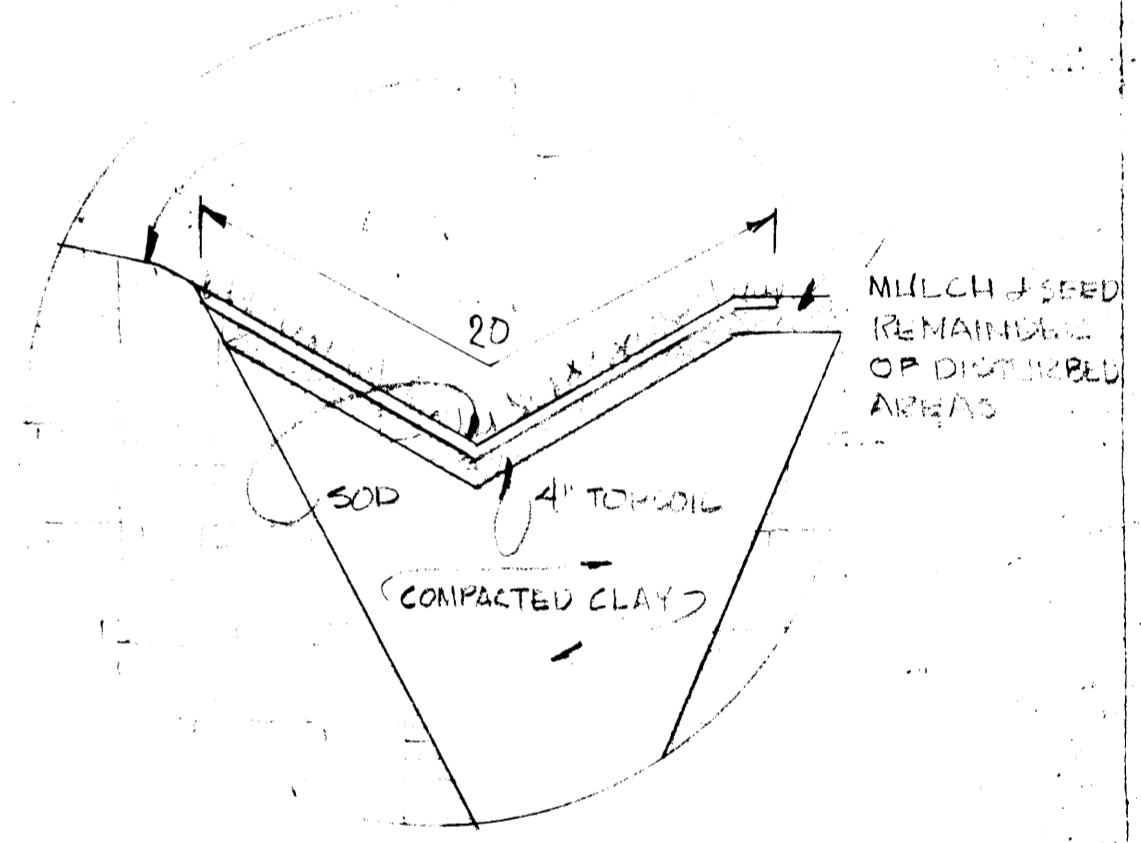
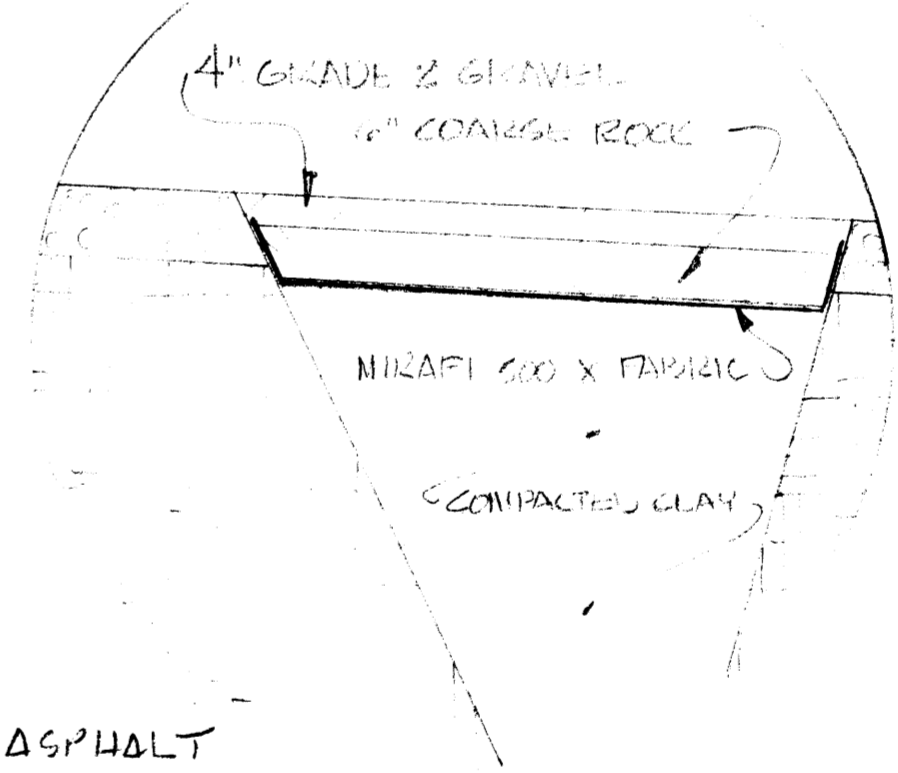
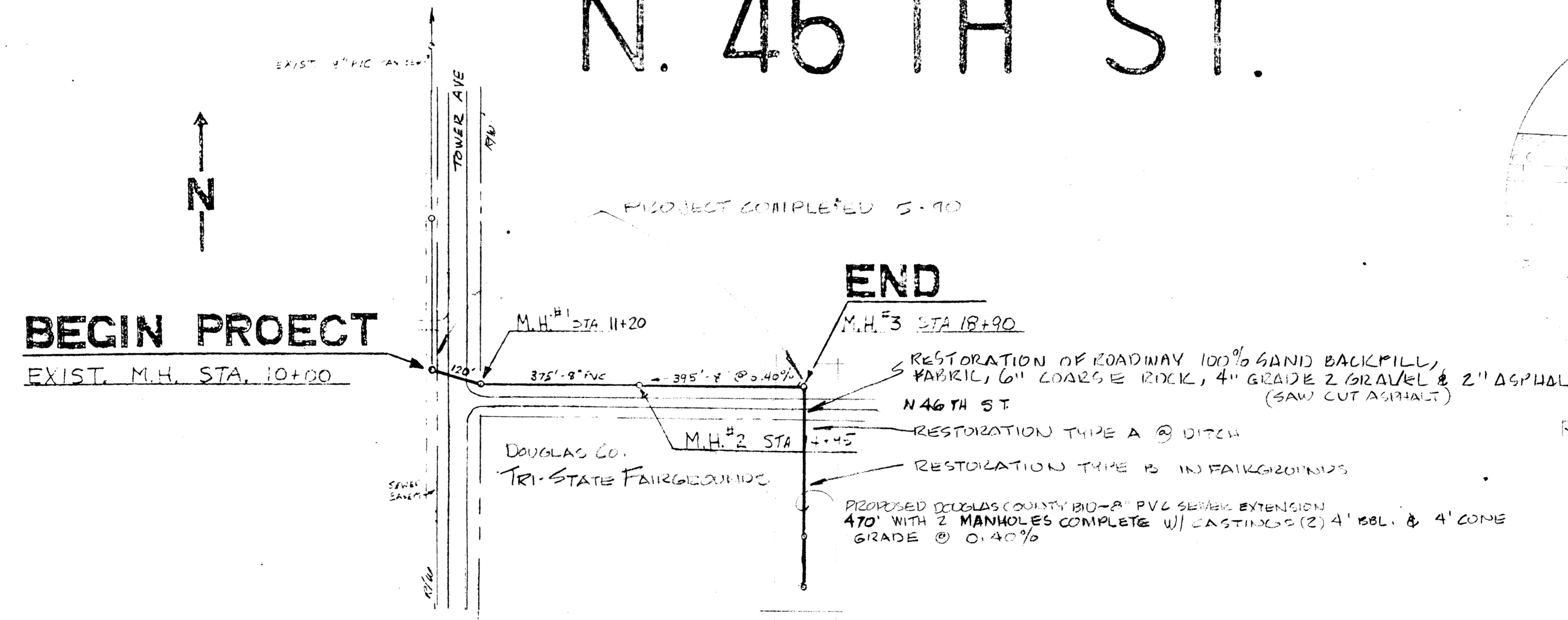

RESTORATION TYPE A
STA. 10+00 TO 17+70 EXCEPT CASING AREA

RESTORATION TYPE B
STA. 17+70 TO 18+90

LOCATION PLAN

SCALE: 1" = 200'

CONSTRUCTION NOTES:
 Utilities shown on these plans are approximate locations only. Contractor is responsible for all utility locations.
 CONTACT Superior Water Light and Power Company for all water, gas, and electric utility locations.
 CONTACT Wisconsin Bell Telephone for all underground telephone cables.
 CONTACT Group W Cable T.V. for all cable T.V. lines.
 Contractor is responsible for coordination with all utility companies for all relocations, etc. for all underground or overhead utilities.
 Contractor is responsible for the cost of utility relocations unless specifically excluded elsewhere in the specifications.
 Contractor is responsible for all pavement crossings. Pavement shall be neatly sawcut. Subgrade and pavement shall be restored to the original condition.
 Contractor shall coordinate with the City of Superior Public Works Department for location of City owned storm and sanitary sewers or other facilities. Contractor shall coordinate with the City Plumbing Inspector for construction of sanitary sewers.

REVIEWED AND APPROVED BY THE DIVISION FOR ENVIRONMENTAL QUALITY, DEPT. OF NATURAL RESOURCES IN ACCORDANCE WITH DEC 1984 WIS. STAT. SUBJECT TO THE CONDITIONS SET FORTH IN THE LETTER OF APPROVAL.
 L. F. WIBLE, ADMINISTRATOR
 APPROVAL NUMBER 98-0672
 APPROVAL DATE 2/17/90

CITY OF SUPERIOR SANITARY SEWER EXTENSION

SIGNATURE: *[Signature]* DATE: 1-23-90

APPROVED FOR THE CITY OF SUPERIOR BY: LEONARD M. PETERSON, DIRECTOR OF PUBLIC WORKS

ENG. GEORGE C. LAVALLEY, JR.
 1-15-90
 E19991