

10
COLOR CODE

As Built
12-3-79

REVISION 4-3-79
STORM SEWER
E STREET GRADE
21 ST ST+18E TO 4+40E
DRN.: D. E. SARNO
DESIGN: CHRIS ZOPPA
CHECK: CHRIS ZOPPA



PLAN
NO. 10
DATE 12-3-79
BY [signature]
CHECKED [signature]

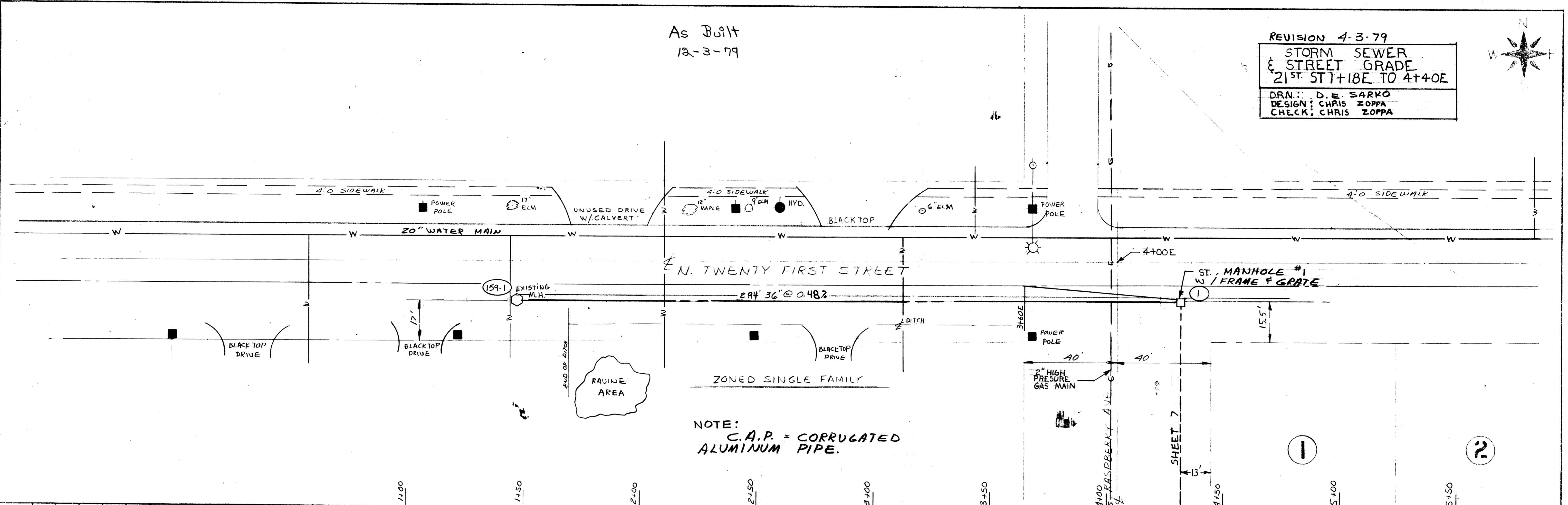

NOTE:
C.A.P. = CORRUGATED
ALUMINUM PIPE.

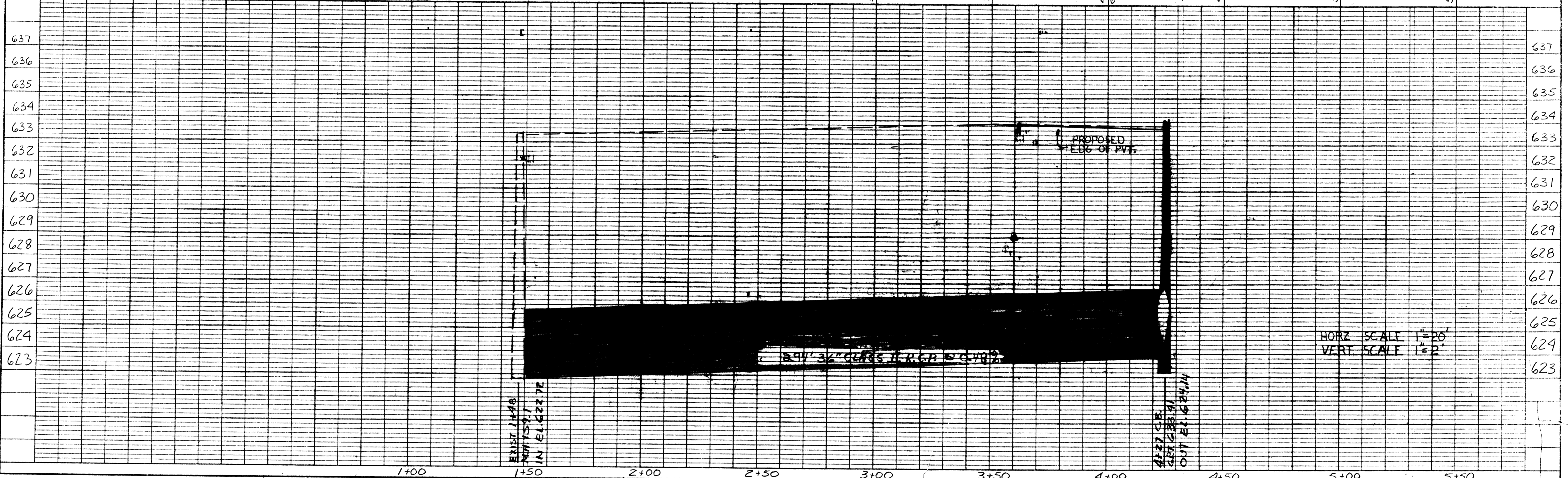

HORIZ SCALE 1"=20'
VERT SCALE 1"=2'

PROFILE
NO. 10
DATE 12-3-79
BY [signature]
CHECKED [signature]

K&E PLATE 1, PLAN-PROFILE
KREFFEL & ESSER CO.
48 7008 ALBANY, N.Y. 12208

SHEET 5 of 11