

660	CB-122A 654.12	MH-122 654.92	MH-118B 652.89	MH-118 652.63	MH-119A 653.18	CB-14B 640.64	CBMH-14A 640.64	MH-52 641.63	RELOCATED 4" LP GAS MAIN -0.58%	CBMH-13A 641.78	MH-S12 642.66	CBMH-12A 642.56	MH-8 643.16	CB-12B 642.55	CBMH-12A 642.56	650
650	160.5'-12" RCP @ 0.65%															650
640	18.5'-12" RCP @ 0.38%															640
630	259'-15" RCP CL IV @ 0.20%															630
	31'-12" RCP @ 1.39%															630
	31'-12" RCP @ 2.45%															630
	57.5'-15" RCP CL III @ 0.16%															630
	3'-12" RCP @ 3.19%															630

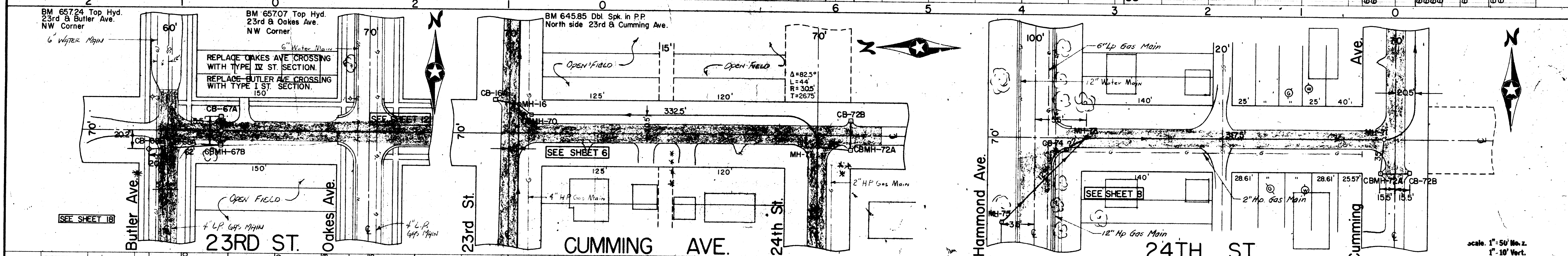

660	MH-68 653.85	CB-68B 653.86	CBMH-67B 652.73	MH-67 653.39	MH-67 652.65	MH-16 645.31	CBMH-70 645.01	MH-71 647.92	CBMH-72A 647.16	CB-72B 647.09	MH-73 648.34	MH-71 647.92	CB-74 647.80	MH-73 648.34	660	
650	15'-12" RCP @ 0.44%															650
640	353'-15" RCP CL II @ 0.18%															640
630	62'-12" RCP @ 0.44%															630
	15'-15" RCP CL II @ 0.32%															630
	15.5'-12" RCP @ 3.35%															630
	15'-42" RCP CL II @ 2.73%															630
	332.5'-42" RCP CL II @ 0.55%															630
	11'-42" RCP LONG RADIUS BENDS (30.5R)															630
	35'-12" RCP @ 1.31%															630
	317.5'-42" RCP CL II @ 0.17%															630
	22' 12" RCP @ 4.04%															630