

Central Office John Ave



Utility Hole



All work within existing conduit and Utility Holes

7 West Tap House

Manion Foods

15th St

Doc's Gym & Tanning Superior, WI

Belknap St

Superior

Super One Foods

Heritage Window & Door

Garfield Ave

Elmira Ave

N 16th

N 17th

Please verify conduit route from CO on John Ave going west to MH 01 then west to MH 4007

Please verify duct and pull 3-1.25" ID through between MH's, make sure to add pull string in each 1.25" ID

West to MH 4003 on Kwik Trip property between building and pumps

MH and conduit run in alley north of Belknap Ave (Hwy 2 and 14th ST

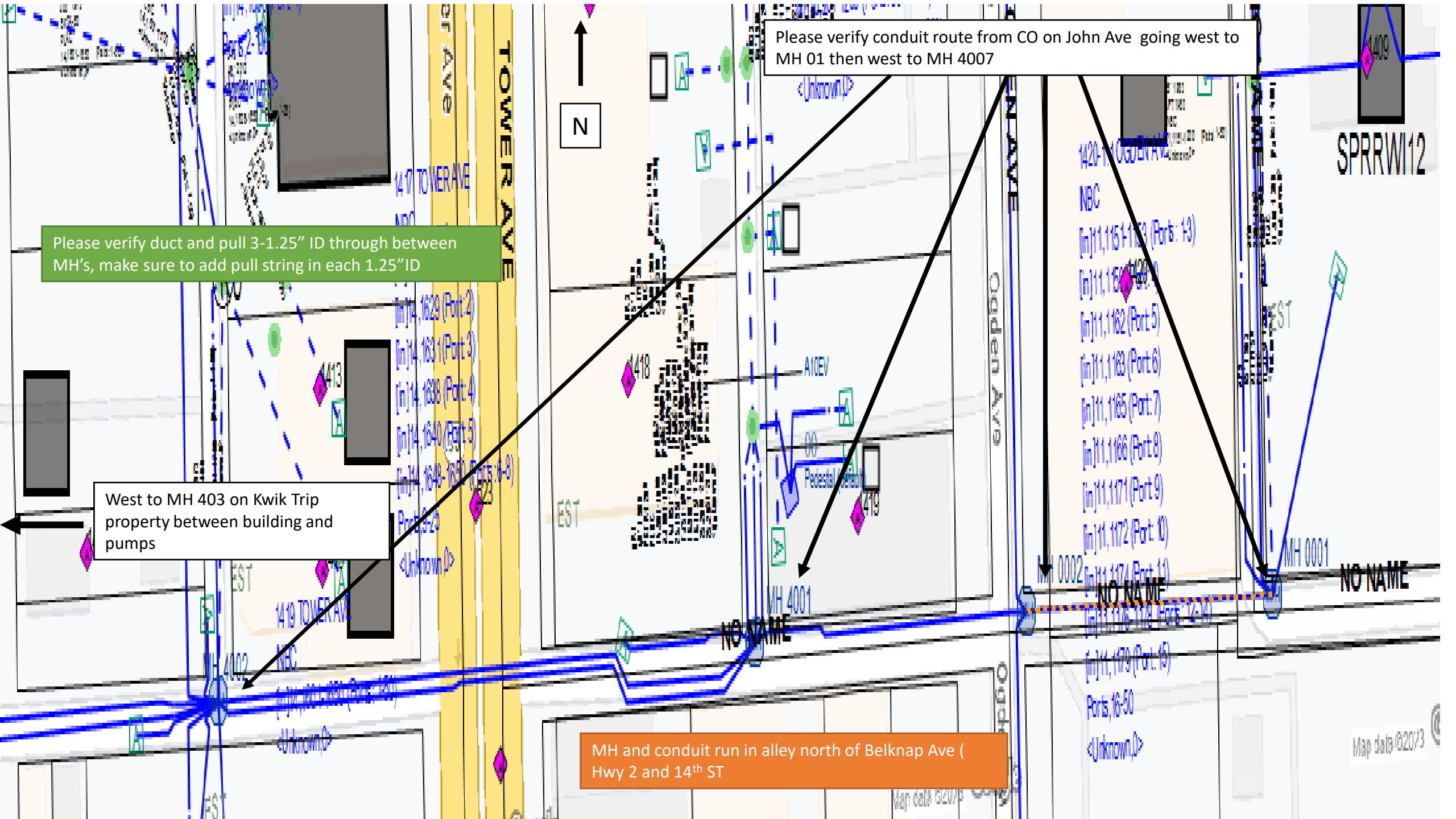

SPRRW12

Map data 8/20/13



MH 4003 in Kwik Trip lot between building and pumps

Please verify duct and pull 3-1.25" ID through between MH's, make sure to add pull string in each 1.25" ID

MH and conduit run in alley north of Belknop Ave (Hwy 2 and 14th ST

Conduit run turns south

Conduit turns west on south side of Belknop (Hwy 2)

MH 4006 west across bridge

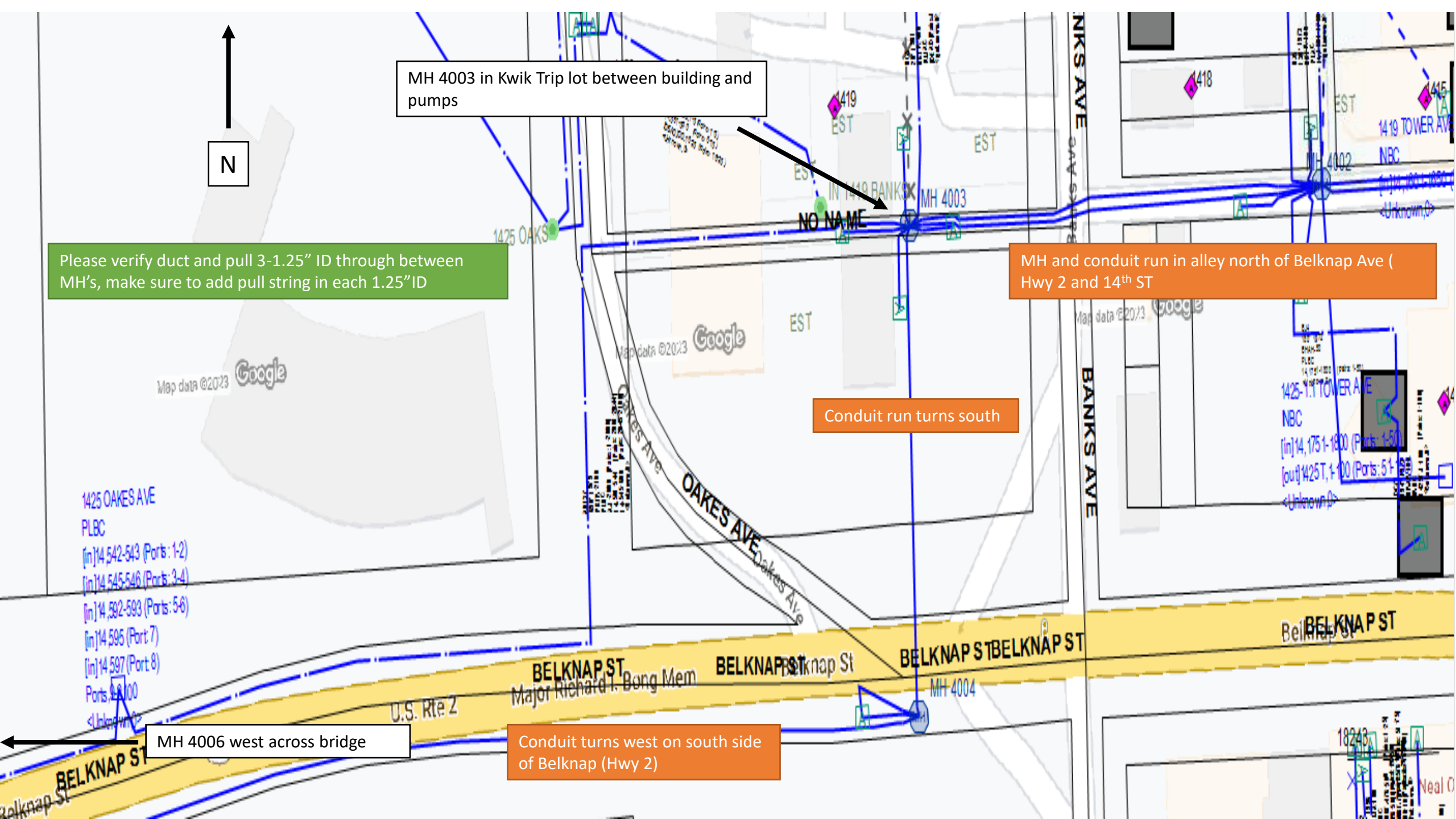

Please verify duct and pull 3-1.25" ID through between MH's, make sure to add pull string in each 1.25" ID

MH 4004 east towards CO

MH 4007 in dirt alley west of Garfield Ave

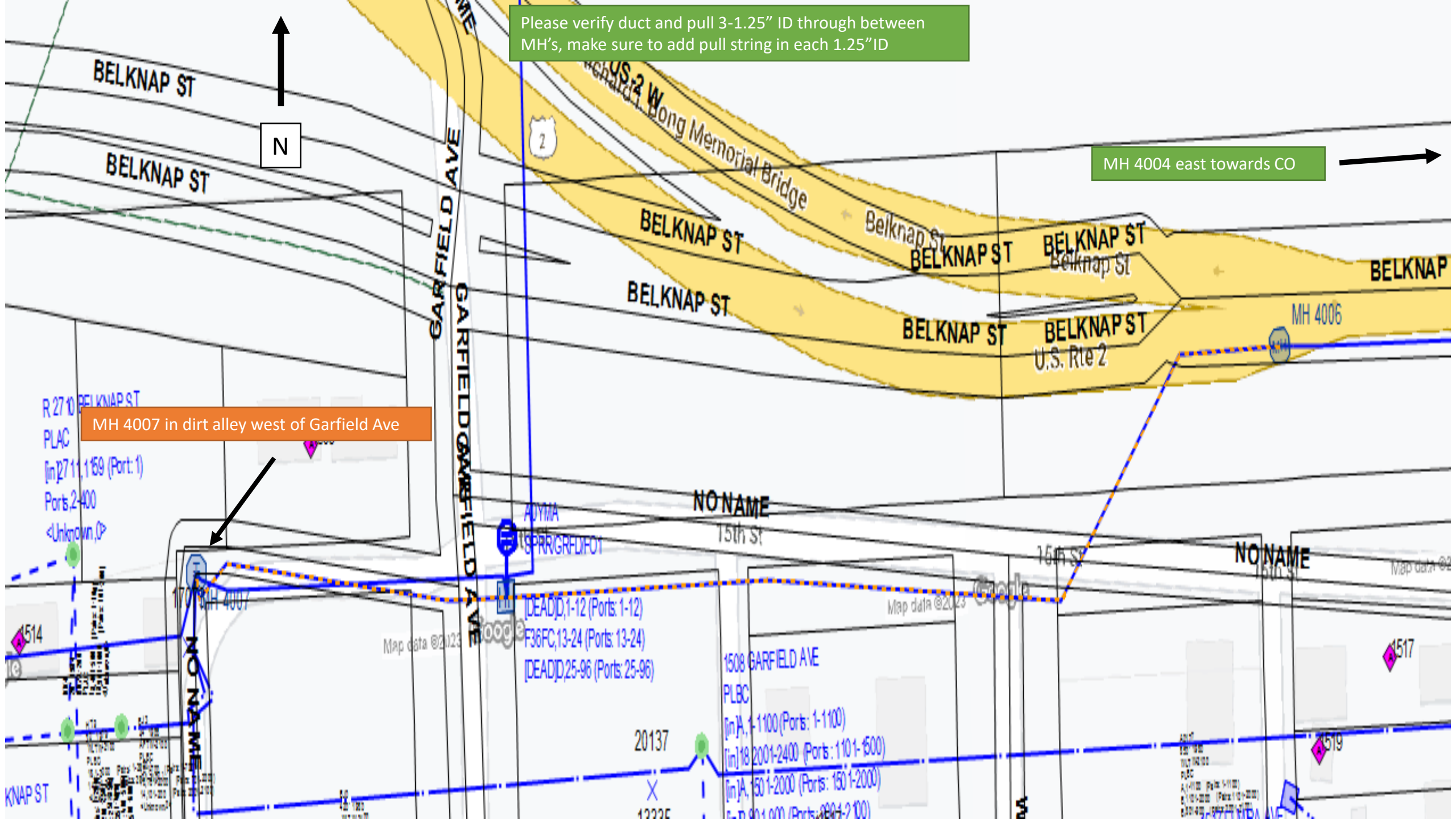



Utility work ahead

lane closed sign



Work area

Utility hole

Rt turn lane close for 276' to create safe work area at utility hole, 22 cones placed at beginning of turn lane to point of end of construction, where vehicles can use turn lane again



Non-Freeway/Expressway OR MULTILANE DIVIDED 45 and under

Posted Speed Limit Prior to Work Starting (mph)		Advance Warning Sign Spacing (A) feet	Decision Sight Distance (D) feet	Taper Length (12 ft lane) (L) feet	Shifting Taper (12 ft lane) (L/2) feet	Buffer Space (B) feet
0-25	G=25ft	200	550	125 (5)	65 (3)	55 (1)
30		200	550	180 (8)	90 (4)	85 (2)
35		350	700	245 (10)	125 (5)	120 (3)
40		350	700	320 (13)	160 (7)	170 (4)
45	G=50ft	500	900	540 (11)	270 (5)	220 (2)
50		500	900	600 (12)	300 (6)	280 (3)
55		500	1200	660 (13)	330 (7)	335 (3)

