

1906 PLATBOOK

MINIS WOODS

PLATBOOK

Stack & Lynch
1960
Madison, Wis.

L95-2-10

MAP OF Douglas County

WISCONSIN
1900

compiled and published
A. DENITZ and H. RETTINGHOUSE
Scale: 1 inch to 1 mile

REFERENCES

WAGON ROADS	AG.	FINAL CERTIFICATE
RAILROADS	CE.	CASH ENTRY
SCHOOLS, HOUSES	SA.	GOLDEN ANGLE SCRIP
GOVERNMENT LAND	FR.	FOREST RESERVE SCRIP
STATE LAND	TA&A.	TIMBERLAND APPLICATION
HOMESTEAD ENTRY	IA.	INDIAN ALLOTMENT

VAN. VALKENBURGH MAP & LITHO. CO.

ROCKFORD ILL.

INDEX.

	PAGE		PAGE
T. 43 N.—R. 10 W.	1	T. 46 N.—R. 14 W.	23
T. 43 N.—R. 11 W.	2	T. 46 N.—R. 15 W.	24
T. 43 N.—R. 12 W.	3	T. 47 N.—R. 10 W.	25
T. 43 N.—R. 13 W.	4	T. 47 N.—R. 11 W.	26
T. 43 N.—R. 14 W.	5	T. 47 N.—R. 12 W.	27
T. 43 N.—R. 15 W.	6	T. 47 N.—R. 13 W.	28
T. 44 N.—R. 10 W.	7	T. 47 N.—R. 14 W.	29
T. 44 N.—R. 11 W.	8	T. 47 N.—R. 15 W.	30
T. 44 N.—R. 12 W.	9	T. 48 N.—R. 10 W.	31
T. 44 N.—R. 13 W.	10	T. 48 N.—R. 11 W.	32
T. 44 N.—R. 14 W.	11	T. 48 N.—R. 12 W.	33
T. 44 N.—R. 15 W.	12	T. 48 N.—R. 13 W.	34
T. 45 N.—R. 10 W.	13	T. 48 N.—R. 14 W.	35
T. 45 N.—R. 11 W.	14	T. 48 N.—R. 15 W.	36
T. 45 N.—R. 12 W.	15	T. 49 N.—R. 10 W.	37
T. 45 N.—R. 13 W.	16	T. 49 N.—R. 11 W.	38
T. 45 N.—R. 14 W.	17	T. 49 N.—R. 12 W.	39
T. 45 N.—R. 15 W.	18	T. 49 N.—R. 13 W.	40
T. 46 N.—R. 10 W.	19	T. 49 N.—R. 14 W.	41
T. 46 N.—R. 11 W.	20	T. 49 N.—R. 15 W.	42
T. 46 N.—R. 12 W.	21		
T. 46 N.—R. 13 W.	22		

3

T. 43 N.

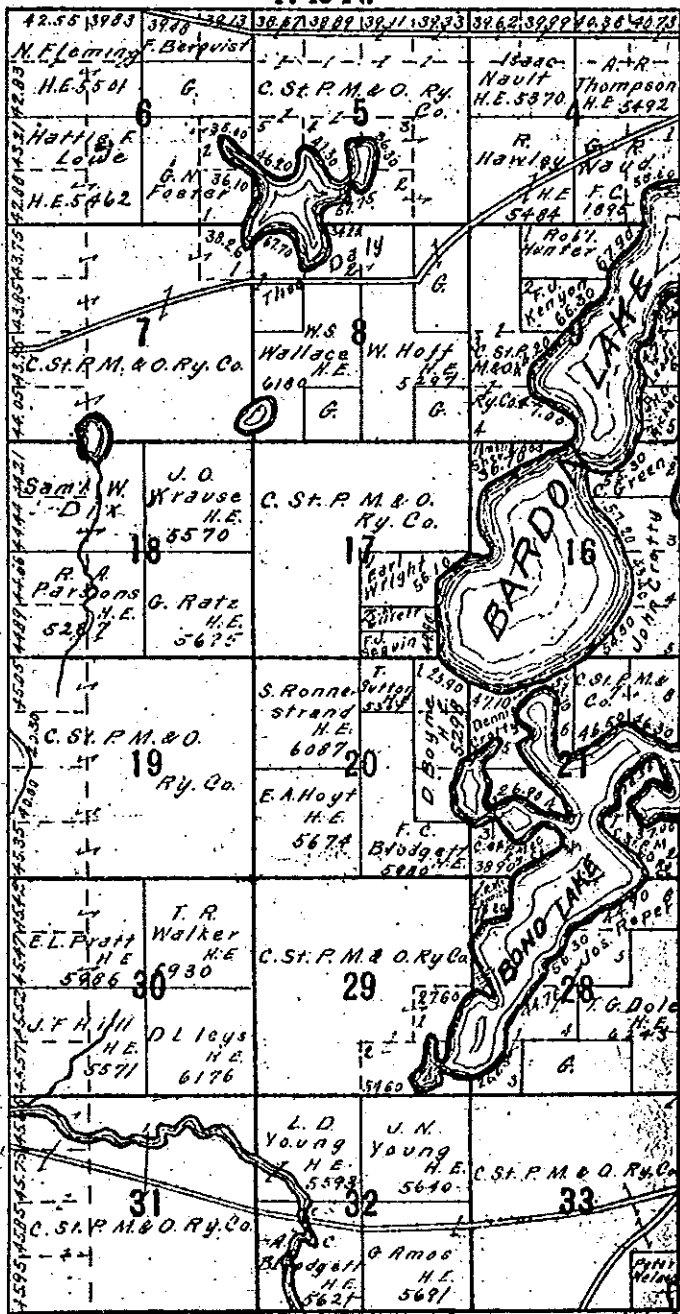

R. 12 W

3

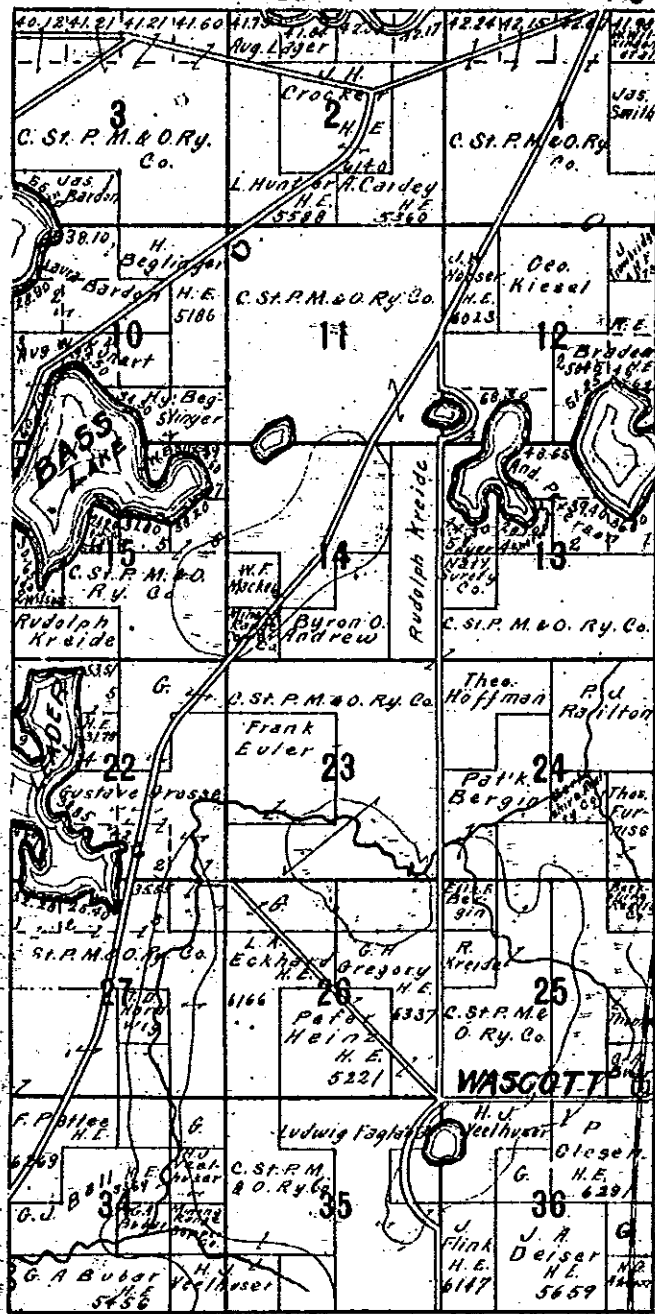

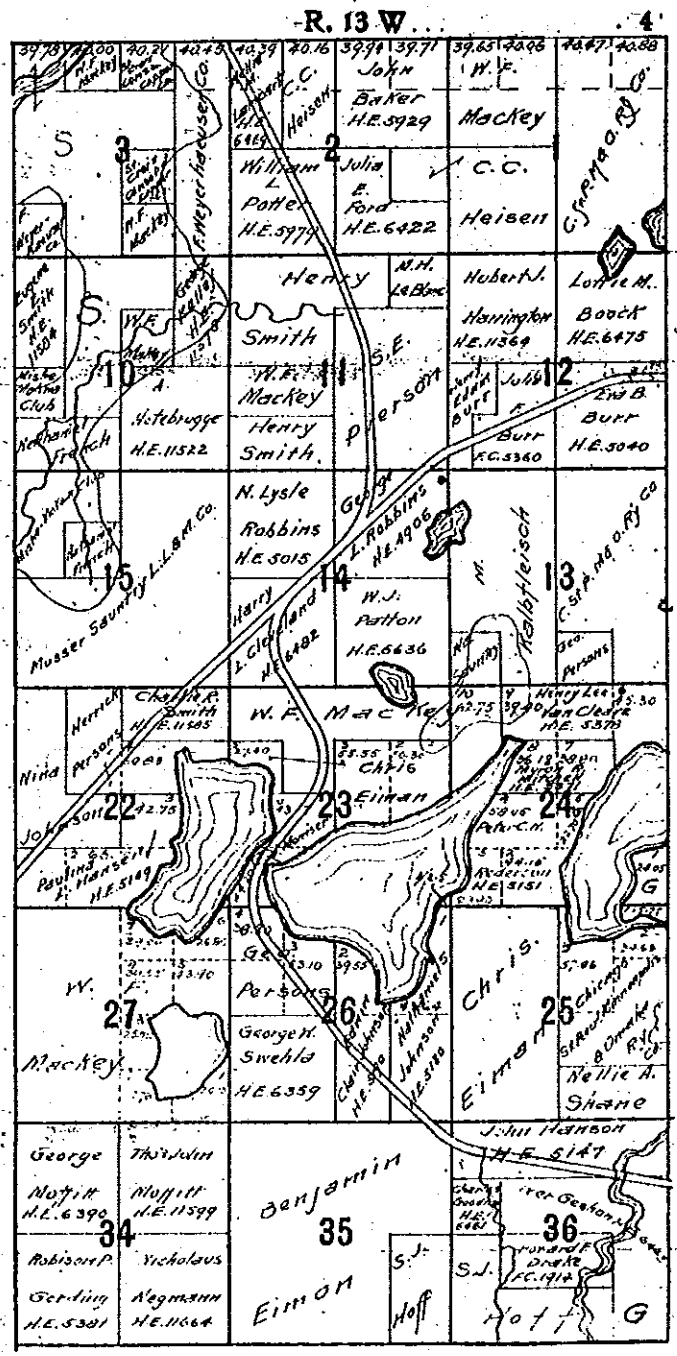
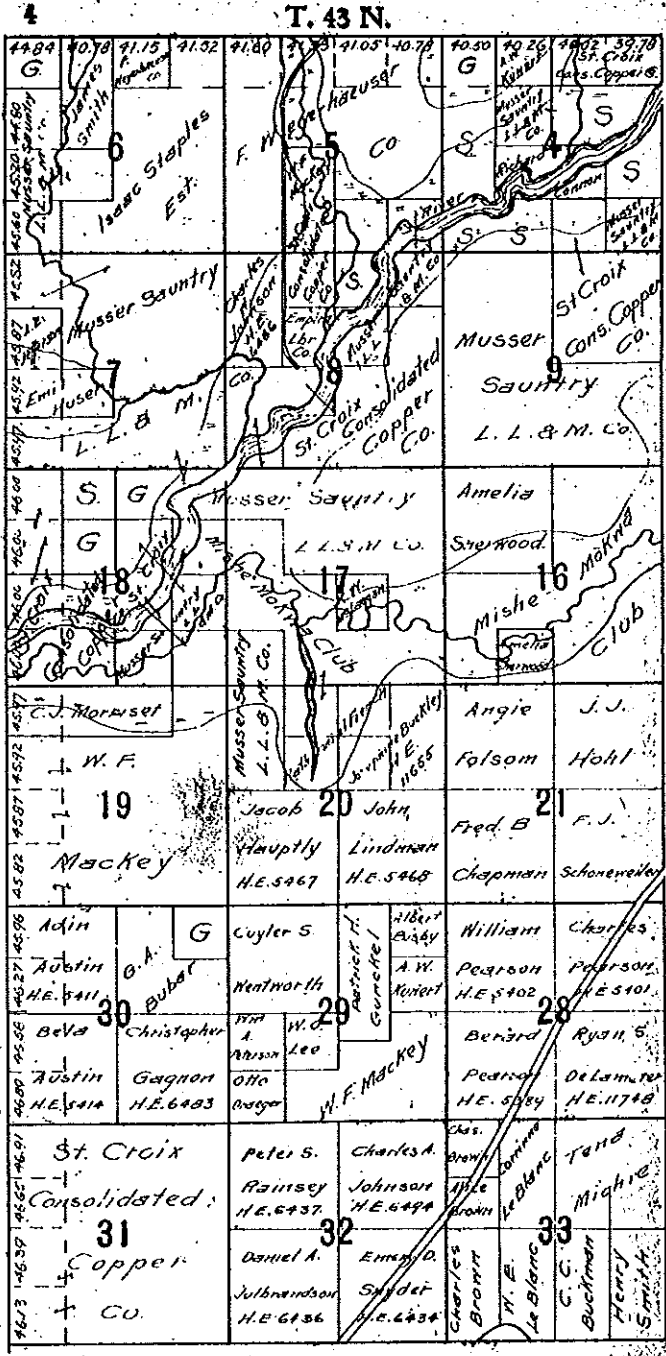

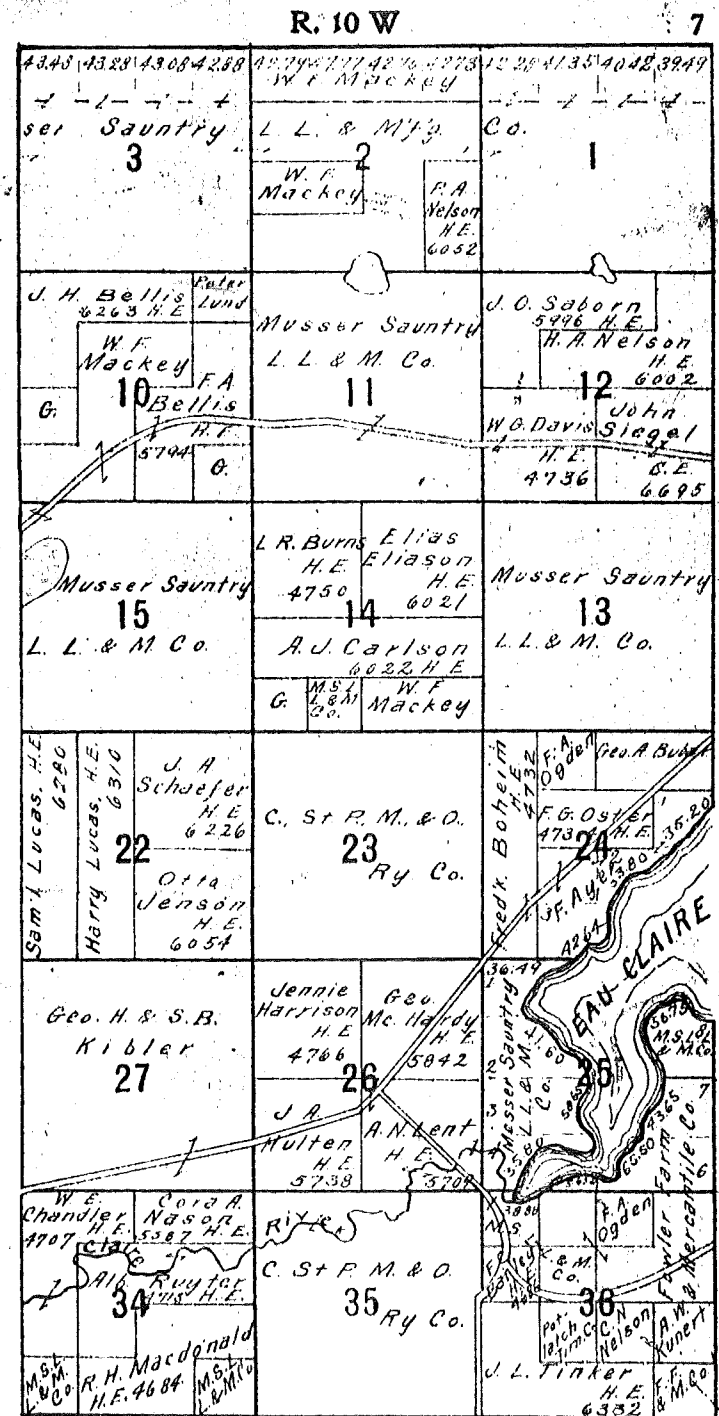
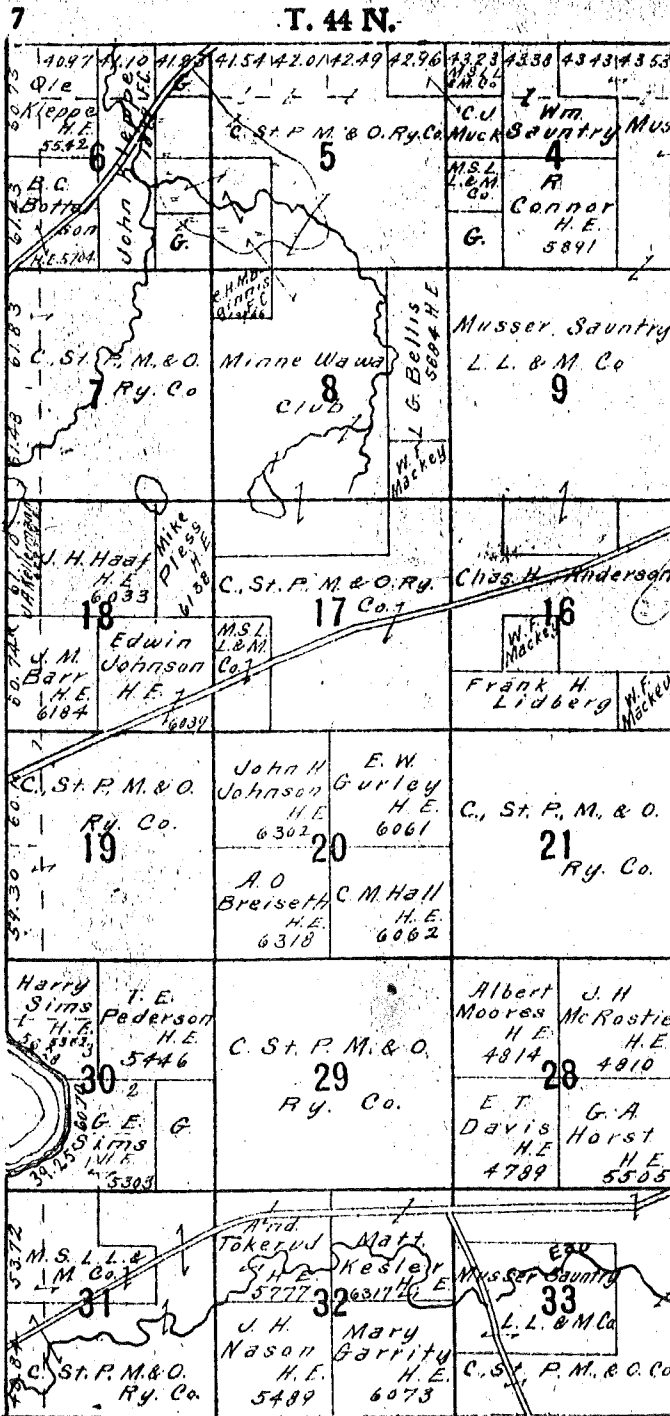

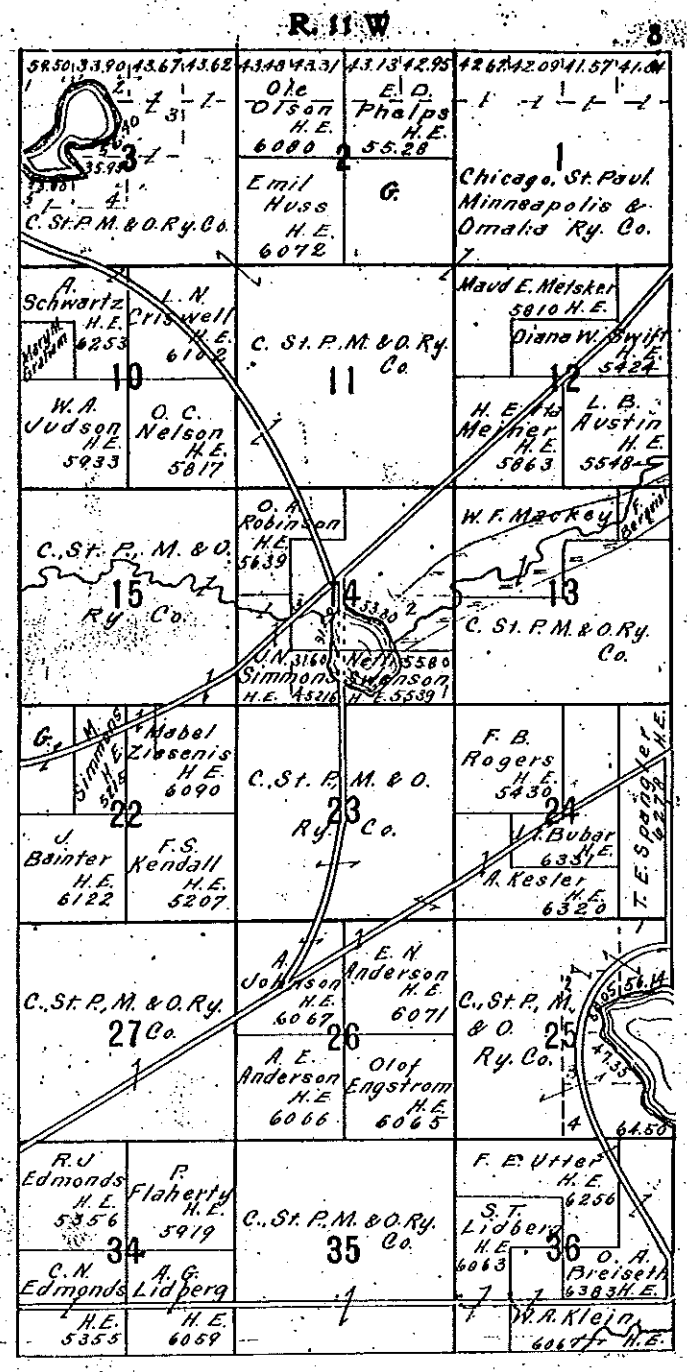
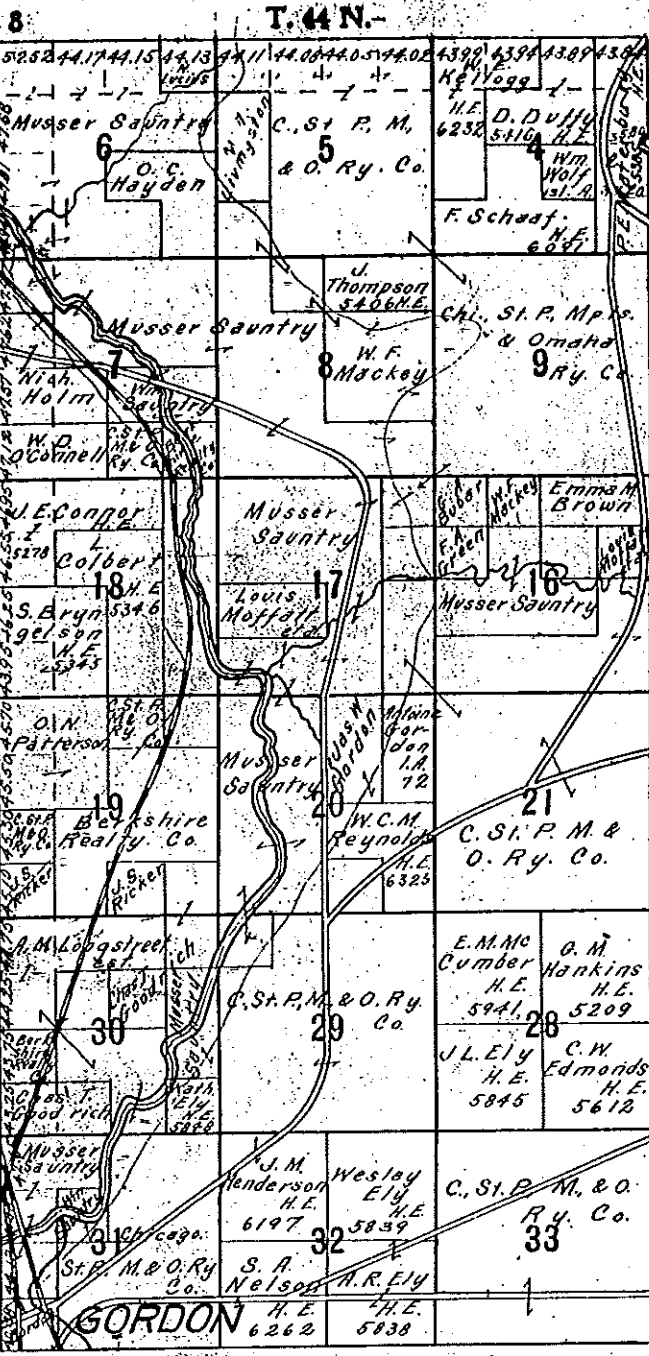

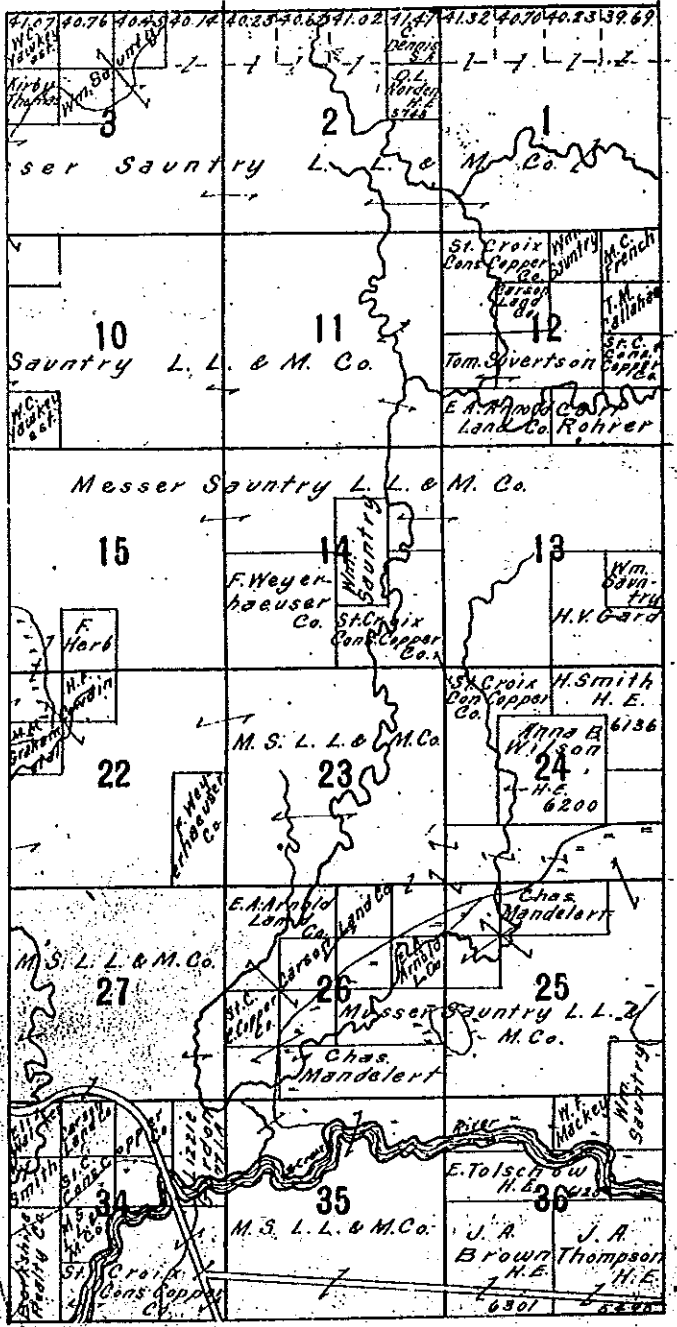
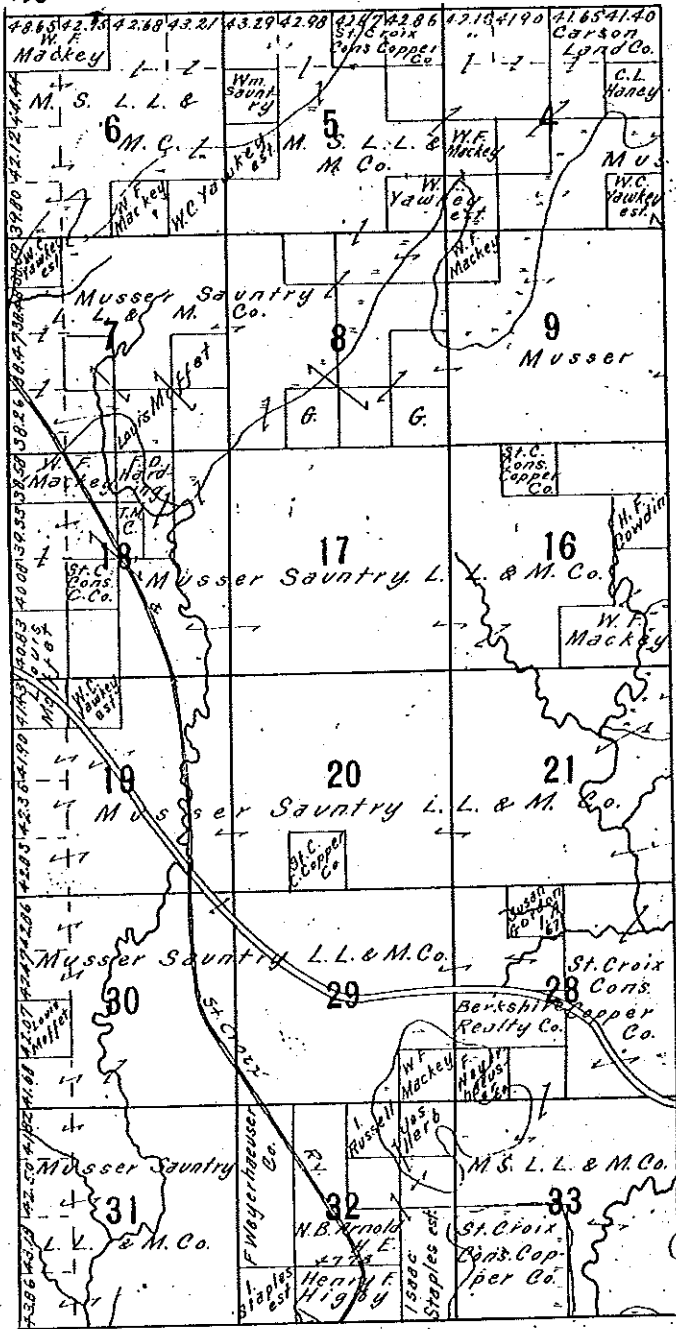

T. 44 N.

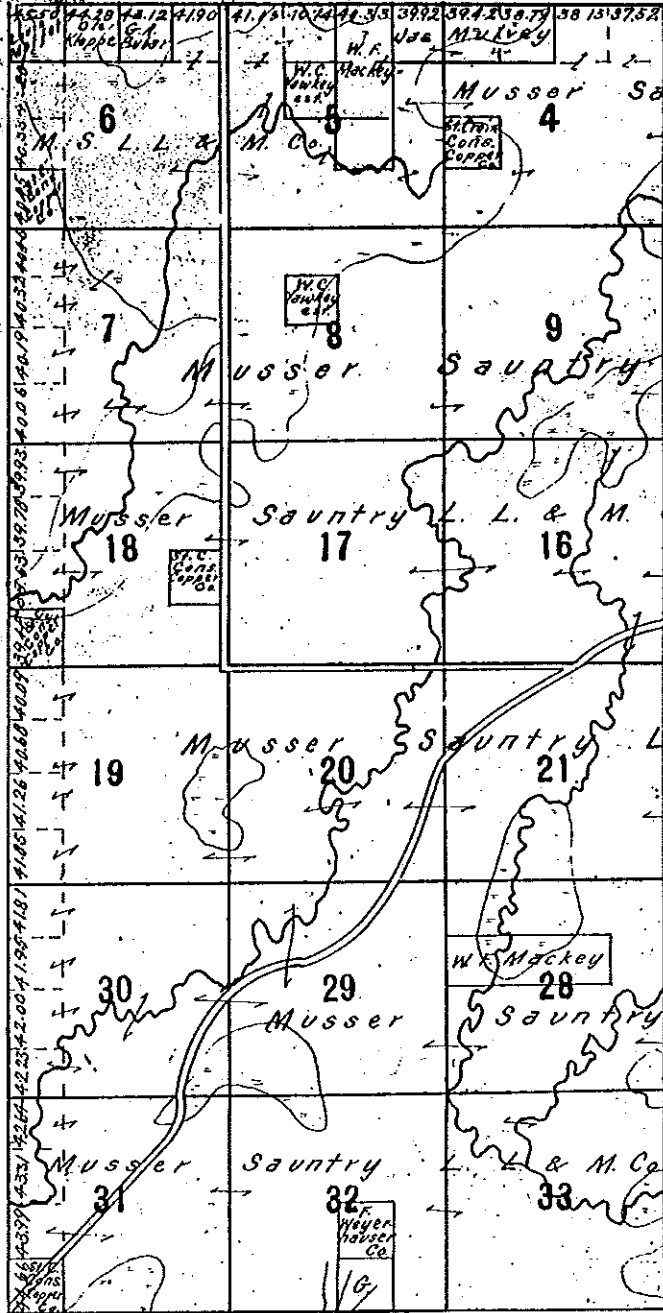

-R. 14 W.

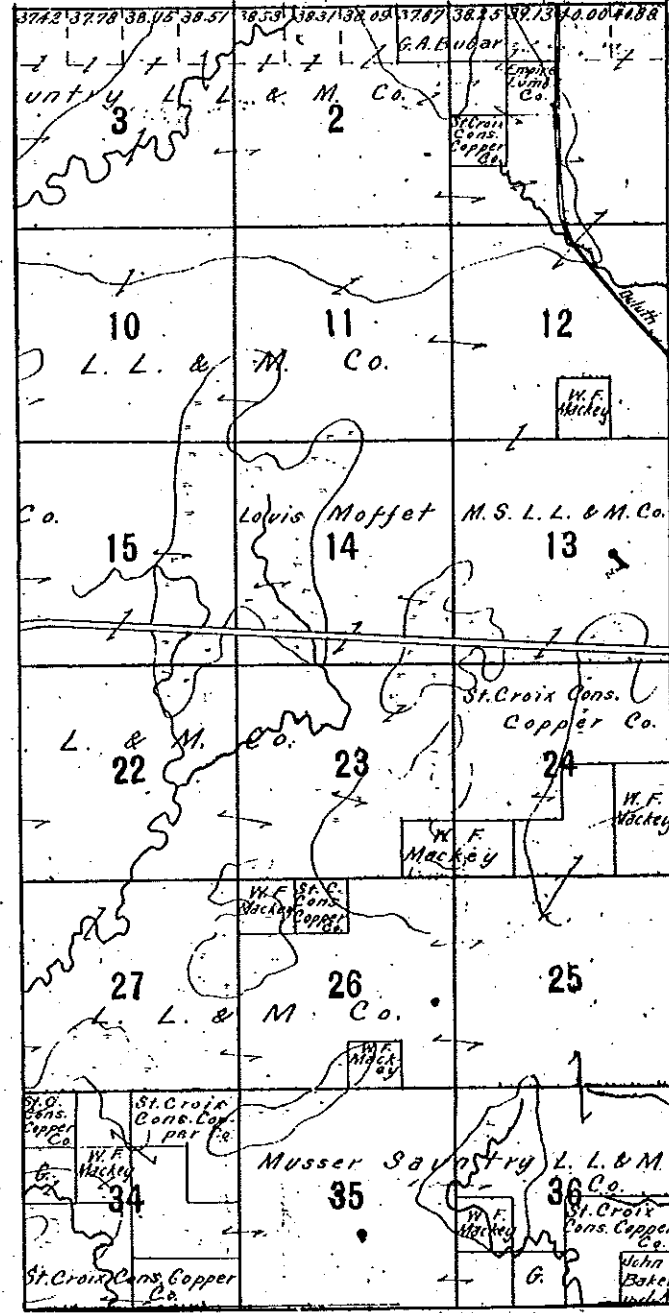

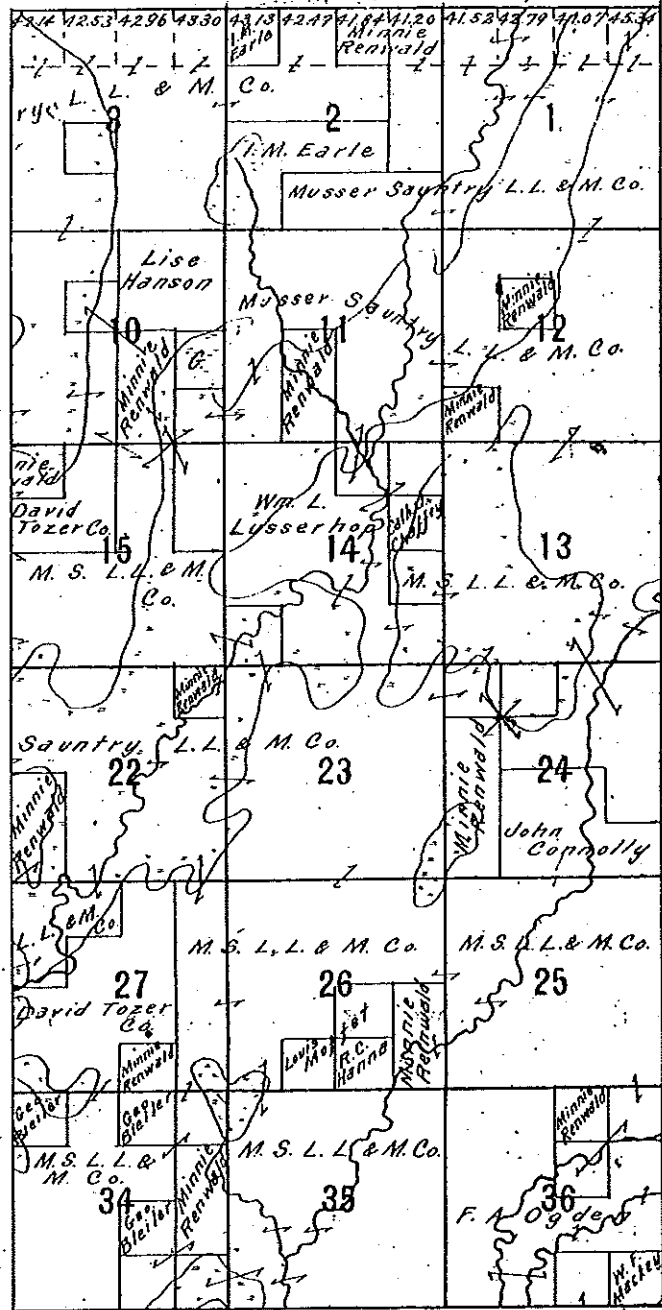
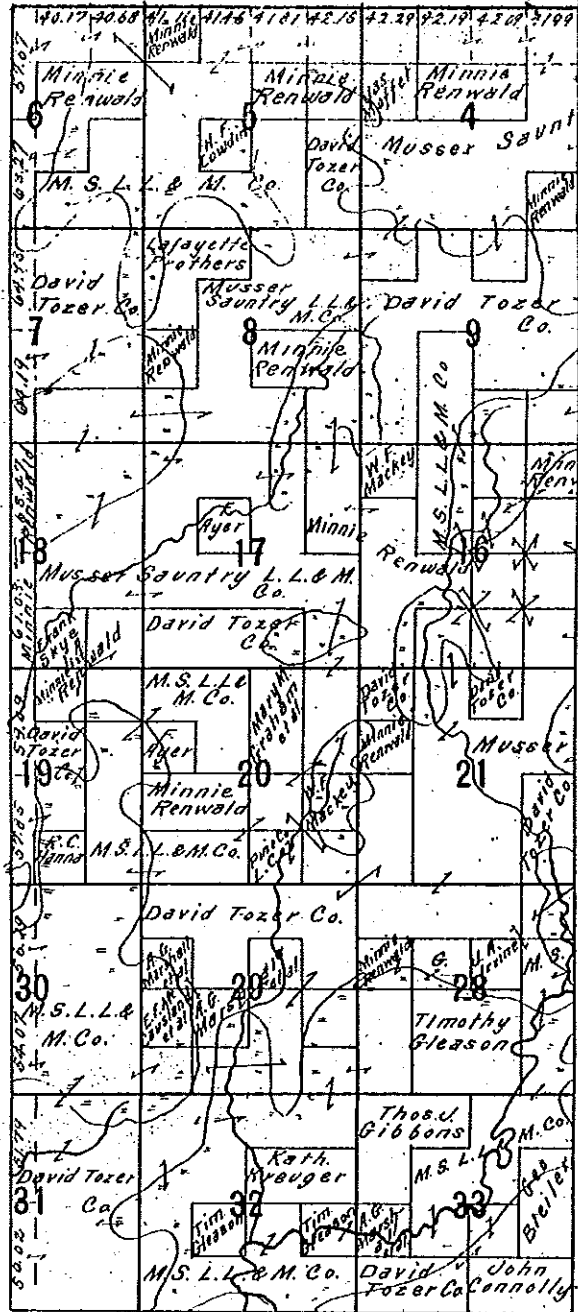

13 T. 45 N.

139.42 P.L. Albert H.E. 5527	399.04 Albert H.E. 5552	40.52 -	40.44 -	40.29 -	40.16 -	40.32 O.R. Johap Henry Bures H.E. 5684	40.79 H.E. 5953	41.27 Alvina C. Duch- Beatcher esneau H.E. 5995	41.74 H.E. 5955
64.65 Henry Good- son H.E. 5818	64.65 G.L. Tucker H.E. 6174	C. St. P. M. & O. Ry. Co.			5		6		
61.87 C. St. P. M. & O. Ry. Co.	61.87 John Butcher H.E. 5898	61.87 Frank Holtz H.E. 5896	C. St. P. M. & O. Ry. Co.			7		8	
61.87 Minnie M. JoDon H.E. 5819	61.87 M.E. Nicholas H.E. 5985	C. St. P. M. & O. Ry. Co.			9		10		11
61.87 G. H.E. 5913	61.87 P.H. Howell H.E. 5903	17			16		18		19
57.70 C. St. P. M. & O. Ry. Co.	57.70 Herman Beckman H.E. 6133	57.70 C.F. Kretzer H.E. 5992	C. St. P. M. & O. Ry. Co.			20		21	
58.10 C. St. P. M. & O. Ry. Co.	58.10 H.P. Hardy H.E. 5790	58.10 Eliza F. Banks H.E. 5845	22			23		24	
56.89 C. St. P. M. & O. Ry. Co.	56.89 Corda Bertsch H.E. 5690	56.89 P.F. Bertsch H.E. 5625	29			30		31	
58.67 C. St. P. M. & O. Ry. Co.	58.67 Gordon Young	58.67 T.E. Spencer H.E. 5555	32			33		34	
58.67 C. St. P. M. & O. Ry. Co.	58.67 Jas. Morrey H.E. 5554	58.67 V.S.P. Morrey H.E. 5553	35			36		37	

R. 15 W 13

39.70 F.D. Alva U. H.E. 6367	39.70 L.L. Leyson H.E. 6029	39.70 C. St. P. M. & O. Ry. Co.	39.70 J.I. Johnston H.E. 5938	39.70 R.W. Johnston H.E. 5946
39.70 B.G. Dicker son H.E. 5967	39.70 Ellen M. Jepson H.E. 6774	39.70 C. St. P. M. & O. Ry. Co.	39.70 John Harpster H.E. 5932	39.70 R.H. Blument H.E. 5093
39.70 C. St. P. M. & O. Ry. Co.	39.70 E.L. Grested H.E. 5956	39.70 E.R. May H.E. 5995	39.70 15	39.70 16
39.70 Orma Hoefling H.E. 5617	39.70 L. Norma Hoefling H.E. 5614	39.70 C. St. P. M. & O. Ry. Co.	39.70 R.A. Kinlock H.E. 5594	39.70 T. H. Kinlock H.E. 5594
39.70 C. St. P. M. & O. Ry. Co.	39.70 M.S.L.S. M. Co.	39.70 C. St. P. M. & O. Ry. Co.	39.70 Musser Sautry L.L. & M. Co.	39.70 Musser Sautry L.L. & M. Co.
39.70 C. St. P. M. & O. Ry. Co.	39.70 W.F. Roy H.E. 5528	39.70 C. St. P. M. & O. Ry. Co.	39.70 W.F. Roy H.E. 5528	39.70 W.F. Roy H.E. 5528
39.70 C. St. P. M. & O. Ry. Co.	39.70 Gordon Young	39.70 T.E. Spencer H.E. 5555	39.70 Jas. Morrey H.E. 5554	39.70 V.S.P. Morrey H.E. 5553

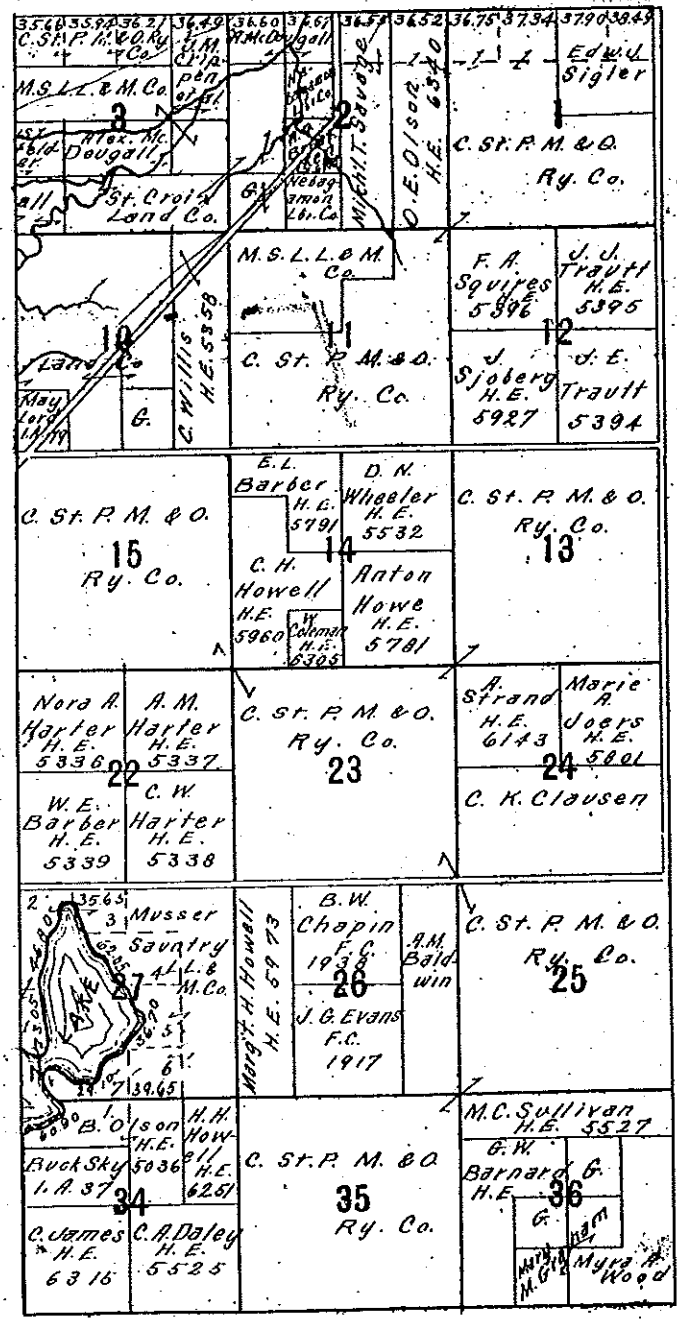
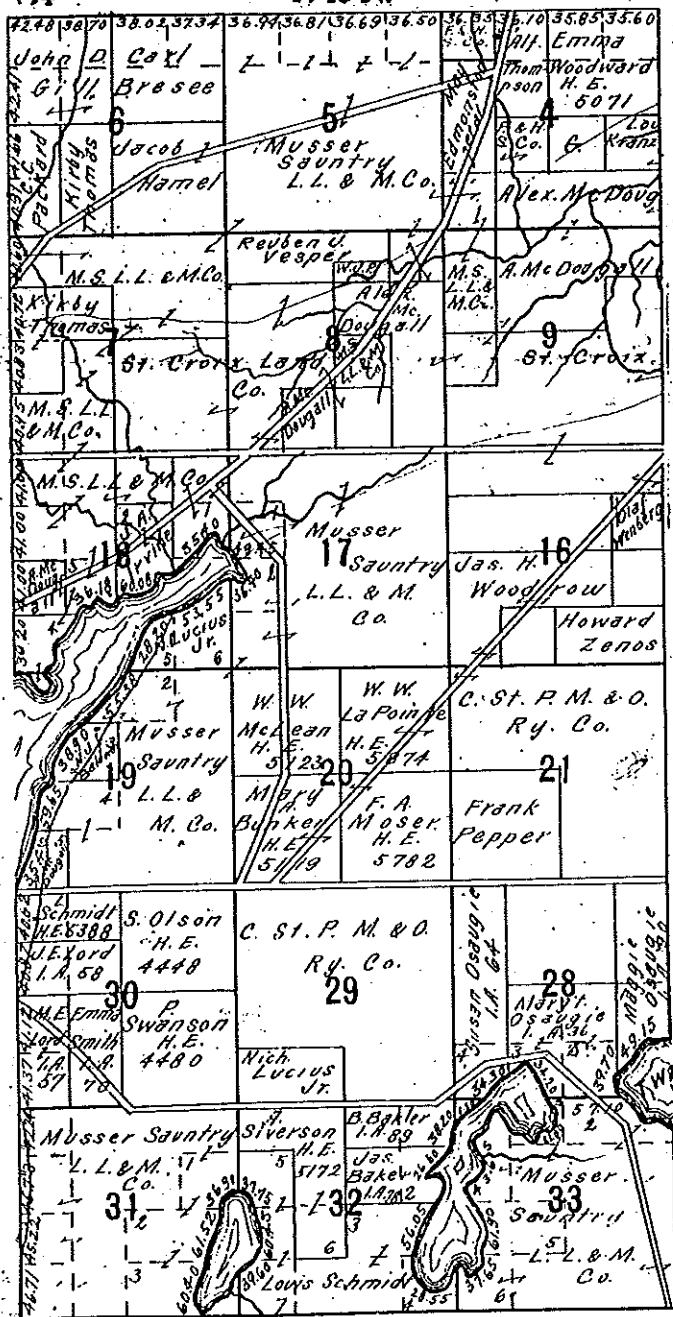

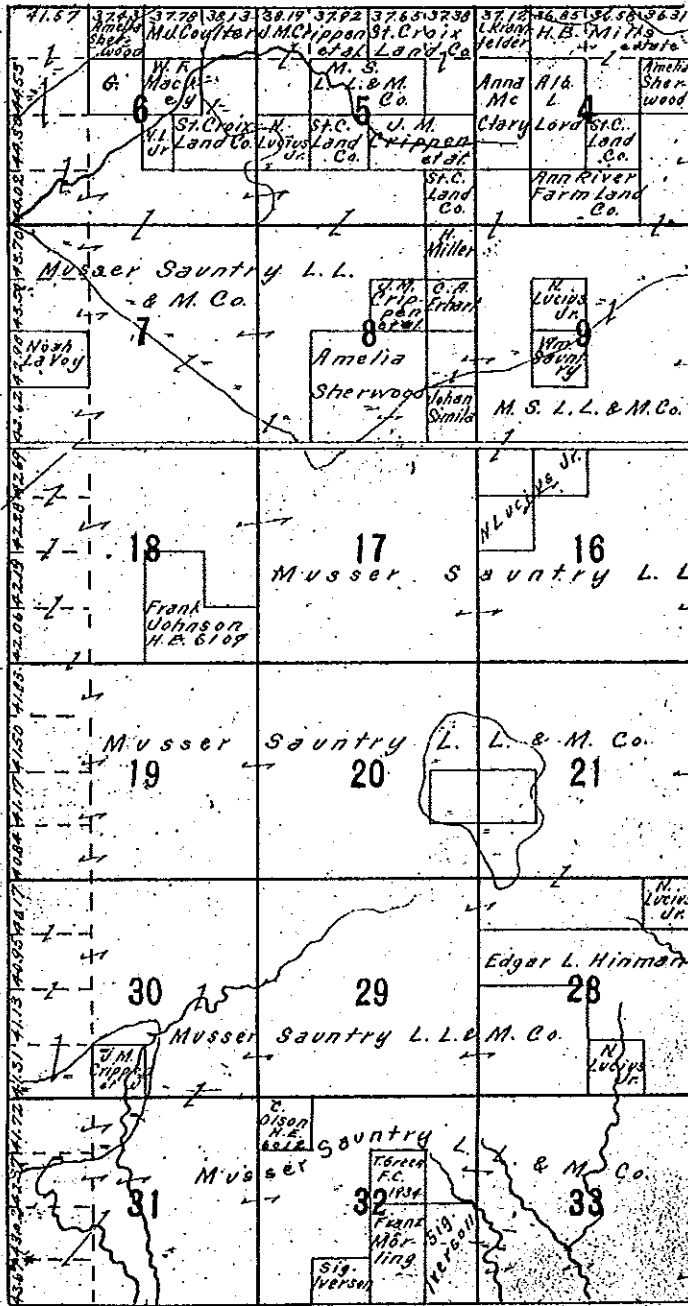

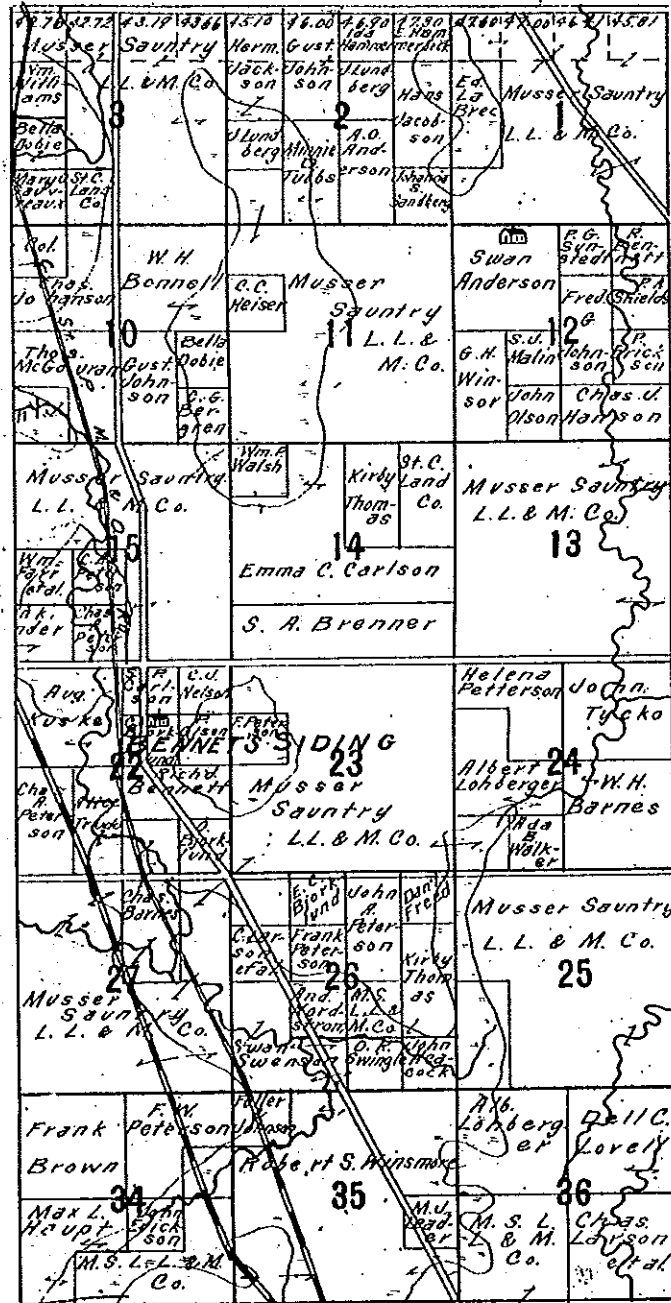
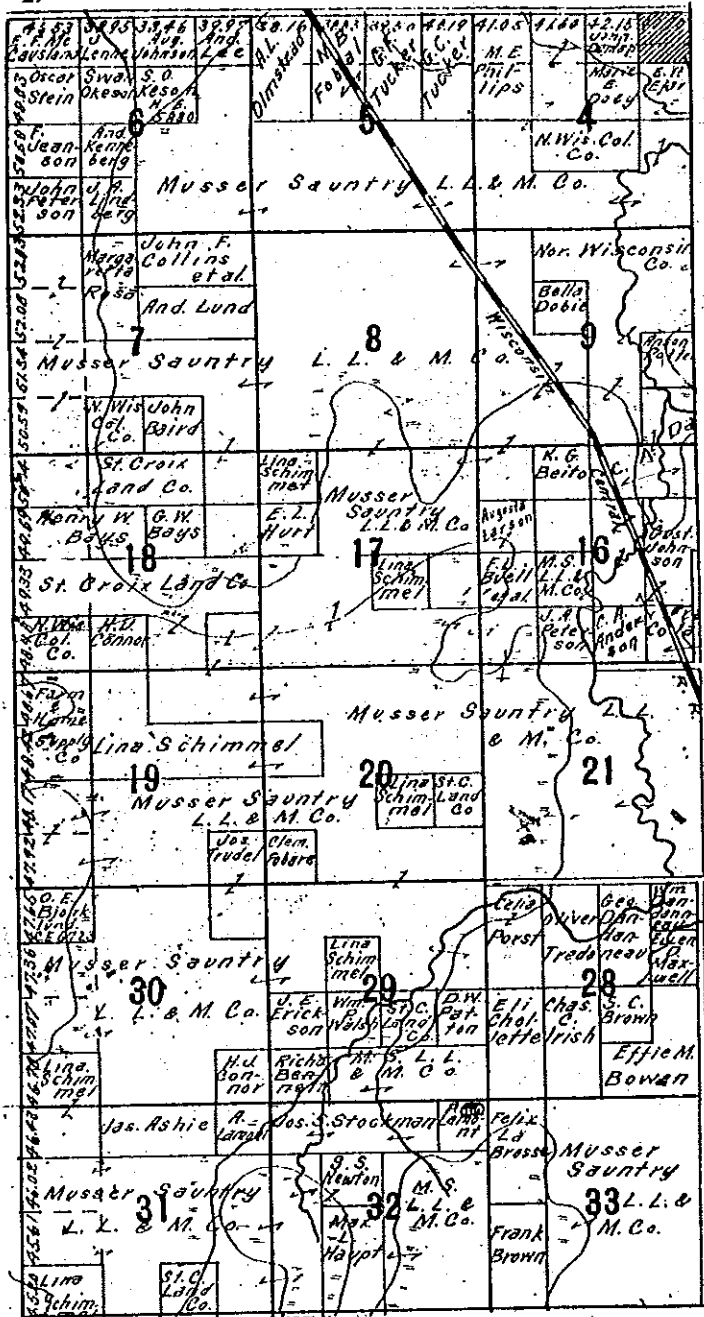

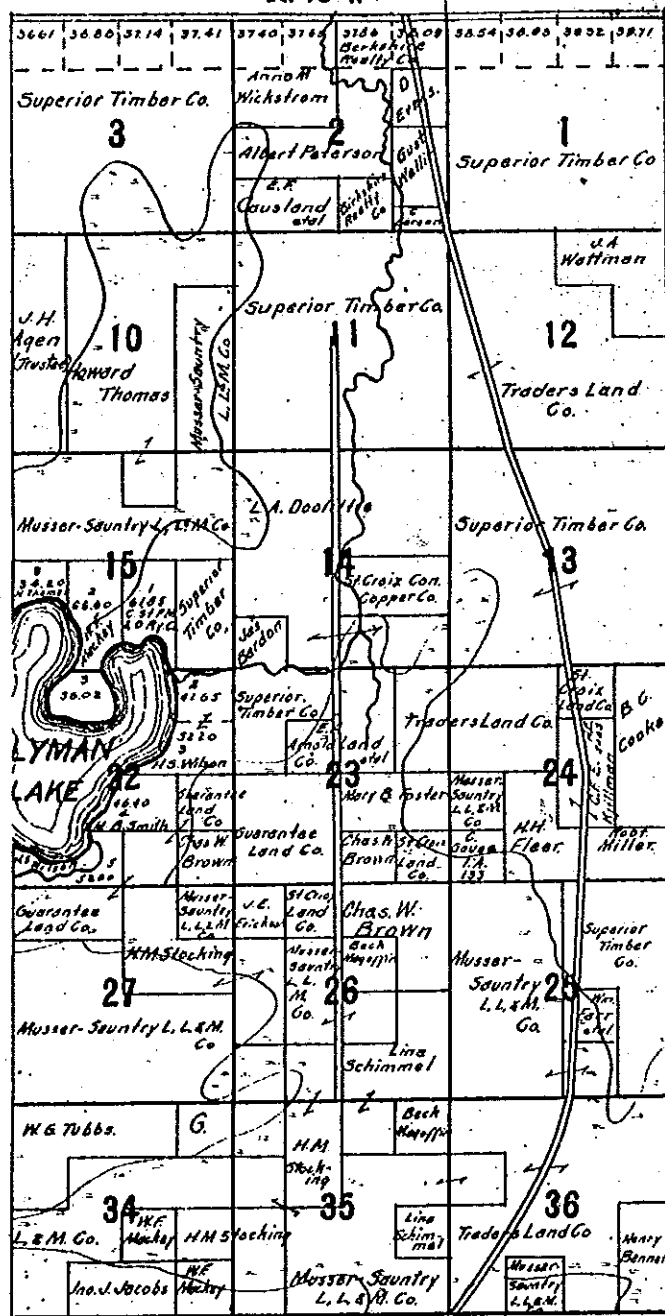
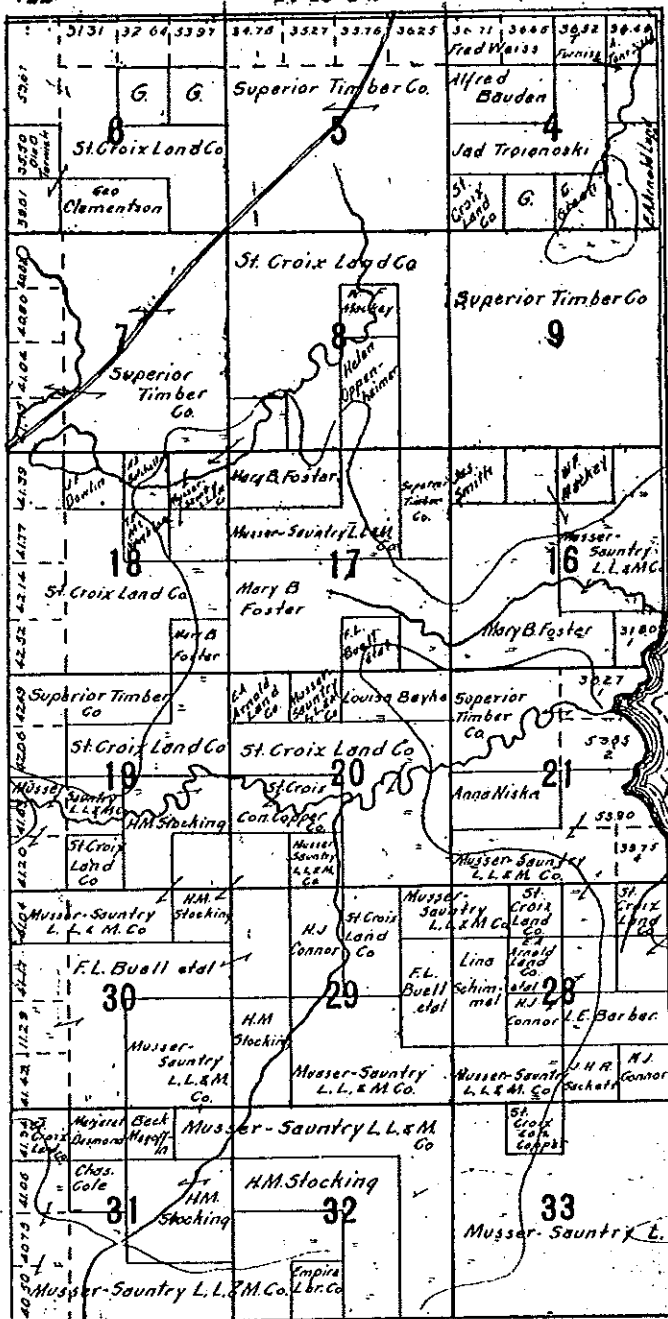

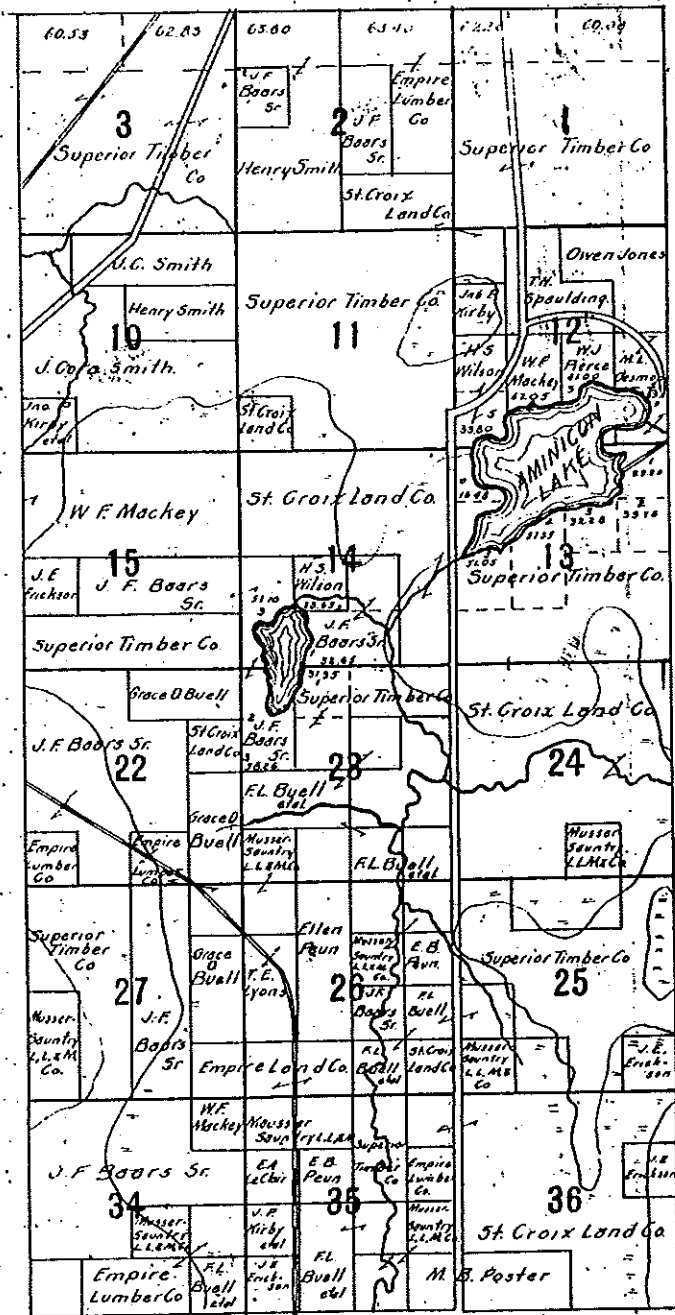
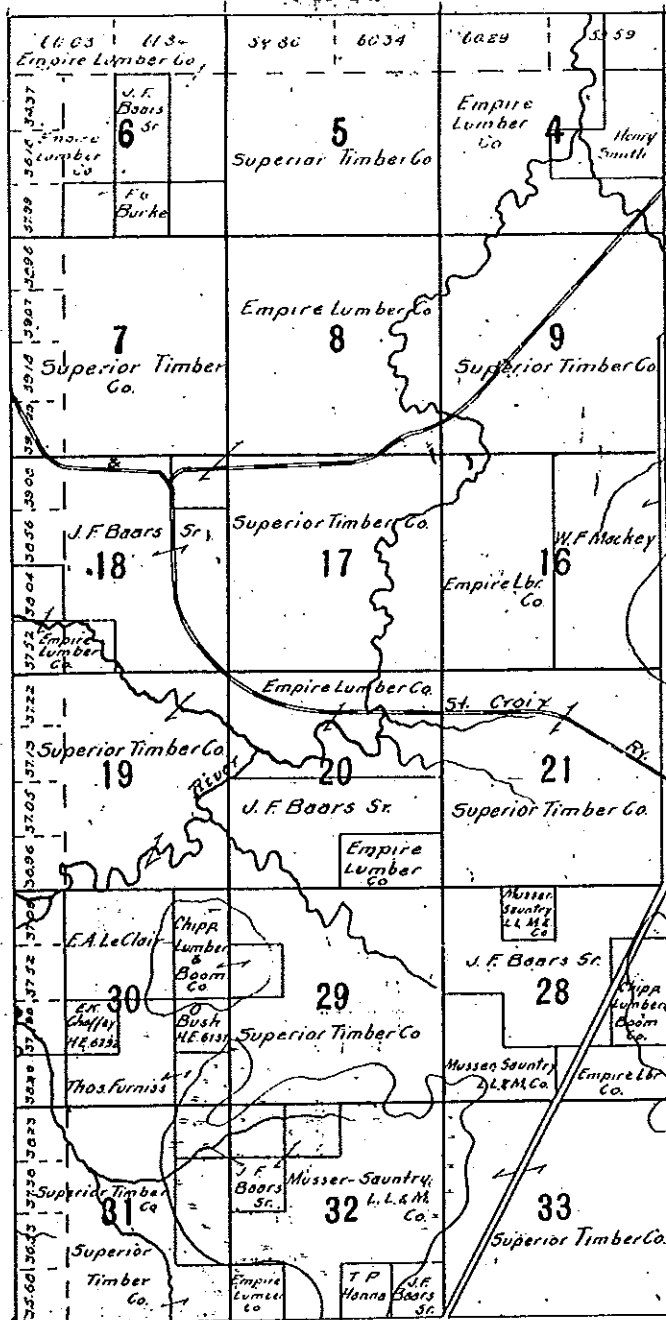

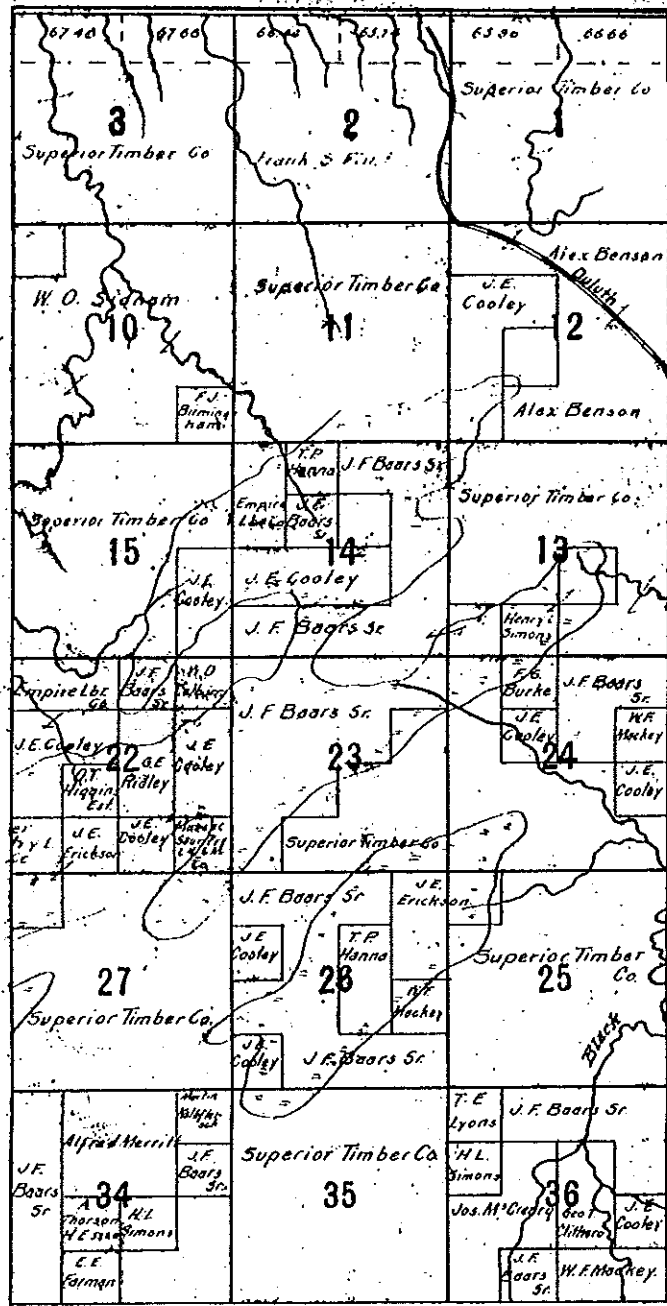
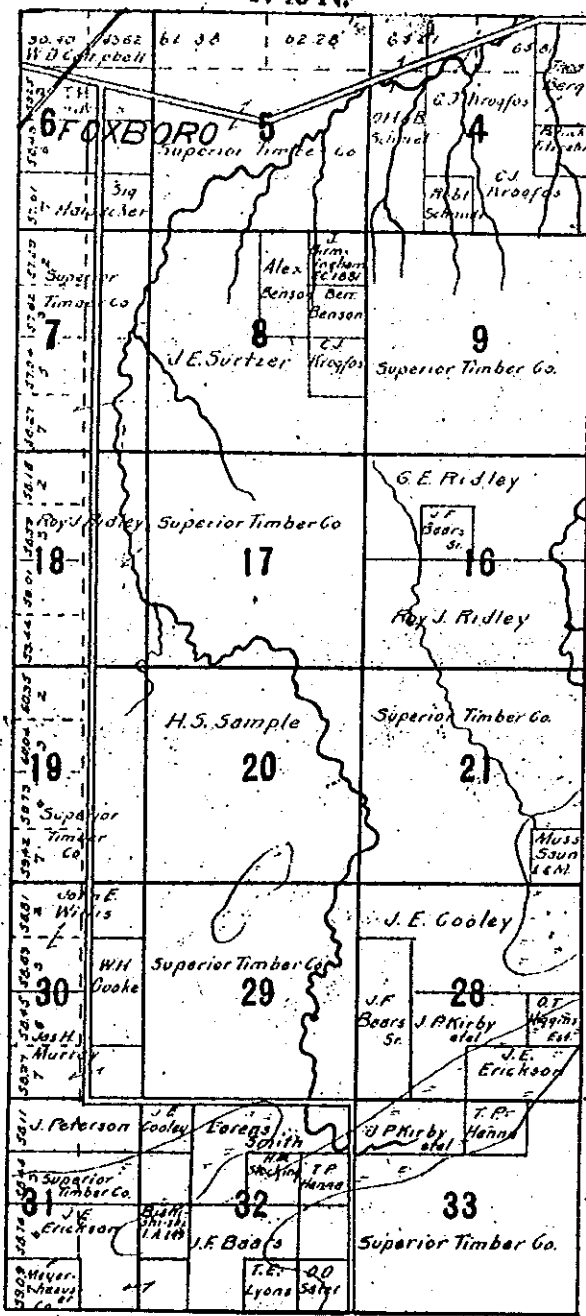

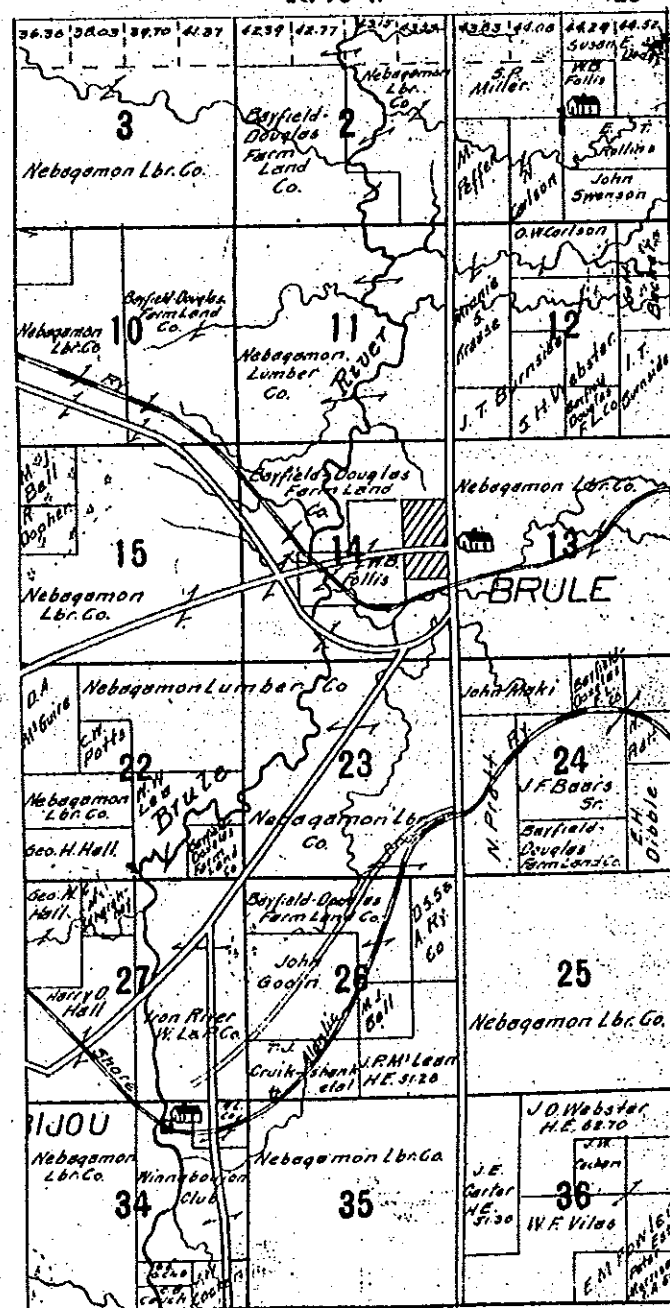

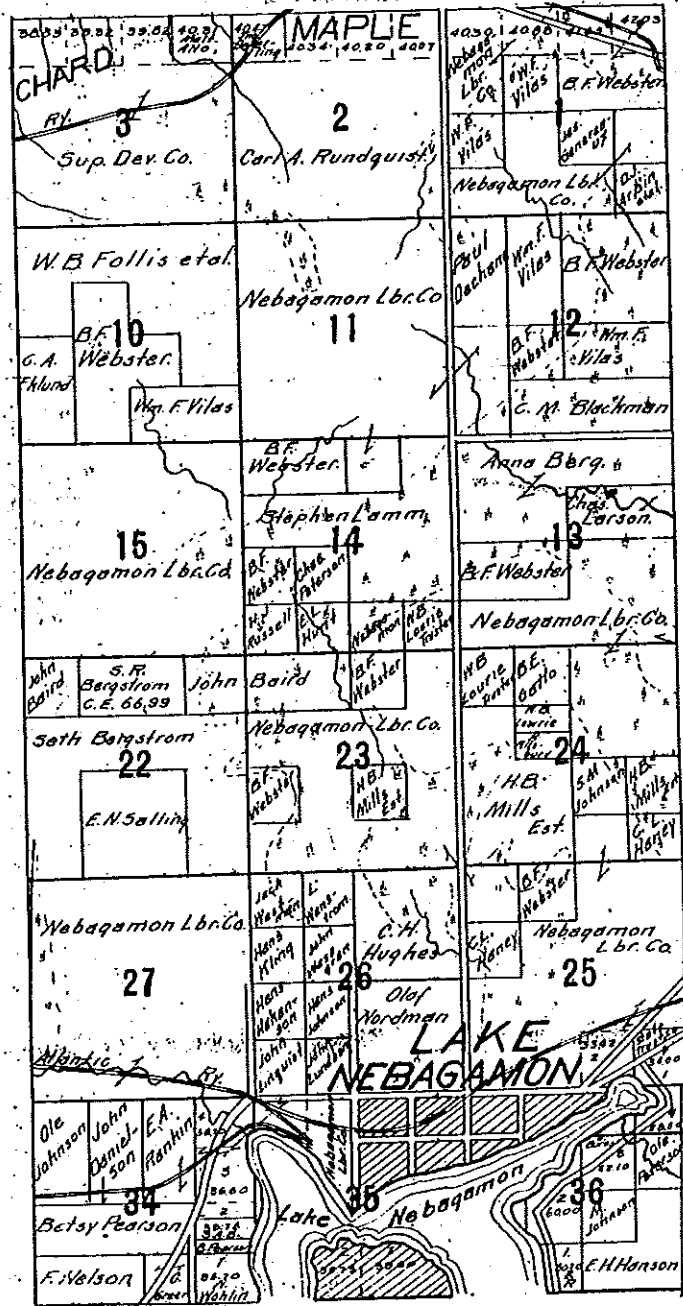
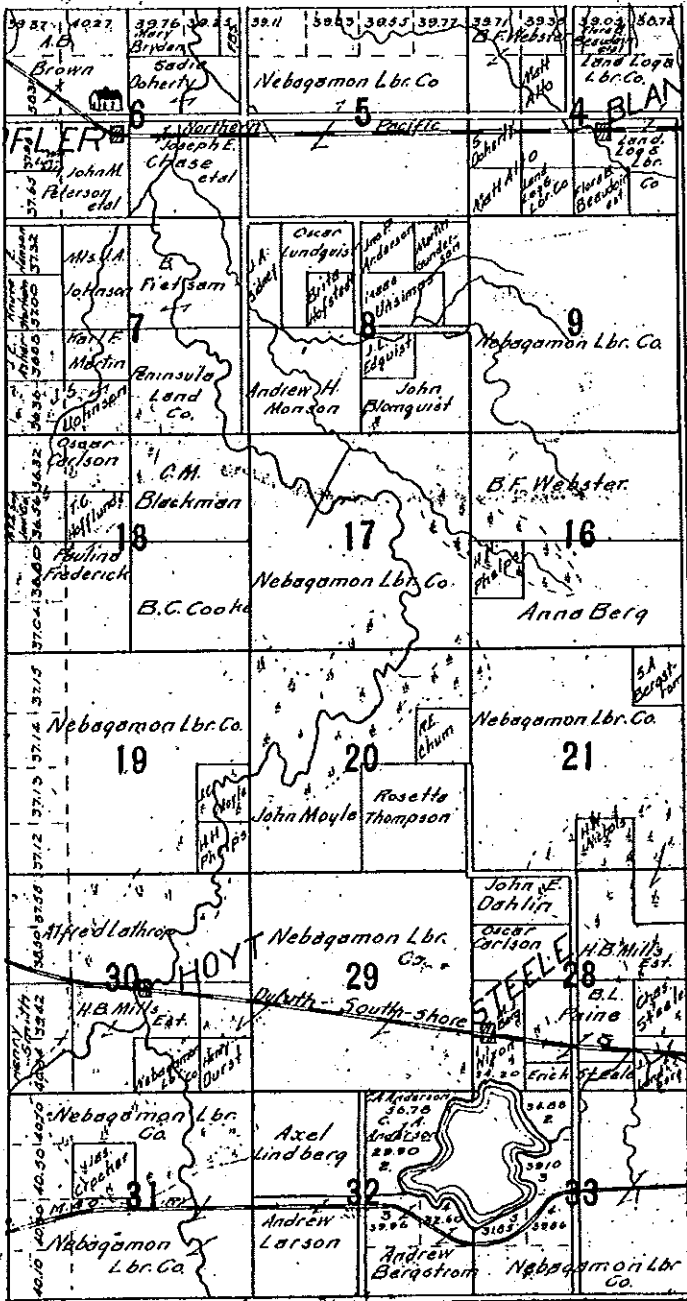

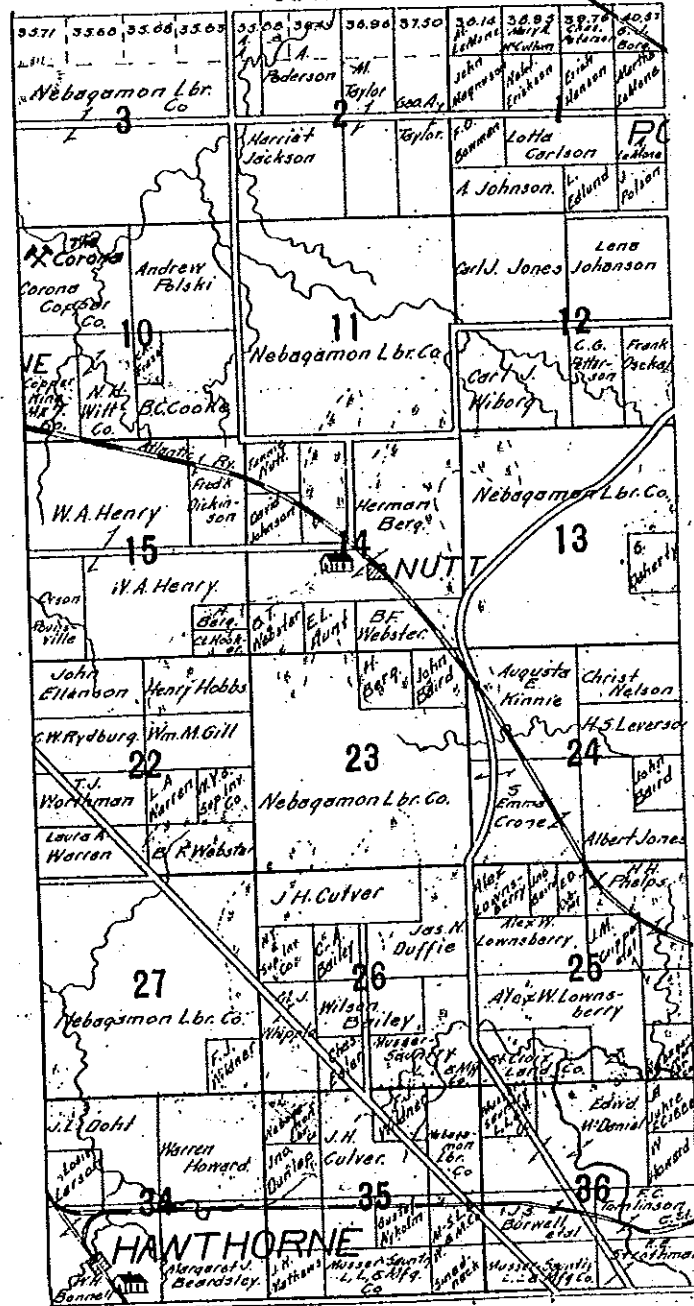
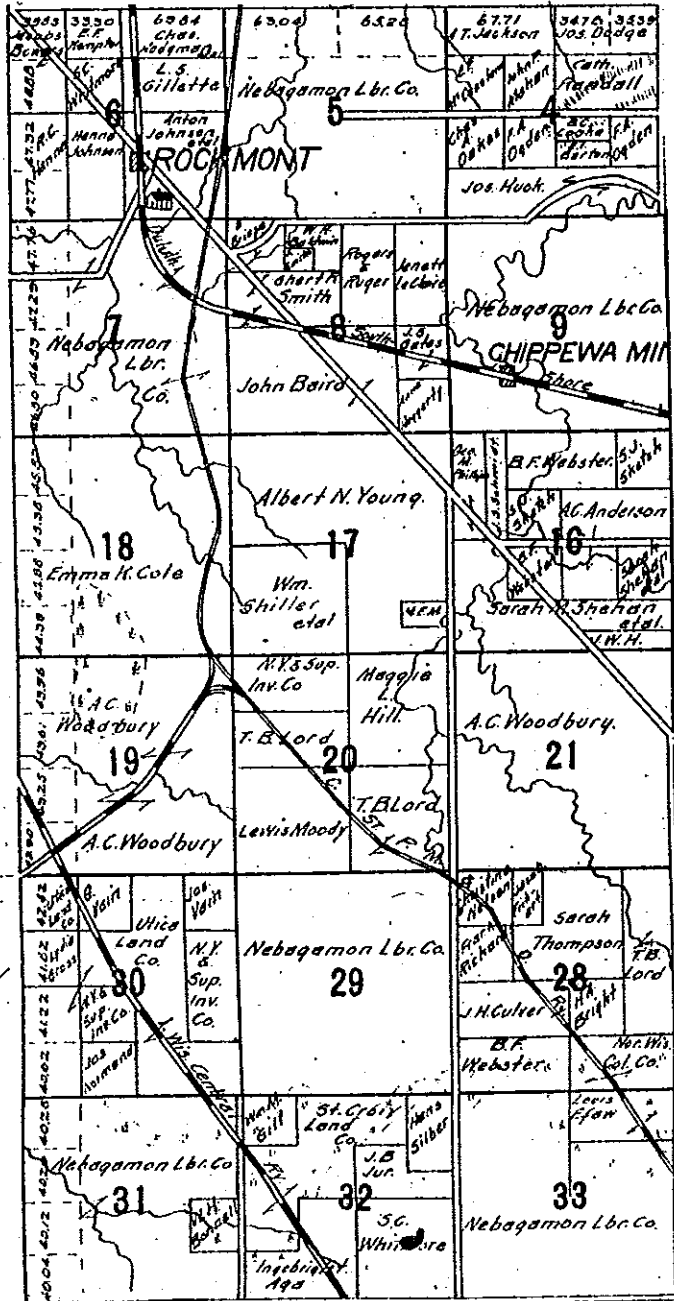

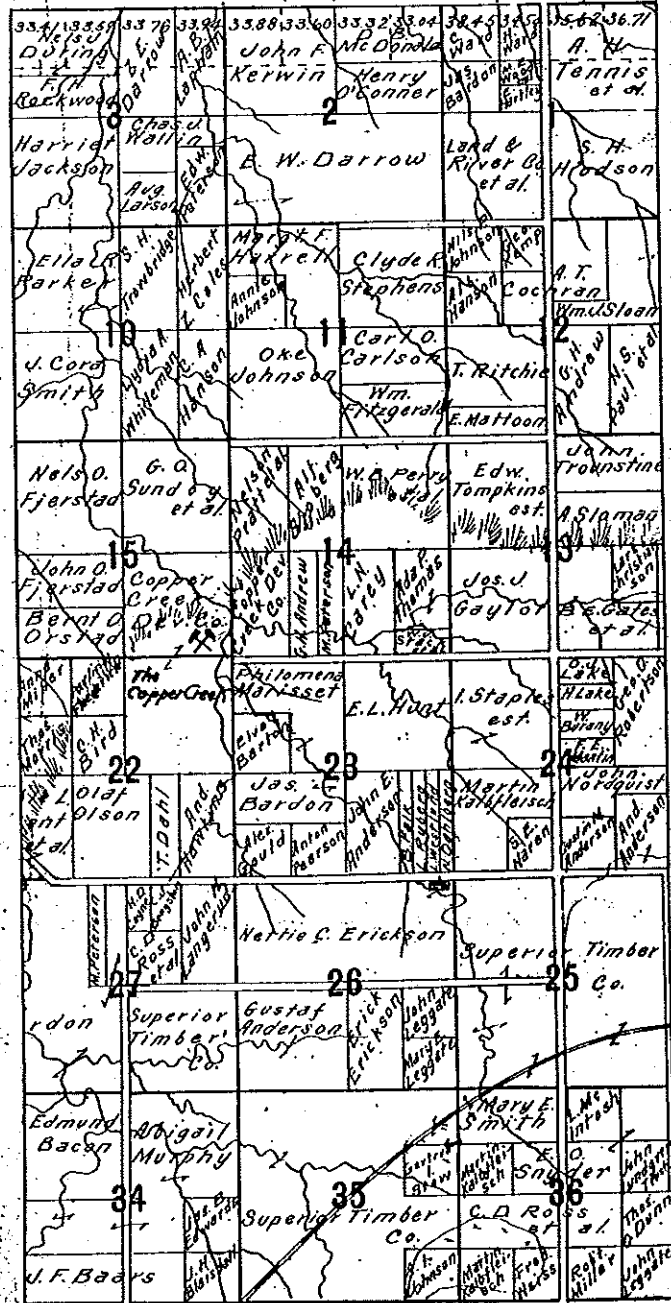
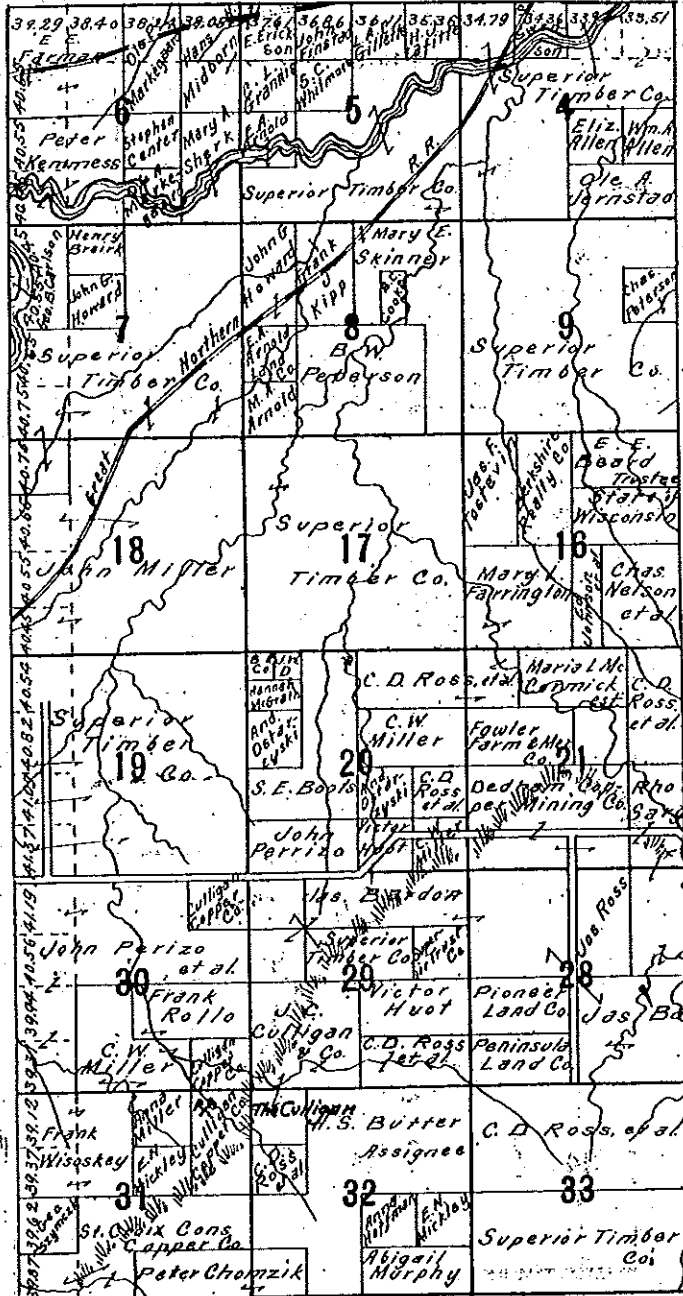

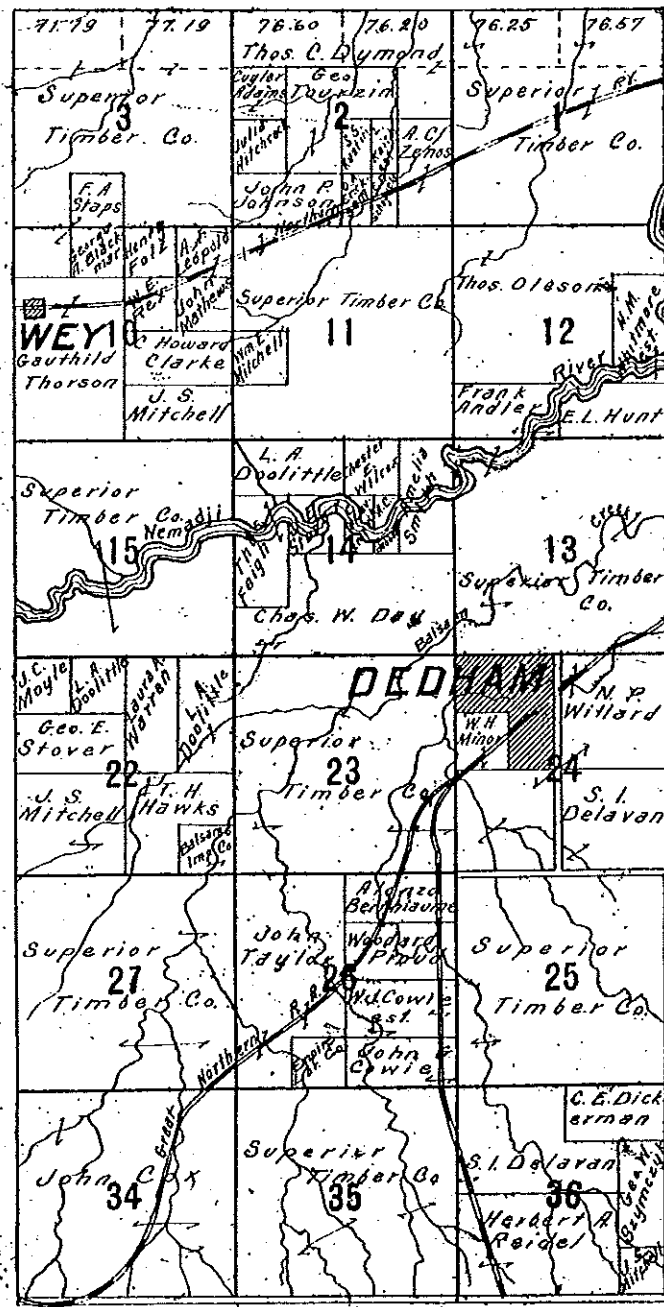
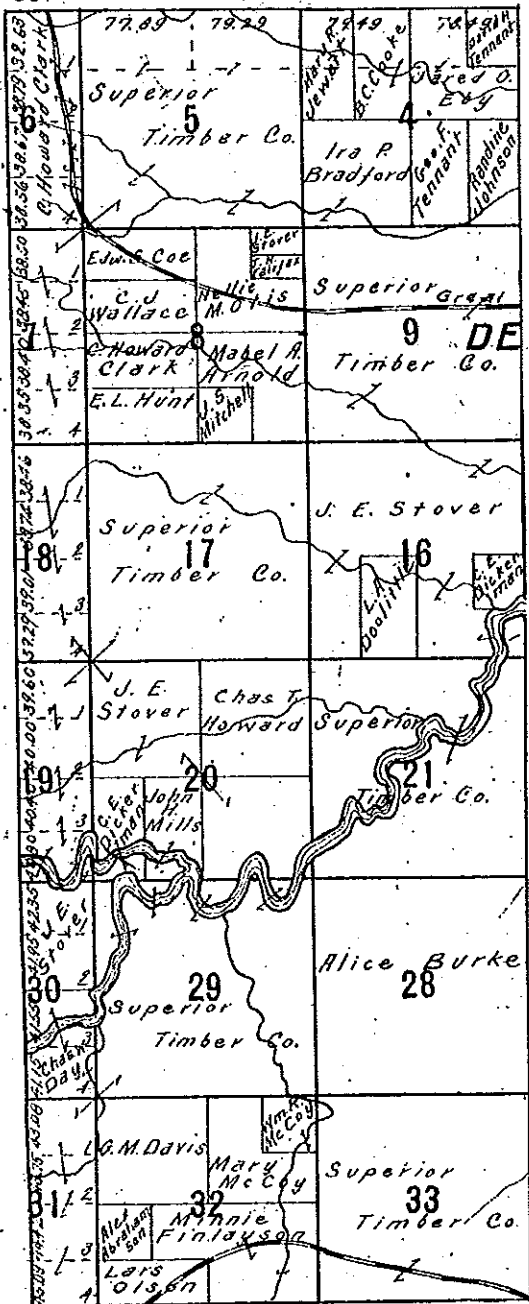

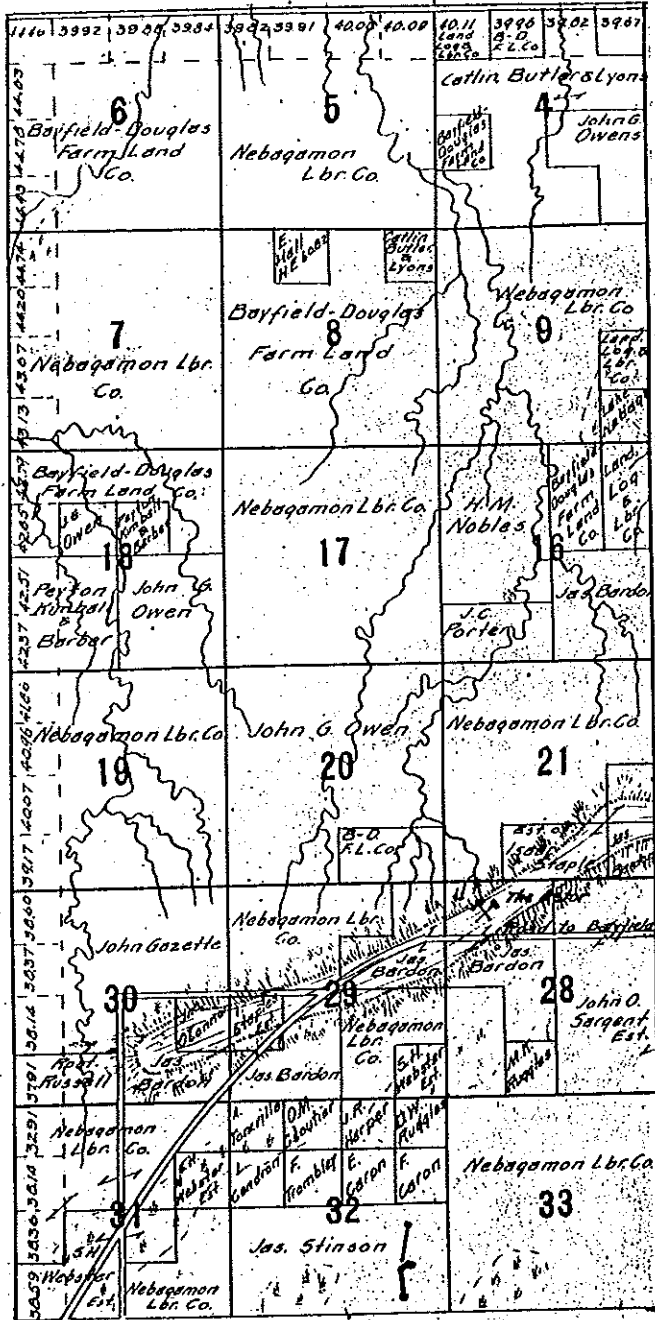

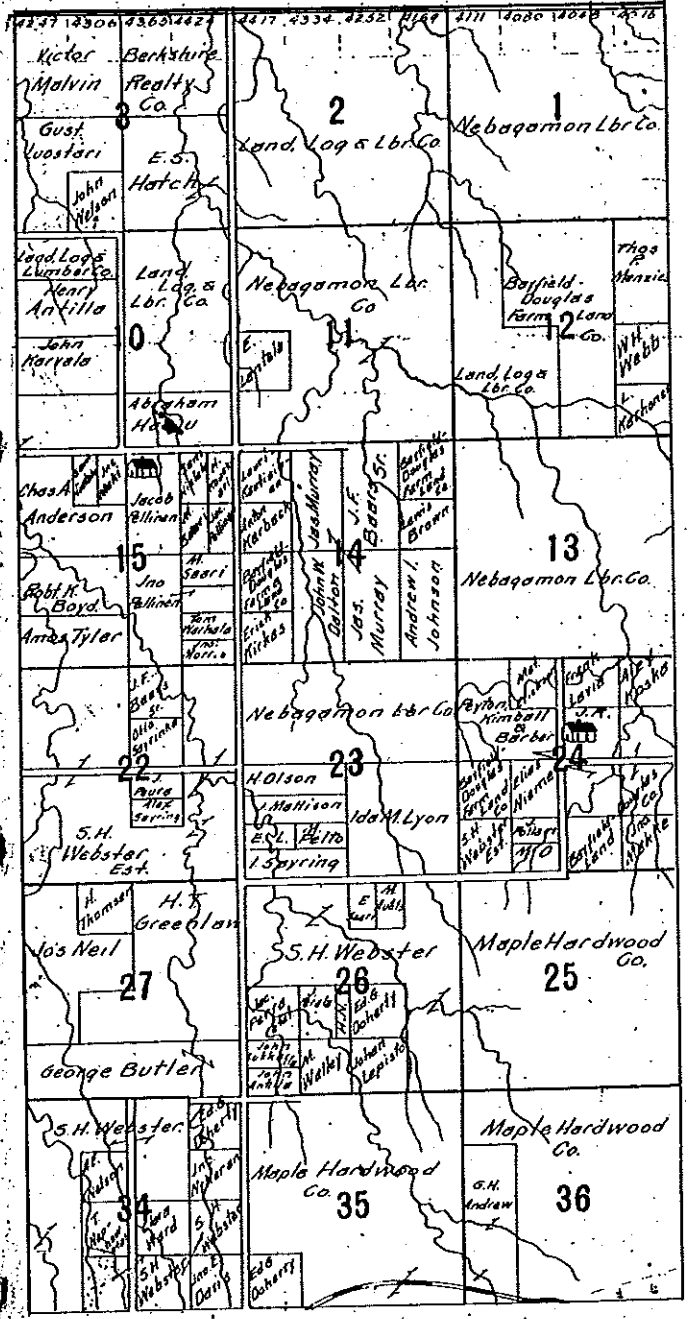
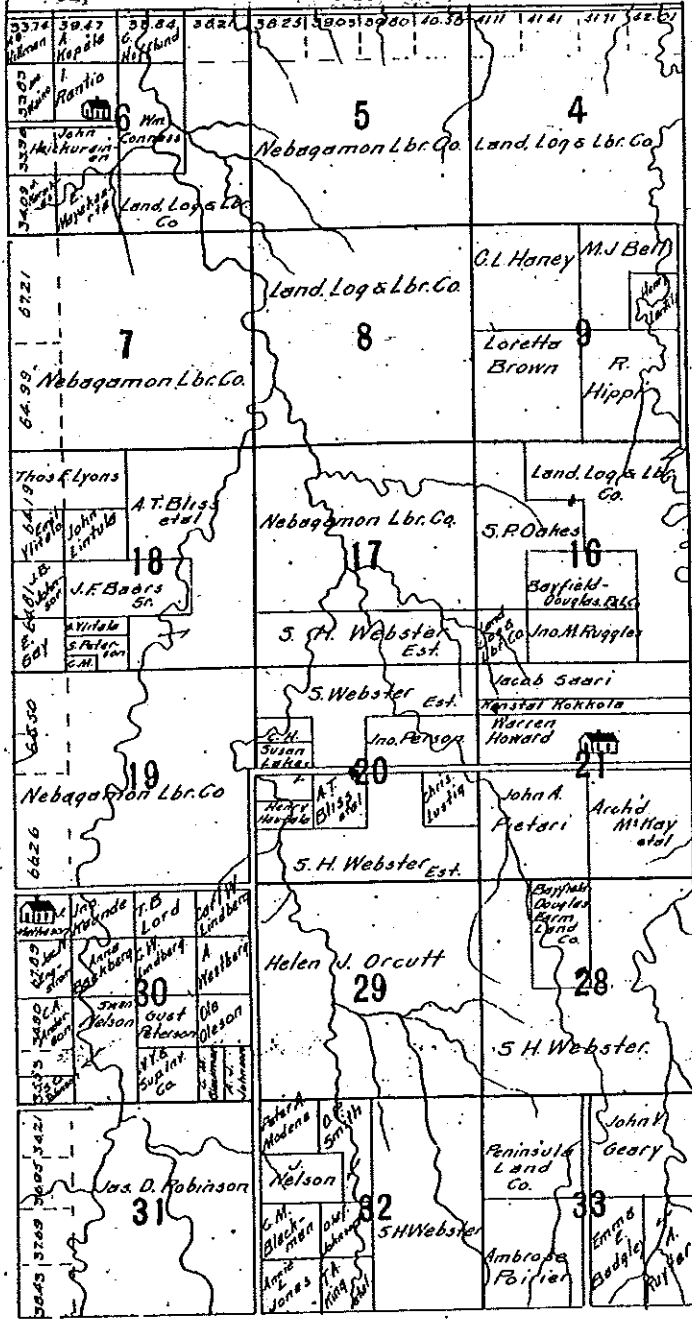

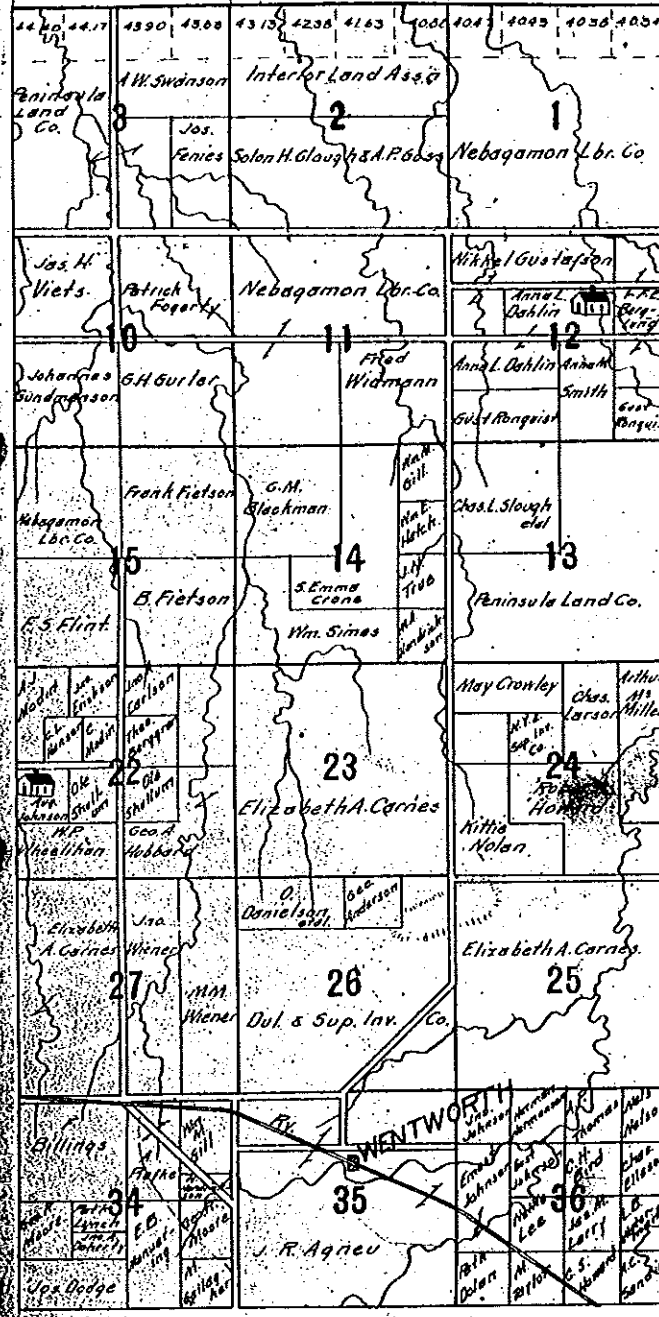
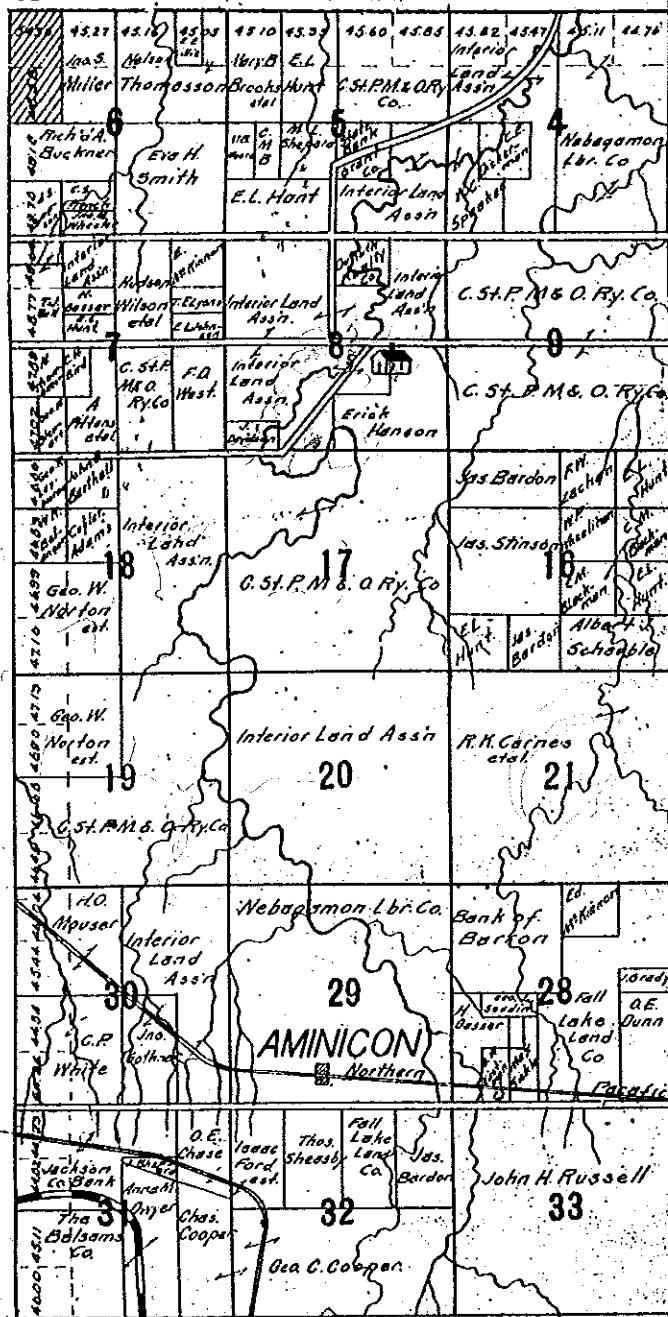

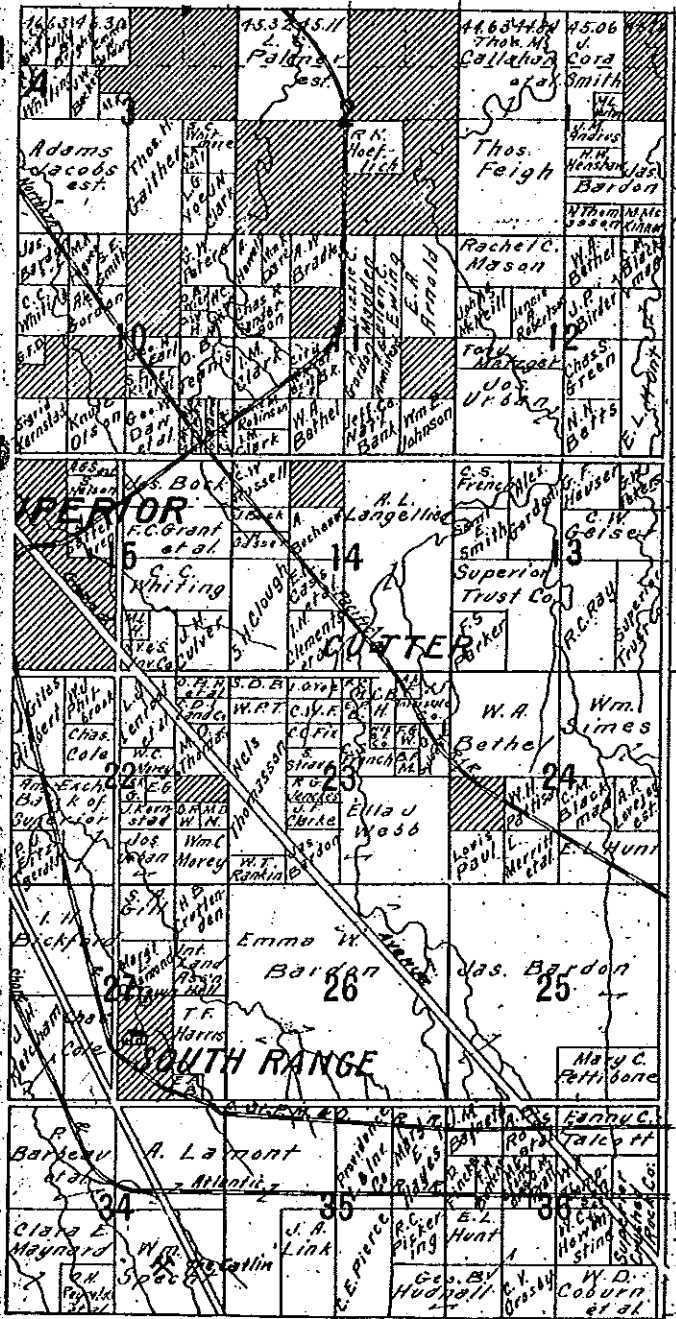
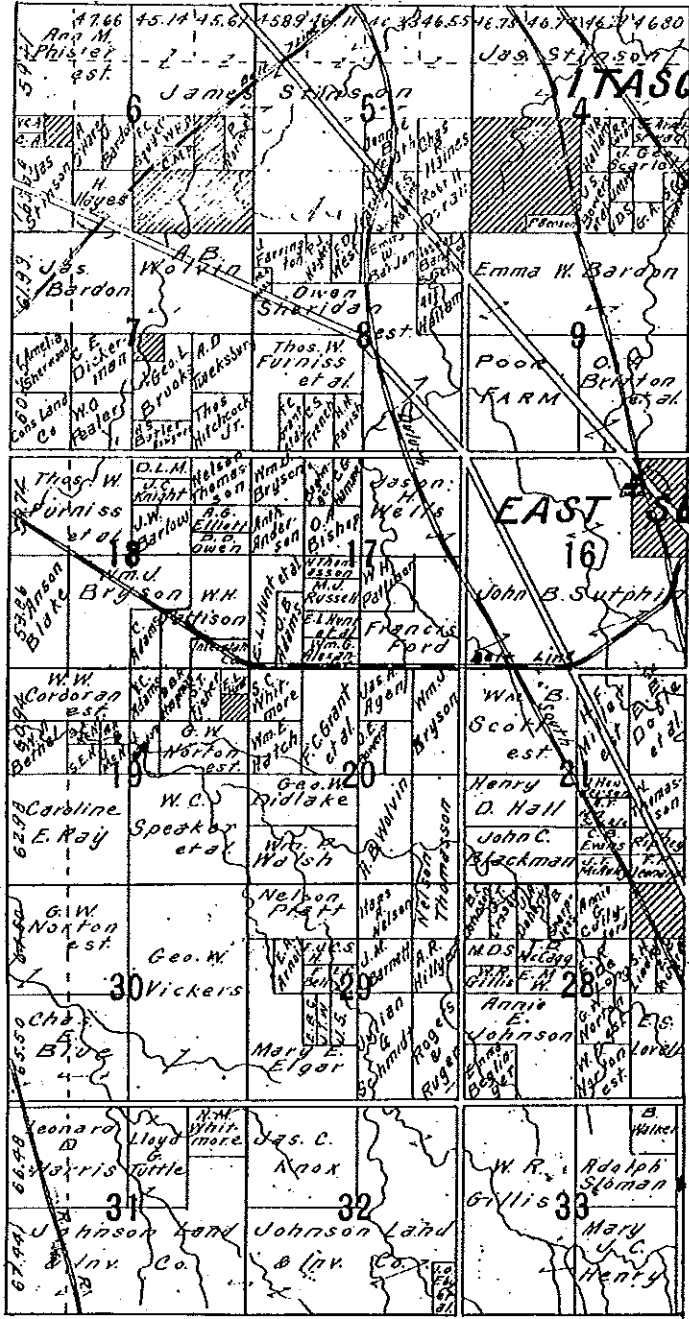

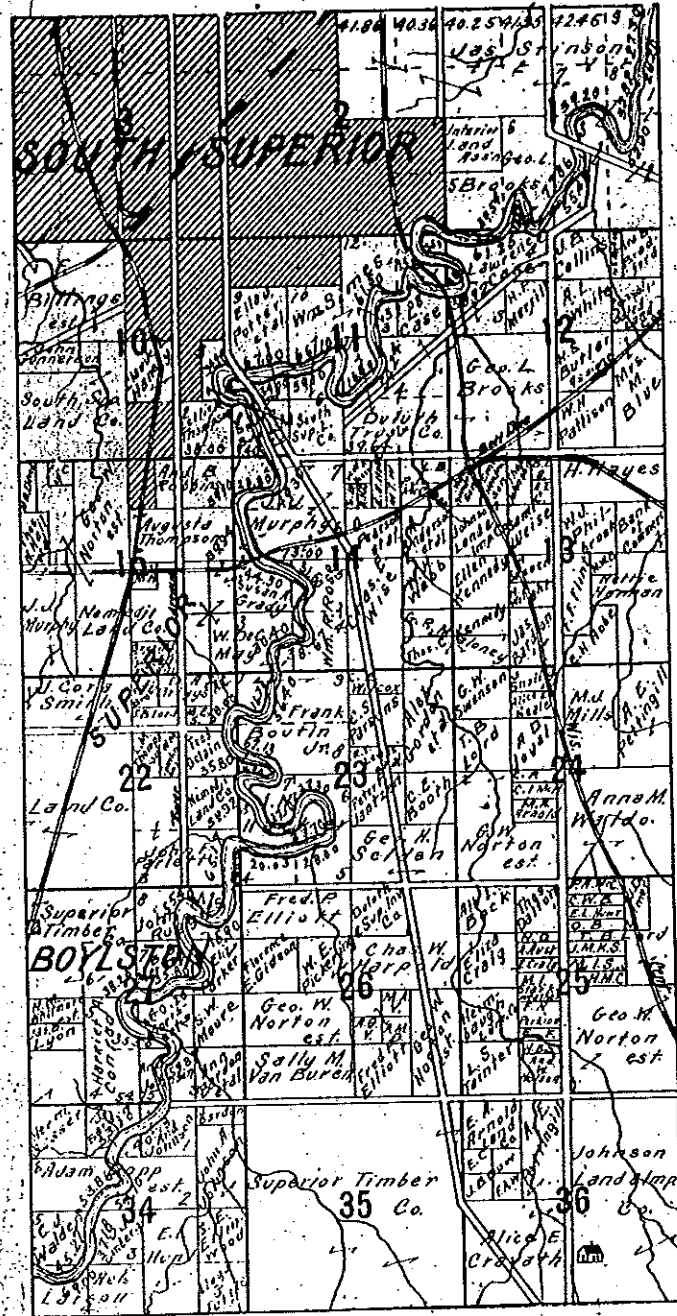
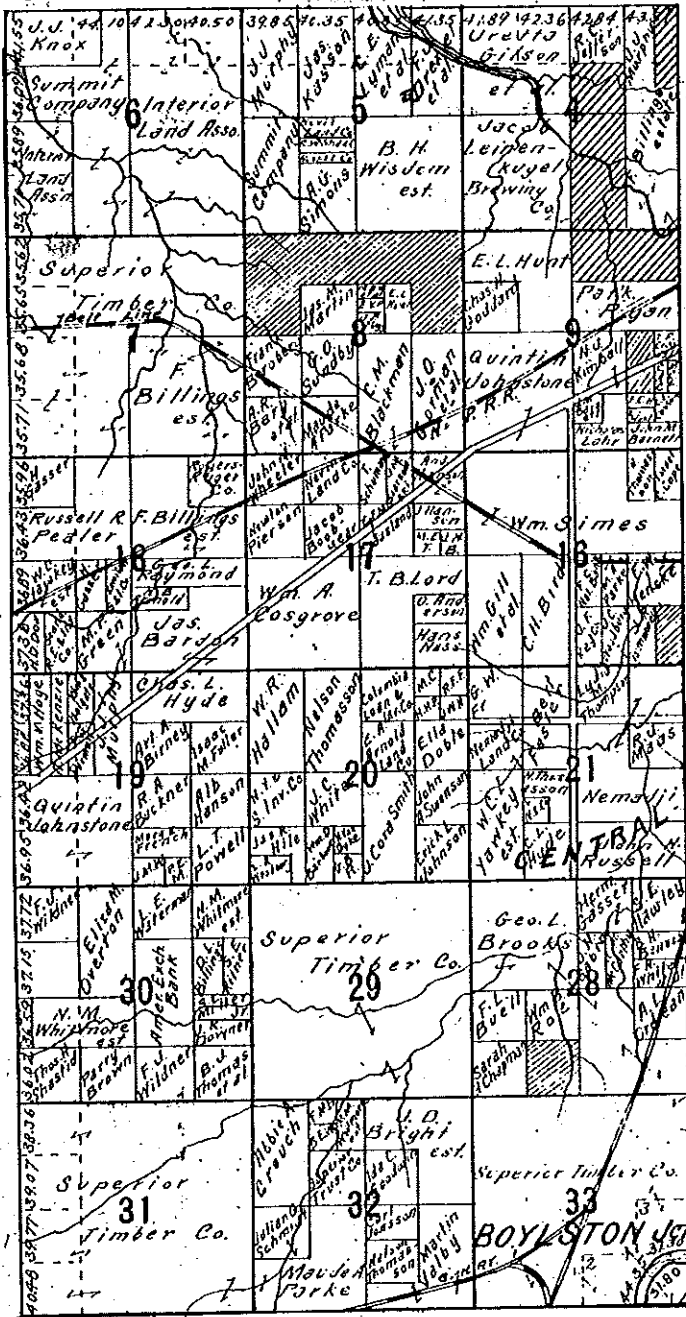

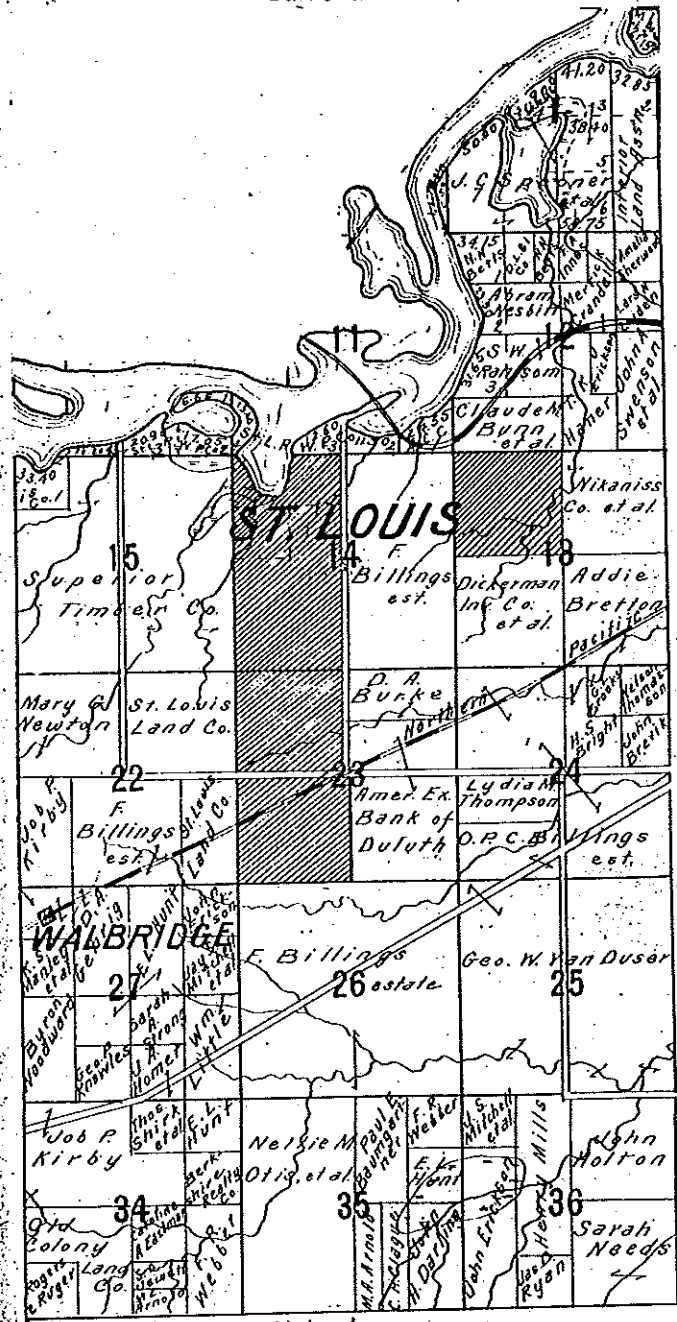
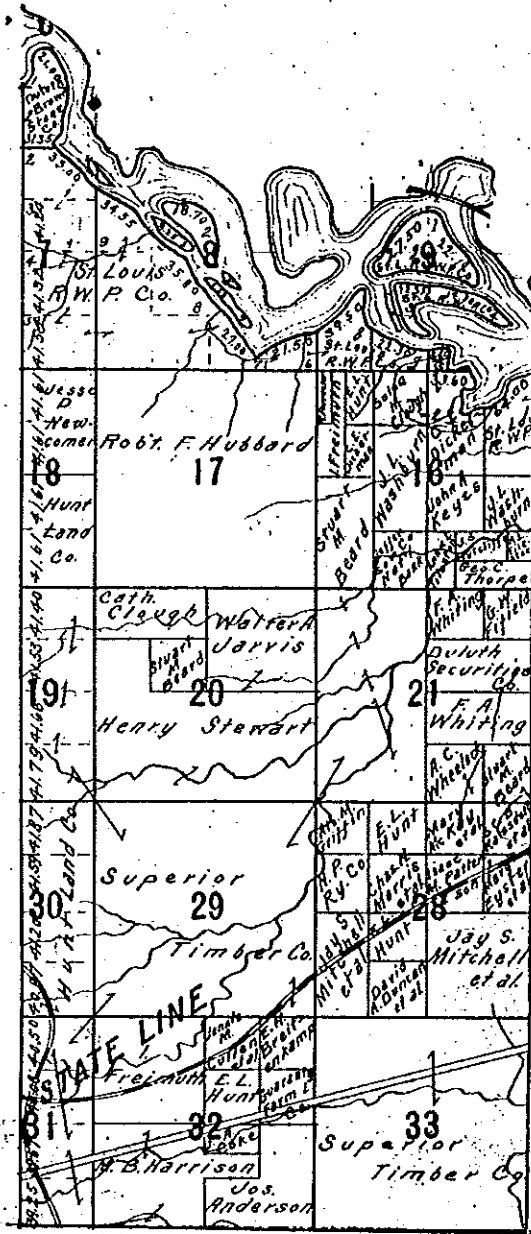

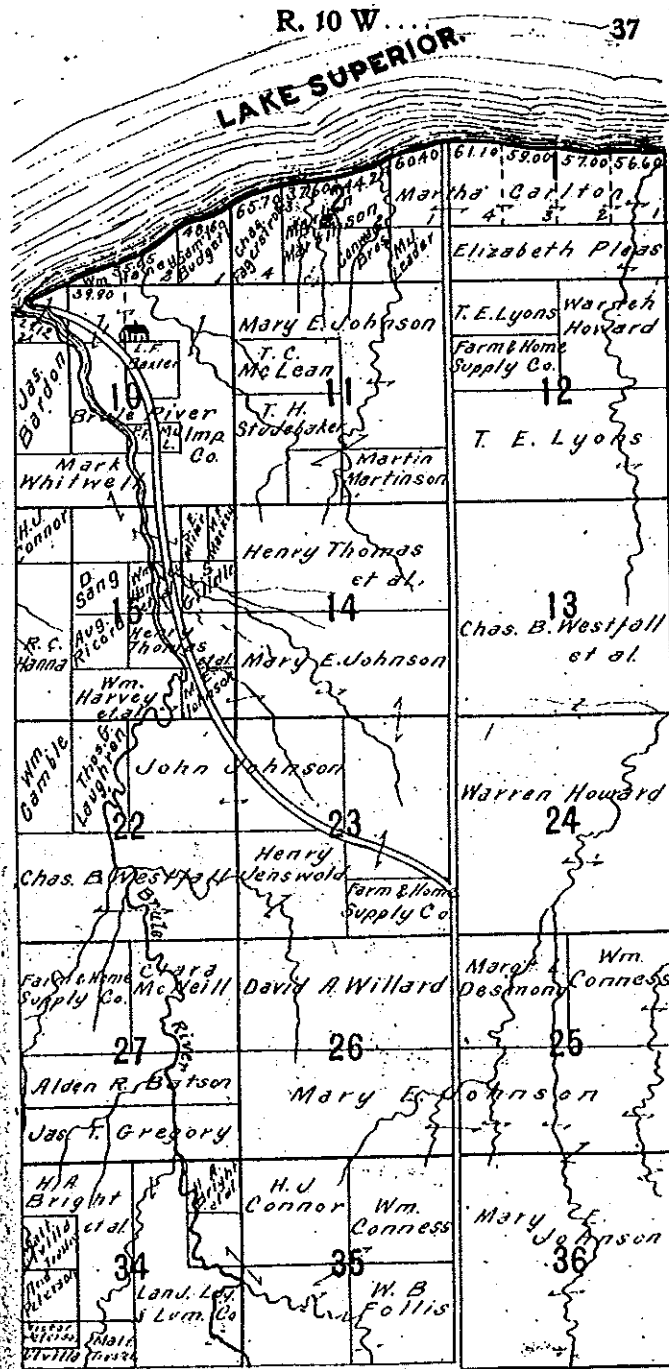
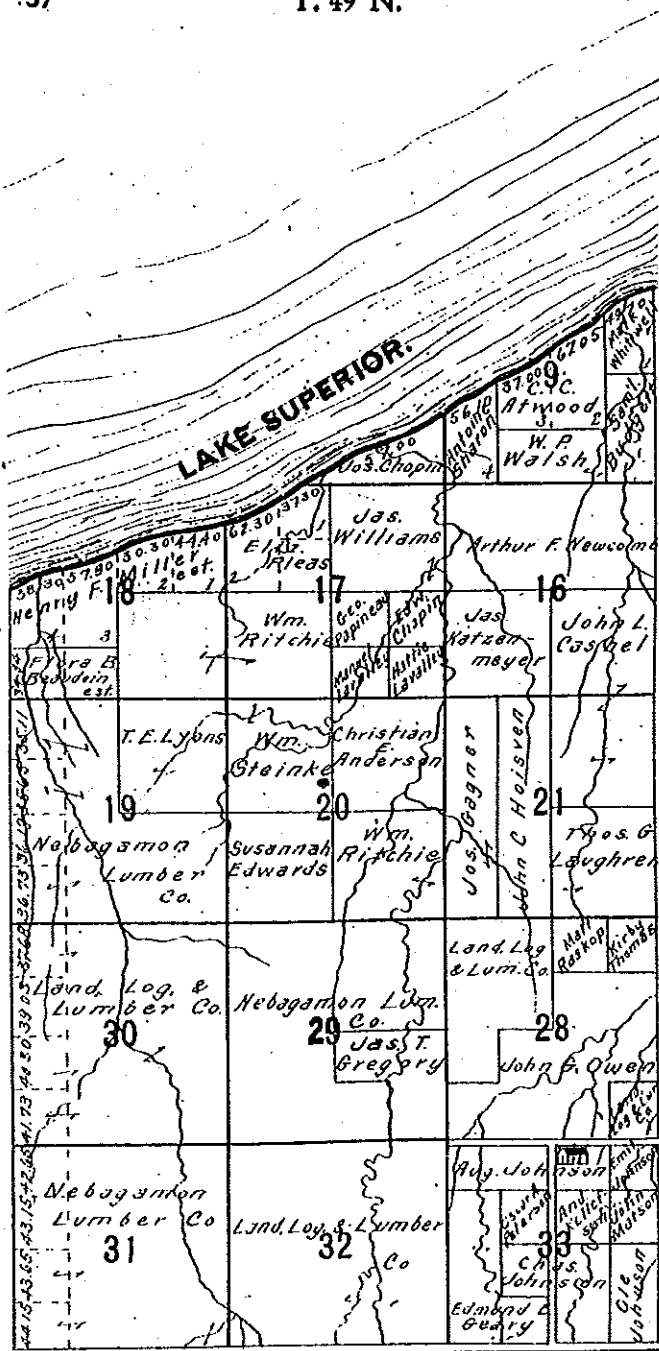

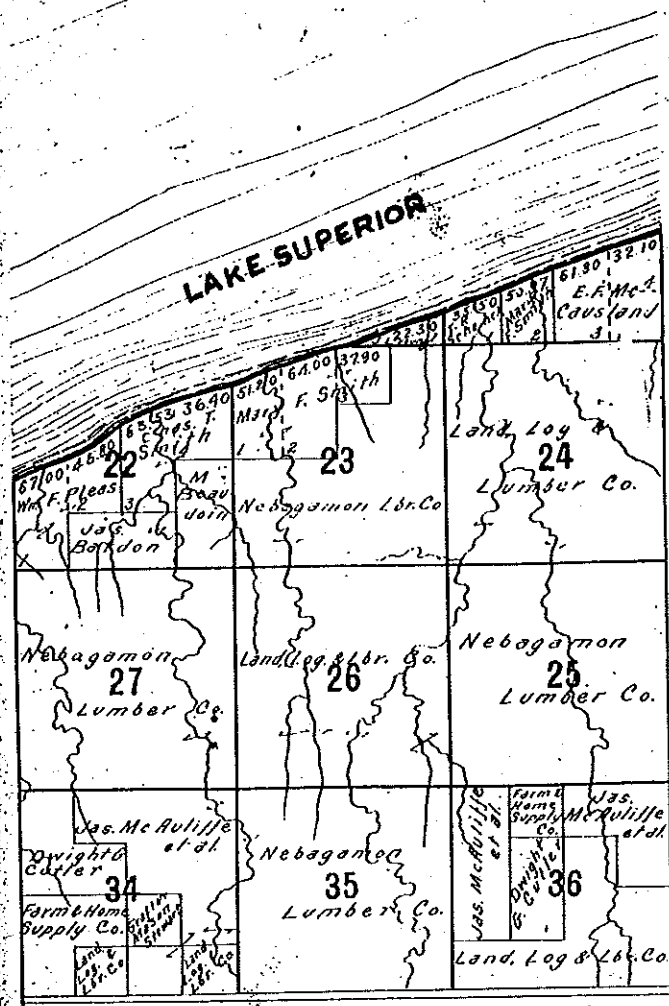
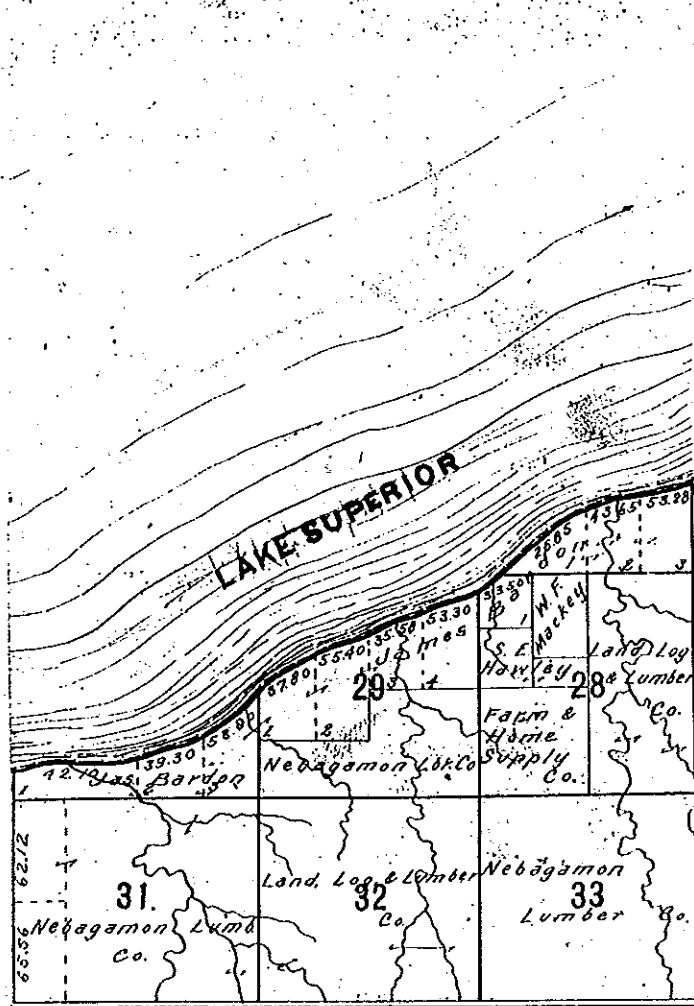

LAKE SUPERIOR.

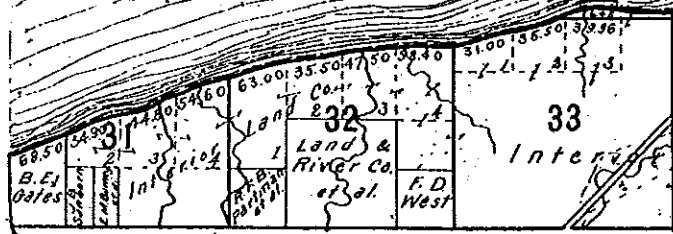

LAKE SUPERIOR.

SANDPORT

